

An illustration of a Metro Rail train at a station. The train is yellow and black with 'Metro Rail' and 'Go Metro' branding. It is stopped at a station platform where several people are walking, including a man with a cane, a woman with a dog, and a man on a bicycle. The background shows a multi-story building and palm trees under a blue sky. A large yellow tree trunk is on the left side of the image.

Next stop: further east.

GOLD LINE EASTSIDE TRANSIT CORRIDOR PHASE 2



Corridor-Wide Update Meeting

November 17, 2021

Meeting Format



Meeting will be recorded

Spanish interpretation available



- *Por teléfono en español: 646.749.3335*
- *Contraseña/Código: 974-408-445*



Webcams will **remain off** during meeting



Mics will **remain off** during formal presentation

To ask a question:



- Use the Raise Hand Function



- Use the Q&A function to type your question
- Call-in users dial *9 to raise your hand
 - Press *6 to unmute

Discounted Fares/LIFE Program

Fare collection and front door boarding resumes on buses on Jan. 10, 2022

Low-Income Fare Is Easy (LIFE) Program

> Six months of discounted LIFE fares

- **New** LIFE riders will get **90 days of free rides** starting January 10, 2022, when fare collection restarts
- Pay \$26 for a 30-day pass (regularly \$76)
- Pay \$6.50 for a 7-day pass (regularly \$19.50)
- To sign up for the LIFE Program, visit www.metro.net/riding/life/

Agenda

- > Project Overview and Schedule
- > Draft Environmental Impact Report Update
- > Grade Separation Policy
- > East LA Station Update
- > Greenwood Station and Alignment Update
- > Q & A

Our Expectation

We will conduct a respectful meeting to allow ideas and comments to be shared in an open and fair environment

Metro's Vision and Project Goals

Metro's vision

- > Increase prosperity for all by removing mobility barriers
- > Swift and easy mobility throughout LA County, anytime and
- > Accommodating more trips through a variety of high-quality mobility options

Project Goals (not all inclusive of all project goals and subject to change)

- > Improved access to the regional rail and bus network in LA County and beyond
- > Improved public transit access to regional employment centers
- > High-capacity transit line that will improve travel time in lower-income, transit-dependent areas

Project Overview: History



Project Overview: Washington Alternative



Measure M Expenditure Plan

CYCLE 1

Washington Alternative

State, Local and Other Funding

Total: \$3B

Groundbreaking
2029

Expected Opening Date
2035

CYCLE 2

Second Alignment (TBD)

State, Local, Federal and Other Funding

Measure M

Total: \$3B

Groundbreaking
2053

Expected Opening Date
2057

Project Overview: Measure M Project Timeline



 **ONGOING PUBLIC PARTICIPATION**

Eastside Transit Corridor Phase 2 is a four-pillar project. Schedule is subject to change per Metro Board direction

Draft Environmental Impact Report Update

- > In Feb 2020, Board approved the discontinuance of the National Environmental Policy Act (NEPA) and studying the project through the California Environmental Quality Act (CEQA)
- > 20 Environmental topics are required to be evaluated by CEQA, including impacts to communities and natural resources
- > Looks at short-term (construction), long-term (operational), and cumulative impacts of project on the environment
- > Community meetings will be scheduled prior to the release of the DEIR to inform the community
- > The DEIR is anticipated to be released in Spring/Summer 2022

Focused Community Updates

East Los Angeles Community Meetings (Monday, November 15)

- > Introduce Atlantic/Pomona Station Options
- > Update on the Atlantic/Whittier Station

Montebello Community Meeting (Tuesday, November 16)

- > Update on the Station and Alignment Configuration
 - Baseline Aerial Configuration
 - Introduction of At-grade Configuration and Station

Atlantic/Pomona Covered Underground Station

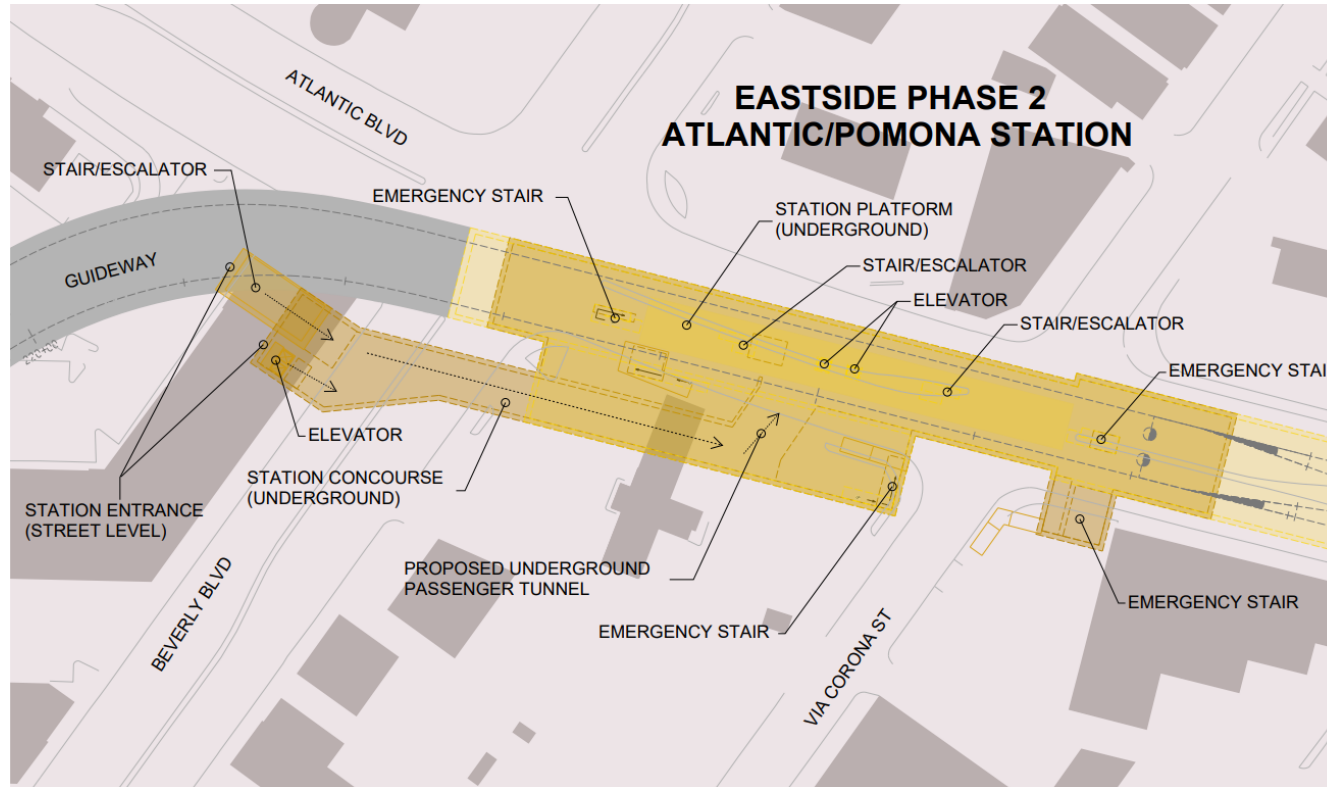

- > Station access on Atlantic Bl
- > Requires temporary construction and street closures on Atlantic Bl
- > Location provides station access and connection to two streets: Atlantic Bl and Beverly Bl
- > Air circulation needs
- > Accessibility (ADA)
- > Further from existing parking structure

Examples of Covered Stations

Vermont/Santa Monica Station



North Hollywood Station



Mariachi Plaza Station



Atlantic/Pomona Open Underground Station

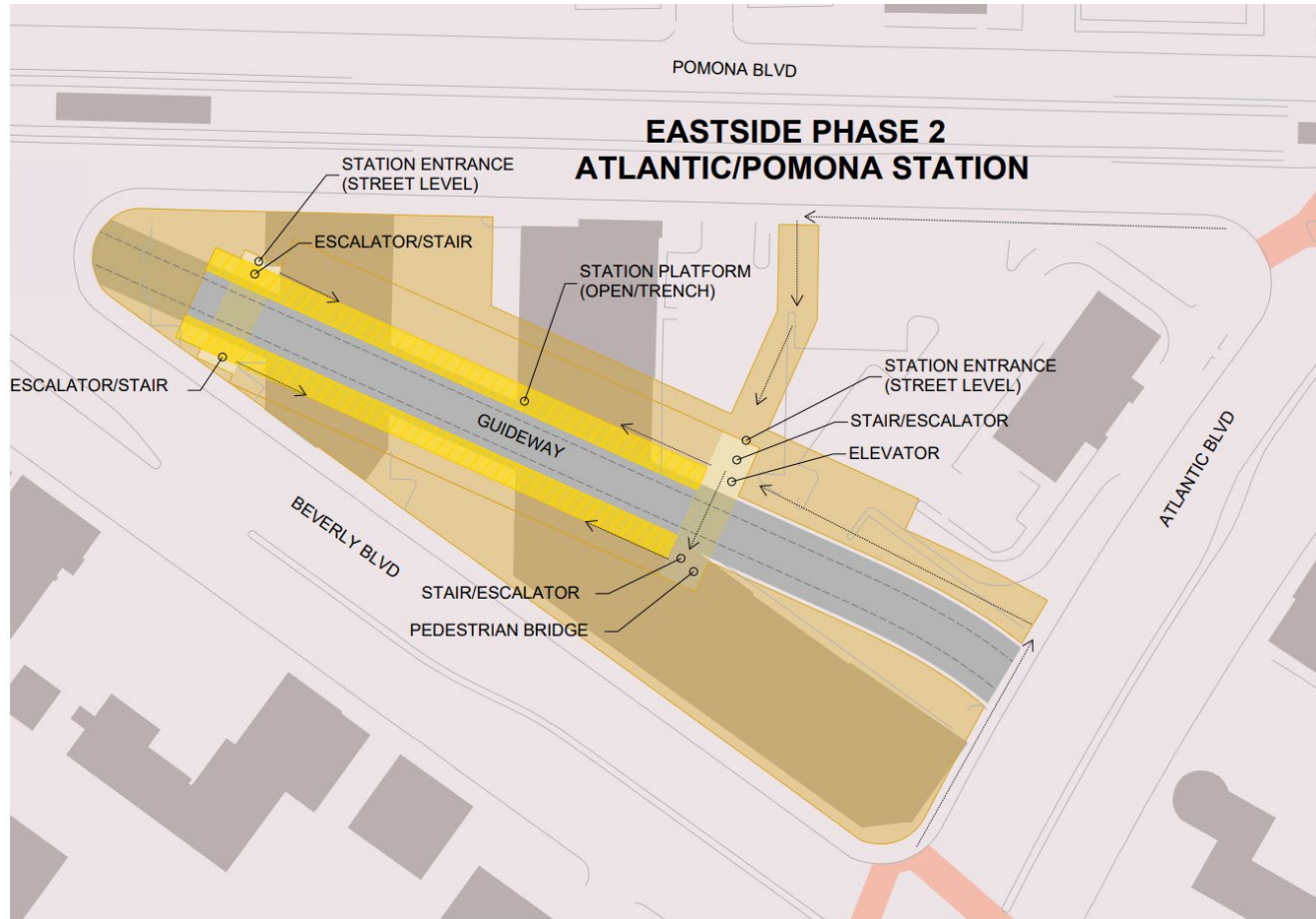

- > Natural ventilation
- > Improve pedestrians and bicyclist connections
- > Accessibility (ADA)
- > Could reduce temporary on-street construction work on Atlantic Bl
- > Reduction of temporary street closures on Atlantic Bl
- > Location provides station access and connection to three key streets: Pomona Bl, Beverly Bl, and Atlantic Bl
- > Close to existing parking structure

Examples of Open Stations

Memorial Park Station City of Pasadena



Atlantic/Whittier – South/West Corner (CVS)

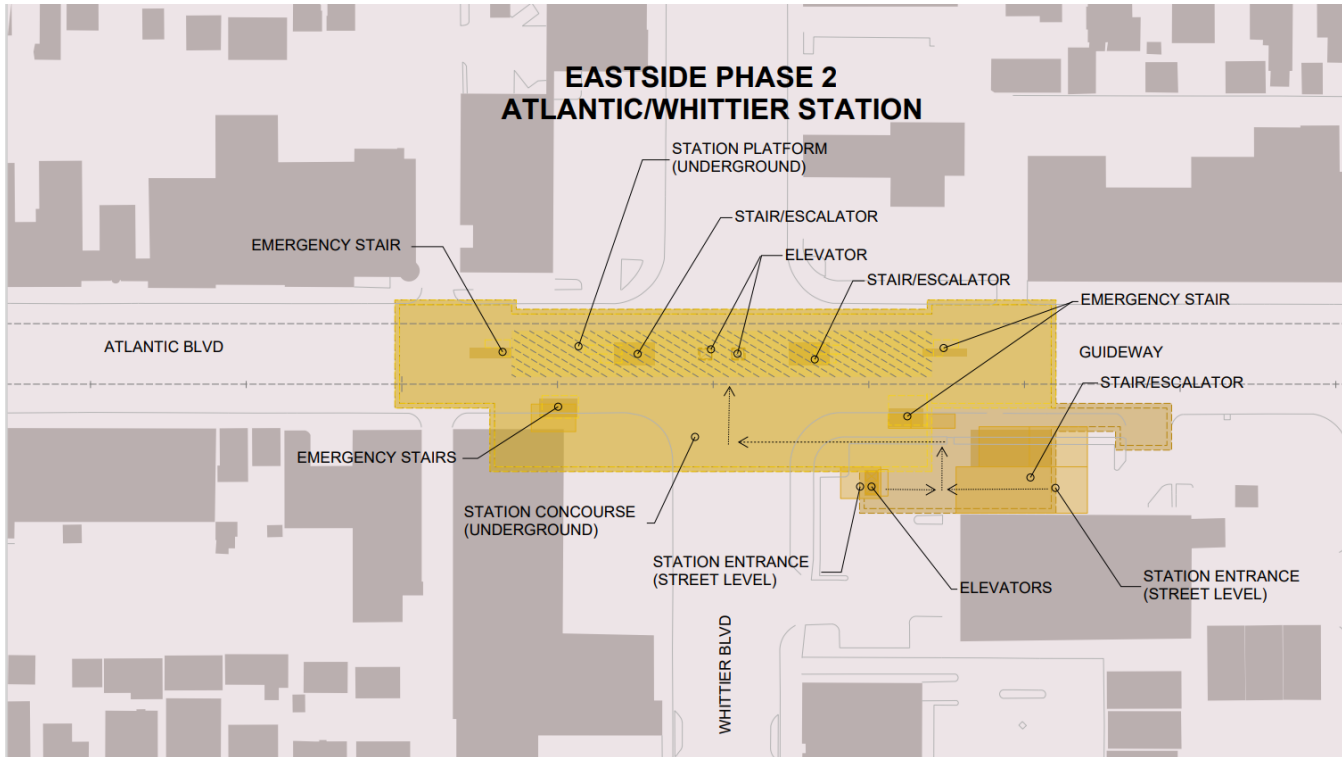

- > Sensitive historic property: Golden Gate Theater
- > Requires close coordination with National Register, historical societies and LA County
- > Constructability considerations and issues
- > Longer construction period – potential schedule delays
- > Not feasible to continue studying

Atlantic/Whittier – North/West Corner

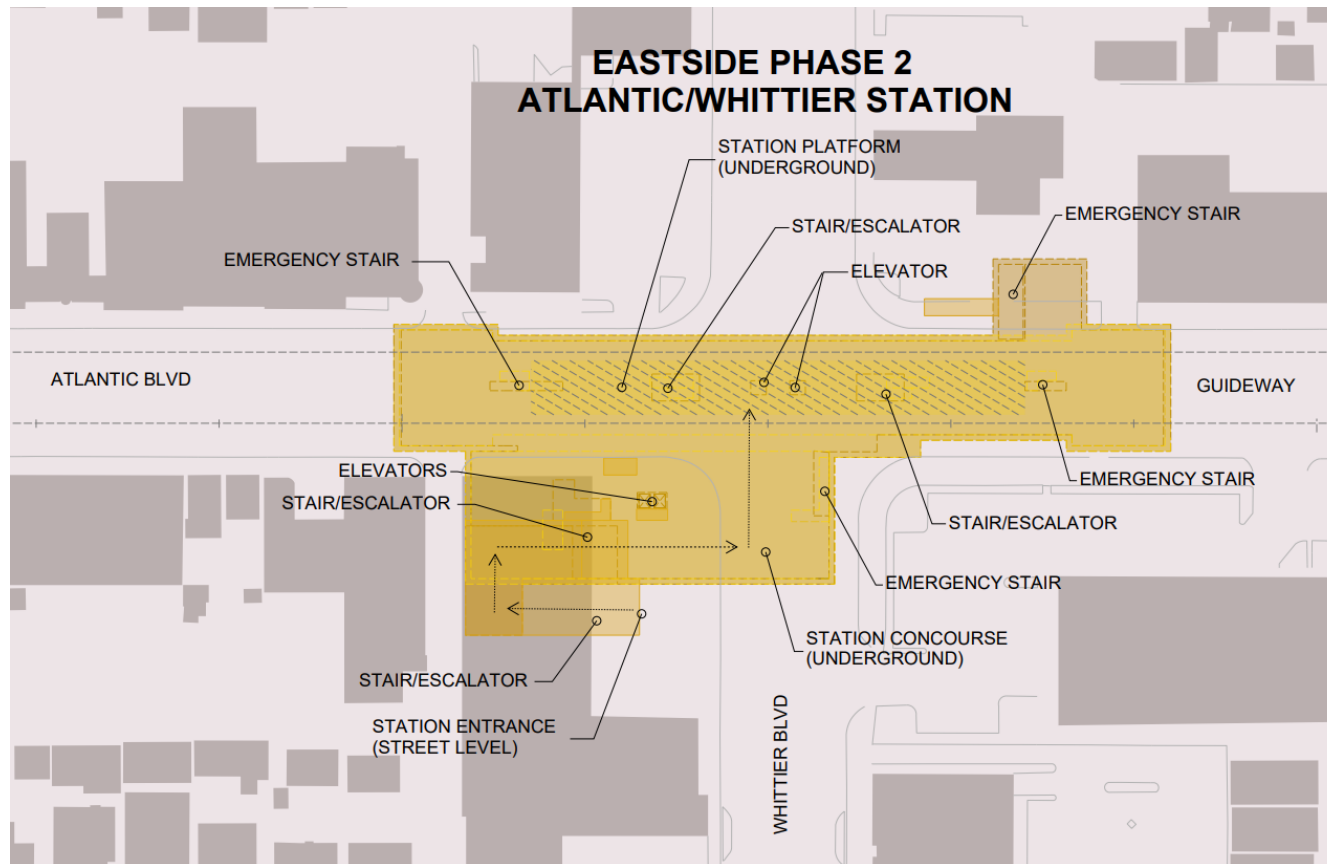

- > Property not historic: Sketchers Building
- > Requires less agency review and coordination
- > Reduce constructability concerns common with historic sites
- > Provides streamlined approach to station portals construction
- > Includes opportunity to connect with historic property
- > Space available for plaza

Greenwood Aerial Station

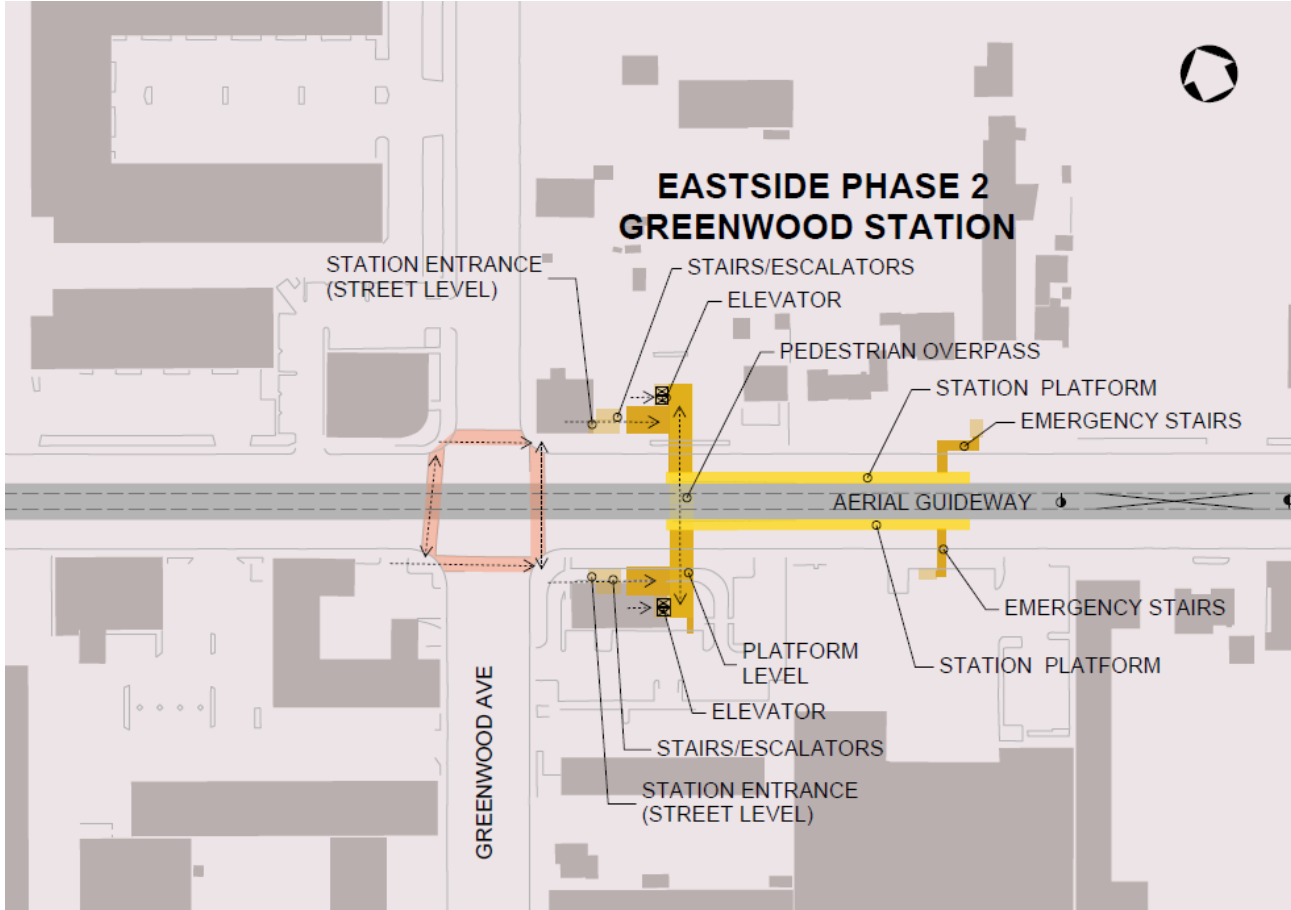

- > Station access requires vertical circulation with escalators and elevators
- > Accessibility (ADA)
- > Requires additional right of row to accommodate station structure
- > Station structure height would be approximately 60'

Greenwood Aerial Station

Metro E Line – La Brea Station



Metro L Line – Chinatown Station



At-grade Segment



At-grade Segment



Greenwood At-grade Station

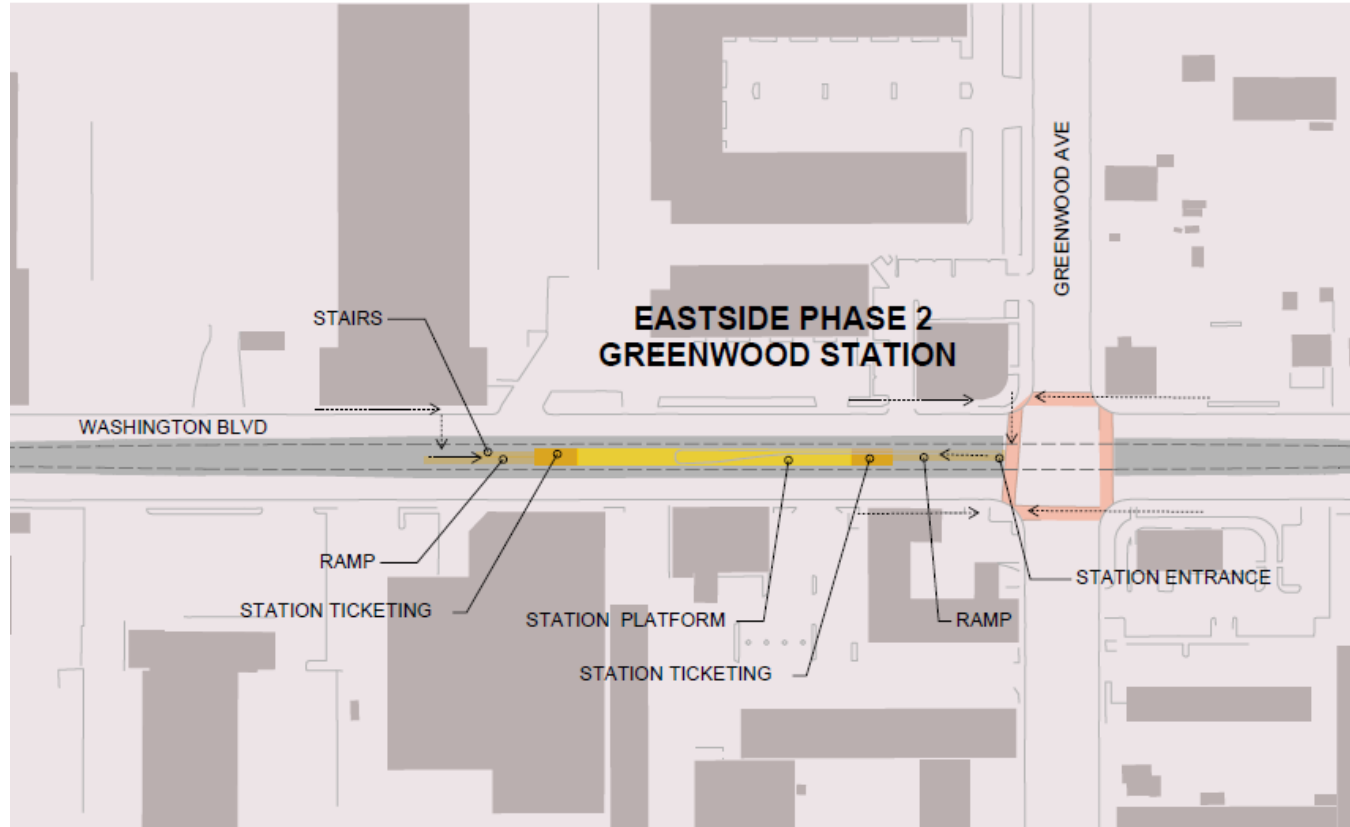

- > Station access is at ground level making the station easier to access
- > Accessibility (ADA)
- > Station area footprint is compact
- > Improved community integration with station level on the ground

Greenwood At-grade Station

Metro E Line – Santa Monica Station



Metro E Line – 17th Street Station



Next Steps

- > Consider feedback and input from the community and stakeholders
- > The design options will continue to be studied in the environmental document
- > Community meetings will be held in advance of the release DEIR
- > Anticipated release of the DEIR in Spring/Summer 2022
- > Public hearings will be schedule for public comment on the DEIR

Washington Alternative

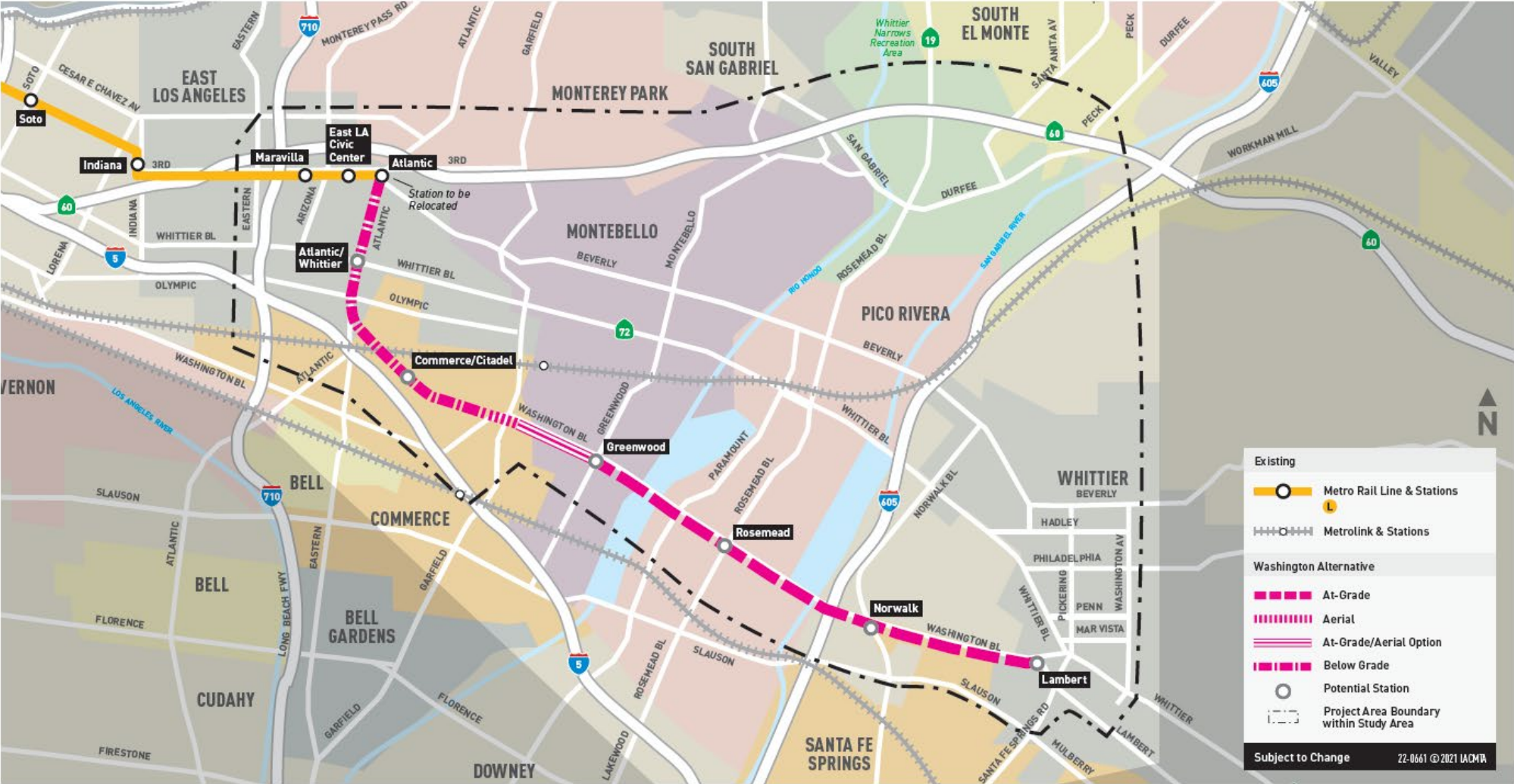

Questions & Answers

To ask a question:



- Use the Raise Hand Function



- Use the Q&A function to type your question
- Call-in users dial *9 to raise your hand

Contact Us



Jenny Cristales-Cevallos
Project Manager, Metro
One Gateway Plaza, M/S 99-22-6
Los Angeles, CA 90012



213.922.3012



eastsidephase2@metro.net



metro.net/eastsidephase2



losangelesmetro



@metrolosangeles