

(THIS PAGE INTENTIONALLY BLANK)

1960 Source Sheets



Volume 3, Sheet 277



Volume 3, Sheet 278



Volume 3, Sheet 279



Volume 3, Sheet 280

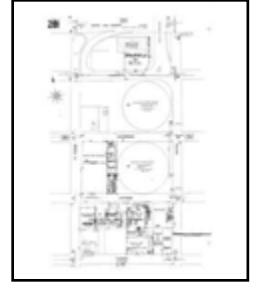

Volume 3, Sheet 281

1957 Source Sheets



Volume 3, Sheet 277



Volume 3, Sheet 278



Volume 3, Sheet 279



Volume 3, Sheet 280

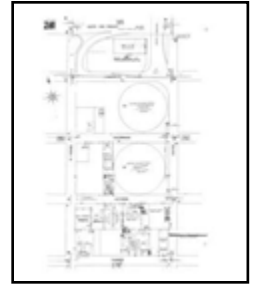

Volume 3, Sheet 281

1954 Source Sheets



Volume 3, Sheet 277



Volume 3, Sheet 278



Volume 3, Sheet 280



Volume 3, Sheet 281

1953 Source Sheets



Volume 3, Sheet 277



Volume 3, Sheet 278



Volume 3, Sheet 279



Volume 3, Sheet 280

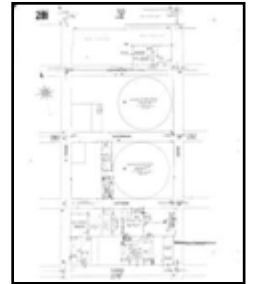

Volume 3, Sheet 281

Volume 3, Sheet 277



Volume 3, Sheet 278



Volume 3, Sheet 280



Volume 3, Sheet 281



1950 Source Sheets



Volume 3, Sheet 277



Volume 3, Sheet 278



Volume 3, Sheet 279



Volume 3, Sheet 280

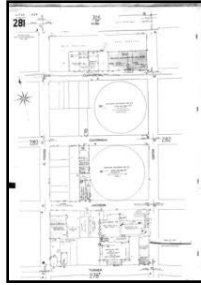

Volume 3, Sheet 281

1920 Source Sheets



Volume Congested Business District, Sheet

1906 Source Sheets



Volume 3, Sheet 277



Volume 3, Sheet 278



Volume 3, Sheet 280



Volume 3, Sheet 281

1894 Source Sheets



Volume 1, Sheet 26



Volume 1, Sheet 28



Volume 1, Sheet 29



Volume 1, Sheet 17



Volume 1, Sheet 18

1888 Source Sheets



Volume 1, Sheet 13



Volume 1, Sheet 15



Volume 1, Sheet 15



Volume 1, Sheet 16



Volume 1, Sheet 16

1970 Certified Sanborn Map



The certified Sanborn Library search results in this report can be authenticated by visiting www.edrnet.com and entering the certification number. Only Environmental Data Resources Inc. (EDR) is authorized to grant rights for commercial reproduction of maps by The Sanborn Library LLC, the copyright holder for the collection.

Certification # 7275-45DE-985A

Site Name: SCRIP
 Address: Union Station Area - N Vignes St & E Cessar Chavez
 City, ST, ZIP: Los Angeles CA 90012
 Client: Leighton Consulting
 EDR Inquiry: 4102444.3
 Order Date: 10/14/2014 8:02:03 AM
 Certification #: 7275-45DE-985A
 Copyright: 1970



This Certified Sanborn Map combines the following sheets. Outlined areas indicate map sheets within the collection.

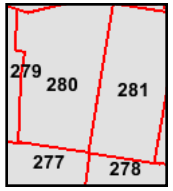
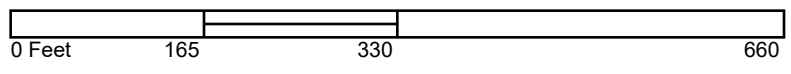

- Volume 3, Sheet 277
- Volume 3, Sheet 278
- Volume 3, Sheet 279
- Volume 3, Sheet 280
- Volume 3, Sheet 281



1968 Certified Sanborn Map



Site Name: SCRIP
 Address: Union Station Area - N Vignes St & E Cessar Chavez
 City, ST, ZIP: Los Angeles CA 90012
 Client: Leighton Consulting
 EDR Inquiry: 4102444.3
 Order Date: 10/14/2014 8:02:03 AM
 Certification #: 7275-45DE-9B5A



This Certified Sanborn Map combines the following sheets. Outlined areas indicate map sheets within the collection.

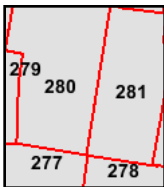
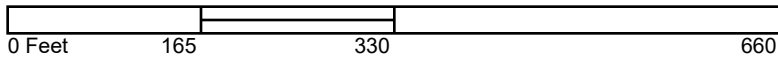

- Volume 3, Sheet 277
- Volume 3, Sheet 278
- Volume 3, Sheet 279
- Volume 3, Sheet 280
- Volume 3, Sheet 281



1965 Certified Sanborn Map

The certified Sanborn Library search results in this report can be authenticated by visiting www.edrnet.com and entering the certification number. Only Environmental Data Resources Inc. (EDR) is authorized to grant rights for commercial reproduction of maps by The Sanborn Library LLC, the copyright holder for the collection.

Certification # 7275-45DE-9B5A

Site Name: SCRIP
 Address: Union Station Area - N Vignes St & E Cessar Chavez
 City, ST, ZIP: Los Angeles CA 90012
 Client: Leighton Consulting
 EDR Inquiry: 4102444.3
 Order Date: 10/14/2014 8:02:03 AM
 Certification #: 7275-45DE-9B5A



This Certified Sanborn Map combines the following sheets. Outlined areas indicate map sheets within the collection.

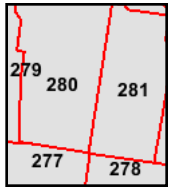
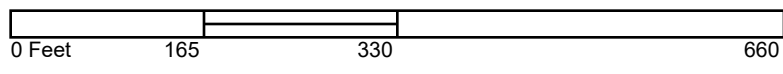

- Volume 3, Sheet 277
- Volume 3, Sheet 278
- Volume 3, Sheet 279
- Volume 3, Sheet 280
- Volume 3, Sheet 281



1964 Certified Sanborn Map

The certified Sanborn Library search results in this report can be authorized by visiting www.edrnet.com and entering the certification number. Only Environmental Data Resources Inc. (EDR) is authorized to grant rights for commercial reproduction of maps by The Sanborn Library LLC, the copyright holder for the collection.



Certification # 7275-45DE-9B5A

Site Name: SCRIP
 Address: Union Station Area - N Vignes St & E Cesar Chavez
 City, ST, ZIP: Los Angeles CA 90012
 Client: Leighton Consulting
 EDR Inquiry: 4102444.3
 Order Date: 10/14/2014 8:02:03 AM
 Certification #: 7275-45DE-9B5A
 Copyright: 1964



This Certified Sanborn Map combines the following sheets. Outlined areas indicate map sheets within the collection.

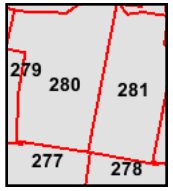
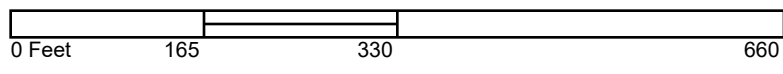

- Volume 3, Sheet 277
- Volume 3, Sheet 278
- Volume 3, Sheet 280
- Volume 3, Sheet 281



1960 Certified Sanborn Map



The certified Sanborn Library search results in this report can be authenticated by visiting www.edrnet.com and entering the certification number. Only Environmental Data Resources, Inc. (EDR) is authorized to grant rights for commercial reproduction of maps by The Sanborn Library LLC, the copyright holder for the collection.

Certification # 7275-45DE-9B5A

Site Name: SCRIP
 Address: Union Station Area - N Vignes St & E Cesar Chavez
 City, ST, ZIP: Los Angeles CA 90012
 Client: Leighton Consulting
 EDR Inquiry: 4102444.3
 Order Date: 10/14/2014 8:02:03 AM
 Certification #: 7275-45DE-9B5A
 Copyright: 1960



This Certified Sanborn Map combines the following sheets. Outlined areas indicate map sheets within the collection.

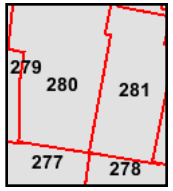
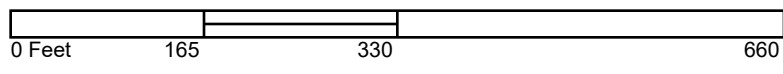

- Volume 3, Sheet 277
- Volume 3, Sheet 278
- Volume 3, Sheet 279
- Volume 3, Sheet 280
- Volume 3, Sheet 281



1957 Certified Sanborn Map



The certified Sanborn Library search results in this report can be authenticated by visiting www.environmentaldata.com and entering the certification number. Only Environmental Data Resources Inc. (EDR) is authorized to grant rights for commercial reproduction of maps by The Sanborn Library LLC, the copyright holder for the collection.

Certification # 7275-45DE-9B5A

Site Name: SCRIP
 Address: Union Station Area - N Vignes St & E Cessar Chavez
 City, ST, ZIP: Los Angeles CA 90012
 Client: Leighton Consulting
 EDR Inquiry: 410244.3
 Order Date: 10/14/2014 8:02:03 AM
 Certification #: 7275-45DE-9B5A
 Copyright: 1957



This Certified Sanborn Map combines the following sheets. Outlined areas indicate map sheets within the collection.

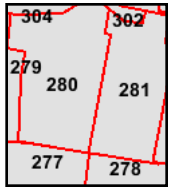
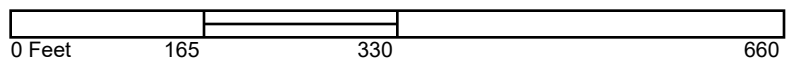

- Volume 3, Sheet 277
- Volume 3, Sheet 278
- Volume 3, Sheet 279
- Volume 3, Sheet 280
- Volume 3, Sheet 281



1954 Certified Sanborn Map

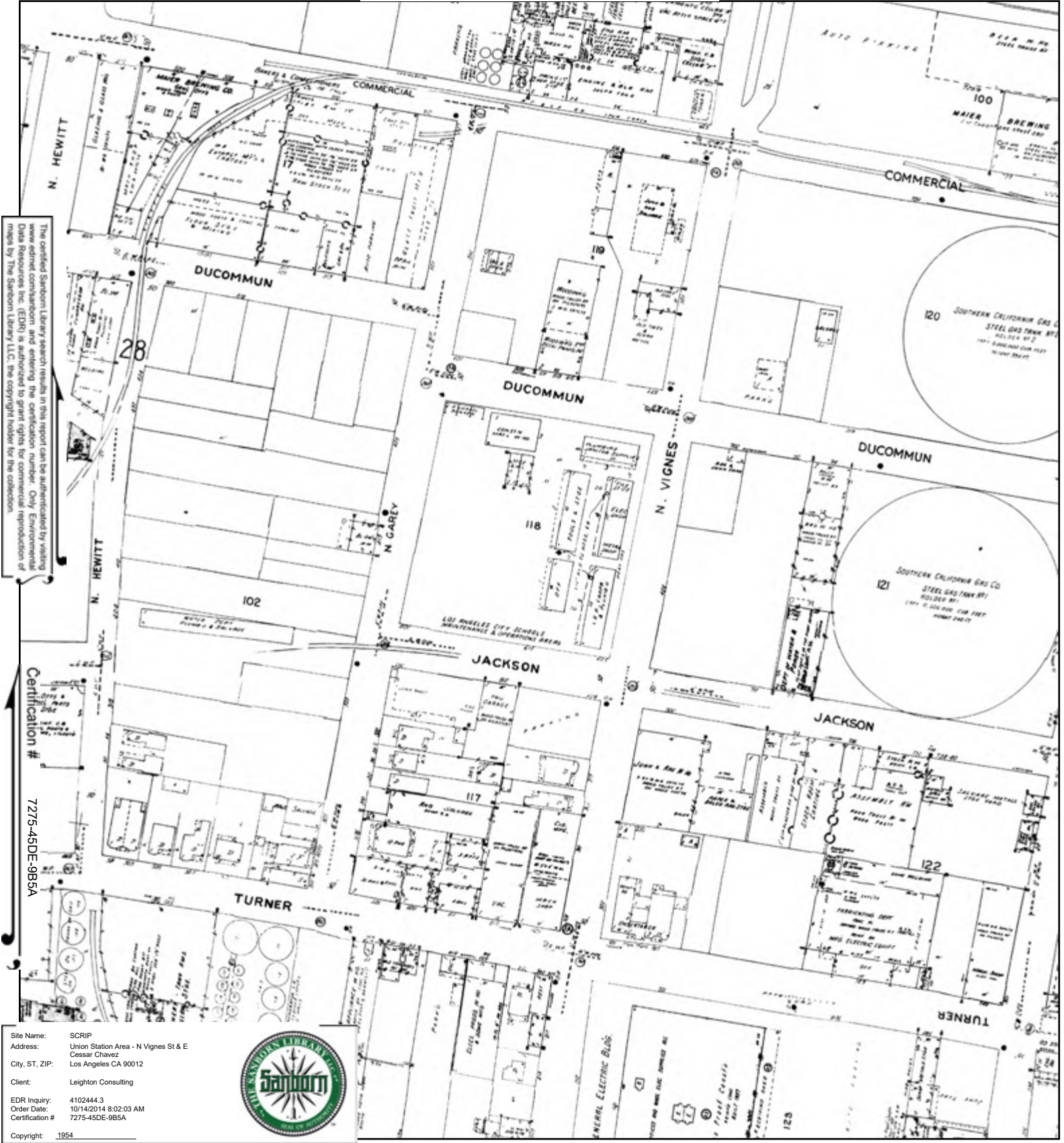

The certified Sanborn Library search results in this report can be authenticated by visiting www.edrnet.com/sanborn and entering the certification number. Only Environmental Data Resources Inc. (EDR) is authorized to grant rights for commercial reproduction of maps by The Sanborn Library LLC, the copyright holder for the collection.

Certification # 7275-45DE-9B5A

Site Name: SCRIP
 Address: Union Station Area - N Vignes St & E Cessar Chavez
 City, ST, ZIP: Los Angeles CA 90012
 Client: Leighton Consulting
 EDR Inquiry: 4102444.3
 Order Date: 10/14/2014 8:02:03 AM
 Certification # 7275-45DE-9B5A
 Copyright: 1954



This Certified Sanborn Map combines the following sheets. Outlined areas indicate map sheets within the collection.

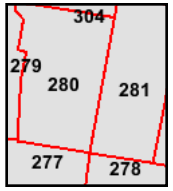
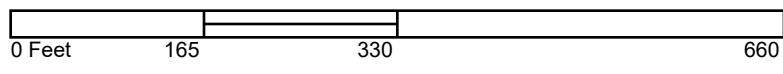

- Volume 3, Sheet 277
- Volume 3, Sheet 278
- Volume 3, Sheet 280
- Volume 3, Sheet 281



1953 Certified Sanborn Map

The certified Sanborn Library search results in this report can be authenticated by visiting www.edrnet.com/sanborn and entering the certification number. Only Environmental Data Resources, Inc. (EDR) is authorized to grant rights for commercial reproduction of maps by The Sanborn Library LLC, the copyright holder for the collection.

Certification # 7275-45DE-9B5A



Site Name: SCRIP
 Address: Union Station Area - N Vignes St & E Cesar Chavez
 City, ST, ZIP: Los Angeles CA 90012
 Client: Leighton Consulting
 EDR Inquiry: 4102444.3
 Order Date: 10/14/2014 8:02:03 AM
 Certification #: 7275-45DE-9B5A
 Copyright: 1953



This Certified Sanborn Map combines the following sheets. Outlined areas indicate map sheets within the collection.

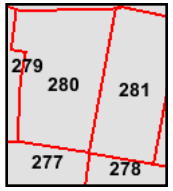
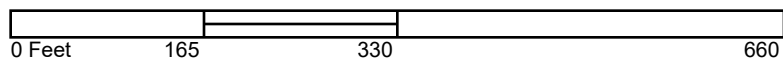

- Volume 3, Sheet 277
- Volume 3, Sheet 278
- Volume 3, Sheet 279
- Volume 3, Sheet 280
- Volume 3, Sheet 281
- Volume 3, Sheet 277
- Volume 3, Sheet 278
- Volume 3, Sheet 280
- Volume 3, Sheet 281



1950 Certified Sanborn Map



This Certified Sanborn Map combines the following sheets. Outlined areas indicate map sheets within the collection.

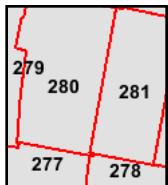
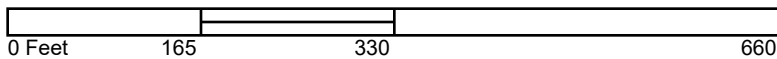

- Volume 3, Sheet 277
- Volume 3, Sheet 278
- Volume 3, Sheet 279
- Volume 3, Sheet 280
- Volume 3, Sheet 281



1920 Certified Sanborn Map

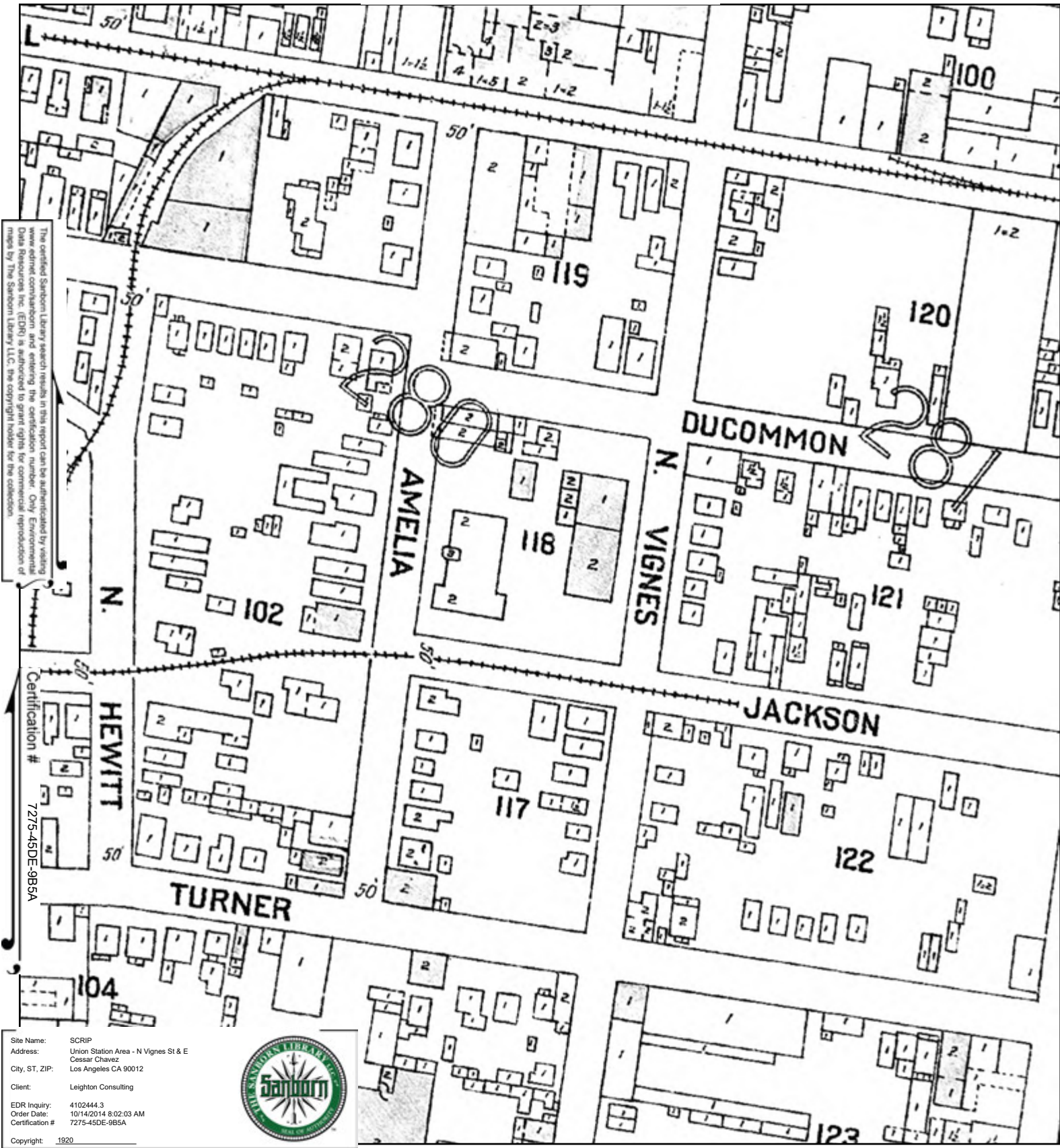

The certified Sanborn Library search results in this report can be authenticated by visiting www.edrnet.com/sanborn and entering the certification number. Only Environmental Data Resources Inc. (EDR) is authorized to grant rights for commercial reproduction of maps by The Sanborn Library LLC, the copyright holder for the collection.

Site Name: SCRIP
 Address: Union Station Area - N Vignes St & E Cessar Chavez
 City, ST, ZIP: Los Angeles CA 90012
 Client: Leighton Consulting
 EDR Inquiry: 4102444.3
 Order Date: 10/14/2014 8:02:03 AM
 Certification #: 7275-45DE-985A
 Copyright: 1920



This Certified Sanborn Map combines the following sheets.
 Outlined areas indicate map sheets within the collection.

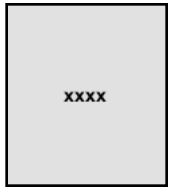
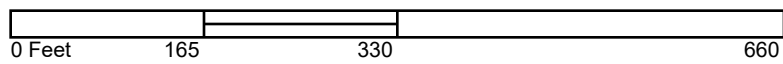

Volume Congested Business District, Sheet



1906 Certified Sanborn Map

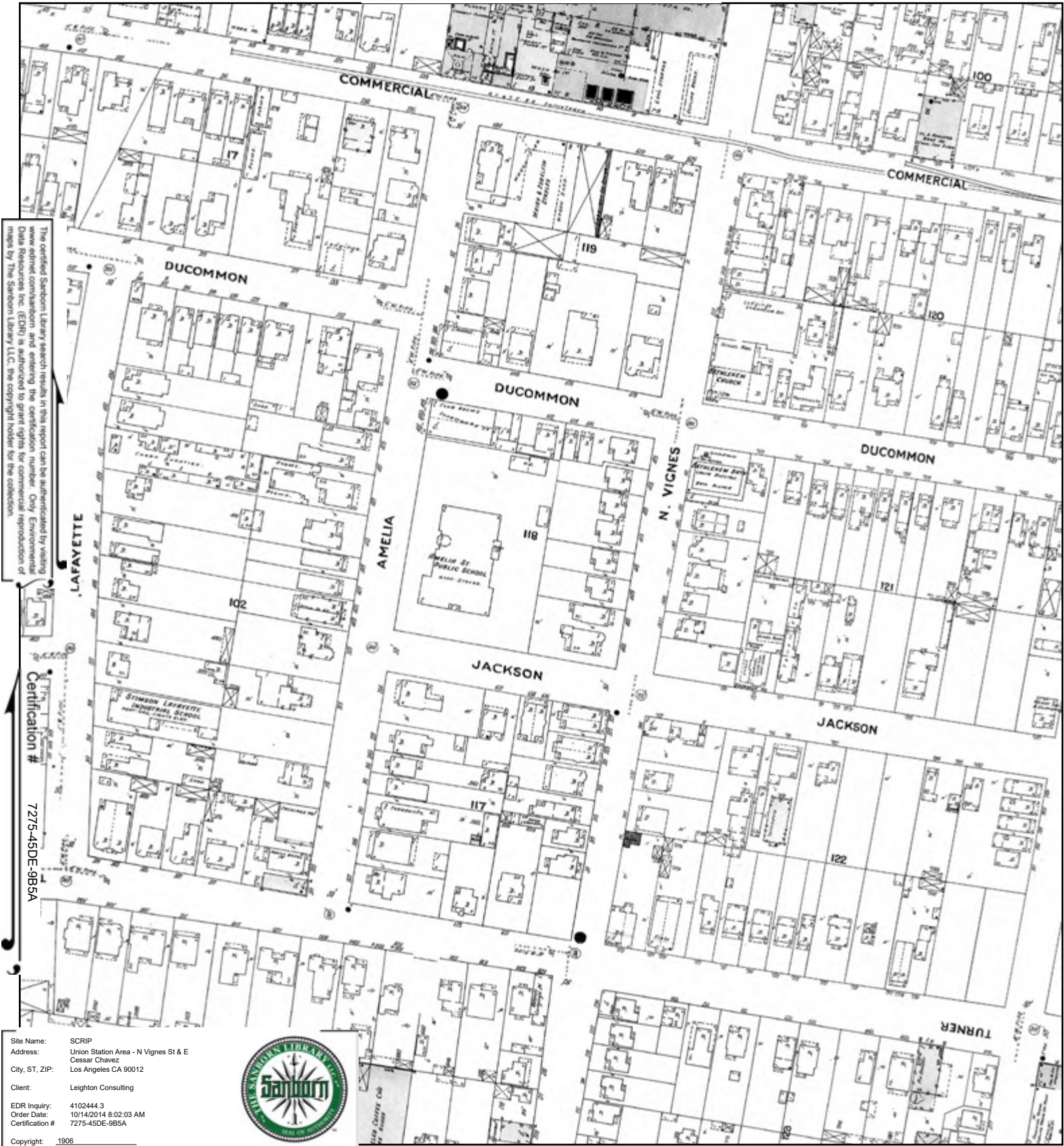

This Certified Sanborn Map combines the following sheets.
 Outlined areas indicate map sheets within the collection.

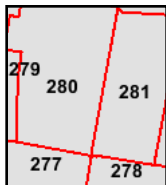
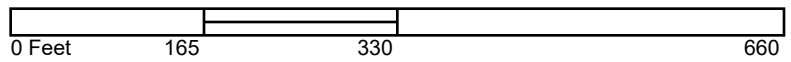

- Volume 3, Sheet 277
- Volume 3, Sheet 278
- Volume 3, Sheet 280
- Volume 3, Sheet 281



1894 Certified Sanborn Map



This Certified Sanborn Map combines the following sheets. Outlined areas indicate map sheets within the collection.

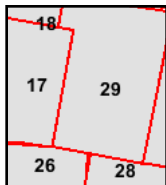
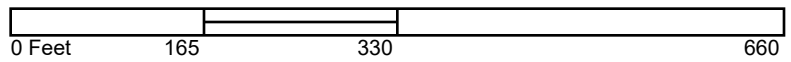

- Volume 1, Sheet 26
- Volume 1, Sheet 28
- Volume 1, Sheet 29
- Volume 1, Sheet 17
- Volume 1, Sheet 18



1888 Certified Sanborn Map

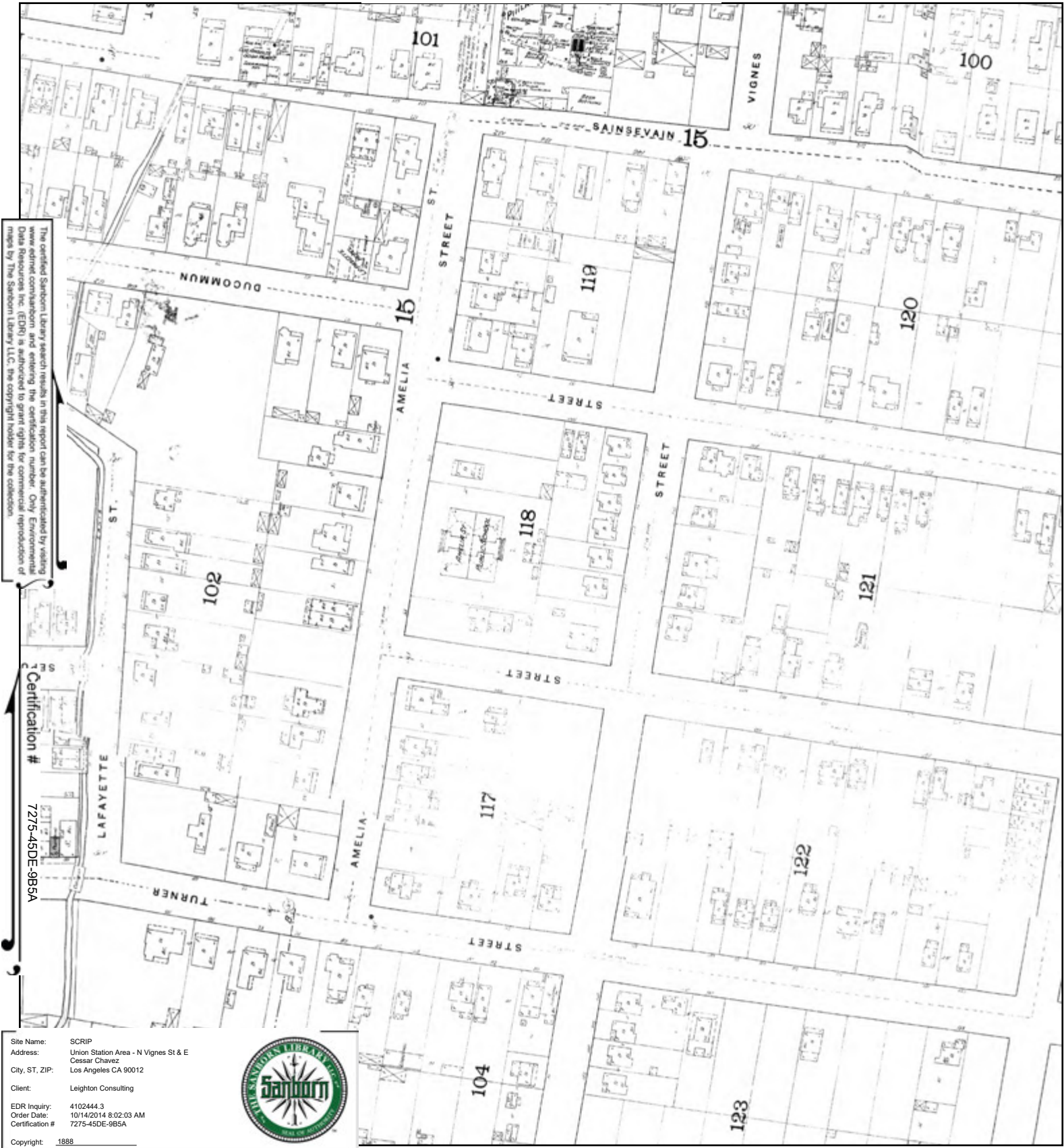

The certified Sanborn Library search results in this report can be authenticated by visiting www.edrnet.com/sanborn and entering the certification number. Only Environmental Data Resources, Inc. (EDR) is authorized to grant rights for commercial reproduction of maps by The Sanborn Library LLC, the copyright holder for the collection.

Certification # 7275-45DE-985A

Site Name: SCRIP
 Address: Union Station Area - N Vignes St & E Cesar Chavez
 City, ST, ZIP: Los Angeles CA 90012
 Client: Leighton Consulting
 EDR Inquiry: 4102444.3
 Order Date: 10/14/2014 8:02:03 AM
 Certification #: 7275-45DE-985A



Copyright: 1888

This Certified Sanborn Map combines the following sheets. Outlined areas indicate map sheets within the collection.

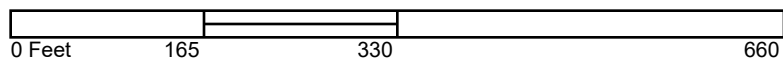

- Volume 1, Sheet 13
- Volume 1, Sheet 15
- Volume 1, Sheet 16
- Volume 1, Sheet 16
- Volume 1, Sheet 16





SCRIP

Union Station Area - N Vignes St & E Cesar Chavez
Los Angeles, CA 90012

Inquiry Number: 4102444.3

October 14, 2014

Certified Sanborn® Map Report



6 Armstrong Road, 4th Floor
Shelton, Connecticut 06484
Toll Free: 800.352.0050
www.edrnet.com

Certified Sanborn® Map Report

10/14/14

Site Name:

SCRIP
Union Station Area - N Vignes
Los Angeles, CA 90012

Client Name:

Leighton Consulting
17781 Cowan
Irvine, CA 92614



EDR Inquiry # 4102444.3

Contact: Meredith Church

The Sanborn Library has been searched by EDR and maps covering the target property location as provided by Leighton Consulting were identified for the years listed below. The Sanborn Library is the largest, most complete collection of fire insurance maps. The collection includes maps from Sanborn, Bromley, Perris & Browne, Hopkins, Barlow, and others. Only Environmental Data Resources Inc. (EDR) is authorized to grant rights for commercial reproduction of maps by the Sanborn Library LLC, the copyright holder for the collection. Results can be authenticated by visiting www.edrnet.com/sanborn.

The Sanborn Library is continually enhanced with newly identified map archives. This report accesses all maps in the collection as of the day this report was generated.

Certified Sanborn Results:

Site Name: SCRIP
Address: Union Station Area - N Vignes St & E Cessar
City, State, Zip: Los Angeles, CA 90012
Cross Street:
P.O. # 10842.001
Project: SCRIP
Certification # 7275-45DE-9B5A

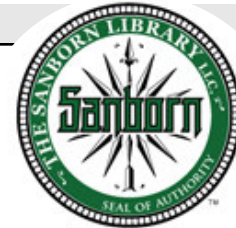

Sanborn® Library search results
Certification # 7275-45DE-9B5A

Maps Provided:

1970	1954	1906
1968	1953	1894
1965	1950	1890
1964	1949	1888
1960	1921	
1957	1920	

The Sanborn Library includes more than 1.2 million fire insurance maps from Sanborn, Bromley, Perris & Browne, Hopkins, Barlow and others which track historical property usage in approximately 12,000 American cities and towns. Collections searched:

- Library of Congress
- University Publications of America
- EDR Private Collection

The Sanborn Library LLC Since 1866™

Limited Permission To Make Copies

Leighton Consulting (the client) is permitted to make up to FIVE photocopies of this Sanborn Map transmittal and each fire insurance map accompanying this report solely for the limited use of its customer. No one other than the client is authorized to make copies. Upon request made directly to an EDR Account Executive, the client may be permitted to make a limited number of additional photocopies. This permission is conditioned upon compliance by the client, its customer and their agents with EDR's copyright policy; a copy of which is available upon request.

Disclaimer - Copyright and Trademark notice

This Report contains certain information obtained from a variety of public and other sources reasonably available to Environmental Data Resources, Inc. It cannot be concluded from this Report that coverage information for the target and surrounding properties does not exist from other sources. NO WARRANTY EXPRESSED OR IMPLIED, IS MADE WHATSOEVER IN CONNECTION WITH THIS REPORT. ENVIRONMENTAL DATA RESOURCES, INC. SPECIFICALLY DISCLAIMS THE MAKING OF ANY SUCH WARRANTIES, INCLUDING WITHOUT LIMITATION, MERCHANTABILITY OR FITNESS FOR A PARTICULAR USE OR PURPOSE. ALL RISK IS ASSUMED BY THE USER. IN NO EVENT SHALL ENVIRONMENTAL DATA RESOURCES, INC. BE LIABLE TO ANYONE, WHETHER ARISING OUT OF ERRORS OR OMISSIONS, NEGLIGENCE, ACCIDENT OR ANY OTHER CAUSE, FOR ANY LOSS OF DAMAGE, INCLUDING, WITHOUT LIMITATION, SPECIAL, INCIDENTAL CONSEQUENTIAL, OR EXEMPLARY DAMAGES. ANY LIABILITY ON THE PART OF ENVIRONMENTAL DATA RESOURCES, INC. IS STRICTLY LIMITED TO A REFUND OF THE AMOUNT PAID FOR THIS REPORT. Purchaser accepts this Report "AS IS". Any analyses, estimates, ratings, environmental risk levels or risk codes provided in this Report are provided for illustrative purposes only, and are not intended to provide, nor should they be interpreted as providing any facts regarding, or prediction or forecast of, any environmental risk for any property. Only a Phase I Environmental Site Assessment performed by an environmental professional can provide information regarding the environmental risk for any property. Additionally, the information provided in this Report is not to be construed as legal advice.

Copyright 2014 by Environmental Data Resources, Inc. All rights reserved. Reproduction in any media or format, in whole or in part, of any report or map of Environmental Data Resources, Inc., or its affiliates, is prohibited without prior written permission.

EDR and its logos (including Sanborn and Sanborn Map) are trademarks of Environmental Data Resources, Inc. or its affiliates. All other trademarks used herein are the property of their respective owners.

Sanborn Sheet Thumbnails

This Certified Sanborn Map Report is based upon the following Sanborn Fire Insurance map sheets.



1970 Source Sheets



Volume 3, Sheet 278

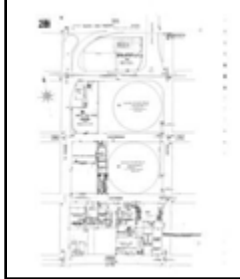

Volume 3, Sheet 281



Volume 3, Sheet 282

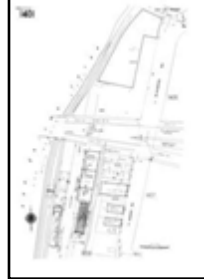

Volume 14, Sheet 1401

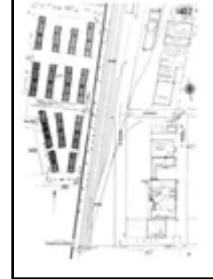

Volume 14, Sheet 1402

1968 Source Sheets



Volume 3, Sheet 278

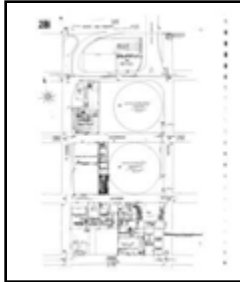

Volume 3, Sheet 281



Volume 3, Sheet 282

1965 Source Sheets



Volume 3, Sheet 278

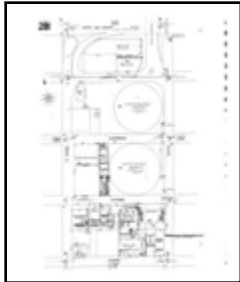

Volume 3, Sheet 281



Volume 3, Sheet 282

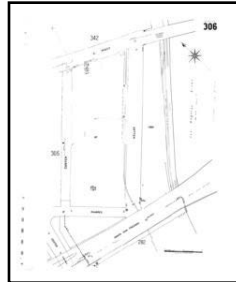

Volume 3, Sheet 306

1964 Source Sheets



Volume 3, Sheet 278

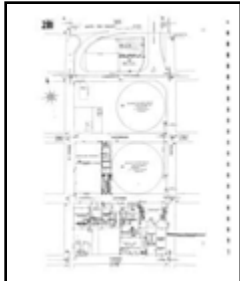

Volume 3, Sheet 281



Volume 3, Sheet 282

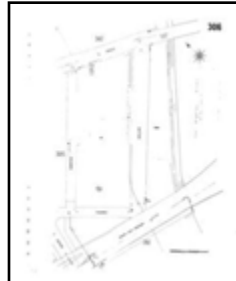

Volume 3, Sheet 306

1960 Source Sheets



Volume 3, Sheet 278



Volume 3, Sheet 281



Volume 3, Sheet 282

1957 Source Sheets



Volume 3, Sheet 278



Volume 3, Sheet 281

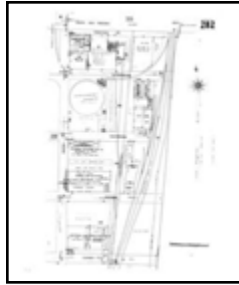

Volume 3, Sheet 282

1954 Source Sheets



Volume 3, Sheet 278

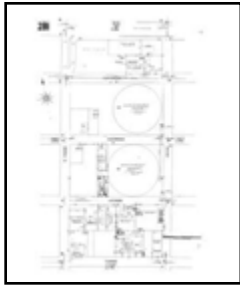

Volume 3, Sheet 281



Volume 3, Sheet 282

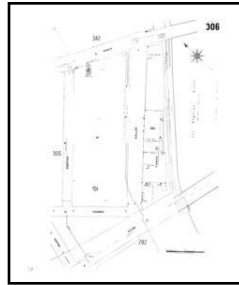

Volume 3, Sheet 306

1953 Source Sheets

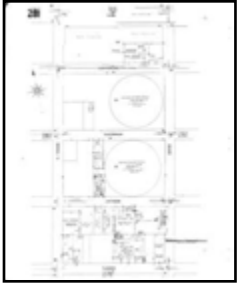

Volume 3, Sheet 281



Volume 3, Sheet 282

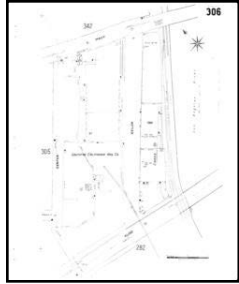

Volume 3, Sheet 306



Volume 3, Sheet 278

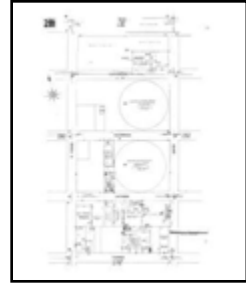

Volume 3, Sheet 281

Volume 3, Sheet 282

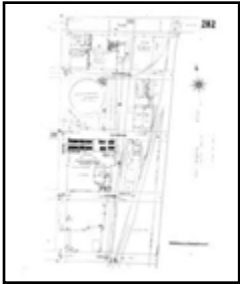

1950 Source Sheets

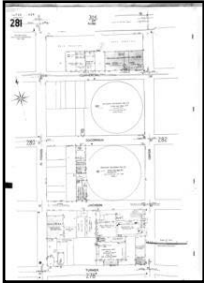

Volume 3, Sheet 281

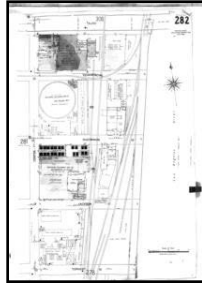

Volume 3, Sheet 282

1949 Source Sheets



Volume 14, Sheet 1401

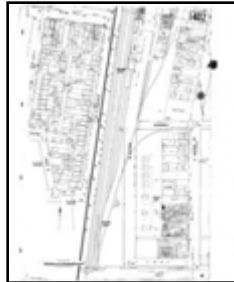

Volume 14, Sheet 1402

1921 Source Sheets



Volume 14, Sheet 1401

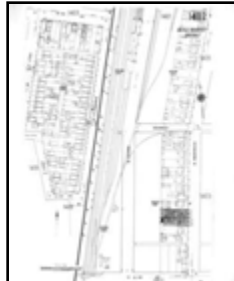

Volume 14, Sheet 1402

1920 Source Sheets



Volume Congested Business District, Sheet

1906 Source Sheets



Volume 4, Sheet 445



Volume 3, Sheet 281

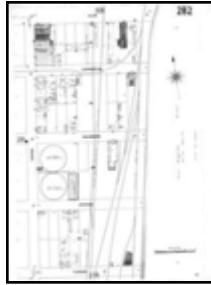

Volume 3, Sheet 282

1894 Source Sheets



Volume 2, Sheet 84



Volume 1, Sheet 28



Volume 1, Sheet 29



Volume 1, Sheet 29

1890 Source Sheets



Volume 2, Sheet 73

1888 Source Sheets



Volume 1, Sheet 13



Volume 1, Sheet 15



Volume 1, Sheet 15

1970 Certified Sanborn Map

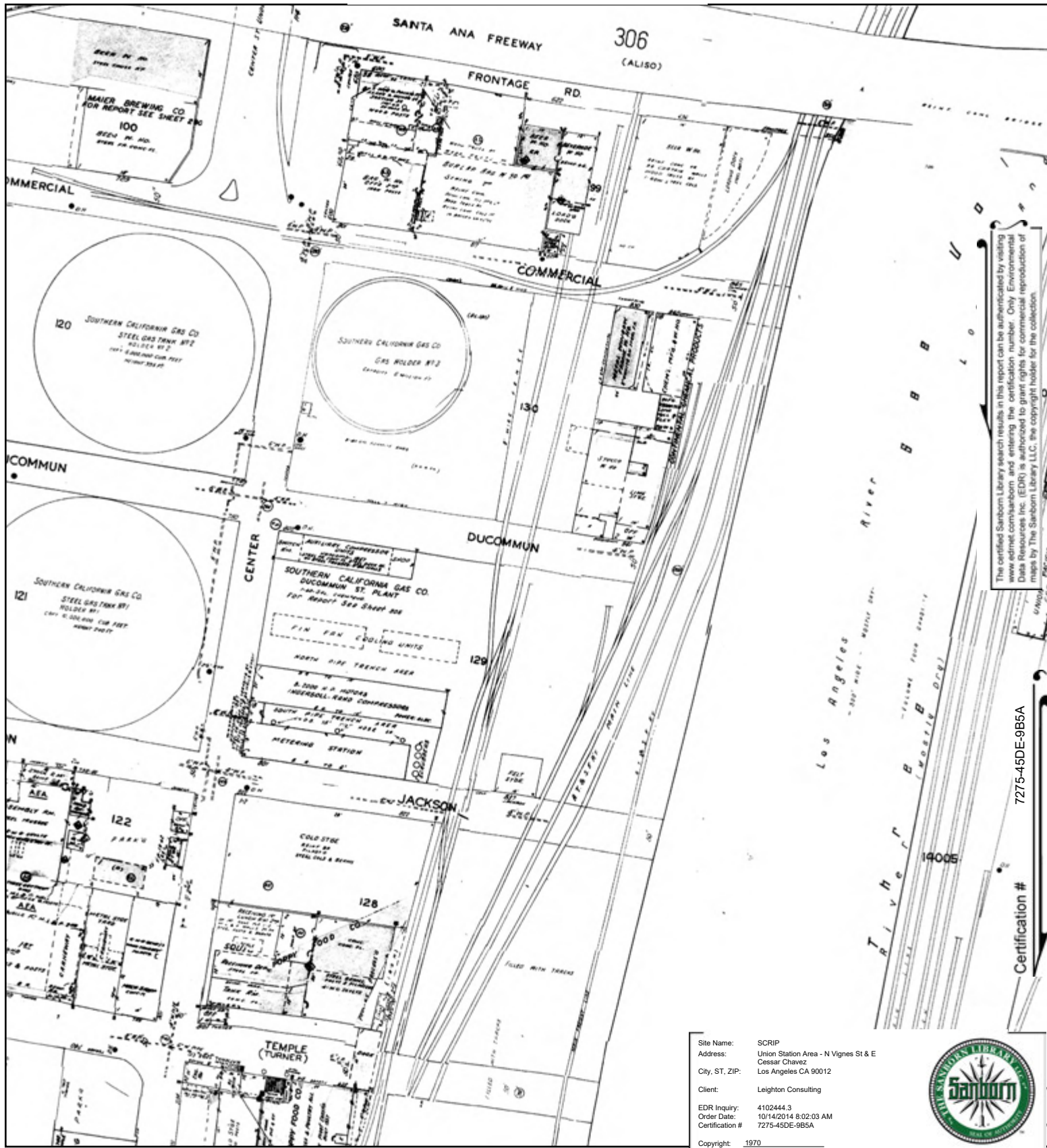

Site Name: SCRIP
 Address: Union Station Area - N Vignes St & E Cesar Chavez
 City, ST, ZIP: Los Angeles CA 90012
 Client: Leighton Consulting
 EDR Inquiry: 4102444.3
 Order Date: 10/14/2014 8:02:03 AM
 Certification #: 7275-45DE-9B5A
 Copyright: 1970



This Certified Sanborn Map combines the following sheets. Outlined areas indicate map sheets within the collection.

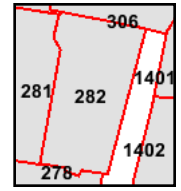
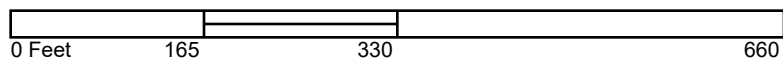

- Volume 3, Sheet 278
- Volume 3, Sheet 281
- Volume 3, Sheet 282
- Volume 14, Sheet 1401
- Volume 14, Sheet 1402



1968 Certified Sanborn Map

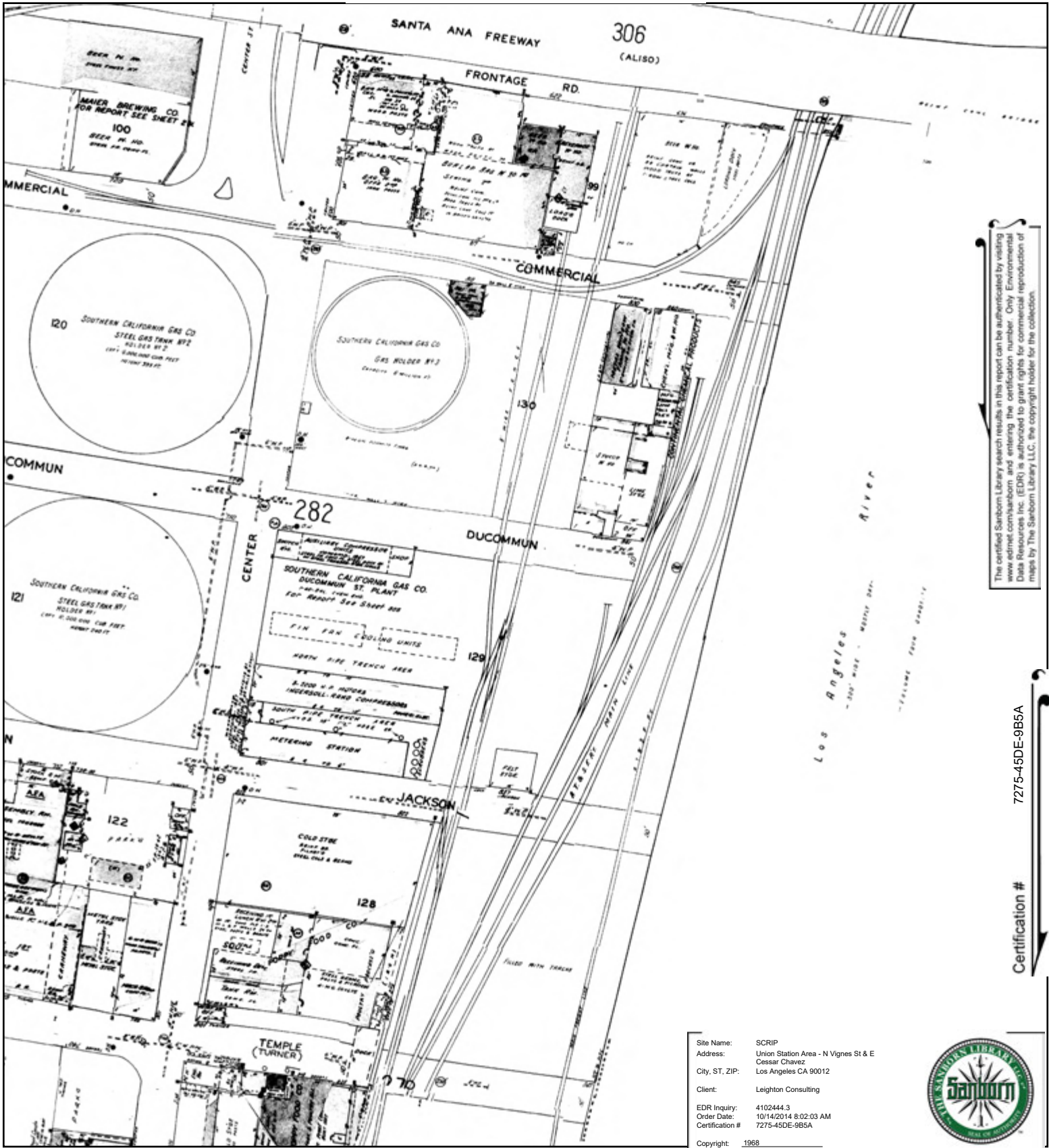

The certified Sanborn Library search results in this report can be authenticated by visiting www.edrnet.com/sanborn and entering the certification number. Only Environmental Data Resources Inc. (EDR) is authorized to grant rights for commercial reproduction of maps by The Sanborn Library LLC, the copyright holder for the collection.

7275-45DE-9B5A

Certification #



This Certified Sanborn Map combines the following sheets. Outlined areas indicate map sheets within the collection.

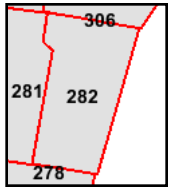
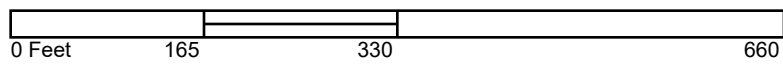

- Volume 3, Sheet 278
- Volume 3, Sheet 281
- Volume 3, Sheet 282



1965 Certified Sanborn Map

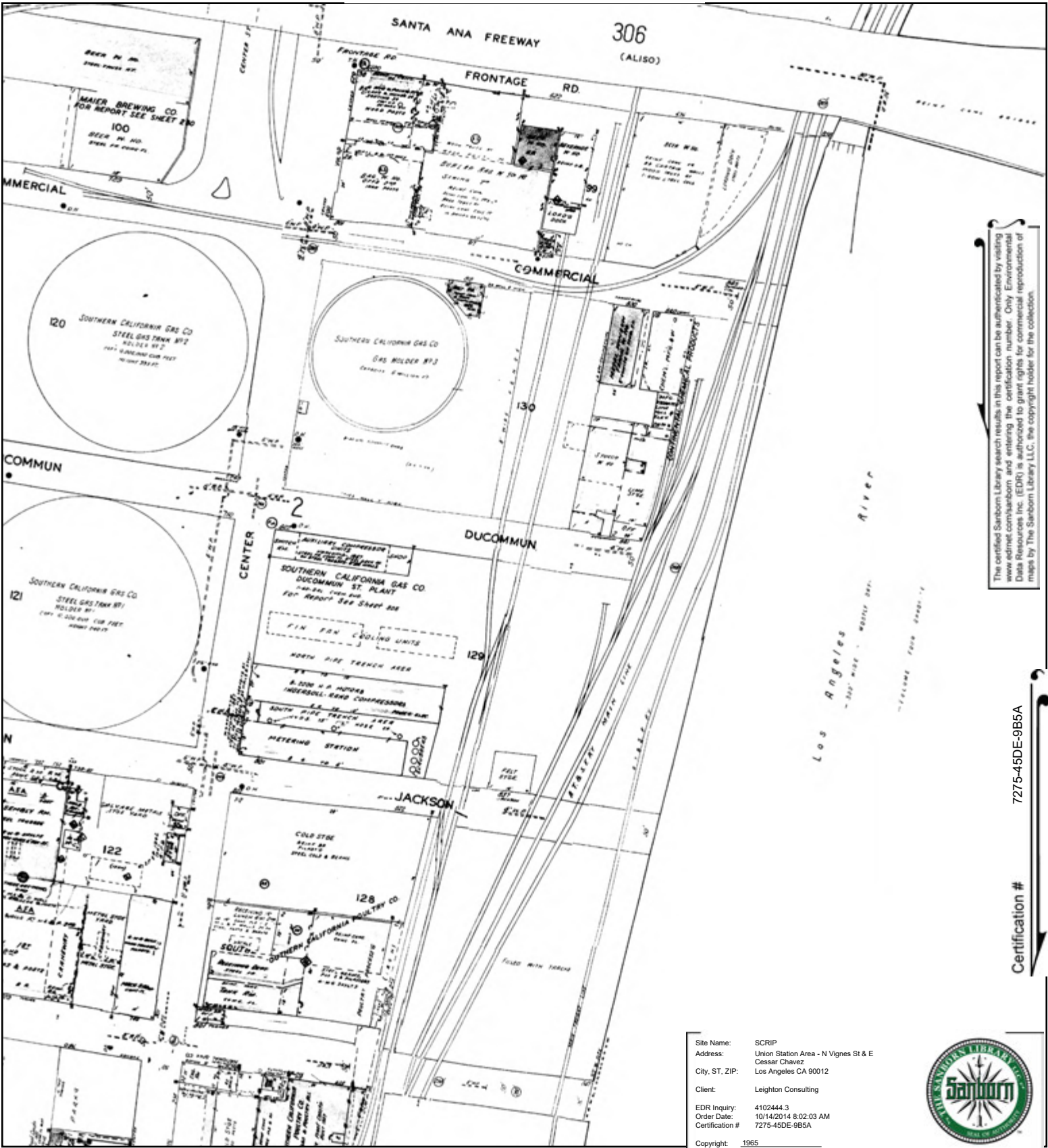

The certified Sanborn Library search results in this report can be authenticated by visiting www.edrnet.com/sanborn and entering the certification number. Only Environmental Data Resources Inc. (EDR) is authorized to grant rights for commercial reproduction of maps by The Sanborn Library LLC, the copyright holder for the collection.

7275-45DE-9B5A

Certification #

Site Name: SCRIP
 Address: Union Station Area - N Vignes St & E Cessar Chavez
 City, ST, ZIP: Los Angeles CA 90012
 Client: Leighton Consulting
 EDR Inquiry: 4102444.3
 Order Date: 10/14/2014 8:02:03 AM
 Certification #: 7275-45DE-9B5A
 Copyright: 1965



This Certified Sanborn Map combines the following sheets. Outlined areas indicate map sheets within the collection.

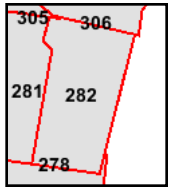
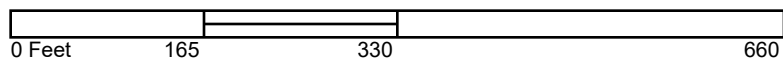

- Volume 3, Sheet 278
- Volume 3, Sheet 281
- Volume 3, Sheet 282
- Volume 3, Sheet 306



1964 Certified Sanborn Map

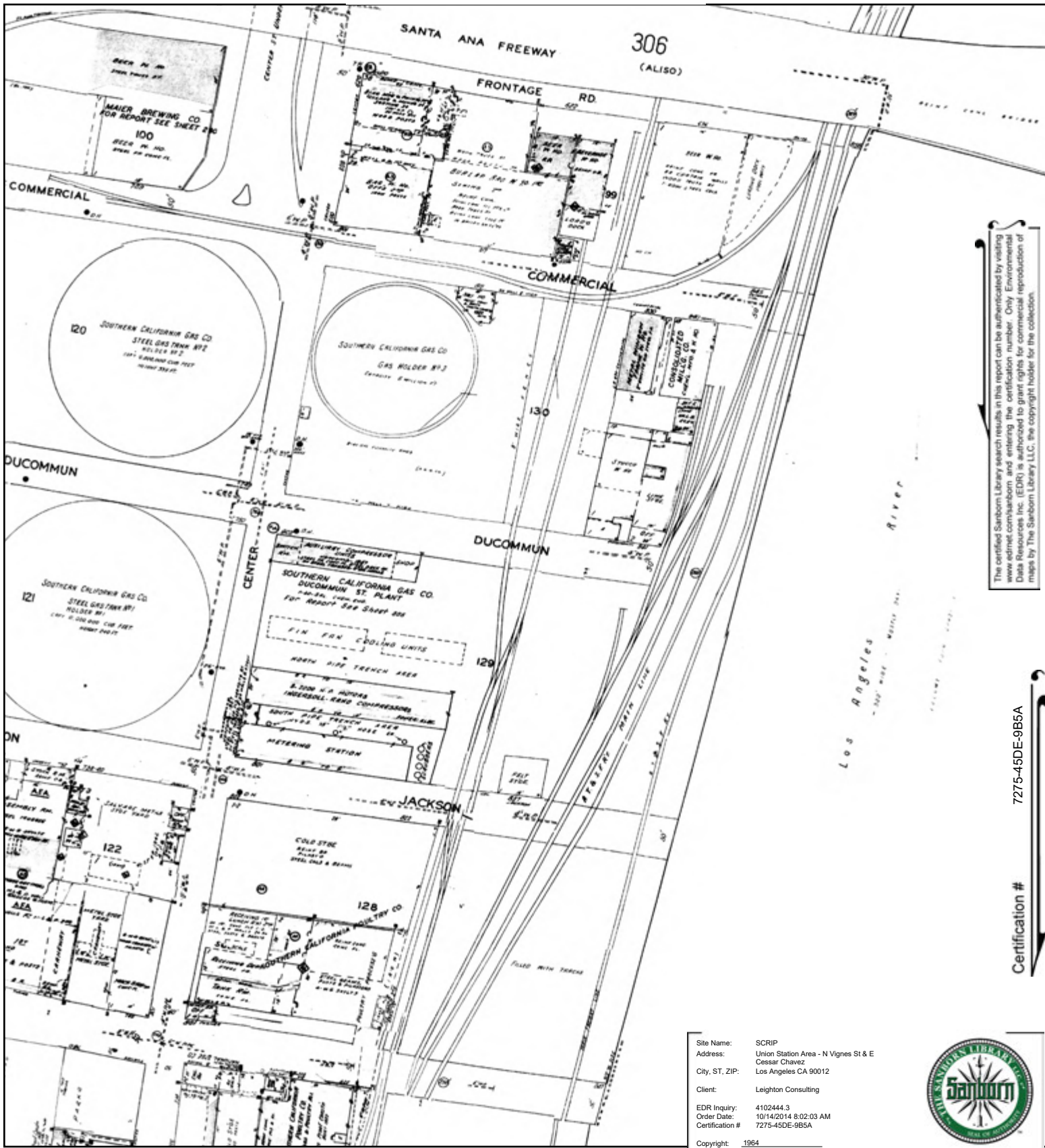

This certified Sanborn Library search results in this report can be authenticated by visiting www.edrnet.com/sanborn and entering the certification number. Only Environmental Data Resources Inc. (EDR) is authorized to grant rights for commercial reproduction of maps by The Sanborn Library LLC, the copyright holder for the collection.

7275-45DE-9B5A

Certification #

Site Name: SCRIP
 Address: Union Station Area - N Vignes St & E Cesar Chavez
 City, ST, ZIP: Los Angeles CA 90012
 Client: Leighton Consulting
 EDR Inquiry: 4102444.3
 Order Date: 10/14/2014 8:02:03 AM
 Certification #: 7275-45DE-9B5A
 Copyright: 1964



This Certified Sanborn Map combines the following sheets. Outlined areas indicate map sheets within the collection.

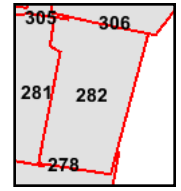
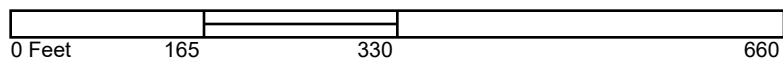

- Volume 3, Sheet 278
- Volume 3, Sheet 281
- Volume 3, Sheet 282
- Volume 3, Sheet 306



1960 Certified Sanborn Map

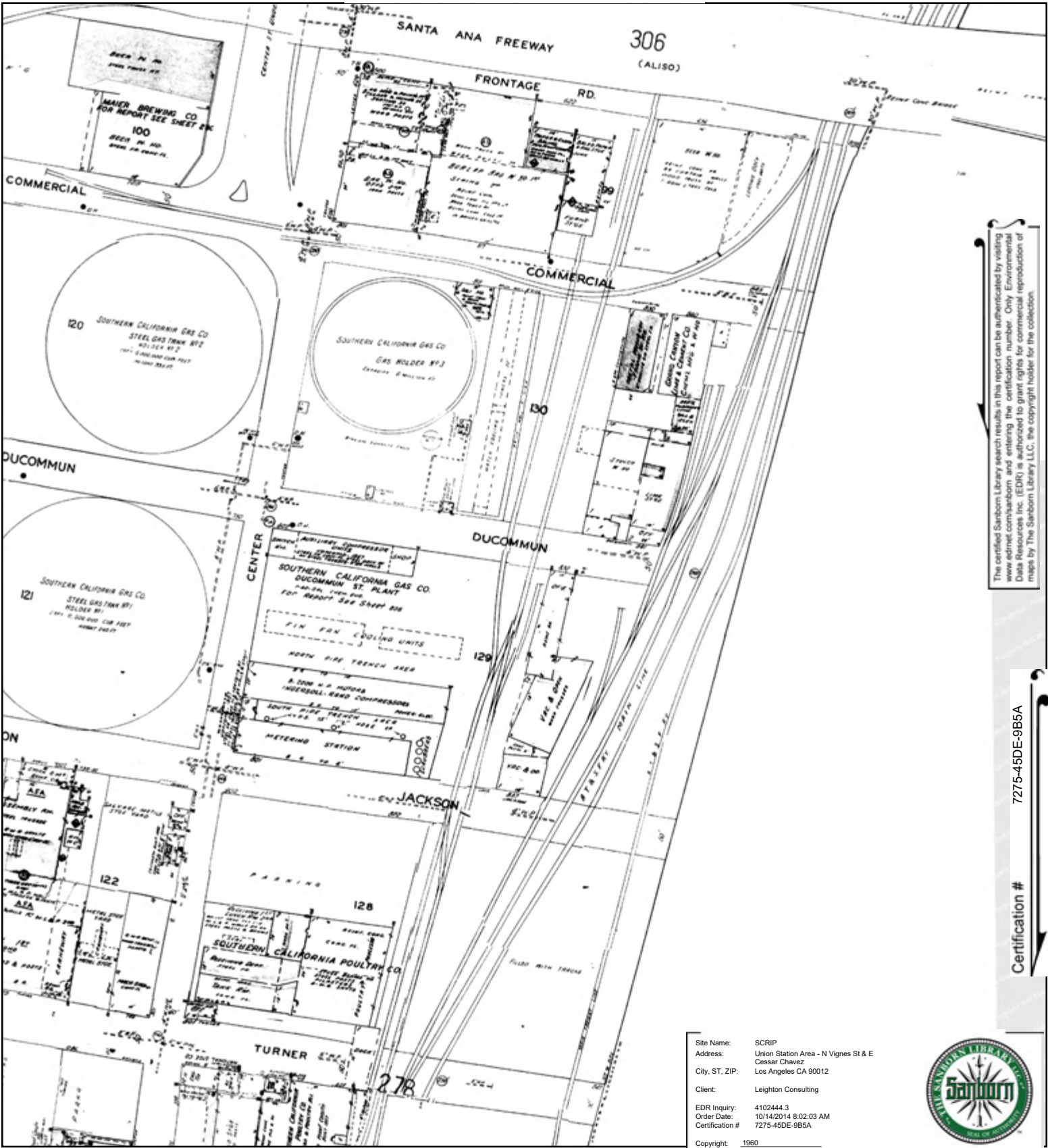

This certified Sanborn Library search results in this report can be authenticated by visiting www.edrnet.com/sanborn and entering the certification number. Only Environmental Data Resources Inc. (EDR) is authorized to grant rights for commercial reproduction of maps by The Sanborn Library LLC, the copyright holder for the collection.

7275-45DE-9B5A

Certification #



This Certified Sanborn Map combines the following sheets. Outlined areas indicate map sheets within the collection.

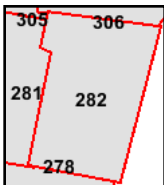
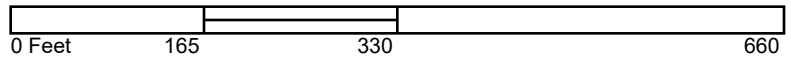

- Volume 3, Sheet 278
- Volume 3, Sheet 281
- Volume 3, Sheet 282



1957 Certified Sanborn Map

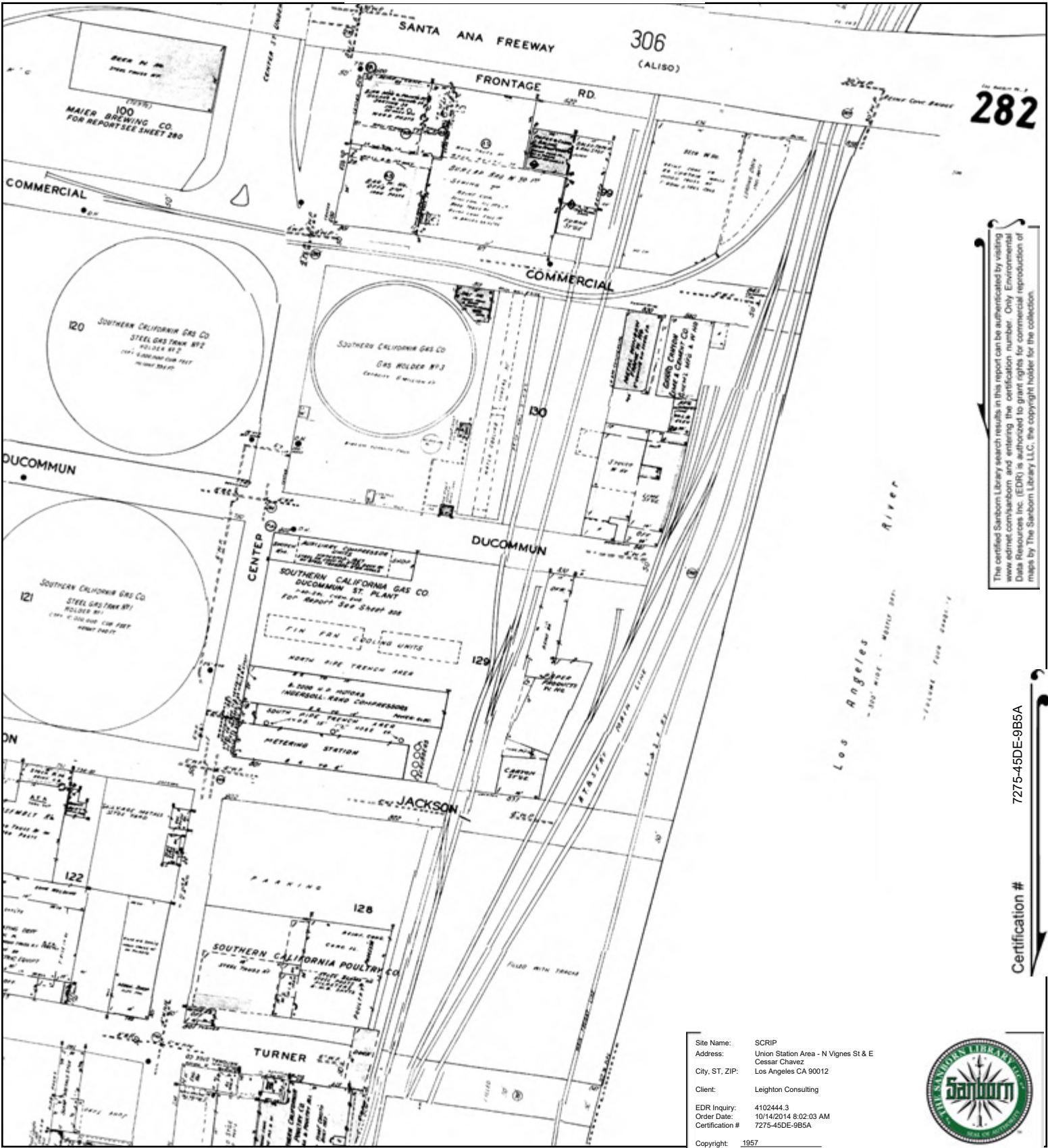

The certified Sanborn Library search results in this report can be authenticated by visiting www.edrnet.com/sanborn and entering the certification number. Only Environmental Data Resources Inc. (EDR) is authorized to grant rights for commercial reproduction of maps by The Sanborn Library LLC, the copyright holder for the collection.

7275-45DE-9B5A

Certification #

This Certified Sanborn Map combines the following sheets. Outlined areas indicate map sheets within the collection.

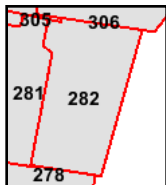

Volume 3, Sheet 278
 Volume 3, Sheet 281
 Volume 3, Sheet 282

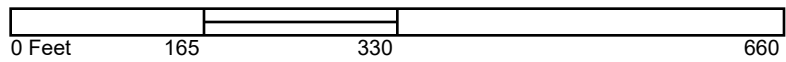

1954 Certified Sanborn Map

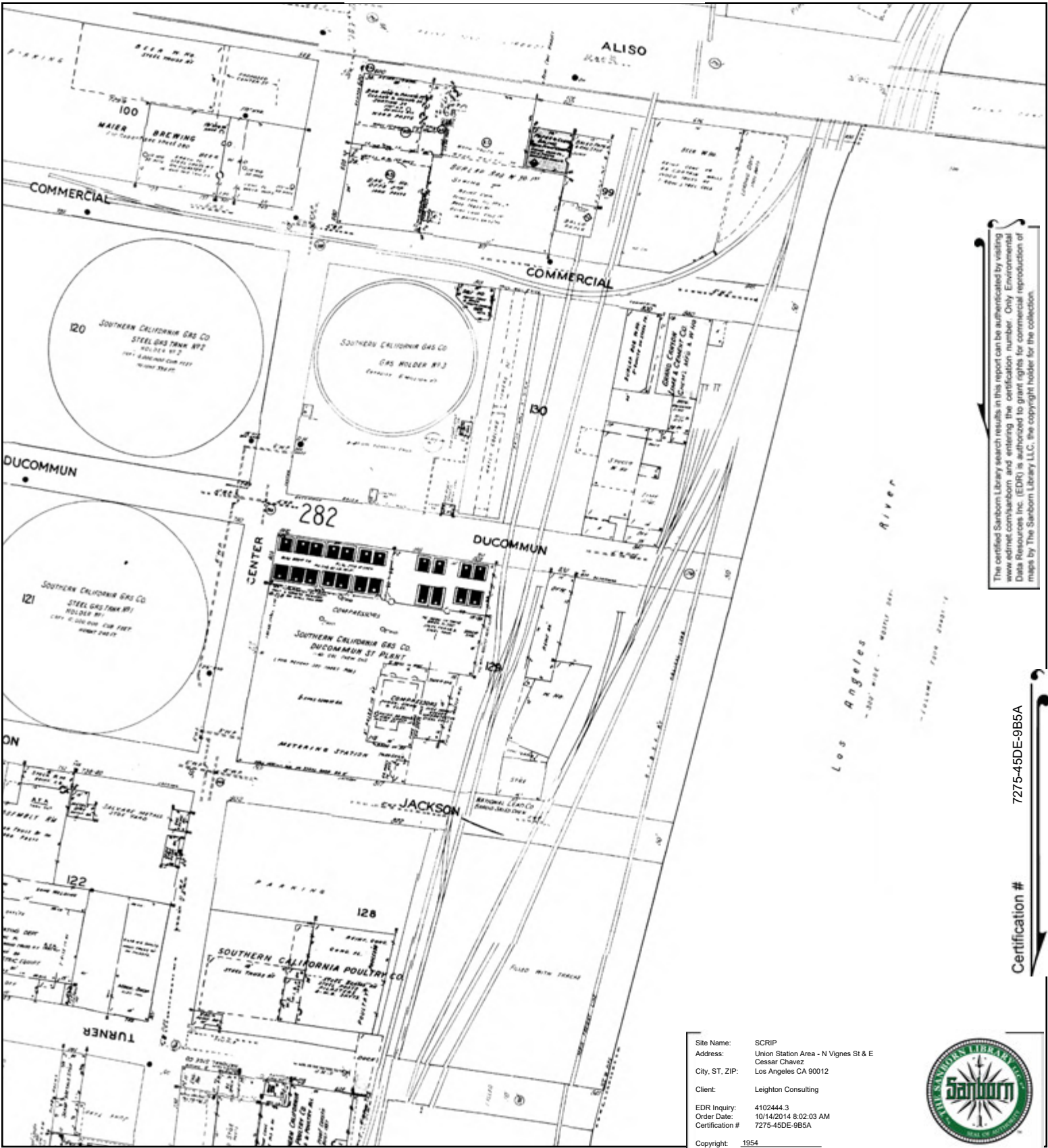

This certified Sanborn Library search results in this report can be authenticated by visiting www.edrinc.com/sanborn and entering the certification number. Only Environmental Data Resources Inc. (EDR) is authorized to grant rights for commercial reproduction of maps by The Sanborn Library LLC, the copyright holder for the collection.

Certification # 7275-45DE-9B5A

Site Name: SCRIP
 Address: Union Station Area - N Vignes St & E Cesar Chavez
 City, ST, ZIP: Los Angeles CA 90012
 Client: Leighton Consulting
 EDR Inquiry: 4102444.3
 Order Date: 10/14/2014 8:02:03 AM
 Certification #: 7275-45DE-9B5A
 Copyright: 1954



This Certified Sanborn Map combines the following sheets. Outlined areas indicate map sheets within the collection.

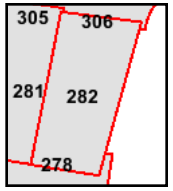

- Volume 3, Sheet 278
- Volume 3, Sheet 281
- Volume 3, Sheet 282
- Volume 3, Sheet 306

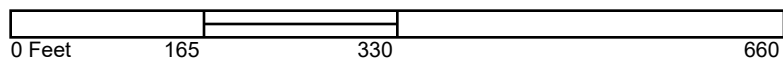

1953 Certified Sanborn Map

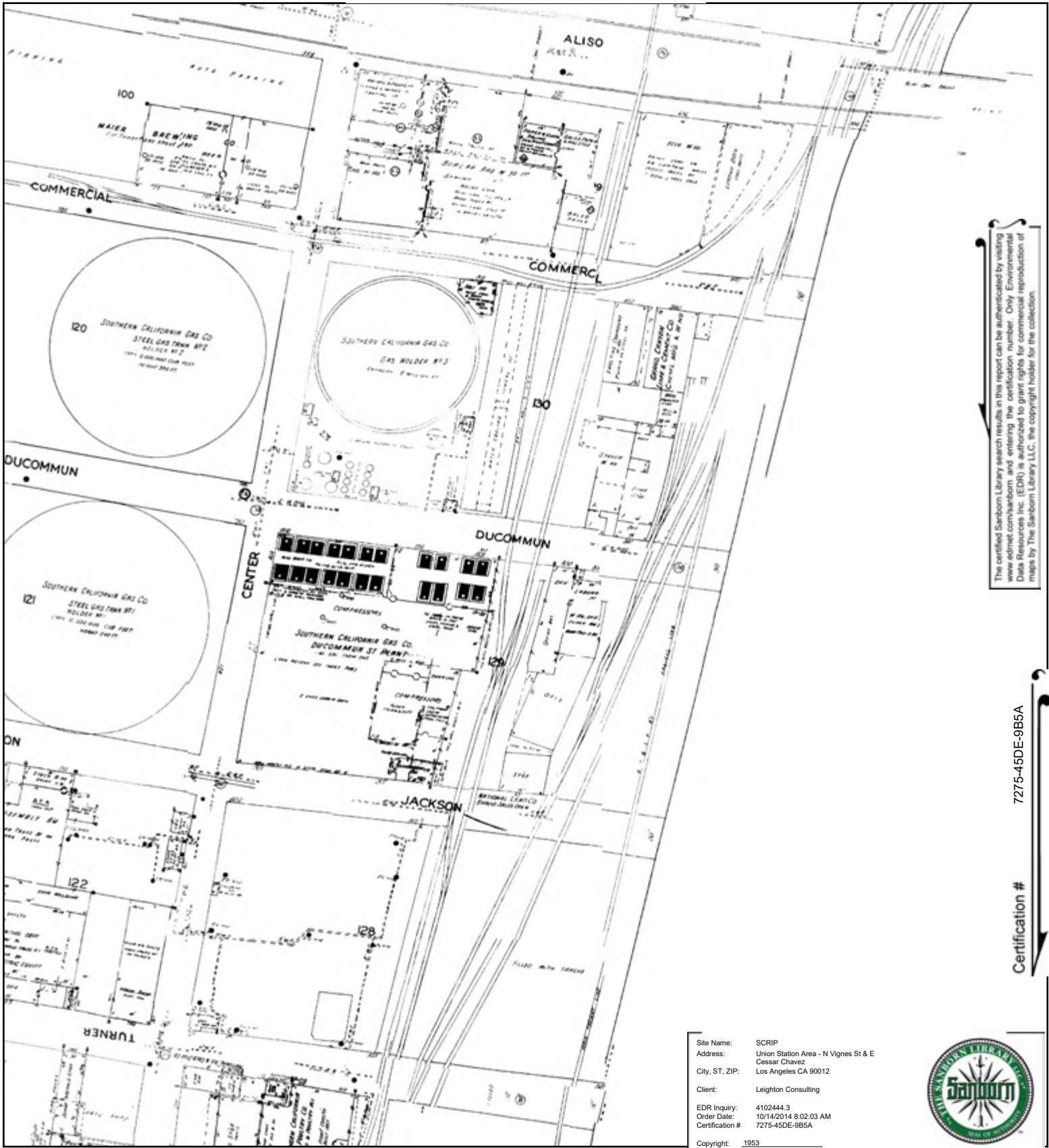

This certified Sanborn Library search results in this report can be authenticated by visiting www.edrnet.com/sanborn and entering the certification number. Only Environmental Data Resources Inc. (EDR) is authorized to grant rights for commercial reproduction of maps by The Sanborn Library LLC, the copyright holder for the collection.

7275-45DE-9B5A

Certification #

This Certified Sanborn Map combines the following sheets. Outlined areas indicate map sheets within the collection.

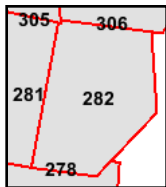

- Volume 3, Sheet 281
- Volume 3, Sheet 282
- Volume 3, Sheet 306
- Volume 3, Sheet 278
- Volume 3, Sheet 281

1950 Certified Sanborn Map

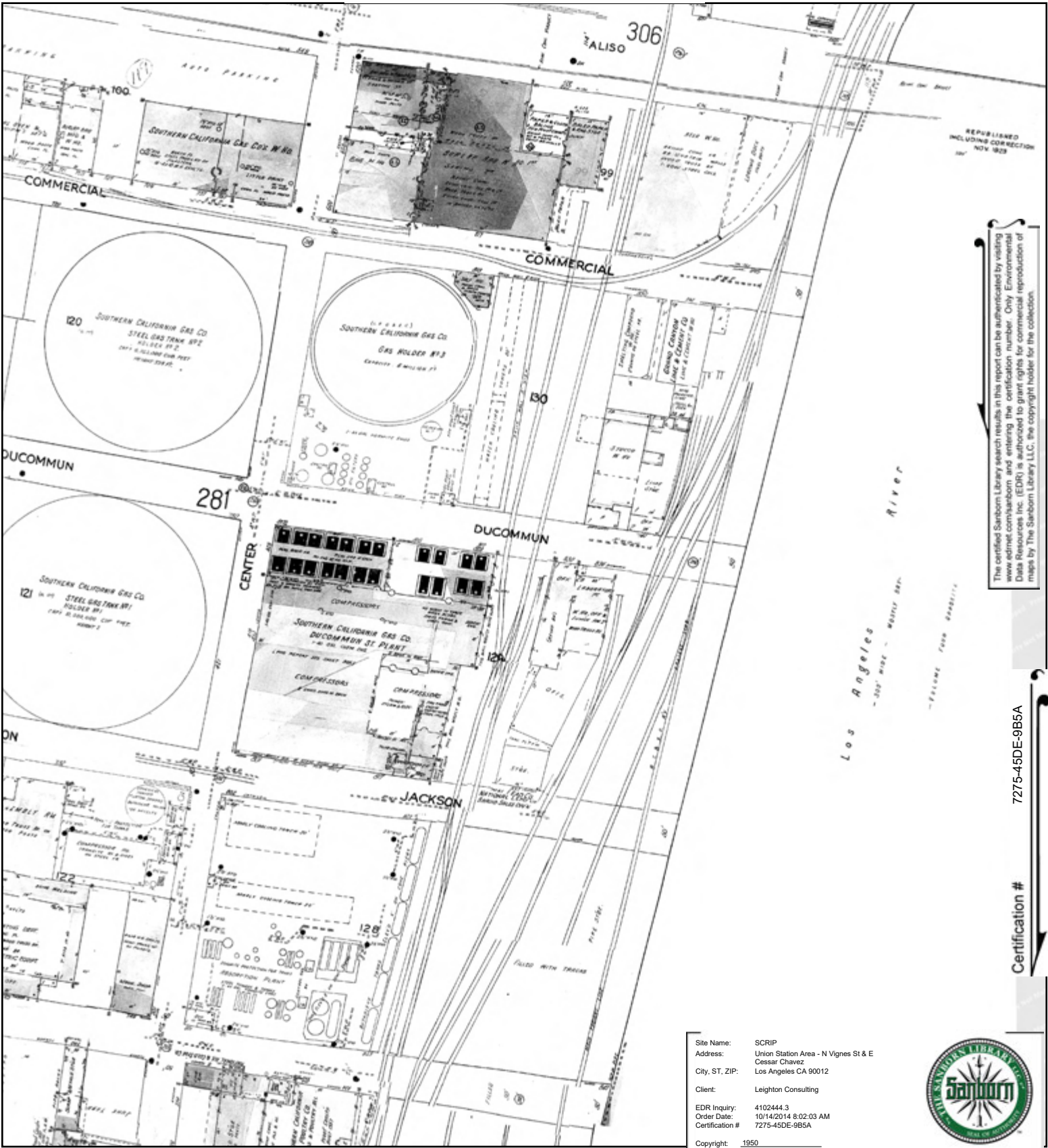

REPRINTED INCLUDING CORRECTION NOV. 1923

The certified Sanborn Library search results in this report can be authenticated by visiting www.edrnet.com/sanborn and entering the certification number. Only Environmental Data Resources Inc. (EDR) is authorized to grant rights for commercial reproduction of maps by The Sanborn Library LLC, the copyright holder for the collection.

7275-45DE-9B5A

Certification #

Site Name: SCRIP
 Address: Union Station Area - N Vignes St & E Cesar Chavez
 City, ST, ZIP: Los Angeles CA 90012
 Client: Leighton Consulting
 EDR Inquiry: 4102444.3
 Order Date: 10/14/2014 8:02:03 AM
 Certification #: 7275-45DE-9B5A
 Copyright: 1950



This Certified Sanborn Map combines the following sheets. Outlined areas indicate map sheets within the collection.

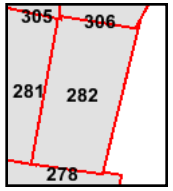
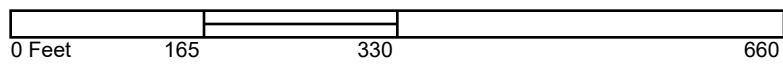

Volume 3, Sheet 381
 Volume 3, Sheet 282



1949 Certified Sanborn Map

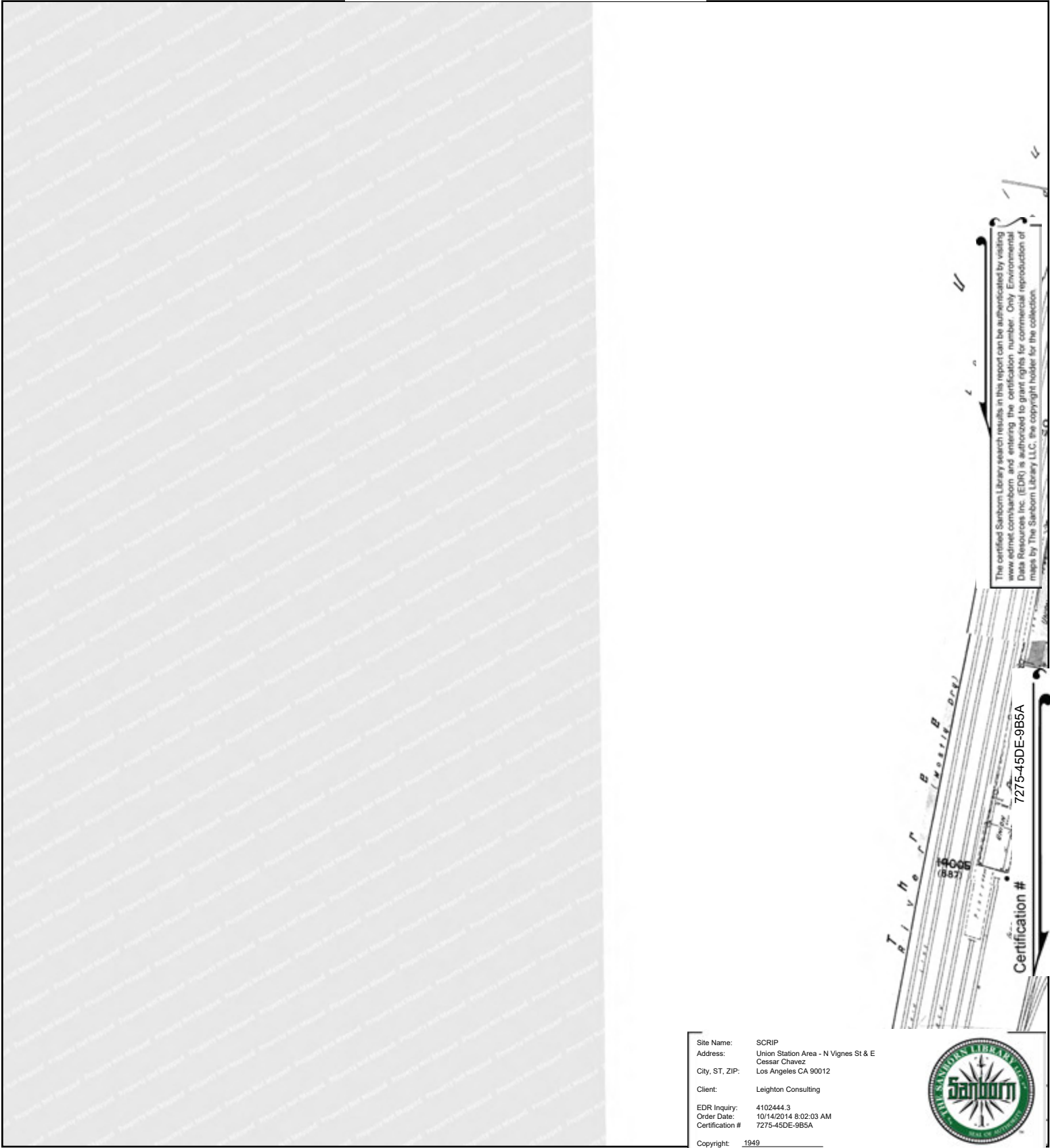

The certified Sanborn Library search results in this report can be authenticated by visiting www.edrnet.com/sanborn and entering the certification number. Only Environmental Data Resources Inc. (EDR) is authorized to grant rights for commercial reproduction of maps by The Sanborn Library LLC, the copyright holder for the collection.

Site Name: SCRIP
 Address: Union Station Area - N Vignes St & E Cessar Chavez
 City, ST, ZIP: Los Angeles CA 90012
 Client: Leighton Consulting
 EDR Inquiry: 4102444.3
 Order Date: 10/14/2014 8:02:03 AM
 Certification #: 7275-45DE-9B5A
 Copyright: 1949



This Certified Sanborn Map combines the following sheets.
 Outlined areas indicate map sheets within the collection.

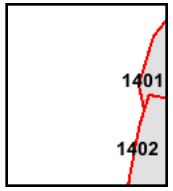

Volume 14, Sheet 1401
 Volume 14, Sheet 1402

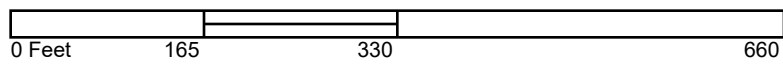

1921 Certified Sanborn Map

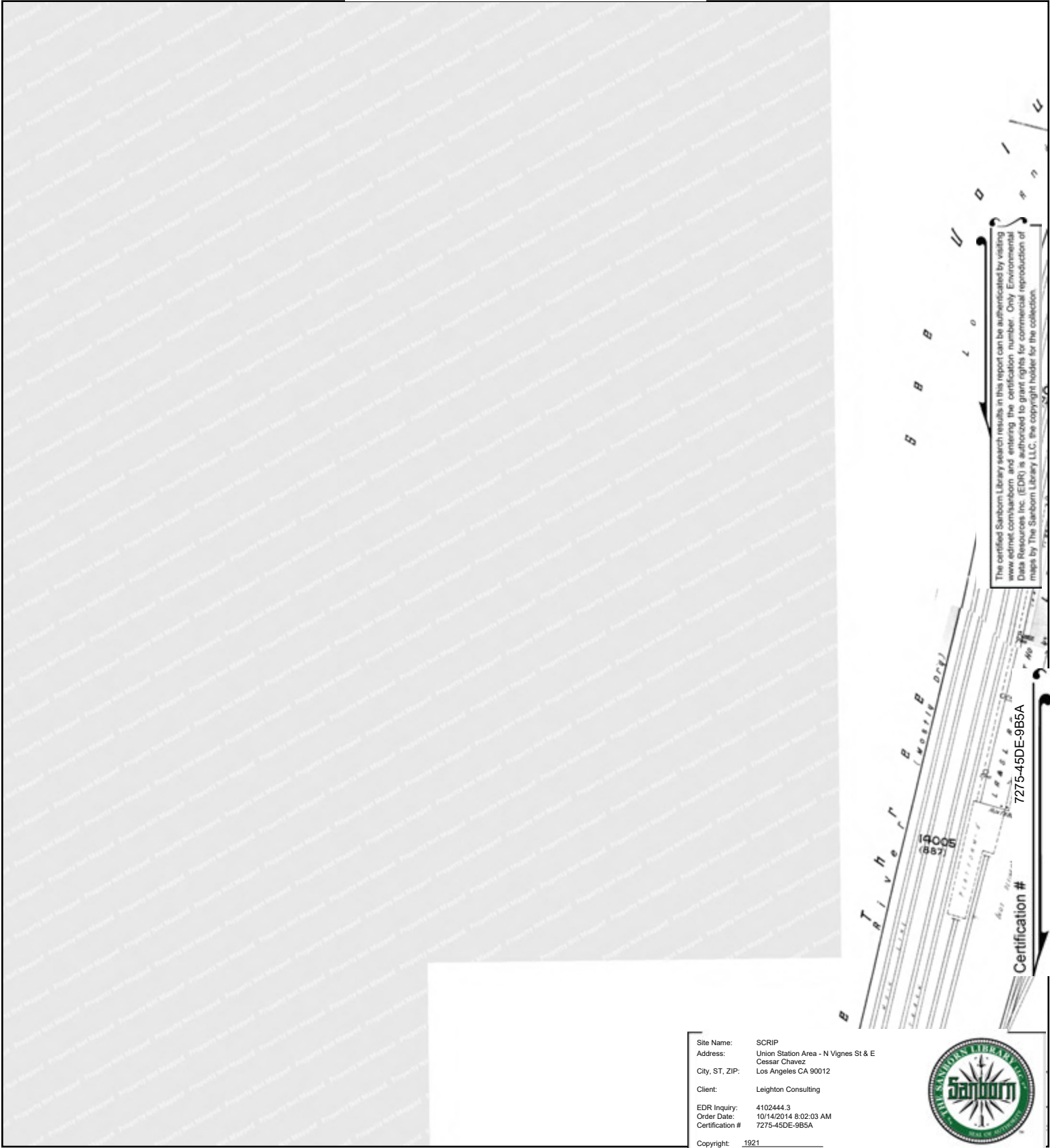

The certified Sanborn Library search results in this report can be authenticated by visiting www.edrnet.com/sanborn and entering the certification number. Only Environmental Data Resources Inc. (EDR) is authorized to grant rights for commercial reproduction of maps by The Sanborn Library LLC, the copyright holder for the collection.

Site Name: SCRIP
 Address: Union Station Area - N Vignes St & E
 Cesar Chavez
 City, ST, ZIP: Los Angeles CA 90012
 Client: Leighton Consulting
 EDR Inquiry: 4102444.3
 Order Date: 10/14/2014 8:02:03 AM
 Certification #: 7275-45DE-9B5A
 Copyright: 1921



This Certified Sanborn Map combines the following sheets.
 Outlined areas indicate map sheets within the collection.

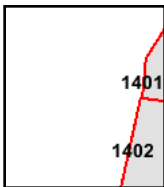
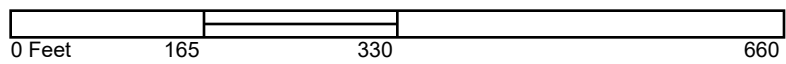

Volume 14, Sheet 1401
 Volume 14, Sheet 1402



1920 Certified Sanborn Map

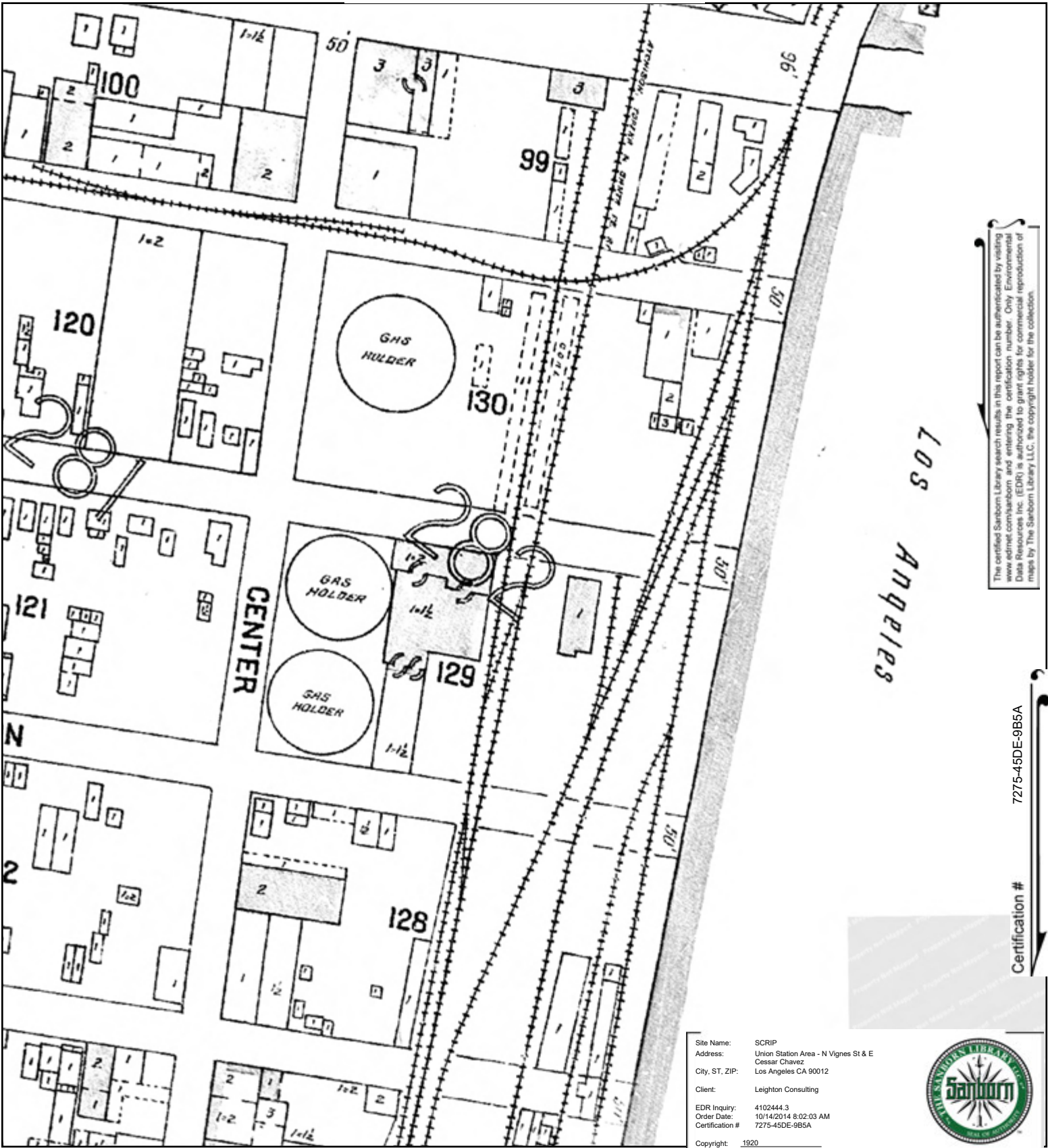

This certified Sanborn Library search results in this report can be authenticated by visiting www.edrnet.com/sanborn and entering the certification number. Only Environmental Data Resources Inc. (EDR) is authorized to grant rights for commercial reproduction of maps by The Sanborn Library LLC, the copyright holder for the collection.

7275-45DE-9B5A

Certification #



1906 Certified Sanborn Map

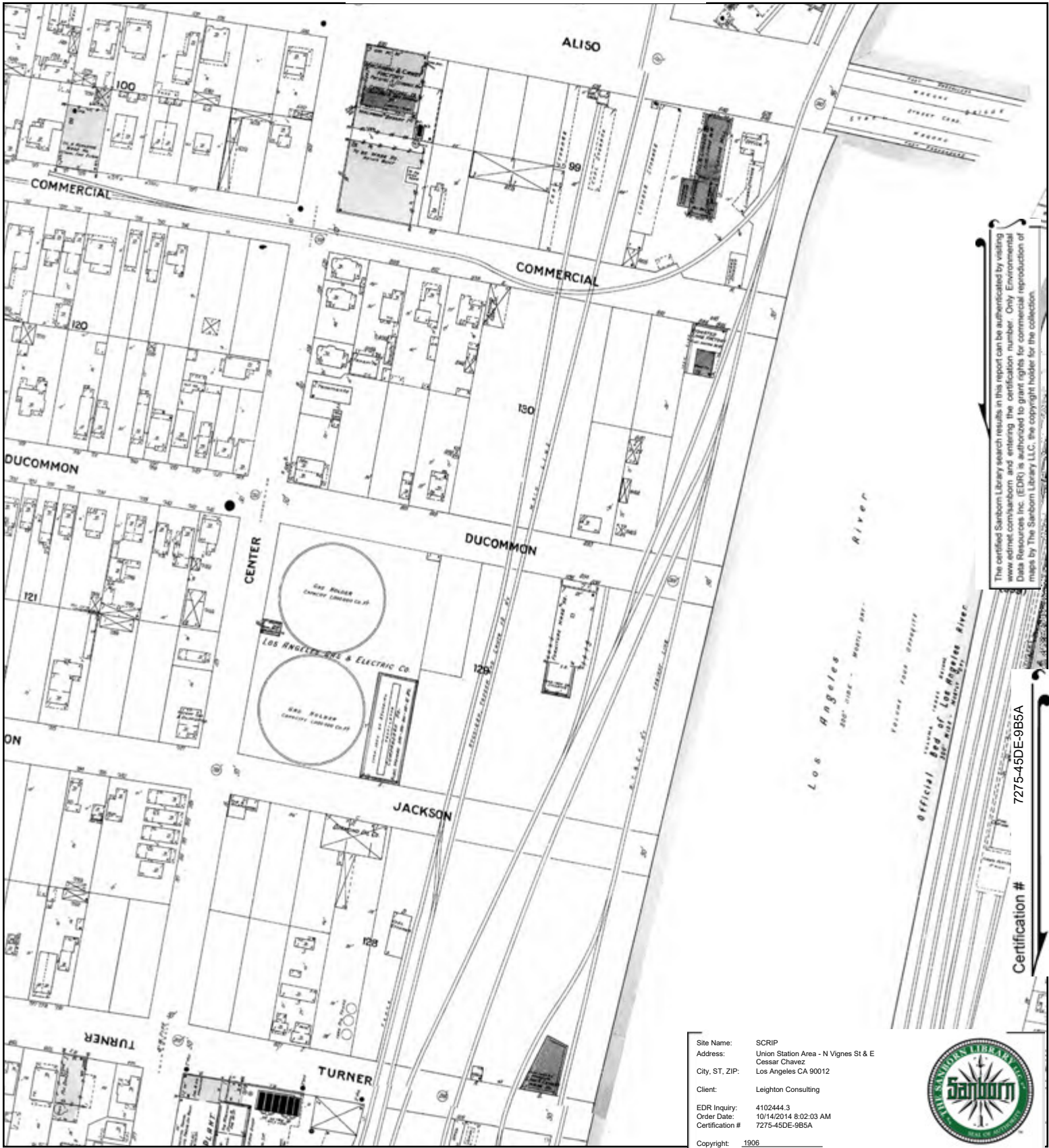

This certified Sanborn Library search results in this report can be authenticated by visiting www.edrnet.com/sanborn and entering the certification number. Only Environmental Data Resources Inc. (EDR) is authorized to grant rights for commercial reproduction of maps by The Sanborn Library LLC, the copyright holder for the collection.

7275-45DE-9B5A

Certification #

Site Name: SCRIP
 Address: Union Station Area - N Vignes St & E Cesar Chavez
 City, ST, ZIP: Los Angeles CA 90012
 Client: Leighton Consulting
 EDR Inquiry: 4102444.3
 Order Date: 10/14/2014 8:02:03 AM
 Certification #: 7275-45DE-9B5A
 Copyright: 1906



This Certified Sanborn Map combines the following sheets. Outlined areas indicate map sheets within the collection.

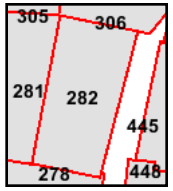
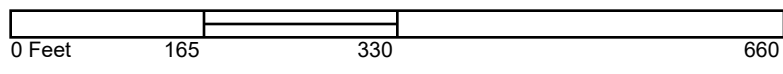

Volume 4, Sheet 445
 Volume 3, Sheet 281
 Volume 3, Sheet 282



1894 Certified Sanborn Map

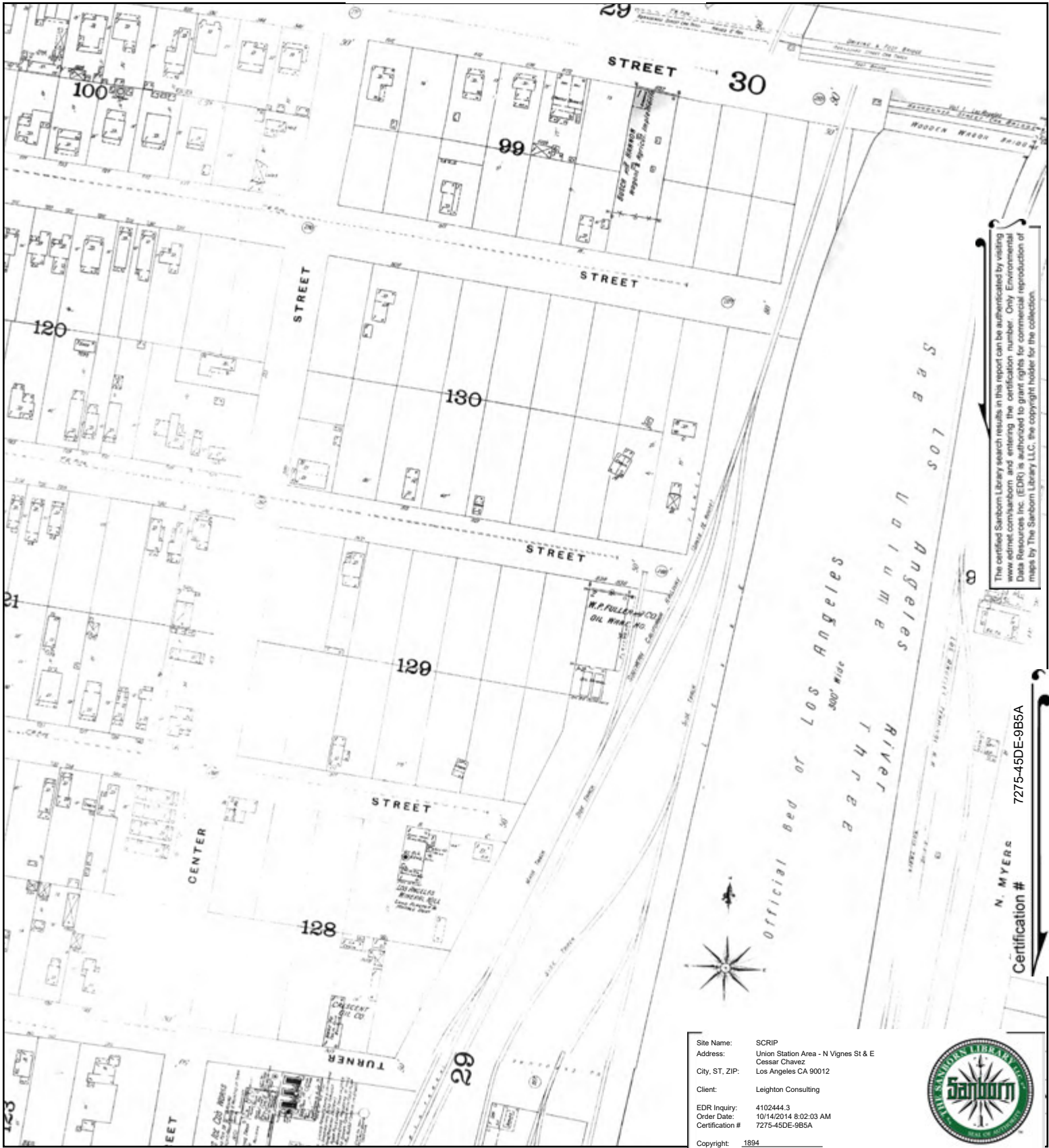

This Certified Sanborn Map combines the following sheets. Outlined areas indicate map sheets within the collection.

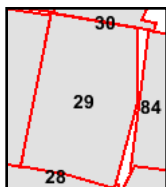

- Volume 2, Sheet 84
- Volume 1, Sheet 28
- Volume 1, Sheet 29
- Volume 1, Sheet 29

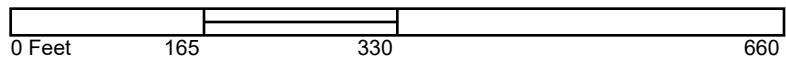

1890 Certified Sanborn Map

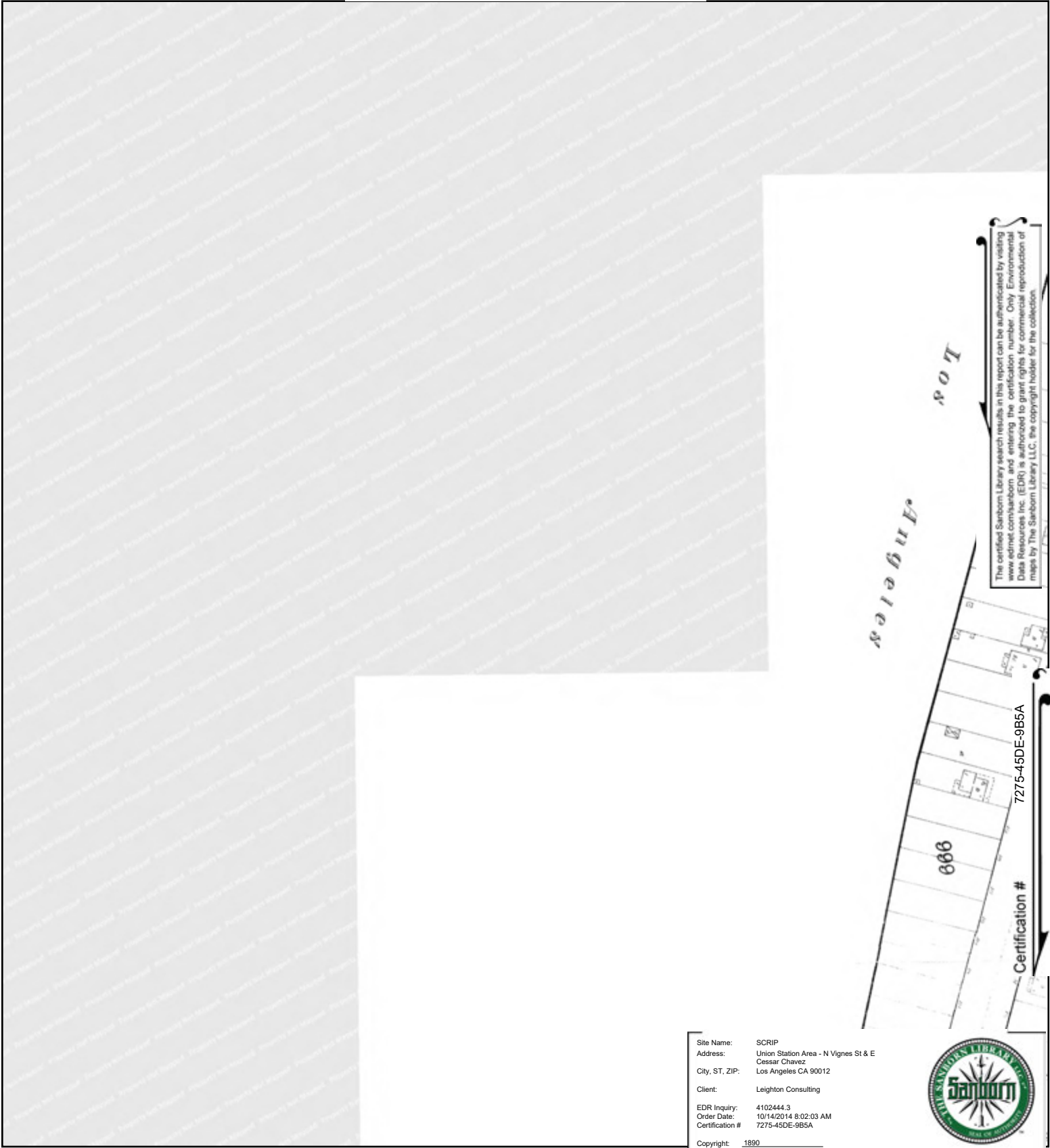

Site Name:	SCRIP
Address:	Union Station Area - N Vignes St & E Cesar Chavez
City, ST, ZIP:	Los Angeles CA 90012
Client:	Leighton Consulting
EDR Inquiry:	4102444.3
Order Date:	10/14/2014 8:02:03 AM
Certification #	7275-45DE-9B5A
Copyright:	1890



This Certified Sanborn Map combines the following sheets.
Outlined areas indicate map sheets within the collection.

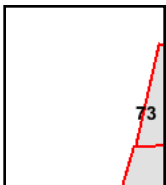
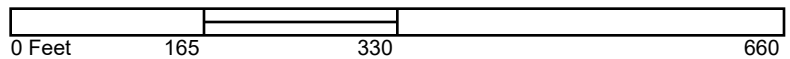

Volume 2, Sheet 73



1888 Certified Sanborn Map



The certified Sanborn Library search results in this report can be authenticated by visiting www.edrnet.com/sanborn and entering the certification number. Only Environmental Data Resources Inc. (EDR) is authorized to grant rights for commercial reproduction of maps by The Sanborn Library LLC, the copyright holder for the collection.



Certification # 7275-45DE-9B5A

Site Name: SCRIIP
 Address: Union Station Area - N Vignes St & E Cesar Chavez
 City, ST, ZIP: Los Angeles CA 90012
 Client: Leighton Consulting
 EDR Inquiry: 4102444.3
 Order Date: 10/14/2014 8:02:03 AM
 Certification # 7275-45DE-9B5A
 Copyright: 1888



This Certified Sanborn Map combines the following sheets. Outlined areas indicate map sheets within the collection.

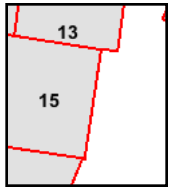
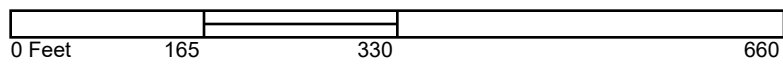

Volume 1, Sheet 13
 Volume 1, Sheet 15
 Volume 1, Sheet 15





SCRIP

Union Station Area - N Vignes St & E Cesar Chavez
Los Angeles, CA 90012

Inquiry Number: 4102444.3

October 14, 2014

Certified Sanborn® Map Report



6 Armstrong Road, 4th Floor
Shelton, Connecticut 06484
Toll Free: 800.352.0050
www.edrnet.com

Certified Sanborn® Map Report

10/14/14

Site Name:

SCRIP

Union Station Area - N Vignes

Los Angeles, CA 90012

EDR Inquiry # 4102444.3

Client Name:

Leighton Consulting

17781 Cowan

Irvine, CA 92614

Contact: Meredith Church



The Sanborn Library has been searched by EDR and maps covering the target property location as provided by Leighton Consulting were identified for the years listed below. The Sanborn Library is the largest, most complete collection of fire insurance maps. The collection includes maps from Sanborn, Bromley, Perris & Browne, Hopkins, Barlow, and others. Only Environmental Data Resources Inc. (EDR) is authorized to grant rights for commercial reproduction of maps by the Sanborn Library LLC, the copyright holder for the collection. Results can be authenticated by visiting www.edrnet.com/sanborn.

The Sanborn Library is continually enhanced with newly identified map archives. This report accesses all maps in the collection as of the day this report was generated.

Certified Sanborn Results:

Site Name:

SCRIP

Address:

Union Station Area - N Vignes St & E Cessar

City, State, Zip:

Los Angeles, CA 90012

Cross Street:**P.O. #**

10842.001

Project:

SCRIP

Certification #

7275-45DE-9B5A

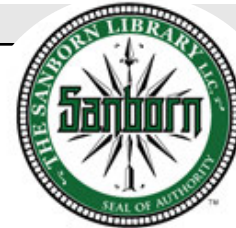

Sanborn® Library search results
Certification # 7275-45DE-9B5A

Maps Provided:

1970	1959	1906
1968	1957	1894
1967	1954	1888
1965	1953	
1964	1950	
1960	1920	

The Sanborn Library includes more than 1.2 million fire insurance maps from Sanborn, Bromley, Perris & Browne, Hopkins, Barlow and others which track historical property usage in approximately 12,000 American cities and towns. Collections searched:

- Library of Congress
- University Publications of America
- EDR Private Collection

The Sanborn Library LLC Since 1866™

Limited Permission To Make Copies

Leighton Consulting (the client) is permitted to make up to FIVE photocopies of this Sanborn Map transmittal and each fire insurance map accompanying this report solely for the limited use of its customer. No one other than the client is authorized to make copies. Upon request made directly to an EDR Account Executive, the client may be permitted to make a limited number of additional photocopies. This permission is conditioned upon compliance by the client, its customer and their agents with EDR's copyright policy; a copy of which is available upon request.

Disclaimer - Copyright and Trademark notice

This Report contains certain information obtained from a variety of public and other sources reasonably available to Environmental Data Resources, Inc. It cannot be concluded from this Report that coverage information for the target and surrounding properties does not exist from other sources. NO WARRANTY EXPRESSED OR IMPLIED, IS MADE WHATSOEVER IN CONNECTION WITH THIS REPORT. ENVIRONMENTAL DATA RESOURCES, INC. SPECIFICALLY DISCLAIMS THE MAKING OF ANY SUCH WARRANTIES, INCLUDING WITHOUT LIMITATION, MERCHANTABILITY OR FITNESS FOR A PARTICULAR USE OR PURPOSE. ALL RISK IS ASSUMED BY THE USER. IN NO EVENT SHALL ENVIRONMENTAL DATA RESOURCES, INC. BE LIABLE TO ANYONE, WHETHER ARISING OUT OF ERRORS OR OMISSIONS, NEGLIGENCE, ACCIDENT OR ANY OTHER CAUSE, FOR ANY LOSS OF DAMAGE, INCLUDING, WITHOUT LIMITATION, SPECIAL, INCIDENTAL CONSEQUENTIAL, OR EXEMPLARY DAMAGES. ANY LIABILITY ON THE PART OF ENVIRONMENTAL DATA RESOURCES, INC. IS STRICTLY LIMITED TO A REFUND OF THE AMOUNT PAID FOR THIS REPORT. Purchaser accepts this Report "AS IS". Any analyses, estimates, ratings, environmental risk levels or risk codes provided in this Report are provided for illustrative purposes only, and are not intended to provide, nor should they be interpreted as providing any facts regarding, or prediction or forecast of, any environmental risk for any property. Only a Phase I Environmental Site Assessment performed by an environmental professional can provide information regarding the environmental risk for any property. Additionally, the information provided in this Report is not to be construed as legal advice.

Copyright 2014 by Environmental Data Resources, Inc. All rights reserved. Reproduction in any media or format, in whole or in part, of any report or map of Environmental Data Resources, Inc., or its affiliates, is prohibited without prior written permission.

EDR and its logos (including Sanborn and Sanborn Map) are trademarks of Environmental Data Resources, Inc. or its affiliates. All other trademarks used herein are the property of their respective owners.

Sanborn Sheet Thumbnails

This Certified Sanborn Map Report is based upon the following Sanborn Fire Insurance map sheets.



1970 Source Sheets



Volume 3, Sheet 277



Volume 3, Sheet 278



Volume 3, Sheet 280



Volume 3, Sheet 281



Volume 2, Sheet 195



Volume 2, Sheet 196

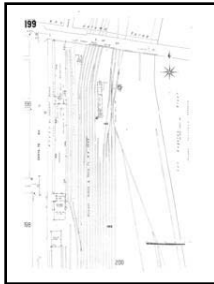

Volume 2, Sheet 199

1968 Source Sheets

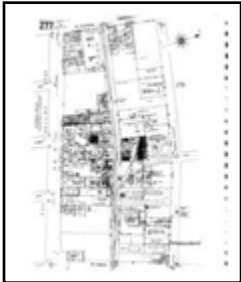

Volume 3, Sheet 277



Volume 3, Sheet 278



Volume 3, Sheet 280

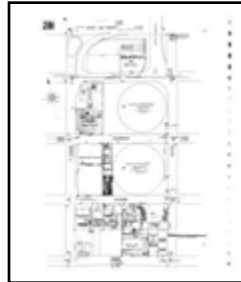

Volume 3, Sheet 281

1967 Source Sheets



Volume 2, Sheet 195



Volume 2, Sheet 196

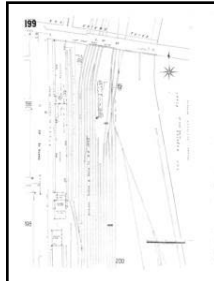

Volume 2, Sheet 199

1965 Source Sheets



Volume 3, Sheet 277



Volume 3, Sheet 278



Volume 3, Sheet 280

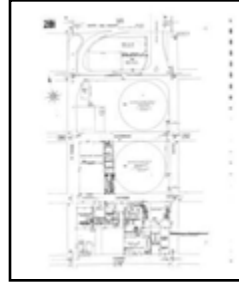

Volume 3, Sheet 281

1964 Source Sheets

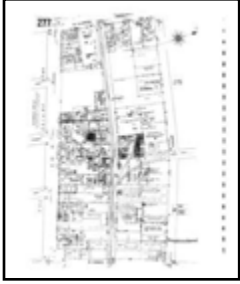

Volume 3, Sheet 277



Volume 3, Sheet 278



Volume 3, Sheet 280

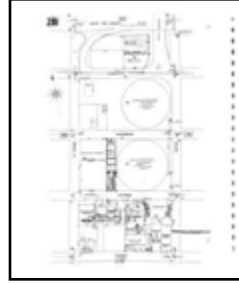

Volume 3, Sheet 281

1960 Source Sheets



Volume 3, Sheet 277



Volume 3, Sheet 278



Volume 3, Sheet 280

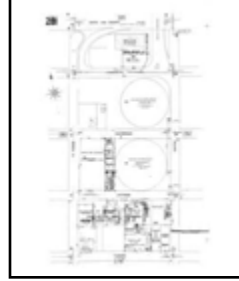

Volume 3, Sheet 281



Volume 2, Sheet 195



Volume 2, Sheet 196

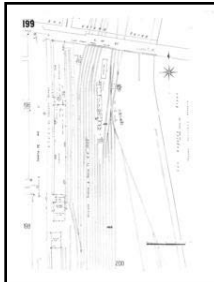

Volume 2, Sheet 199

1959 Source Sheets



Volume 2, Sheet 195



Volume 2, Sheet 196

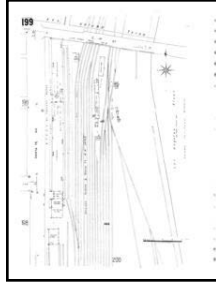

Volume 2, Sheet 199

1957 Source Sheets



Volume 3, Sheet 277



Volume 3, Sheet 278



Volume 3, Sheet 280

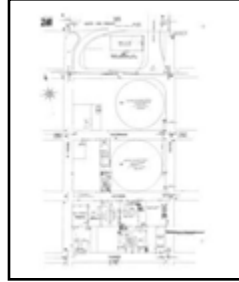

Volume 3, Sheet 281

1954 Source Sheets



Volume 3, Sheet 277



Volume 3, Sheet 278



Volume 3, Sheet 280



Volume 3, Sheet 281



Volume 2, Sheet 195



Volume 2, Sheet 196

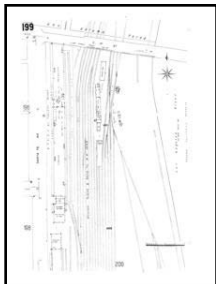

Volume 2, Sheet 199

1953 Source Sheets



Volume 2, Sheet 195



Volume 2, Sheet 196

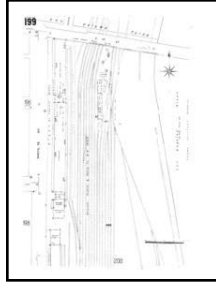

Volume 2, Sheet 199



Volume 3, Sheet 277

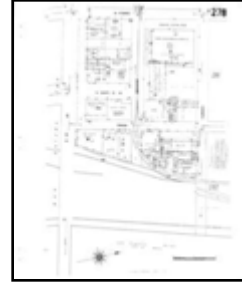

Volume 3, Sheet 278



Volume 3, Sheet 280

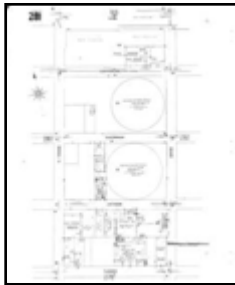

Volume 3, Sheet 281



Volume 3, Sheet 277



Volume 3, Sheet 278

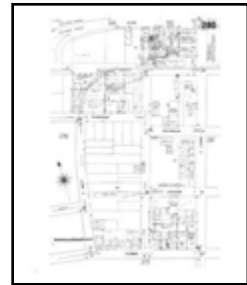

Volume 3, Sheet 280



Volume 3, Sheet 281



Volume 2, Sheet 195



Volume 2, Sheet 196

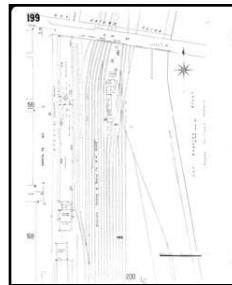

Volume 2, Sheet 199

1950 Source Sheets



Volume 2, Sheet 195



Volume 2, Sheet 196

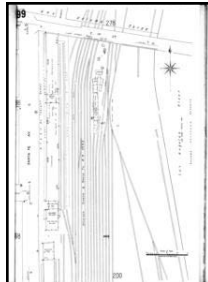

Volume 2, Sheet 199



Volume 2, Sheet 195



Volume 2, Sheet 196

Volume 2, Sheet 199

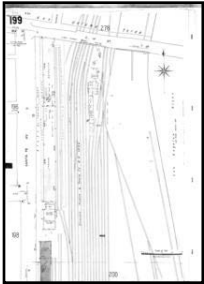

Volume 3, Sheet 277



Volume 3, Sheet 278



Volume 3, Sheet 280



Volume 3, Sheet 281

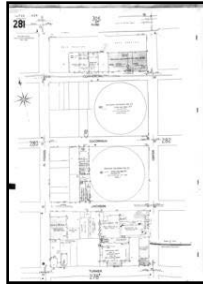

1920 Source Sheets



Volume Congested Business District, Sheet

1906 Source Sheets



Volume 3, Sheet 277



Volume 3, Sheet 278



Volume 3, Sheet 280



Volume 3, Sheet 281



Volume 2, Sheet 195



Volume 2, Sheet 196

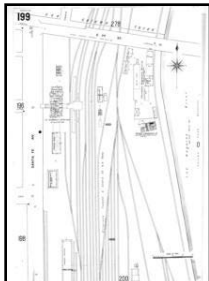

Volume 2, Sheet 199