

We will get going in just a moment



Thank you for joining us!



This conversation will be recorded and shared afterwards online and via email



You can submit your questions using the Q&A feature.

Agency News

Let's Ride Safely Together

Keeping riders safe is our number one priority and we're committed to providing you with a great experience on Metro.

That's why we've launched a plan that reimagines the way we approach public safety, to ensure all our riders feel safe, comfortable, and welcome on our system.

Check out 'Let's Ride Safely Together' at <https://www.metro.net/riding/safety-security/> to learn how we're improving security, cleanliness, and customer care on our buses and trains.



We're planning Metro's budget for fiscal year 2024 and want your input.

For more info on how to participate, visit mybudget.metro.net/bus.



Metro Budget Tool is Live



- We're committed to providing you with a great experience on Metro. That means a system that's secure and clean, where we treat every rider with care. We have a comprehensive plan that focuses on 3 areas to keep our riders and employees safe.
- Visit mybudget.metro.net to participate in the budget survey

Presentation Panelists

Metro Purple Line Extension Team

Marlon Walker, Community Relations Manager

- Sections 1, 2 & 3 and Division 20

Ned Racine, Principal Community Relations Officer

- Section 1 and Division 20

Mindy Lake, Principal Community Relations Officer

- Section 1, Beverly Hills and Section 2

Glyssa Robles, Principal Community Relations Officer

- Section 3

Clare Haggarty, Sr Manager, Transportation Planning,
Arts + Community Enrichment

- Metro Art Update, Sections 1,2,3

Metro New Media Team

Stephanie Molen, Principal Community Relations Officer New Media Team

Katrice Chandler, Principal Community Relations Officer New Media Team

Contractor Representatives and Presenters

Scott Donohue, STS Community Relations Coordinator

Matt Evans, TPOG Project Information Coordinator

Joanna Amador-Dempsey, Modern Times Community Relations Director

Metro Business Interruption Fund Team

Sidney Urmancheev, DEOD Representative

Today's Agenda

- > Metro Art Update
- > Project Overview
- > Division 20
 - Section 1 Construction Update
 - Section 2 Construction Update
 - Section 3 Construction Update
- > Eat Shop Play
- > Business Interruption Fund

Metro Art Update

Upcoming Meet the Artist Event:

Meet Analia Saban, one of the five artists commissioned for the Century City/Constellation Station

- > Learn about Analia Saban's artwork design
- > Meet the PLE paleontologists
- > See real fossils excavated from PLE stations
- > Join a fun art activity

Saturday, February 11, 2023, 11:00am – 1:00pm

Westfield Century City Mall, 2nd Floor, Dining Terrace

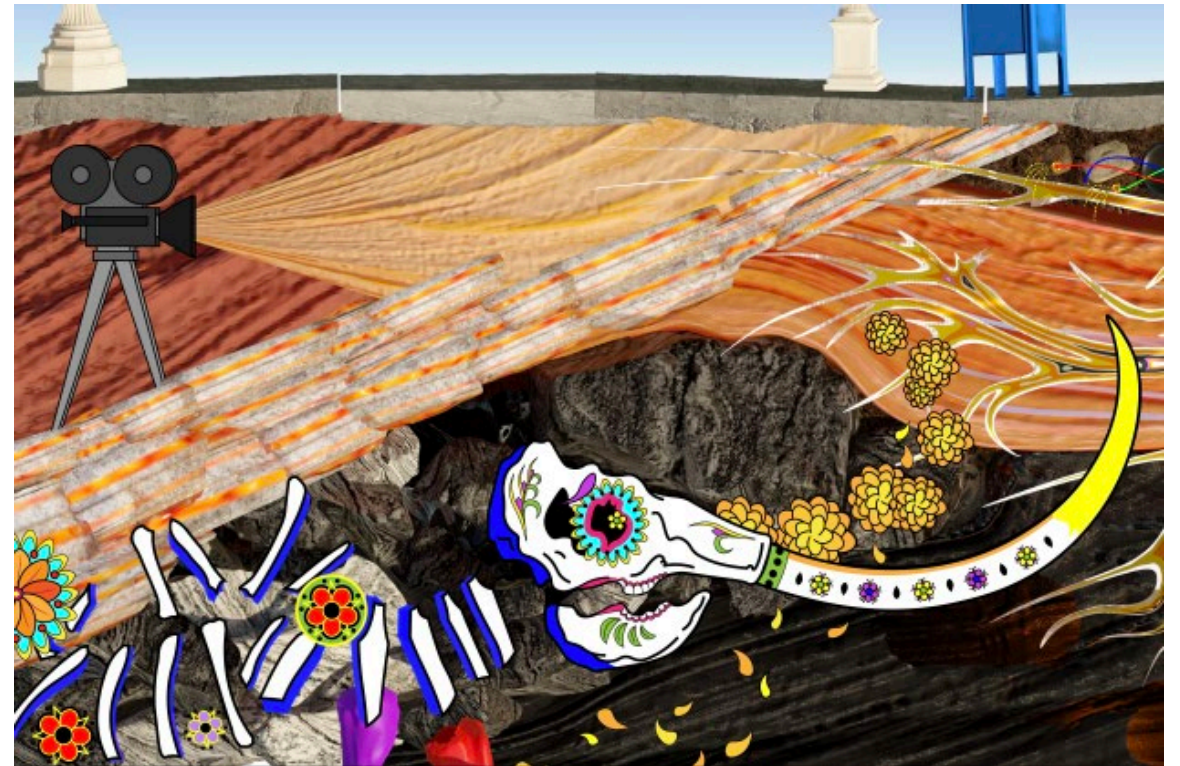

Metro Art Update

To receive the latest on Metro Art events and art opportunities, subscribe for email updates at [Metro.net/art](https://metro.net/art)

Metro Purple (D Line) Extension Transit Project



Sections 1, 2, & 3 Status

	Forecasted Schedule		
Section	Section 1	Section 2	Section 3
Length	3.92 Miles	2.59 Miles	2.56 Miles
New Stations	Wilshire/La Brea Wilshire/Fairfax Wilshire/La Cienega	Wilshire/Rodeo Century City/ Constellation	Westwood/UCLA Westwood/VA Hospital
Pre-Construction Activities	2014 – 2015	2016 – 2018	2018 – 2019
Construction	2015 – 2024	2018 – 2025	2019 – 2027
Operations	2024	2025	2027



**Subject to change. The PLE project team is working to deliver the project consistent with Measure M.*

Next stop: improving rail service.

DIVISION 20 PORTAL WIDENING AND TURNBACK FACILITY



Metro

Project Overview

- > Operational improvements to Metro's Division 20 Rail Yard will accommodate increased service levels on the Metro Red and Purple (B and D) Lines
- > Improvements include:
 - Widening of heavy rail portal
 - New turnback facility
 - Expansion and reconfiguration of rail storage tracks
- > Benefits
 - Faster and more frequent service

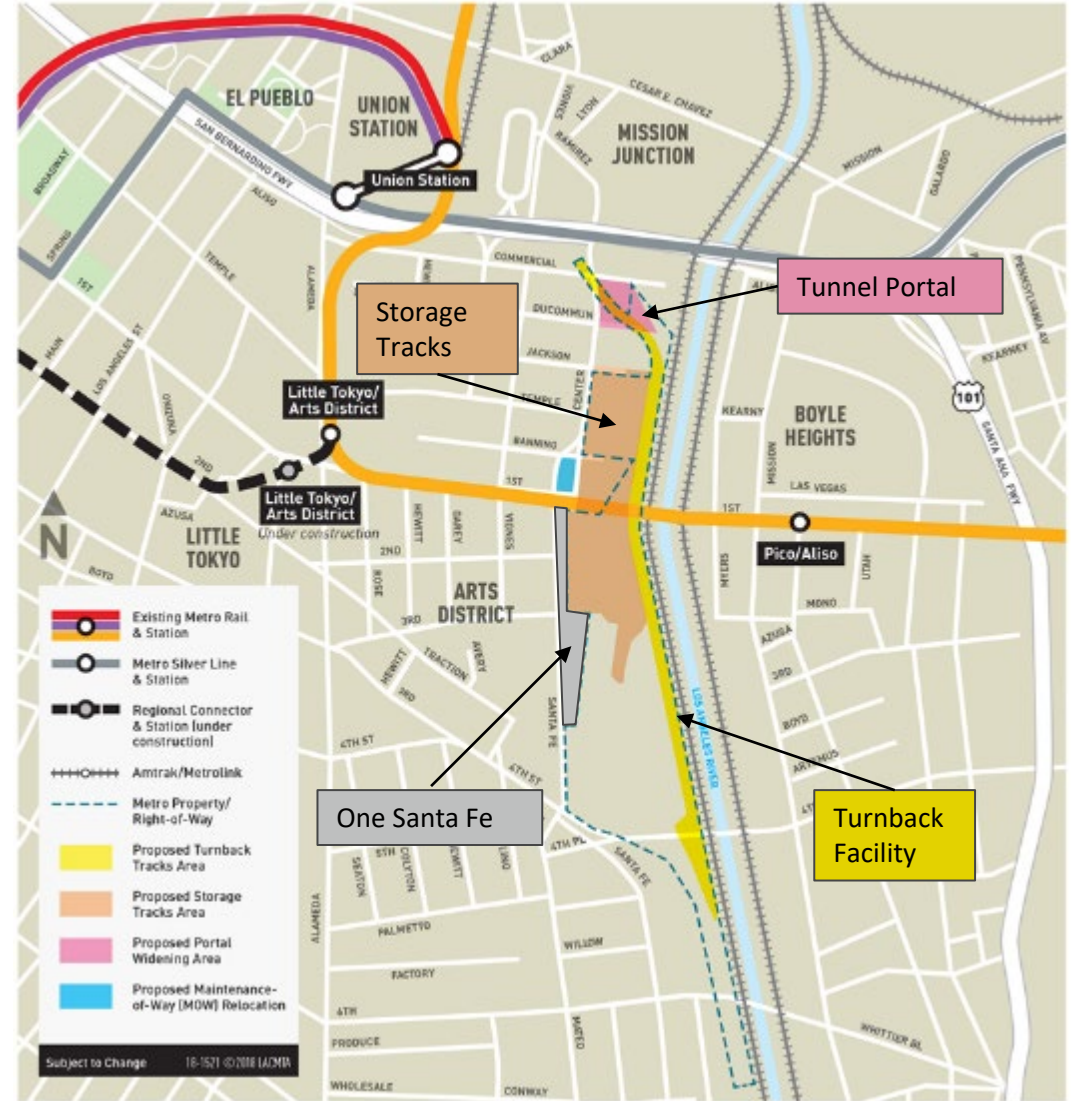

Exact location of turnback tracks and storage tracks to be determined.

Current work- Portal Area

Before Construction



Current area*

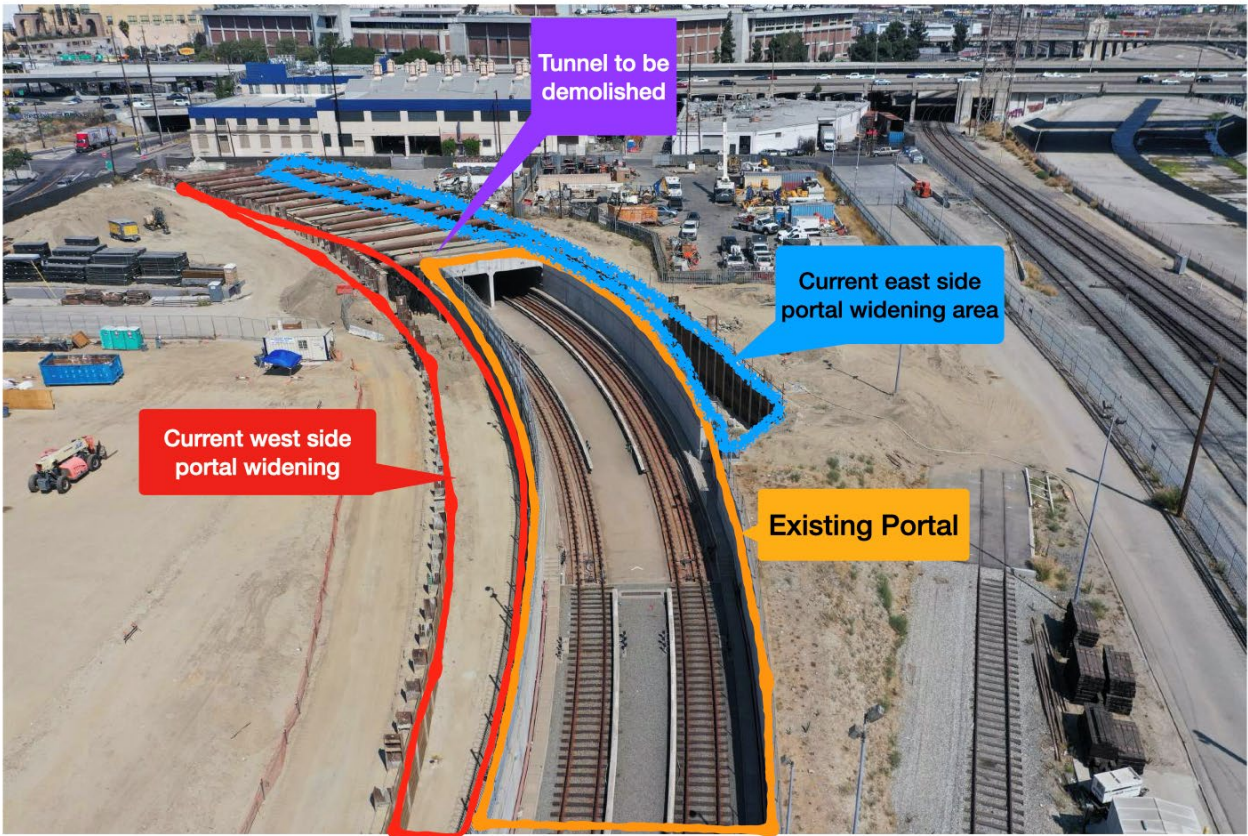

*Delineations on the image are not to scale.

Next stop: more subway.

PURPLE (D LINE) EXTENSION TRANSIT PROJECT
Section 1



Metro



La Brea Station - Planned Activities in 2023



La Brea Station - Interior



Concourse Level



Stairway Falsework

La Brea Station – Interior (cont.)



M Metro Entrance Structure



Roof Level

La Brea Station – South Side Civil Restoration

Curb, Gutter, Bus Pad Restoration

Following north side restoration, a work zone will be established on the south side of Wilshire Blvd. between Mansfield Ave. and Detroit St.

Work zone supports:

- Curb and gutter restoration
- Streetlight installation
- Tree well installation
- Wheelchair and bus lane completion

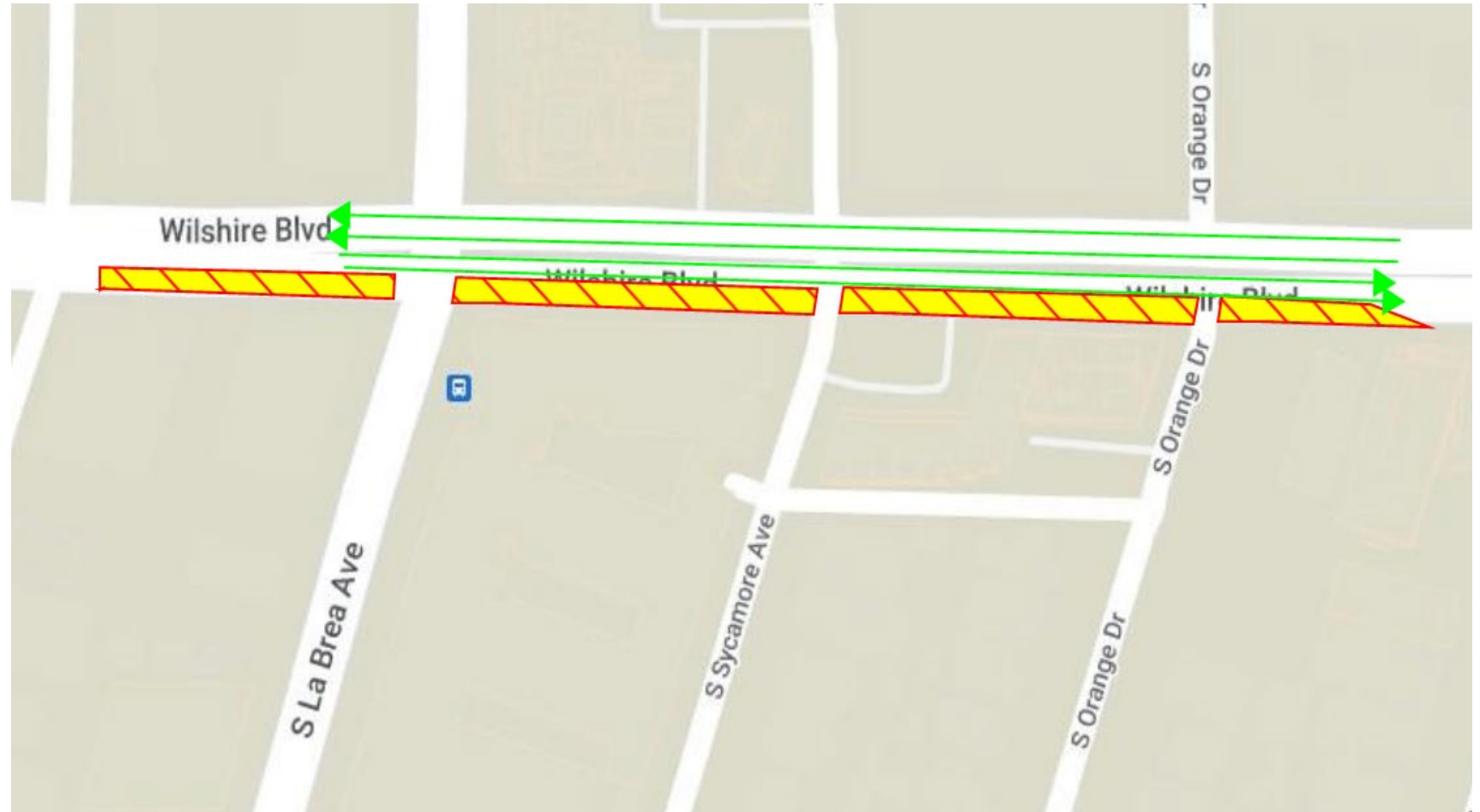

This workzone was implemented just before Thanksgiving 2022. It will be in place through February/March 2023

Work Behind the K-Rail



**Finished Bus Pad and Curb on
Wilshire – between Orange Dr
and Sycamore Av**



**Finished Bus Pad and Curb at
Wilshire/Orange**

Work Behind the K-Rail (cont.)



Foundation for the radio antenna at Wilshire/Sycamore



Poured Bus Pad Section between Mansfield Av and Orange Dr



Additional Items At La Brea

Remaining Civil Restoration

- > February/March 2023 – September 2023
 - > Ongoing Station Construction between Sycamore Av and Detroit St
 - > STS will utilize Peak Hour lane reductions on Wilshire Bl and La Brea Av to access deck panels that lead to the western half of the La Brea Station
 - > Advanced notification of work activities will remain ongoing
- > September 2023 – November 2023
 - > Decking Removal between La Brea Av and Detroit St – at least two distinct phases of work. Phase 1 will require a full closure of Wilshire Bl and La Brea Av at the intersection. Phase 2 will require a full closure of Wilshire Bl between La Brea Av and Detroit St
 - > Work will take place over weekends, starting on Fridays at around 9pm and continuing through the following Monday at 6am
- > November 2023 – January 2024
 - > STS will implement a work zone on the north side of Wilshire Bl, reducing Wilshire to two lanes in each direction. The work zone will span between Sycamore Av and Detroit St
 - > This work zone will support ongoing civil restoration work activities, including curb, bus pad, tree wells, and street lighting
- > January 2024 – February 2024
 - > STS will implement a work zone on the south side of Wilshire Bl, reducing Wilshire to two lanes in each direction. The work zone will span between Sycamore Av and Detroit St
 - > This work zone will support ongoing civil restoration work activities, including curb, bus pad, tree wells, and street lighting
- > February 2024 - TBD
 - > Hatch Access and Median Construction – Further details will be available at a future date

Fairfax Station - Planned Activities in 2023



Fairfax Station - Interior

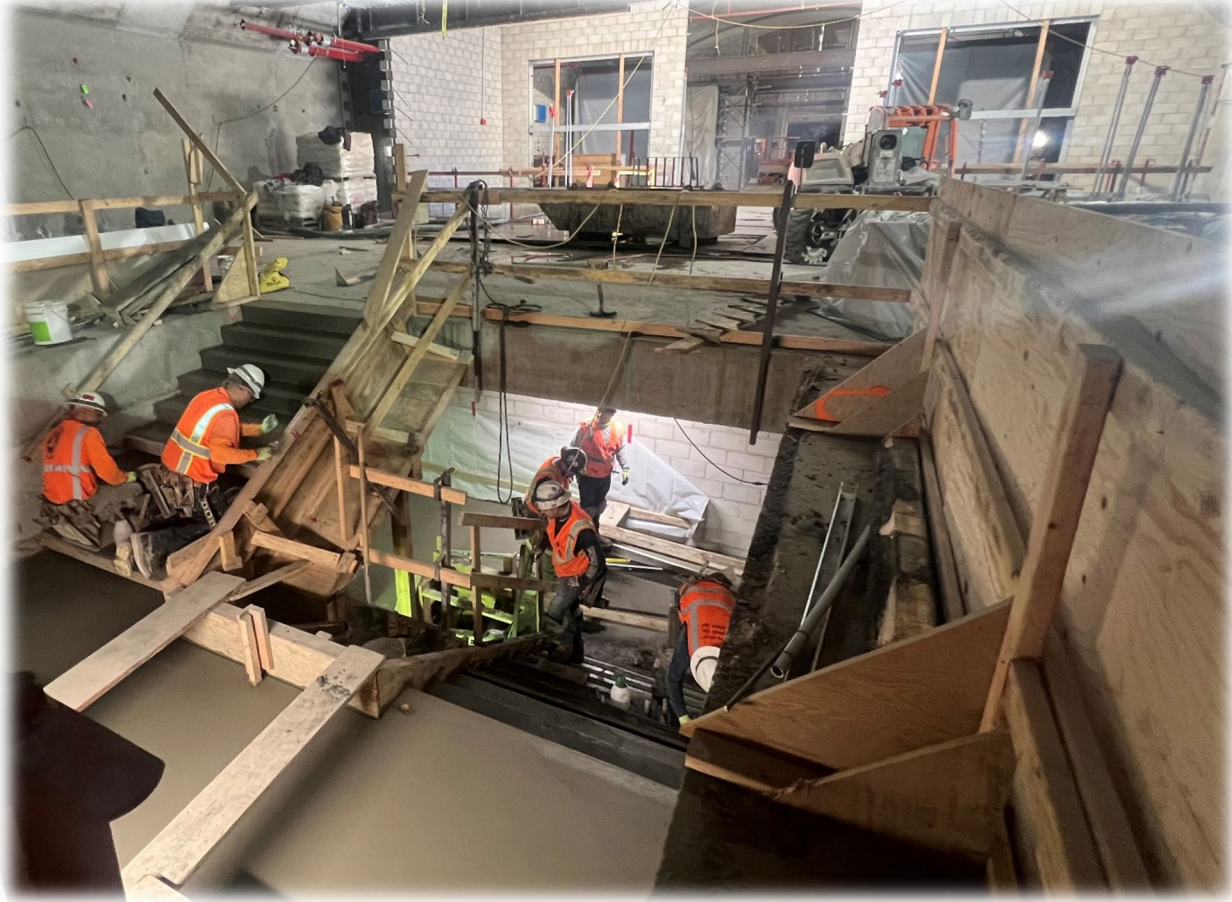

Internal Staircase



Concourse Level

Fairfax Station – Interior (cont.)



Entrance Structure



Roof Level

Fairfax Decking Removal – Phase 2

- Work will begin at 9pm on Friday night and continue through 6am on Monday morning. As a contingency, the Design-Builder has requested approval to extend work hours as late as 12 noon on Monday. The extension will only be used in the event of an emergency.
- Following Phase 1 Decking Removal and the Holiday Moratorium Period
- This work will take two weekends to complete, January 6 – 9, and February 3 - 6
- Full closures will be in place on Wilshire Bl and Fairfax Av. All traffic will be detoured around the work zone.
- Southbound Fairfax Av traffic will be detoured at 6th St
- Northbound Fairfax Av traffic will be detoured at Olympic Bl
- Eastbound Wilshire Bl traffic will be detoured at La Cienega Bl and San Vicente Bl
- Westbound Wilshire Bl traffic will be detoured at La Brea Av

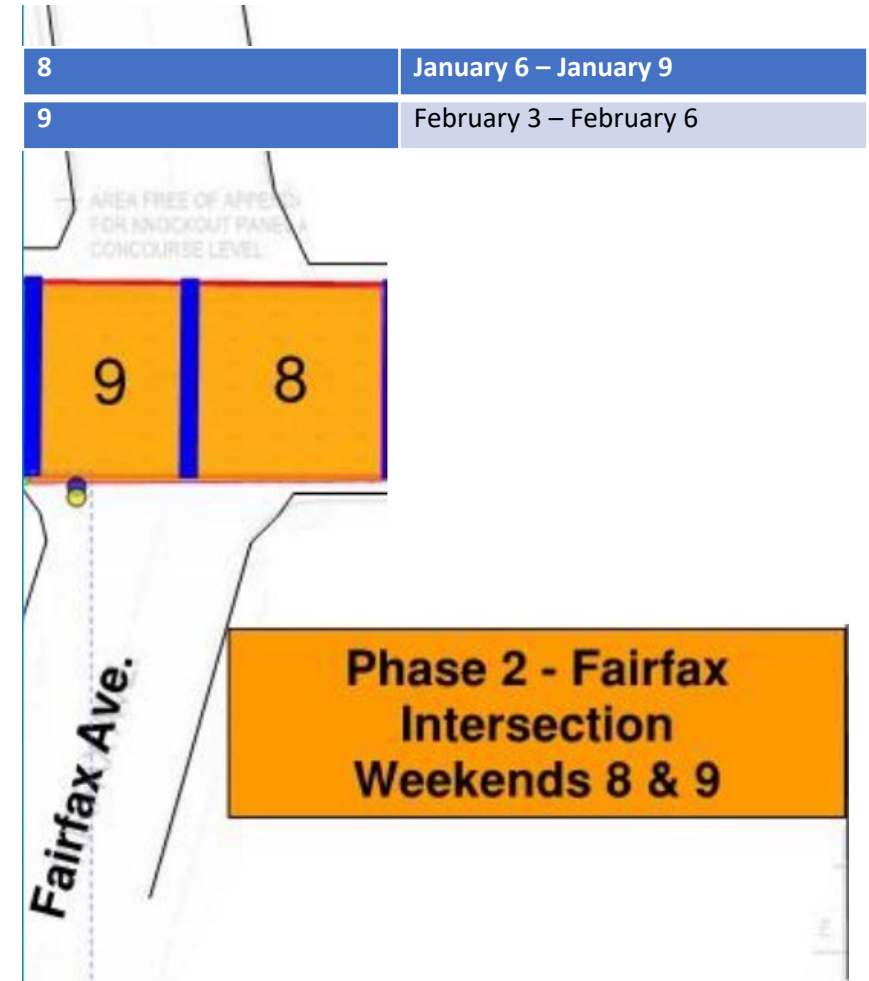

Fairfax Decking Removal – Phase 2 Detour Map

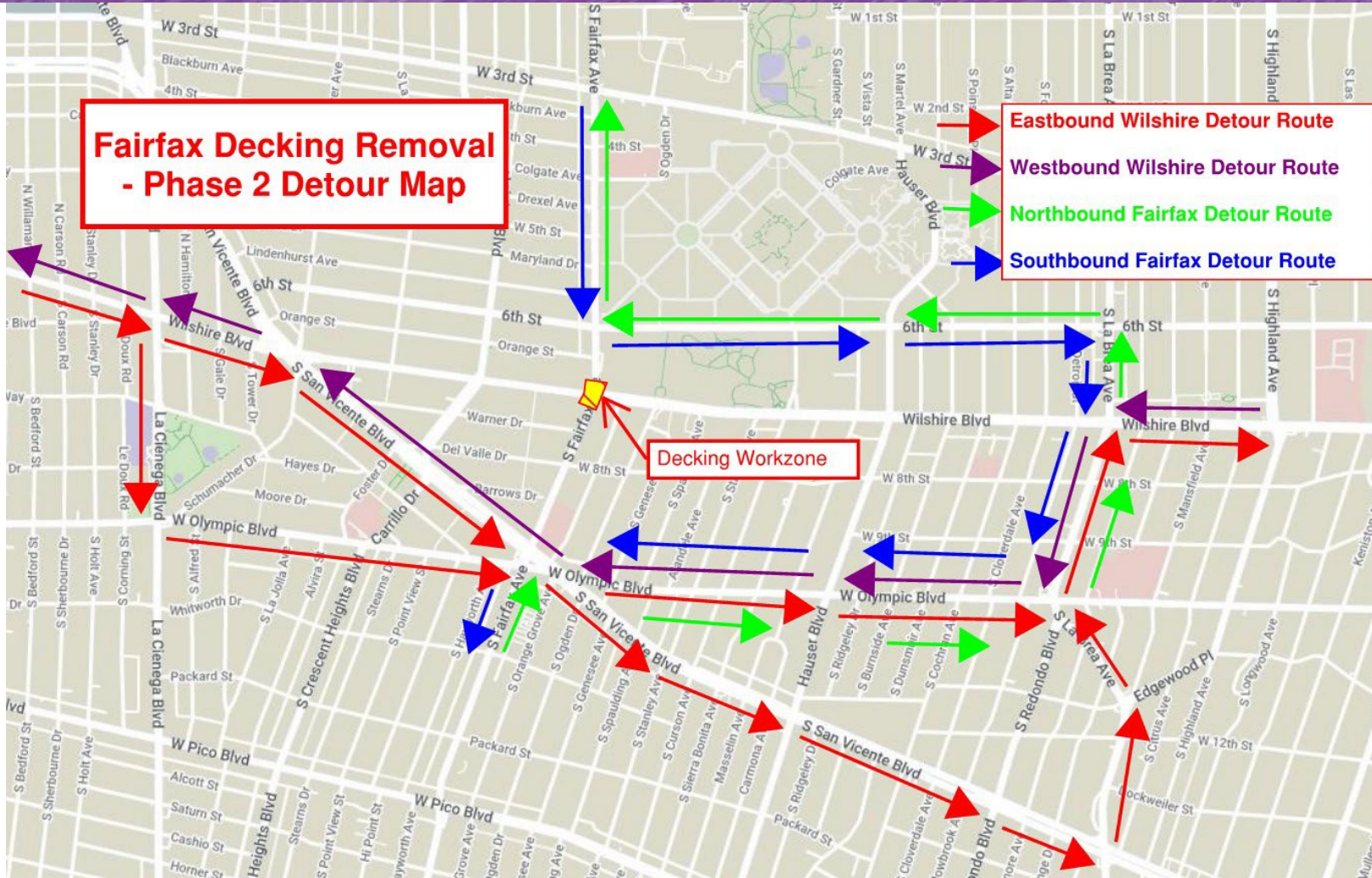

- **Eastbound Wilshire > Southbound La Cienega Bl > Westbound Olympic Bl > Northbound La Brea Av > Eastbound Wilshire**
- **Eastbound Wilshire > Southbound San Vicente Bl > Northbound La Brea Av > Eastbound Wilshire**
- **Westbound Wilshire > Southbound La Brea Av > Westbound Olympic Bl > Northbound San Vicente Bl > Westbound Wilshire**
- **Northbound Fairfax Av > Eastbound Olympic Bl > Northbound La Brea Av > Westbound 6th St > Northbound Fairfax Av**
- **Southbound Fairfax Av > Eastbound 6th St > Southbound La Brea Av > Westbound Olympic Bl > Southbound Fairfax Av**

Fairfax Decking Removal – Phase 3

- Work will begin at 9pm on Friday night and continue through 6am on Monday morning. As a contingency, the Design-Builder has requested approval to extend work hours as late as 12 noon on Monday. The extension will only be used in the event of an emergency.
- Following Phase 2 Removal, the third and final phase of work will begin to the west of Fairfax Av
- This work will take place over 3 weekends, beginning on February 10
 - Please note: a 4th weekend may be required depending on weather.
- Full closures will be in place at Fairfax Av and San Diego Way
- Eastbound Wilshire will be detoured at La Cienega Bl or San Vicente Bl
- Westbound Wilshire will be detoured at Fairfax Av

10	February 10 – February 13
11	February 17 – February 20
12	February 24 – February 27
13	March 3 – March 6



Fairfax Decking Removal – Phase 3 Detour Map

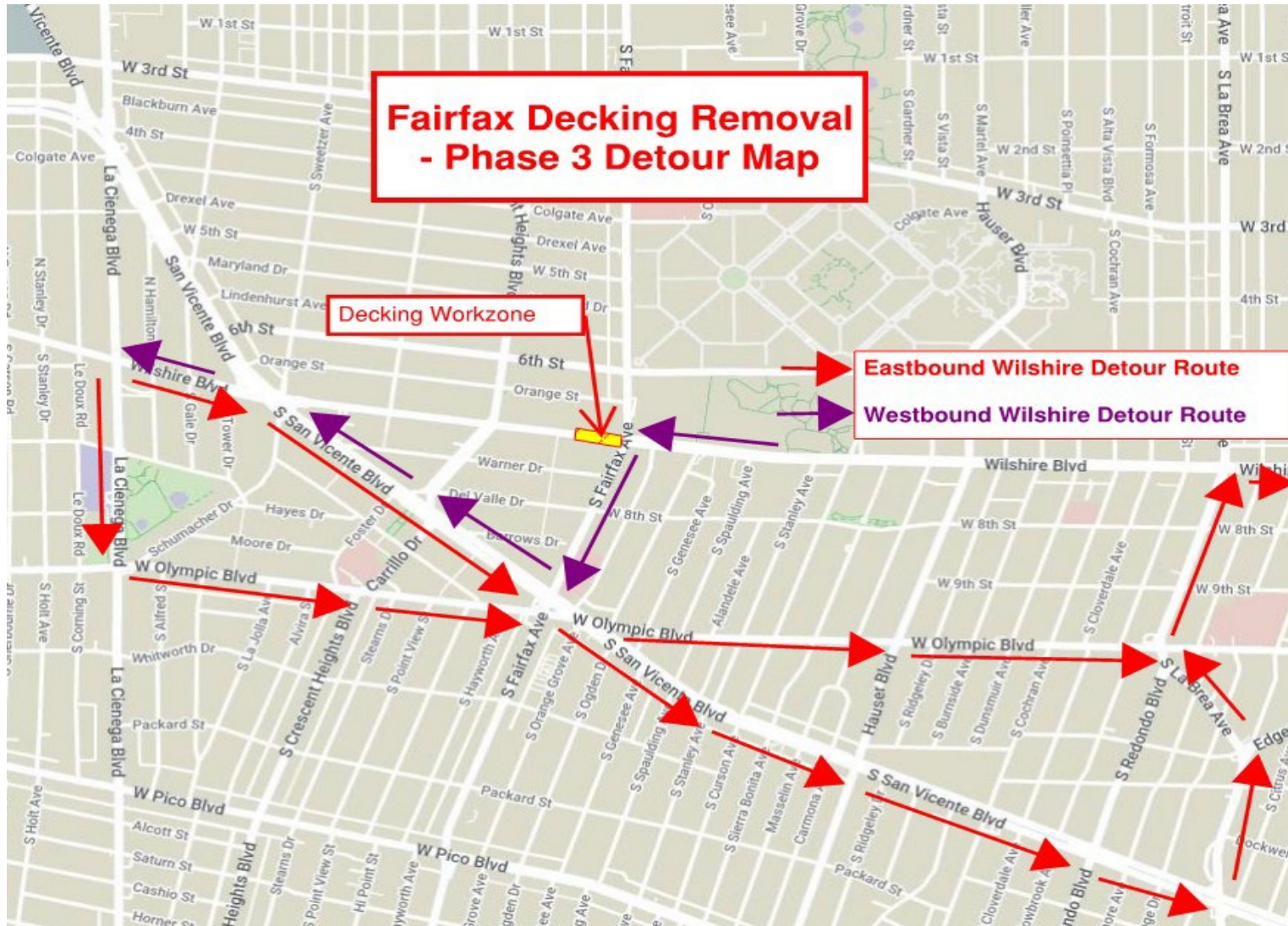

- Eastbound Wilshire > Southbound La Cienega Bl > Eastbound Olympic Bl > Northbound La Brea Av > Eastbound Wilshire
- Eastbound Wilshire > Southbound San Vicente Bl > Northbound La Brea Av > Eastbound Wilshire
- Westbound Wilshire > Southbound Fairfax Av > Northbound San Vicente Bl > Westbound Wilshire

Fairfax Station – Civil Restoration

*Dates Subject to Change



Curb, Gutter, Bus Pad Restoration

Beginning over the weekend of February 3 to February 6, a work zone will be implemented on the north side of Wilshire Blvd between Spaulding Av and San Diego Way. This work zone is anticipated to be in place for approximately 4 – 6 months

This work zone will support curb and gutter restoration and the installation of streetlights, tree wells, wheelchair ramps, and bus lanes.

Wilshire/La Cienega Station Rendering



Upcoming COLA Work – Fairfax Decking Removal

- > Beginning the weekend of January 27 to January 30, and continuing for 3 consecutive weekends, STS will resume decking removal operations at Wilshire/Fairfax.
- > Work will begin on Friday nights at 9pm, and continue through the following Monday at 6am. An emergency Peak Hour Exemption has been granted in the event that the road is not safe to drive on by Monday morning.
- > The work has now moved into the Wilshire/Fairfax intersection. Due to the nature of each closure, detour routes have been engineered. The detour routes for eastbound Wilshire BI will impact traffic within the City of Beverly Hills.
- > **Eastbound Wilshire Detour Routes:**
 - > Eastbound Wilshire BI > Southbound La Cienega BI > Eastbound Olympic BI > Northbound La Brea Av > Eastbound Wilshire BI
 - > Eastbound Wilshire BI > Southbound San Vicente BI > Northbound La Brea Av > Eastbound Wilshire

Detour Route Maps

Fairfax Decking Removal – Phase 2 Detour Map

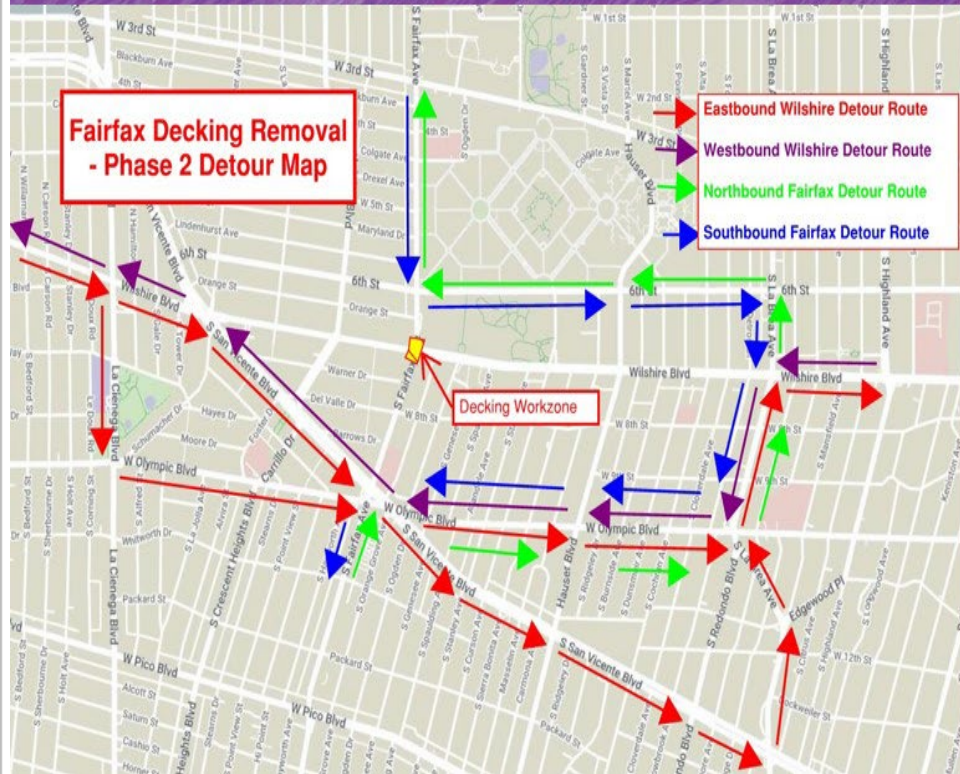

- Eastbound Wilshire > Southbound La Cienega Bl > Westbound Olympic Bl > Northbound La Brea Av > Eastbound Wilshire
- Westbound Wilshire Detour Route
- Northbound Fairfax Detour Route
- Southbound Fairfax Detour Route
- Eastbound Wilshire > Southbound San Vicente Bl > Northbound La Brea Av > Eastbound Wilshire
- Westbound Wilshire > Southbound La Brea Av > Westbound Olympic Bl > Northbound San Vicente Bl > Westbound Wilshire
- Northbound Fairfax Av > Eastbound Olympic Bl > Northbound La Brea Av > Westbound 6th St > Northbound Fairfax Av
- Southbound Fairfax Av > Eastbound 6th St > Southbound La Brea Av > Westbound Olympic Bl > Southbound Fairfax Av

Fairfax Decking Removal – Phase 3 Detour Map



- Eastbound Wilshire > Southbound La Cienega Bl > Eastbound Olympic Bl > Northbound La Brea Av > Eastbound Wilshire
- Eastbound Wilshire > Southbound San Vicente Bl > Northbound La Brea Av > Eastbound Wilshire
- Westbound Wilshire > Southbound Fairfax Av > Northbound San Vicente Bl > Westbound Wilshire

Wilshire/La Cienega Station Appendage Work

- > **Why:** Multiple appendages will be required for each station on the Purple Line Extension
- > Each appendage structure houses a vital function for the stations:
 - Emergency exits
 - Utility rooms
 - Ventilation rooms
 - Entrance and exit structures
- > **When:** Began in March 2021 through 2023*
 - > Phase 2 was implemented on December 17, 2022
- > Coordination with impacted businesses will continue following the implementation of Phase 2

Appendage Work in 2022



 **Metro** Captured January 2022



Captured January 2023

Wilshire/La Cienega Station: Appendage Work and K-Rail Placement

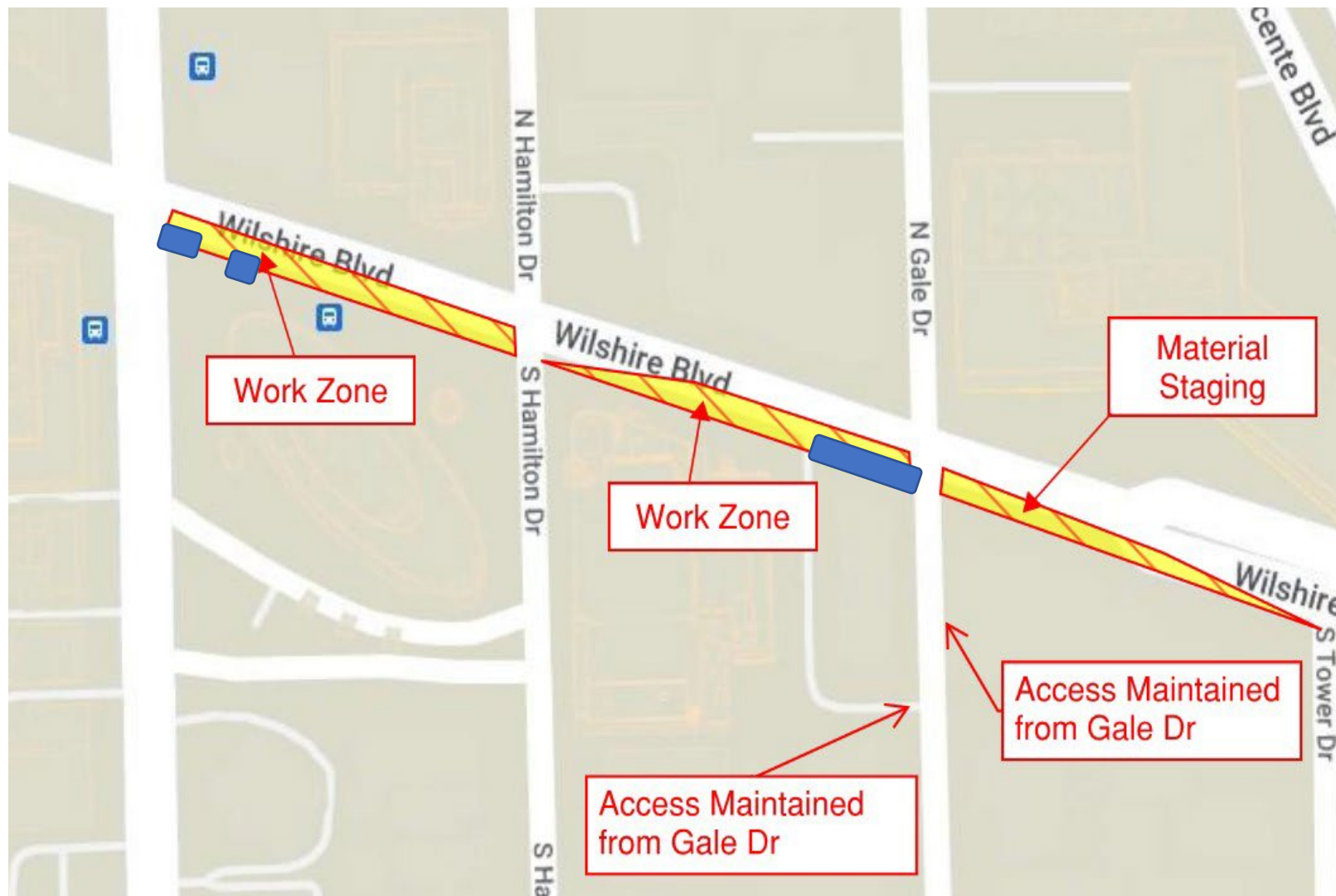

- > Anticipated to be in place for 9 to 11 months.
- > The two work zones will support excavation, and then construction, of three separate appendage structures
- > The largest of these is on the southwest corner of Wilshire Bl and Gale Dr
- > The Material Staging Zone at the southeast corner* will be in place to support excavation, and then construction, by providing a laydown area for support of excavation (SOE) and construction materials such as rebar and HDPE
- > * The Staging Area allows us to keep S Gale Dr and S Hamilton Dr open on a more regular basis. Instead of long-term closures to the street, STS will utilize intermittent short-term closures on S Gale and S Hamilton on an as needed basis.
- > The south Wilshire sidewalk is closed to pedestrian traffic at S Gale Dr – a pedestrian detour has been implemented along the north side of Wilshire Bl. North-south crosswalks are maintained at La Cienega Bl and Gale Dr

Replacement Parking

Locations for One Hour Free Parking: Mon to Fri, 10am to 3pm

- 8447 Wilshire Bl:
Accessible from N Hamilton
- 8350 Wilshire Bl:
Accessible from S Tower
- Please mention "**Metro**" upon entering the building to receive the 1st hour free



Wilshire/La Cienega Station Backfilling

*Subject to Approval

- > **When:** Continuing in February 2023
- > **What:** Station Backfilling
- > This is the first of multiple construction activities in advance of decking removal and street restoration.
- > **Why:** The Station Roof is approximately 20ft below the street surface. That area will need to be filled with slurry, soil, and utilities.
 - > STS will need to restore utilities in the street, including sewer, storm drains, and other utilities.
- > **Traffic Control and Work Hours:** Intermittent weeknights and weekend days.
 - > Hours: 8pm to 6am (the following morning) on weeknights
 - > Hours: 6am to 6pm on Saturdays
 - > Traffic Control: Wilshire Bl reduced to a single lane in each direction between San Vicente Bl and Le Doux Rd



Backfilling operations at Wilshire Bl and Orange Dr, within the City of Los Angeles

Coming Soon: Decking Removal and Civil Restoration

*Pending COBH Approval



- > Anticipated to begin at the end of April 2023
- > Decking Removal will commence over approximately 17 total weekends. Work is expected to begin at 8pm on Friday nights and continue through 7am the following Monday. During this time Wilshire Bl will be fully closed.
- > Additional information will be made available in future presentations and construction notices.

Concrete and Material Deliveries

> Traffic Control:

- Beginning in mid-December, eastbound Wilshire Bl will be intermittently reduced to one lane between La Cienega Bl and San Vicente Bl, this will support material delivery to the appendage work zones
- Daily closures will be utilized in support of ongoing work activities in the staging yard at Gale Dr

> Deck Panel Access: Hamilton Dr (9am to 4pm and 8pm to 7am, weekdays; 6am to 6pm, Saturdays)

- Continuing in January, intermittent deck panel access may be implemented within the Wilshire/Hamilton intersection.
- Wilshire will be reduced to a single lane in each direction between Tower Dr and Stanley Dr
- Left turns from Wilshire to Hamilton will be restricted. Through traffic on Hamilton will be restricted at Wilshire.
- Short term closures on S Tower Dr, S Gale Dr, and S Hamilton Dr may also be utilized

> Noise Mitigations: will remain in place

- Sound blankets around noisy equipment
- Trucks equipped with low-impact backup alarms
- Nylon straps used to lift material



Outside Gale Staging Yard

Wilshire/La Cienega Station Progress: Final Roof Pour



The last roof section for Wilshire/La Cienega was poured on 12.28.2022. This was the final roof pour for Section 1 of the Purple (D) Line Extension, and a major milestone for this section of the project.

Instrumentation Work

- > **When:** Ongoing in 2023
- > **Traffic Controls:**
 - Intermittent lane reductions on Wilshire Bl, La Cienega Bl, and side streets during off-peak hours may be in place to support the maintenance of geotechnical instruments in the Wilshire Bl and La Cienega Bl area
 - Intermittent lane reductions may be in place on Wilshire Bl, west of La Cienega Bl, to support coring survey work under Wilshire Bl
- > Additional details on this work will be available in future construction notices





Next stop: more subway.

PURPLE (D LINE) EXTENSION TRANSIT PROJECT
Section 2

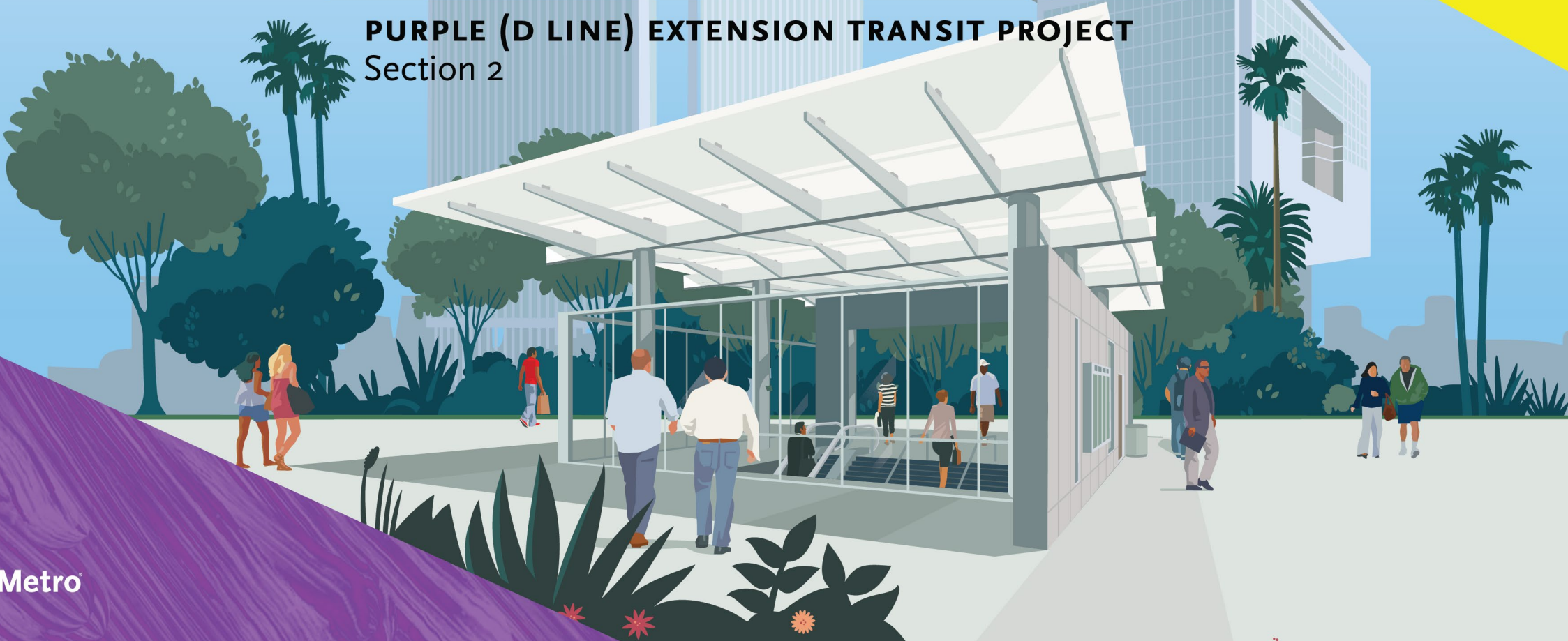

Section 2: Station Naming

Join us at the Century City Westfield Mall on February 11th from 11am-2pm! Meet one of the Artists for the Century City Station and see the fossils found during excavation that inspired her design.

You can also submit station names online using this QR code or site address.



bit.ly/3KHqNgs

Station Naming Policy

Station Names will reflect the following principles

- **Transit system content:** Names will reflect the property's location, relative to the entire transit system, and not duplicate elsewhere.
- **Property area:** provide specific information about the property's location relative to the surrounding area.
- **Neighborhood identity:** Acknowledge the communities and neighborhoods services by the station and stops.
- **Simplicity:** Names will be short, easily recognizable and fit for signage and mapping.

Wilshire/Rodeo Station Rendering



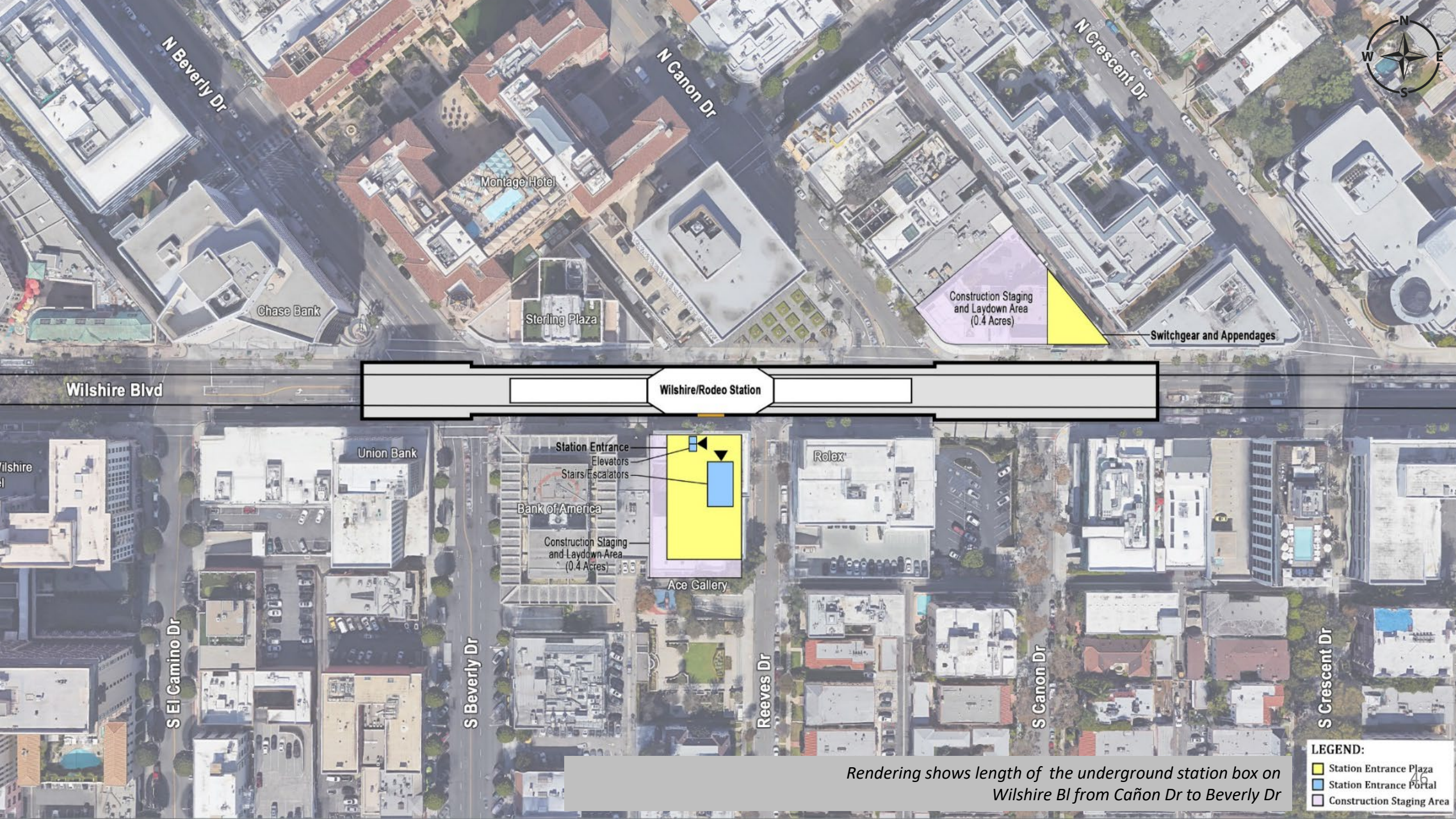

Wilshire Blvd

Wilshire/Rodeo Station

Construction Staging and Laydown Area (0.4 Acres)

Switchgear and Appendages

Union Bank

Station Entrance
Elevators
Stairs/Escalators

Bank of America

Construction Staging and Laydown Area (0.4 Acres)

Ace Gallery

Rolex

S El Camino Dr

S Beverly Dr

Reeves Dr

S Canon Dr

S Crescent Dr

LEGEND:

- Station Entrance Plaza
- Station Entrance Portal
- Construction Staging Area

Rendering shows length of the underground station box on Wilshire Bl from Cañon Dr to Beverly Dr

Wilshire/Rodeo Station: Permitted Work Hours and Traffic Control

- Work hours underneath the deck are 24 hours a day, 7 days a week. Deliveries of material, equipment, and concrete will be ongoing daily from Wilshire Bl. A breakdown of daily work hours on street level:
 - **From 7am to 9am and 4pm to 8:15pm**, Wilshire Blvd. will remain open with three lanes in each direction between El Camino Dr. and Crescent Dr.
 - **From 9am to 4pm**, Wilshire Blvd. may be reduced to two lanes in each direction between El Camino Dr. and Crescent Dr.
 - **From 8:15pm to 7am**, Wilshire Blvd. may be reduced to one lane in each direction between El Camino Dr. and Crescent Dr.
- Traffic control may also be implemented on Beverly Dr. At least one through traffic lane will be maintained in both directions between 9am to 4pm and 8pm to 7am.
- From 9am to 4pm, S. Reeves Dr. may be reduced to one lane northbound. A flagger will be on site to assist motorists with two-way traffic.

Wilshire/Rodeo Station: Structure Construction through 2024

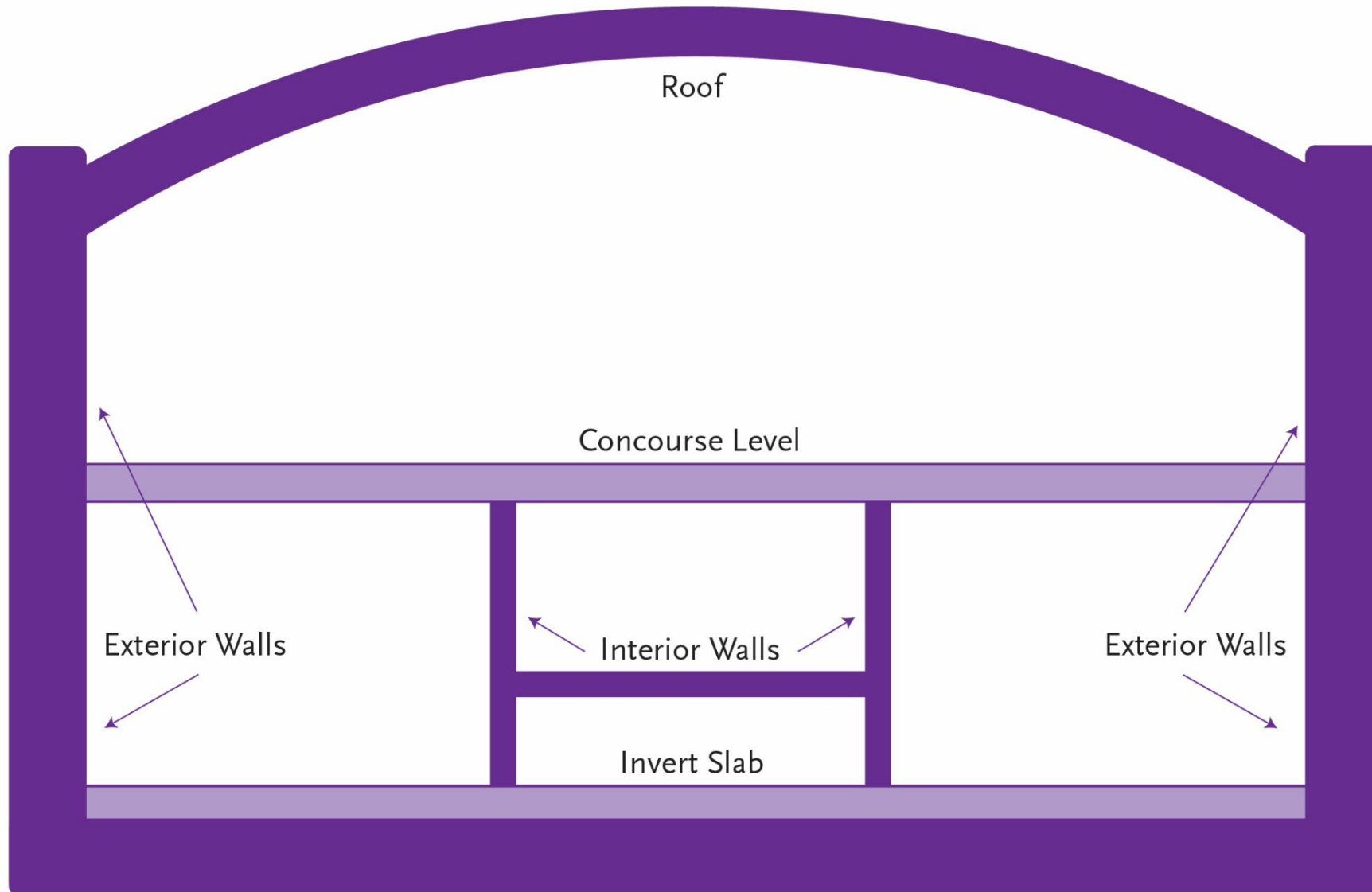

Wilshire/Rodeo Station: Concourse Level Progress

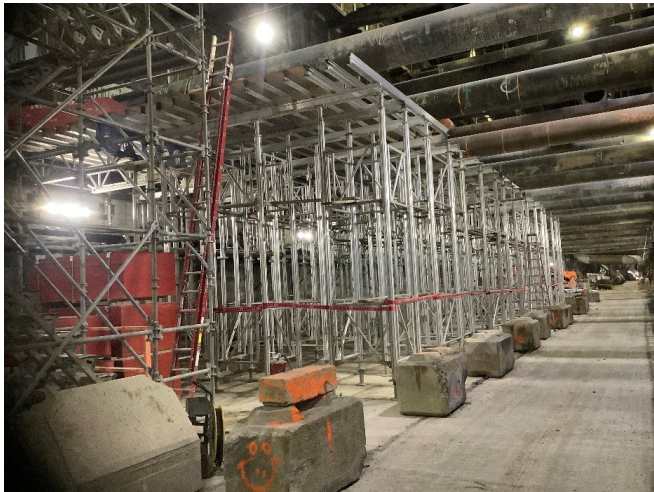

Left two photos – Progress work on Concourse Level (Falsework & Rebar)

Right two photos – On Concourse Level (Entrance) preparing to pour concrete slab for concourse roof

Wilshire/Rodeo Station: Construction Progress



Station roof falsework



Concourse Roof Falsework Installation Progress

Continuing Work: SCE Installation

Contractor is progressing with installation of SCE Permanent Power Feeds to the station.

- **Where:** Wilshire Bl between Dayton Way and Rexford Dr.
 - Starting east of station box
- **Duration:** Approximately 7 months [Work started Saturday, September 10, 2022]
 - > *Work has started east of station box from S Canon Dr to Rexford Dr (Sep – Mar 2023)*
 - > *Work west of station box from Dayton Way to Beverly Dr in progress working east*
- **Work Hours:** Weekends, 8am to 8pm and Weekdays 8:15pm to 7am
- **Traffic Control:**
 - Wilshire Bl may be reduced to one lane in each direction overnight and on weekends

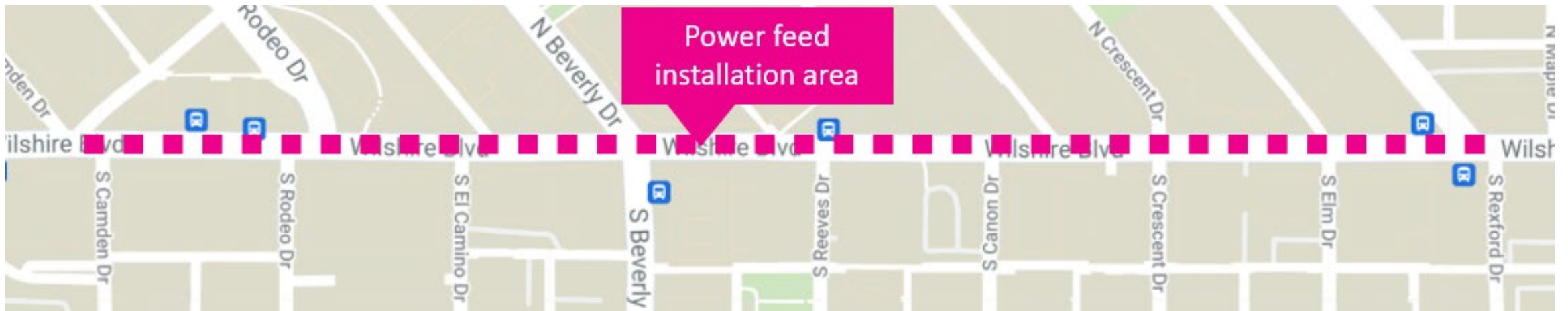

Upcoming Ground Improvement/Cross Passage Work

The contractor is progressing with ground improvement work along the tunnel alignment in preparation for the construction of cross passage tunnels.

- **When:** Work started in late May 2022
 - Ongoing until mid 2023
- **Where:** *14 locations; First 7 work sites noted on map
- **Work Hours:** Monday-Friday 8am-11pm on Wilshire Bl.
 - Closures remain in place 24/7 until each location is completed
- **Duration:** ~4 weeks/location

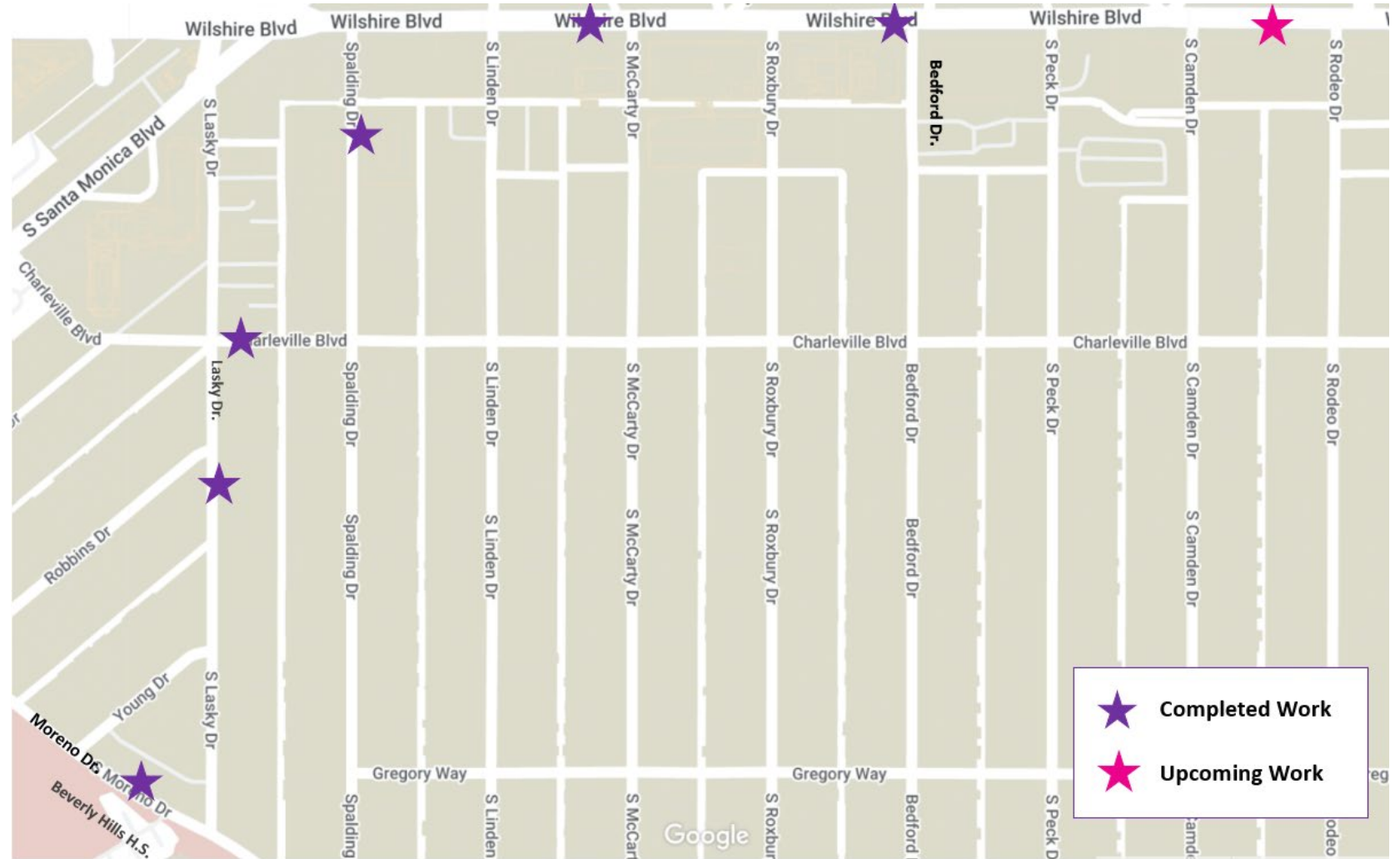

**Additional notices detailing dates & closure information will be provided in advance*

Cross Passage Work: Sidewalk Enclosures

Sidewalk enclosures are placed at each cross-passage location to house equipment.

- Each enclosure remains up until the completion of cross passage construction below ground.



Upcoming Work – Appendage Potholing

Contractor will begin potholing activity in preparation for the construction of appendage structures.

- **Where:** Wilshire Bl between Beverly Dr and Crescent Dr.
 - › Starting on north side of Wilshire at Crescent Dr.
 - › Work occurring at various areas adjacent to station box
- **Duration:** 4 weeks to complete
 - Work starting on February 3, 2023
- **Work Hours:** Monday through Friday, 9am to 4pm
- **Traffic Control:**
 - Curb lane (far right lane) may be closed from Beverly Dr to Crescent Dr.
 - Pedestrian detoured to opposite side of work
 - Detour signs will be placed

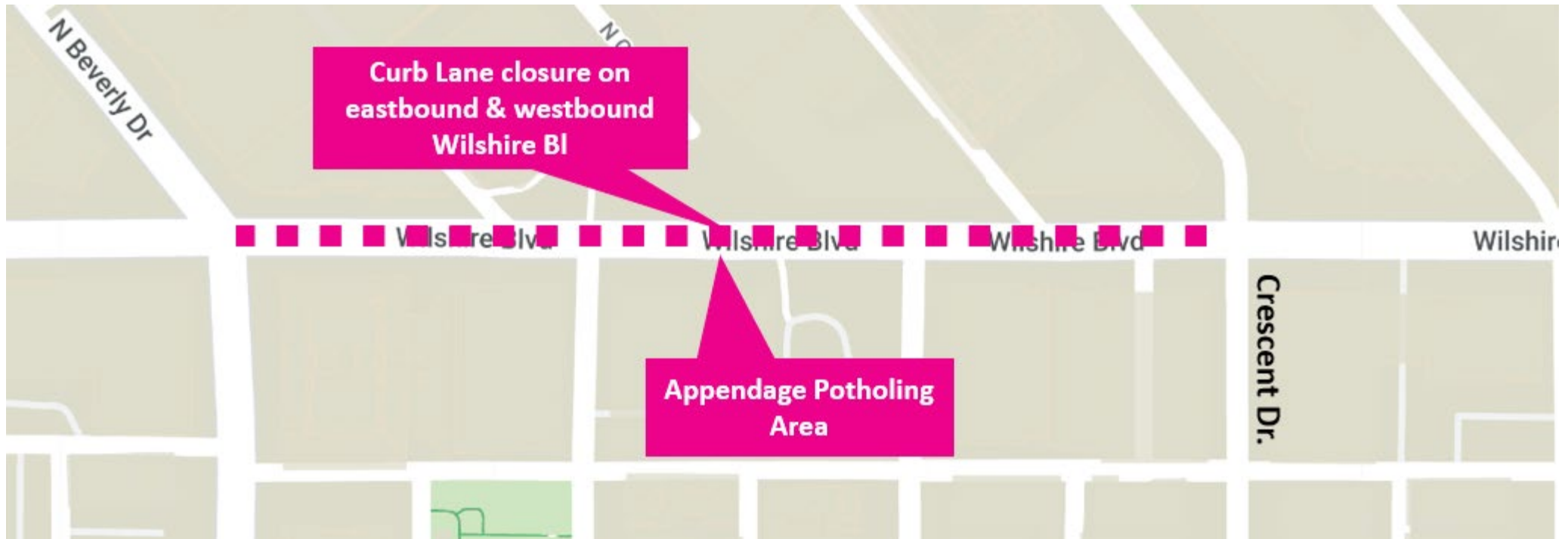

Upcoming Work – Appendage Piling

Contractor will begin piling activity in preparation for the construction of appendage structures.

- **Where:** Wilshire Bl between Beverly Dr and Crescent Dr.
 - Starting on north side of Wilshire Bl at Crescent Dr.
 - Shift to south side of Wilshire Bl after north side complete.
- **Duration:** Anticipated to start beginning of April
 - Approximately 2 months
 - 1 month on north side of Wilshire Bl
 - 1 month on south side of Wilshire Bl
- **Work Hours:** Weekdays and Weekends, 8am to 11pm
 - Closures remain in place 24 hours/day, 7 days/week
 - Non drilling activity from 9pm-11pm
- **Traffic Control:**
 - 2 lanes will be maintained on Wilshire Bl in each direction
 - Pedestrian access maintained

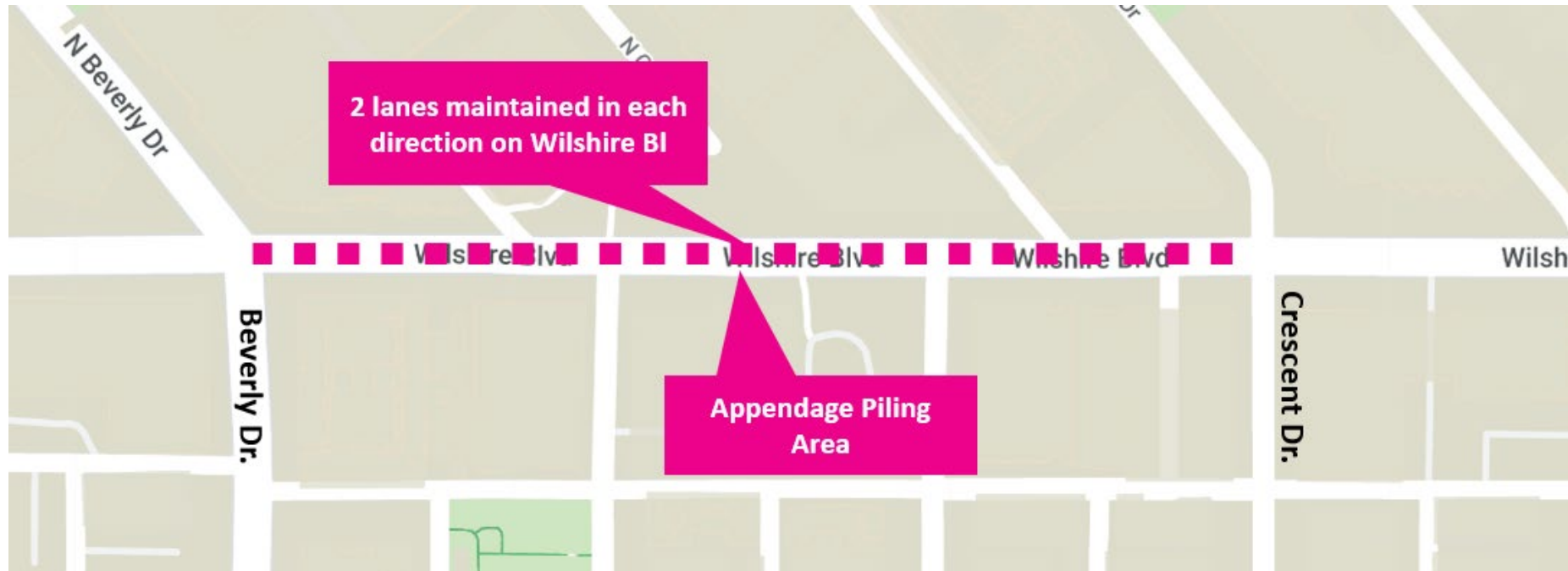

Wilshire/Rodeo Station: Geotechnical Instrumentation

- **Where:** Instruments installation has been completed along the tunnel alignment. Instruments monitor ground movement, settlement and other geological conditions
 - Maintenance work will be ongoing
- **Duration:** Ongoing
- **Work Hours On Wilshire Bl:**
 - Weekdays, 7am to 4pm and 8pm to 7am
- **Work Hours Off Wilshire Bl:**
 - Weekdays, 8am to 6pm and 8pm to 7am



Example of 10-foot geotechnical instrumentation pole.

Tunnel Boring Machine (TBM) Update

Mining Complete!

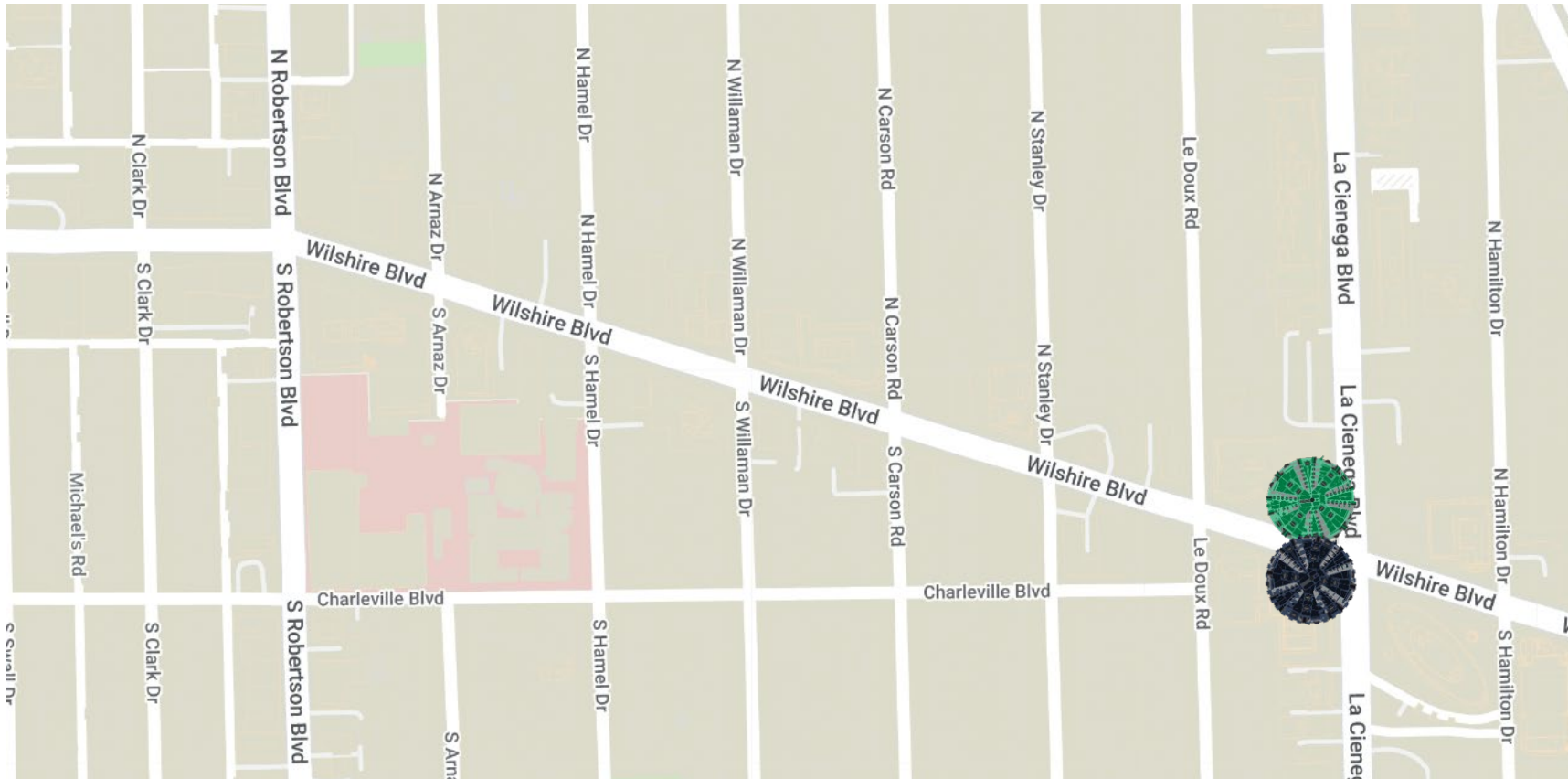

Tunneling Statistics As of (2/1/2023)

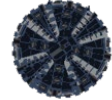
Ruth
 11,510 feet (total journey)
100% complete

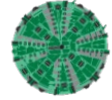
Harriet
 11,510 feet (total journey)
100% complete

- Both TBM's have completed mining at Wilshire/La Cienega. Completing a 2.5 mile journey.
- **Tunneling Duration:**
Approximately 2 ½ years from the start

Century City/Constellation Station Rendering



Century City/Constellation Station Box

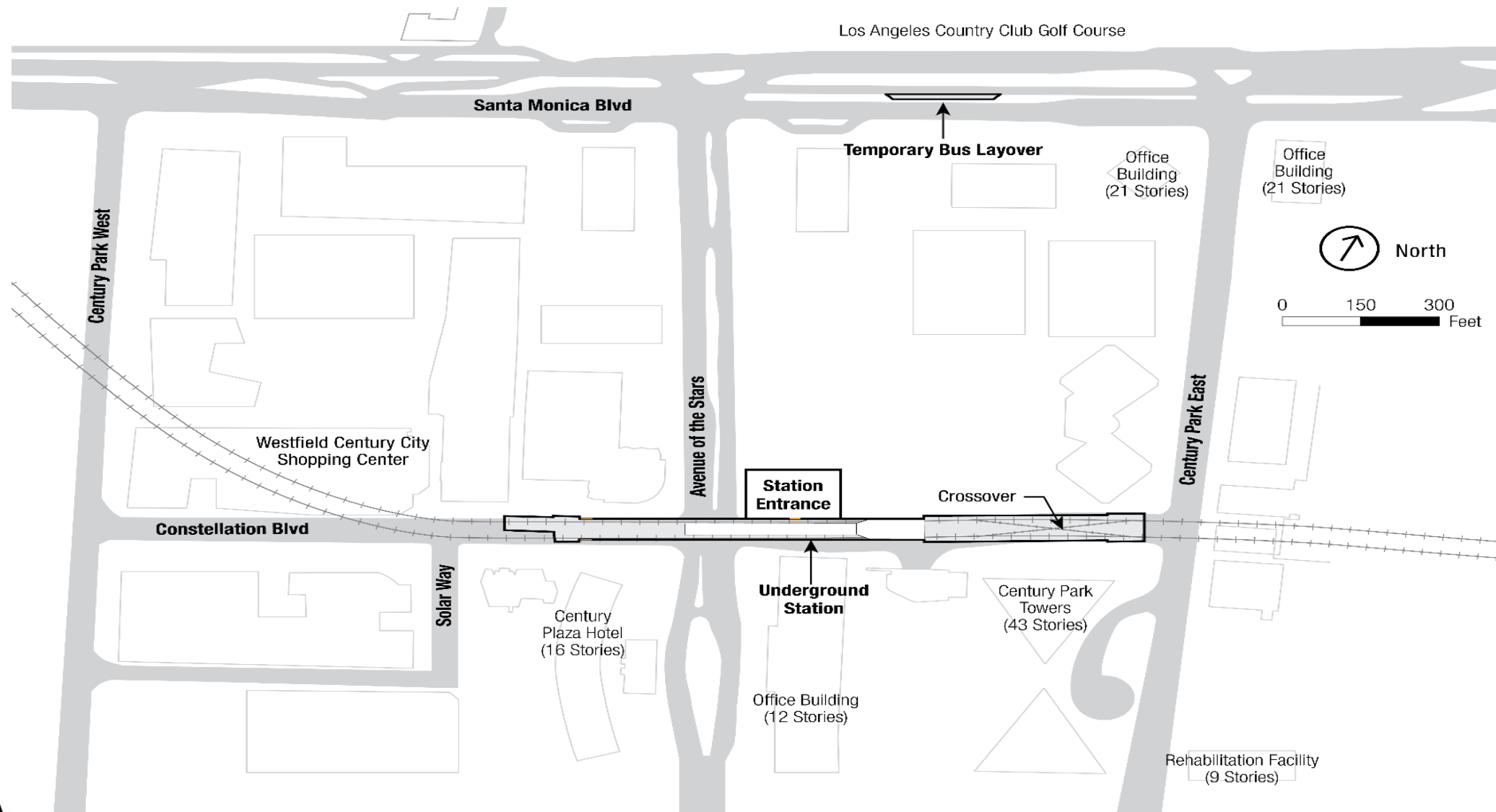

Station Excavation

- > Excavation of the underground station underneath Constellation Blvd. is in progress and will continue until reaching approximately 100 feet in depth.
- > **Work Hours:** 24 hours a day, 5 days a week (Monday – Friday)
- > **Anticipated Completion:** 1st quarter 2023
- > Temporary partial traffic lane closures may be required on Constellation Blvd. both east and west of Avenue of the Stars to facilitate this work.



Station Entrance Excavation



Station Entrance Excavation



Sanitary Sewer and Storm Drain Relocation

- > **Ongoing:** Work activity began in March 2022
- > **Anticipated Duration:** End of 1st Quarter, 2023
- > **Anticipated Traffic Control:**
 - > Lane closures on Avenue of the Stars
 - > Night closures (8pm to 6am) will be required intermittently

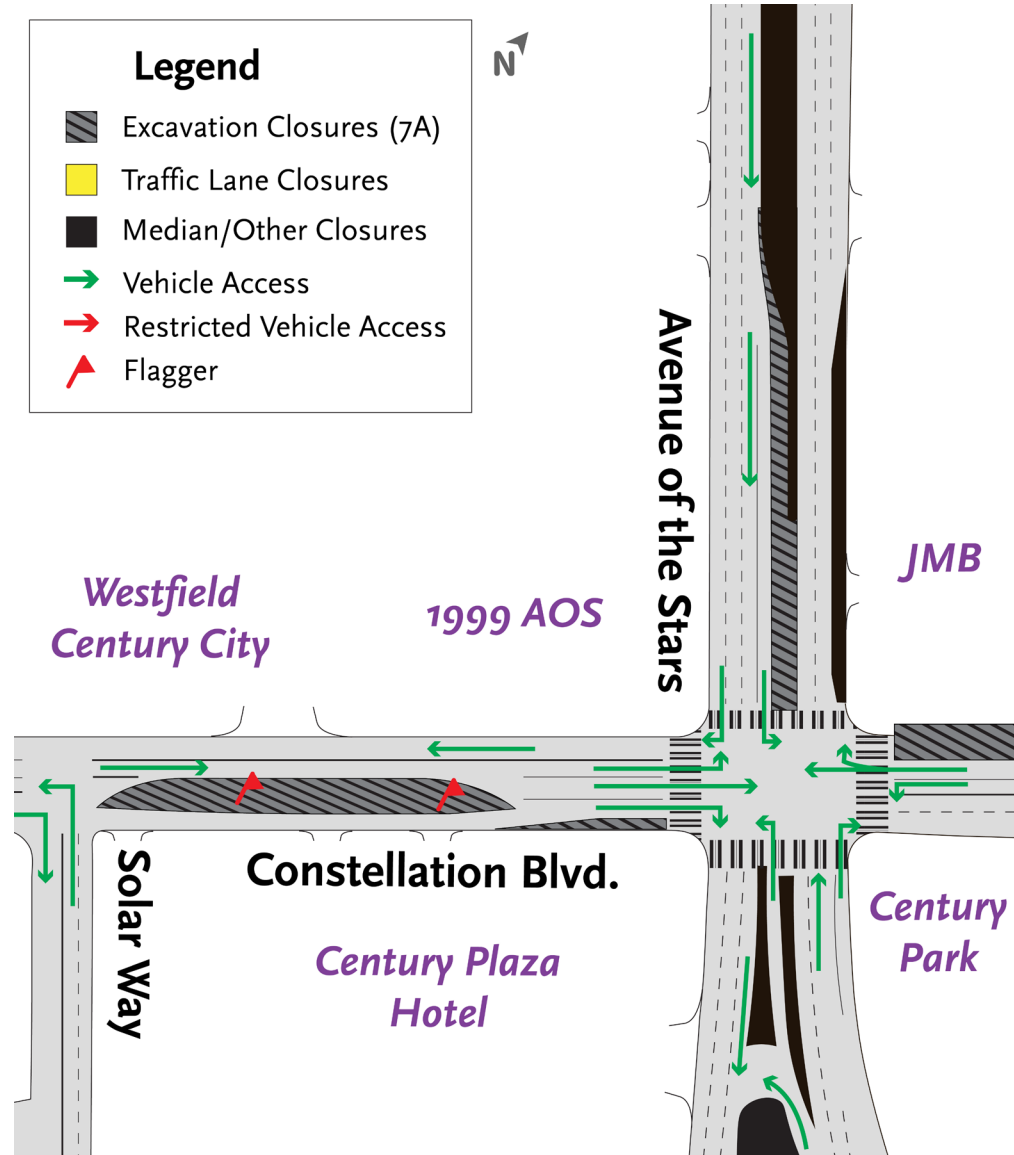

Stage 8 (Current Steady State Closures)

- > **Anticipated Completion Date:** End of 1st Quarter, 2023
- > **Work Hours:** 24 hours a day, 7 days a week
- > **What to Expect:** Potholing, piling, shoring, and utility installation

Traffic Control:

- > Left turns restricted on NB AOS onto WB Constellation Bl
- > Intermittent closure of access lane on south side of Constellation Bl.

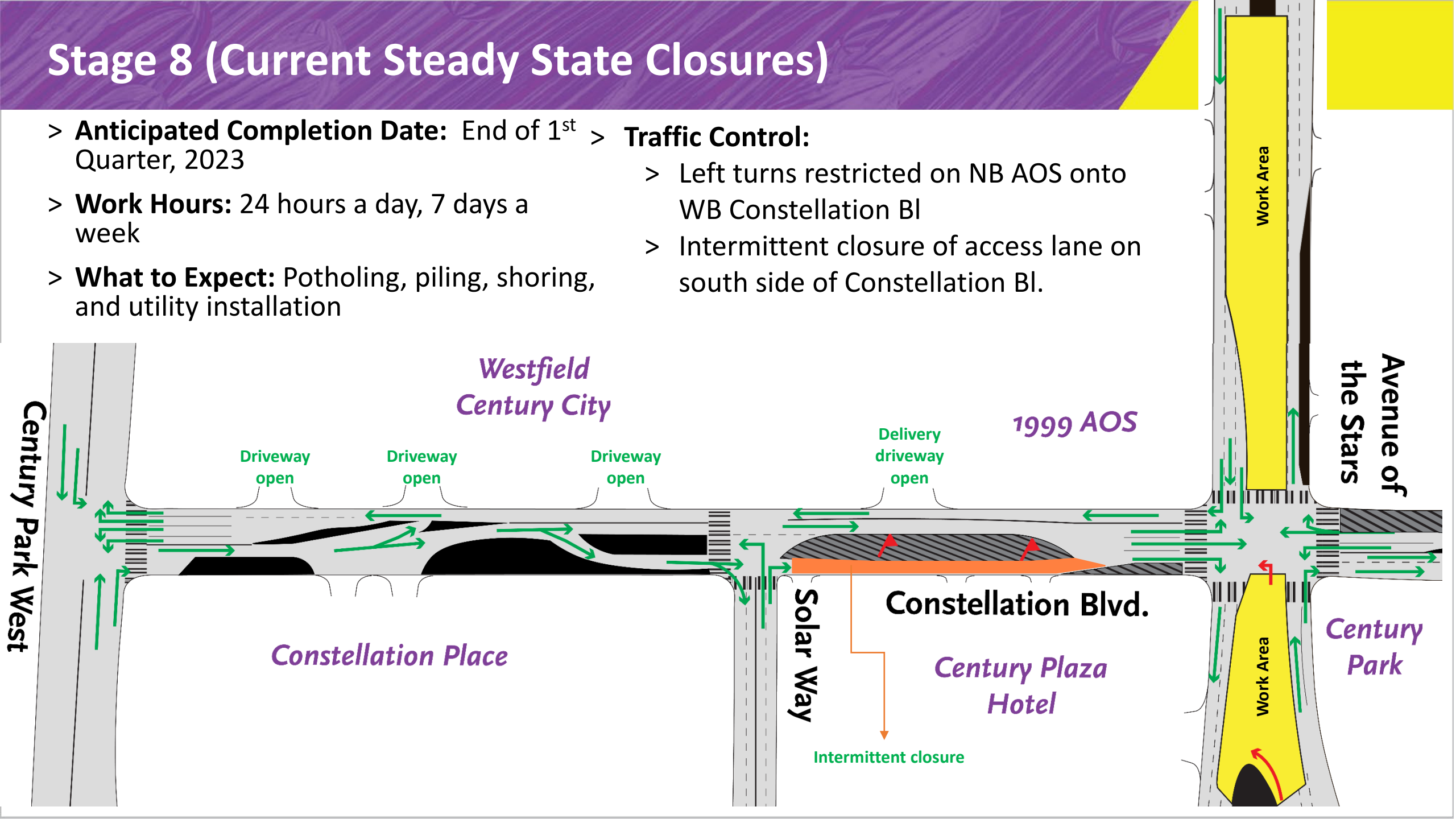

Stage 8.1

- > **Anticipated Duration:** Intermittently during Stage 8
- > **Work Hours:** 8pm to 6am
- > **What to Expect:** Potholing, piling, shoring, and utility installation

- > **Traffic Control:**
 - > Left turns restricted on SB AOS onto EB Constellation Bl
 - > Intermittent closure of access lane on south side of Constellation Bl.

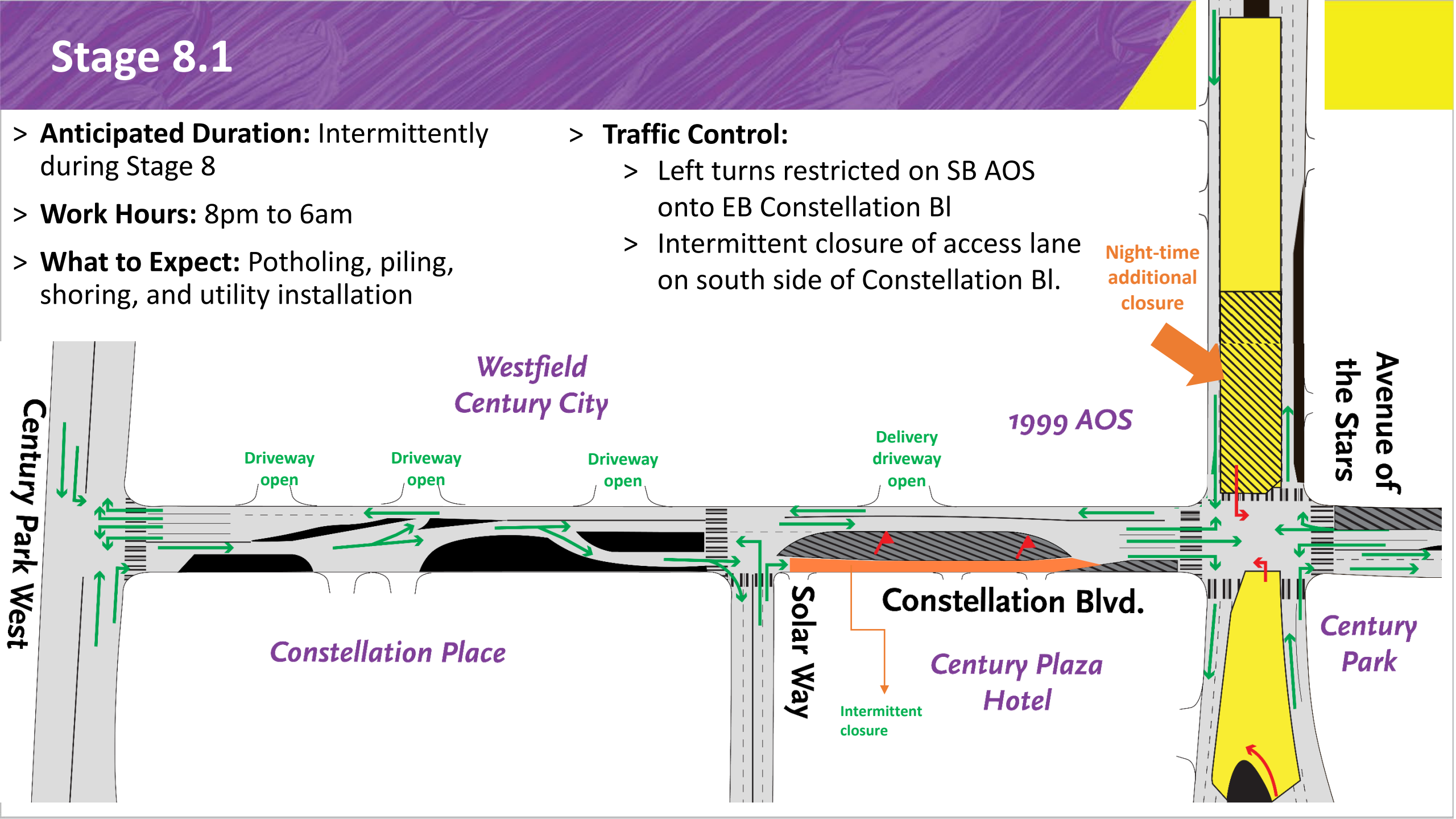

Upcoming Activity – Side Structure/Appendage Work

- > **Anticipated Start Date:**
February 2023
- > **Traffic Control:** Within current Stage 8 closures
 - > Additional traffic control needed after Stage 8 is complete.
- > **What to Expect:**
Potholing and Piling

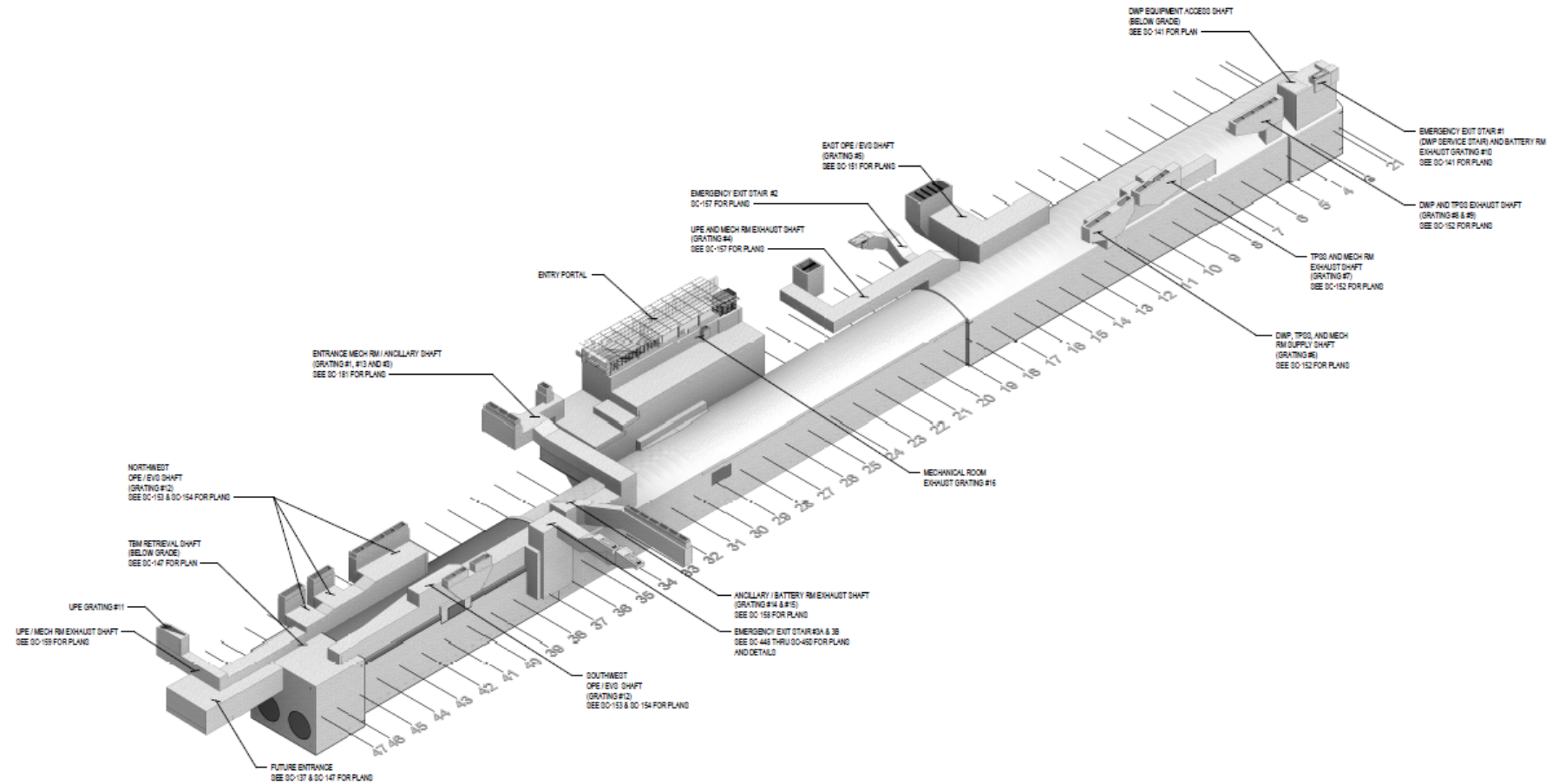

Stage 7B (Steady State Closure)

- > **Anticipated Duration:**

- > 2 years (Re-implemented after utility relocation)

- > **Traffic Control:**

- > One eastbound and westbound lane are accessible from CPW to AOS

- > Maintaining access to Westfield driveways and Fairmont Century Plaza Hotel

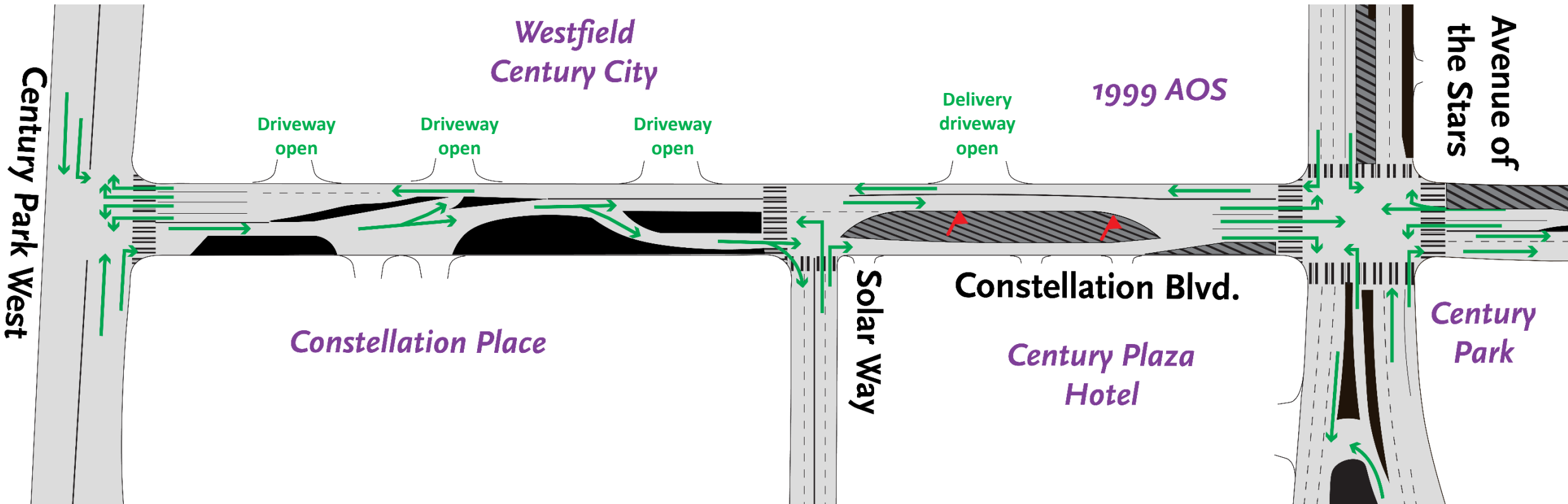



Next stop: Westwood.

PURPLE (D LINE) EXTENSION TRANSIT PROJECT
Section 3



Section 3 Tunnel from Century City to Westwood



Section 3 Tunneling Progress

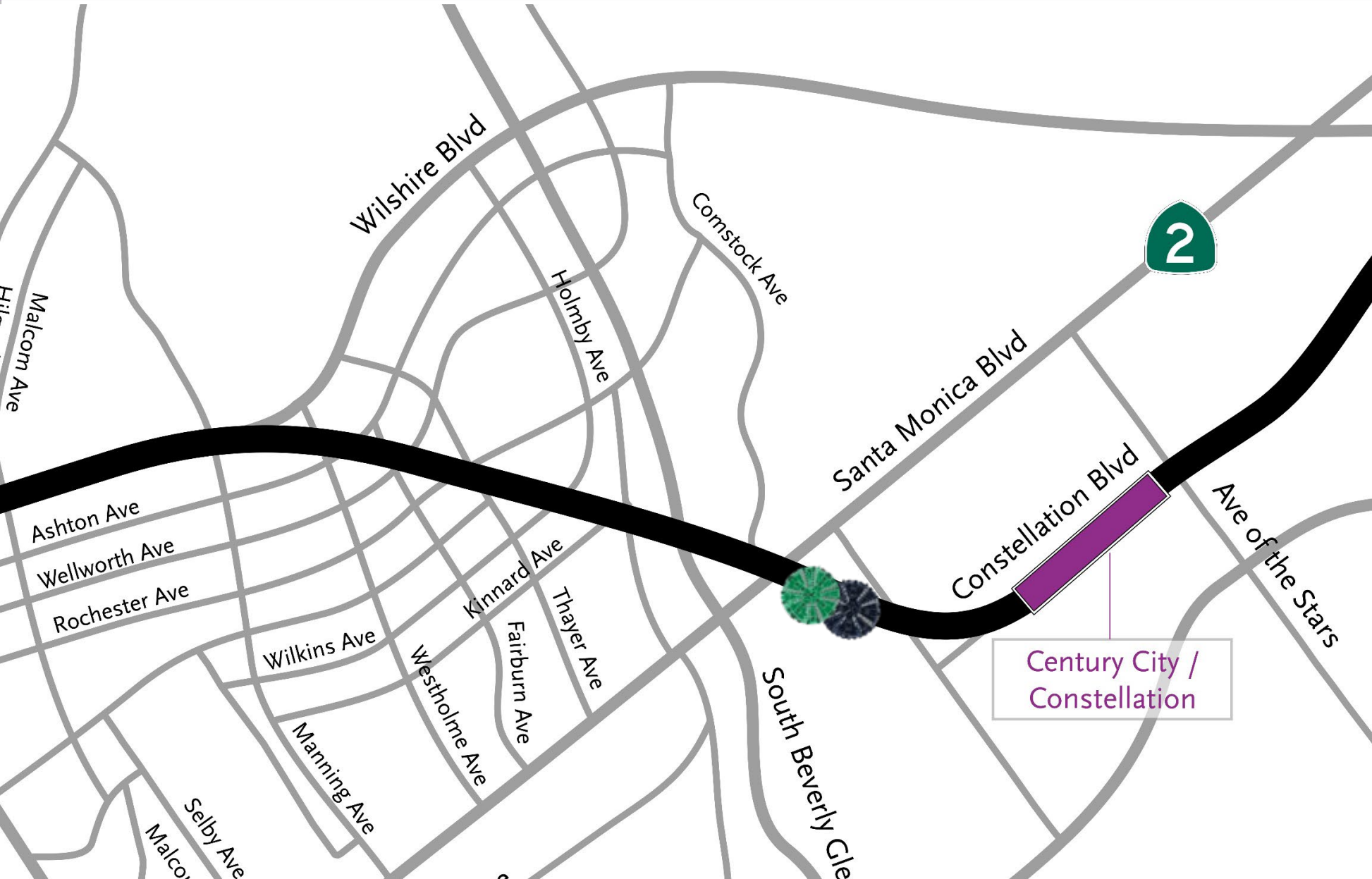

Tunneling Statistics as of 1/29/2023

Iris (TBM 1)
12,156 feet
90% complete

Aura (TBM 2)
11,932 feet
88% complete

 Future Station Boxes

Inside the BR TBM "Iris"



Precast tunnel segments in the BL TBM "Aura"



Instrumentation Work for Tunneling

- > **Anticipated Completion Date:** February 10
- > **Work Hours:** 9am to 3:30pm
- > **What to Expect:** Drilling and Instrumentation Installation

- > **Traffic Control:**
 - > Missouri Closure at Fox Hills Dr.
 - > Fox Hills Dr. Closure at Missouri

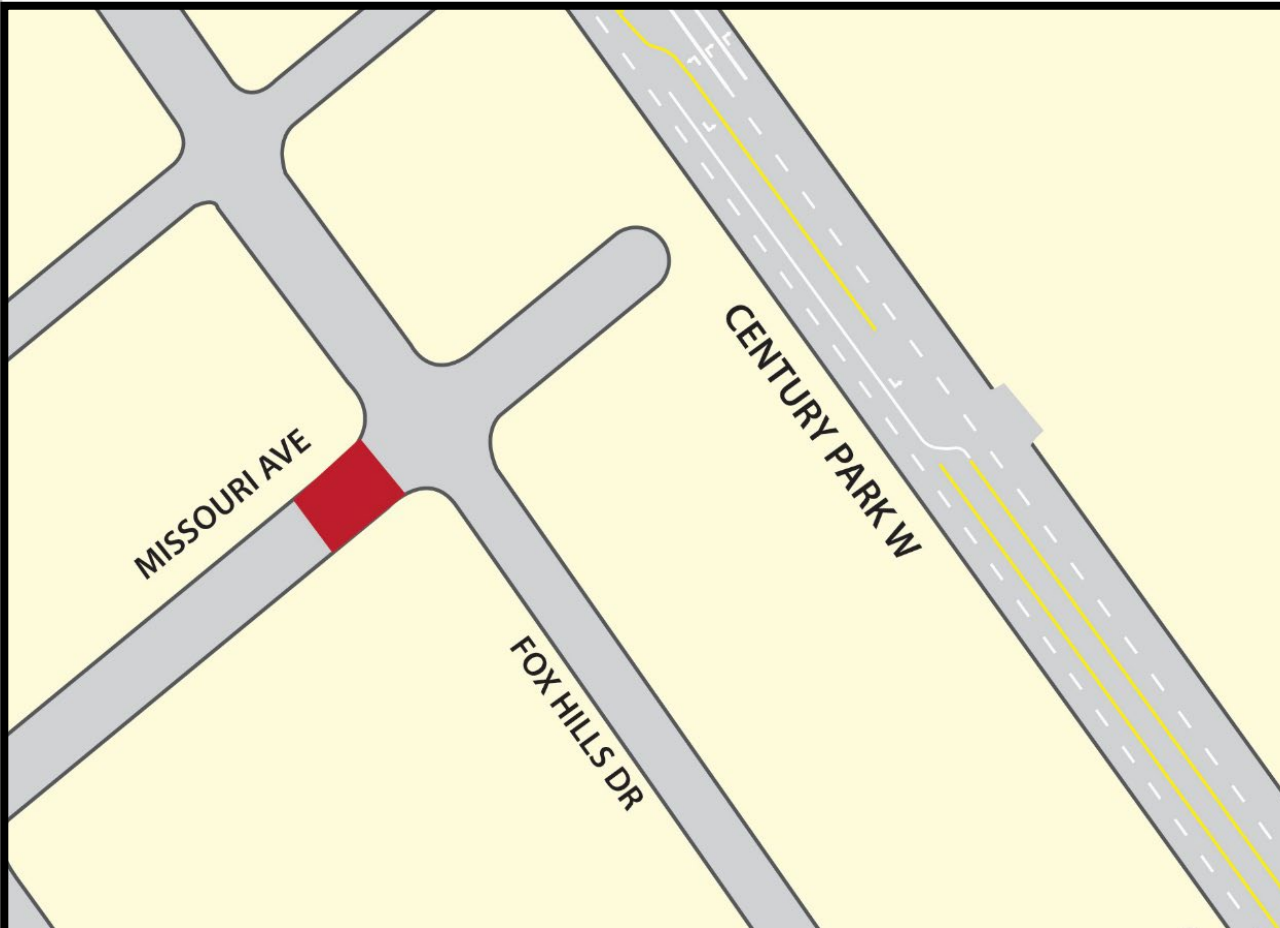

Instrumentation Work for Tunneling

- > **Anticipated Completion Date:** February 10
- > **Work Hours:** 9am to 3:30pm
- > **What to Expect:** Drilling and Instrumentation Installation

- > **Traffic Control:**
 - > Intermittent lane reductions on Century Park West
 - > Driveway access will be maintained

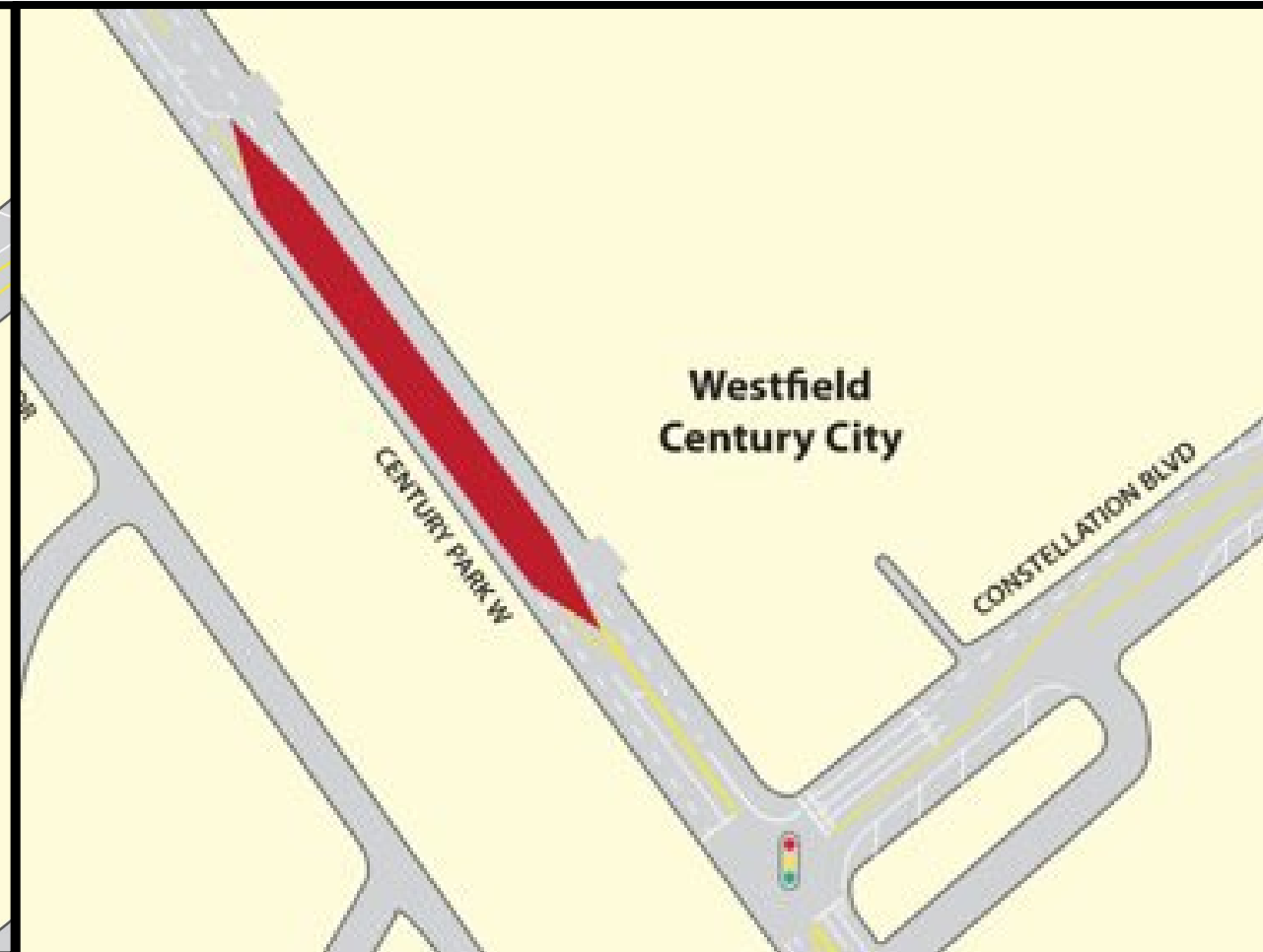

Instrumentation Work for Tunneling

- > **Work Hours:** 9am to 3:30pm
- > Southbound lane reduction on Century Park West

- > **Work Hours:** 10pm to 6am
- > Eastbound lane reduction on Constellation Bl

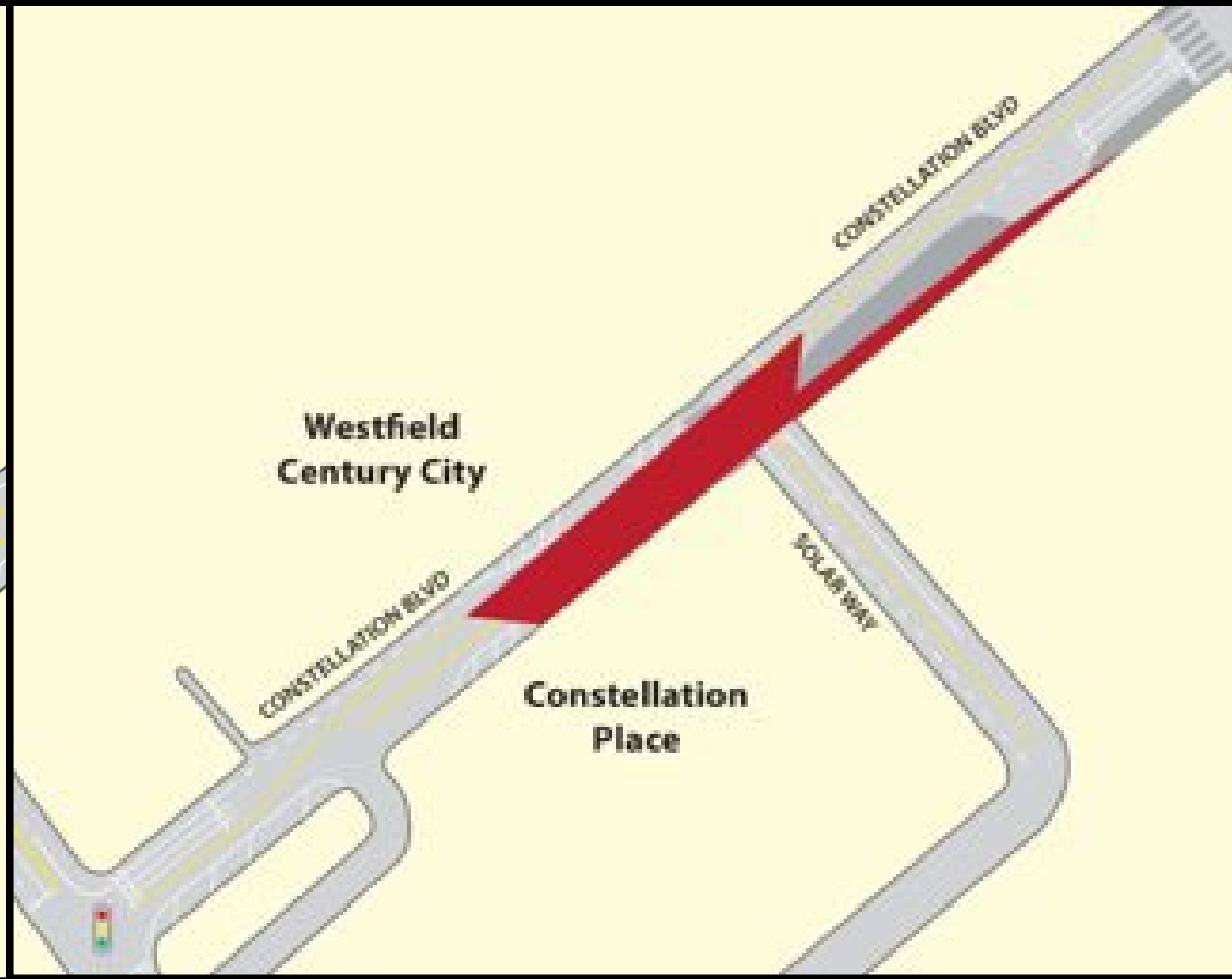
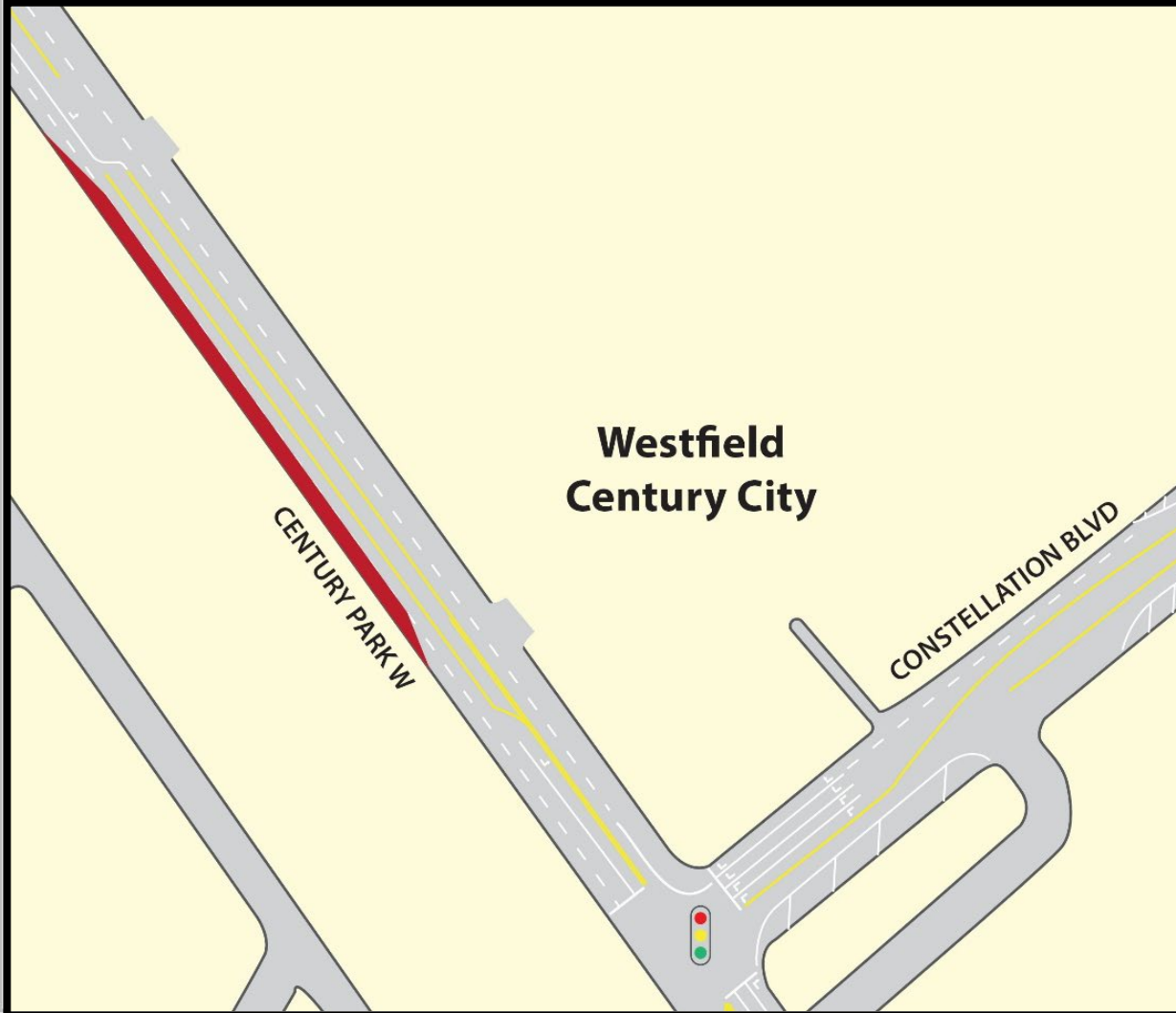

Installing Settlement Markers for the Tunnels

Horizontal drilling to install settlement markers under Westfield Century City .
Settlement markers help monitor ground movement during tunneling.

Where: Constellation Bl near Solar Way,
Inside the existing Sec 2 closure.

When: February 6, for approximately 1 month

Work Hours: 9pm to 6am, Monday to Friday

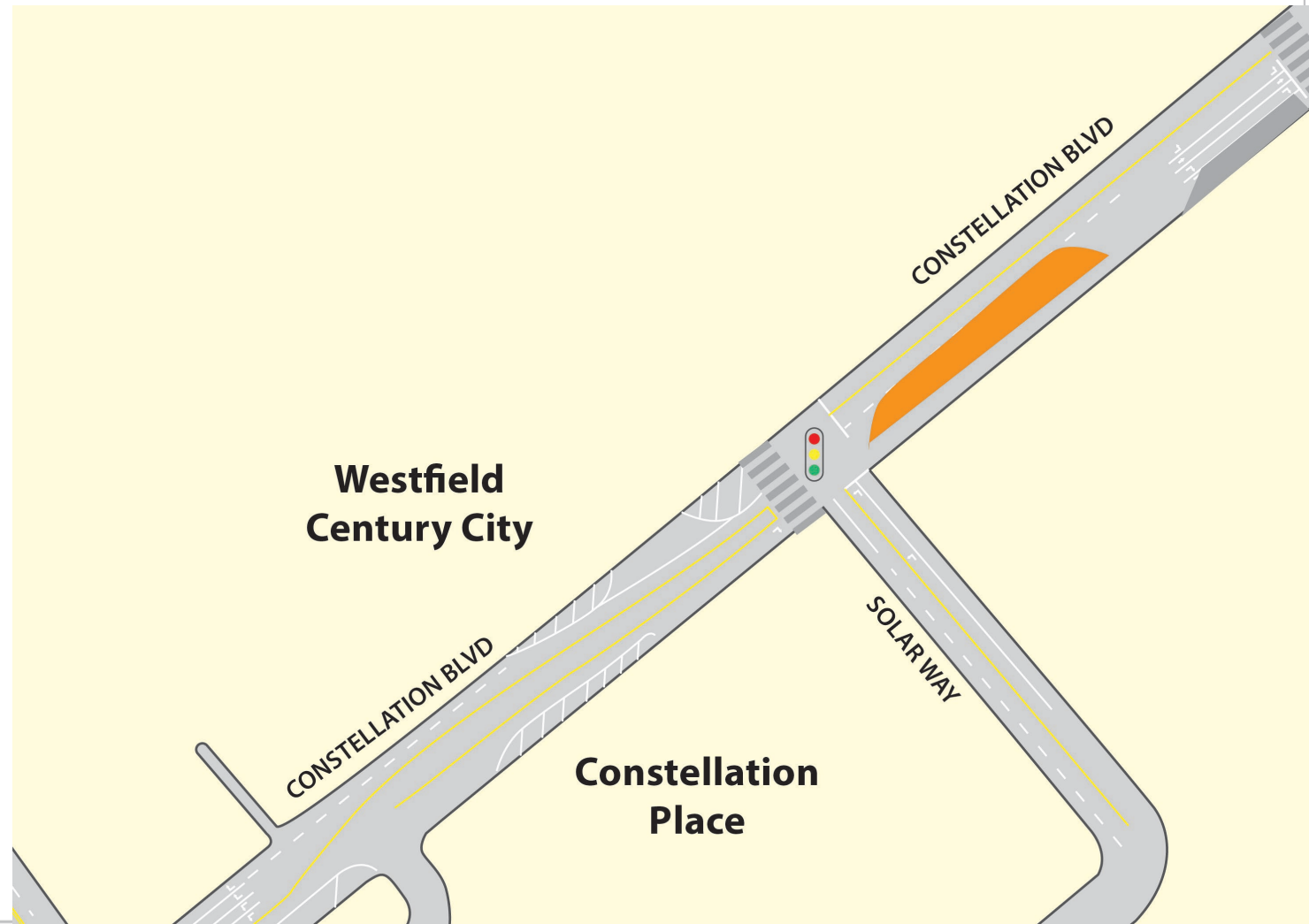

Westwood/UCLA Station Rendering (Northwest Entrance)



Westwood/UCLA Station Rendering (Northeast Entrance)



Westwood/UCLA Station Rendering (Southeast Entrance)



Westwood/UCLA Station Box



Rendering shows length of the underground station box on Wilshire Bl between Westwood Bl and Veteran Av.

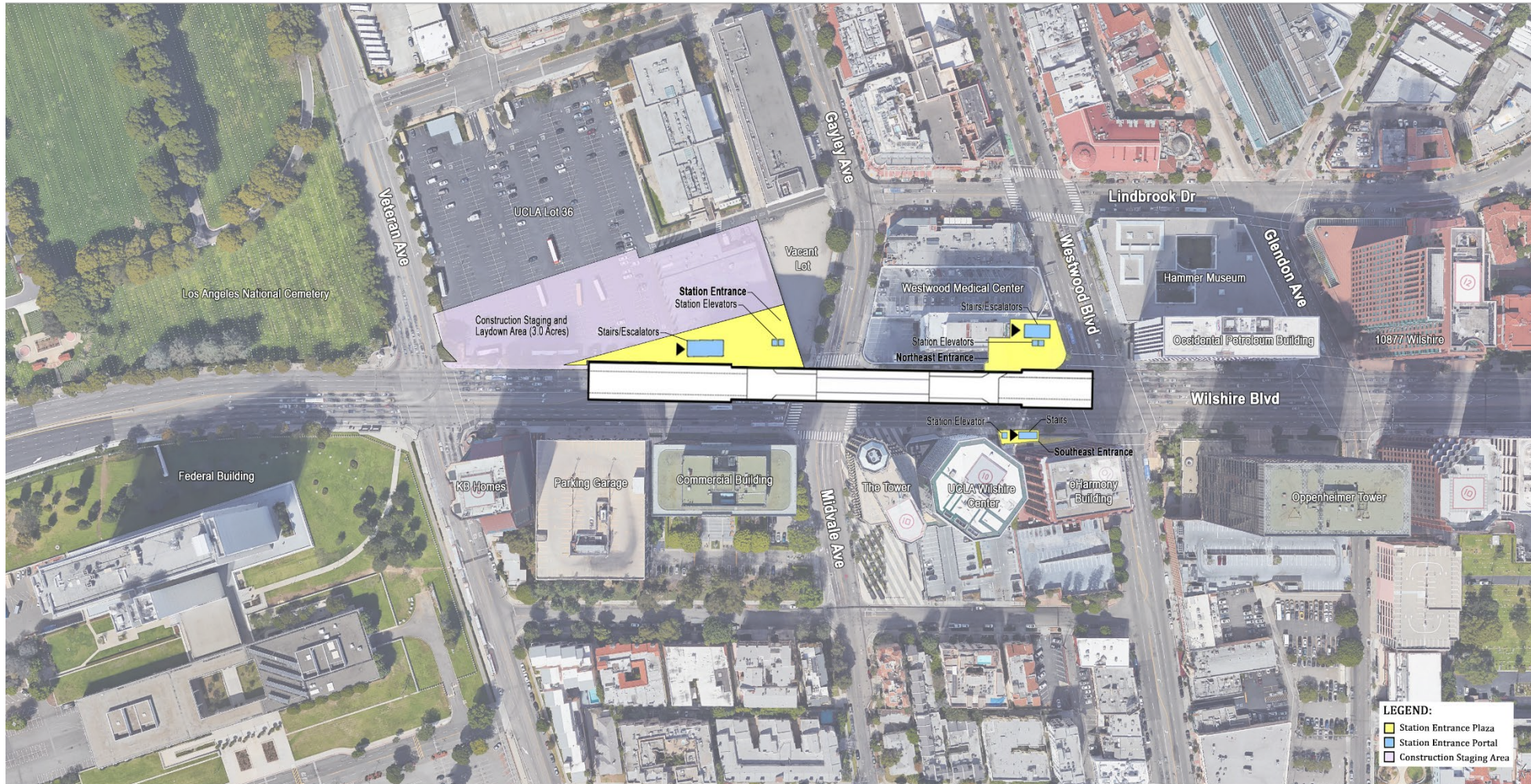

Construction continues in UCLA Lot 36. Some work may overlap onto the sidewalk.

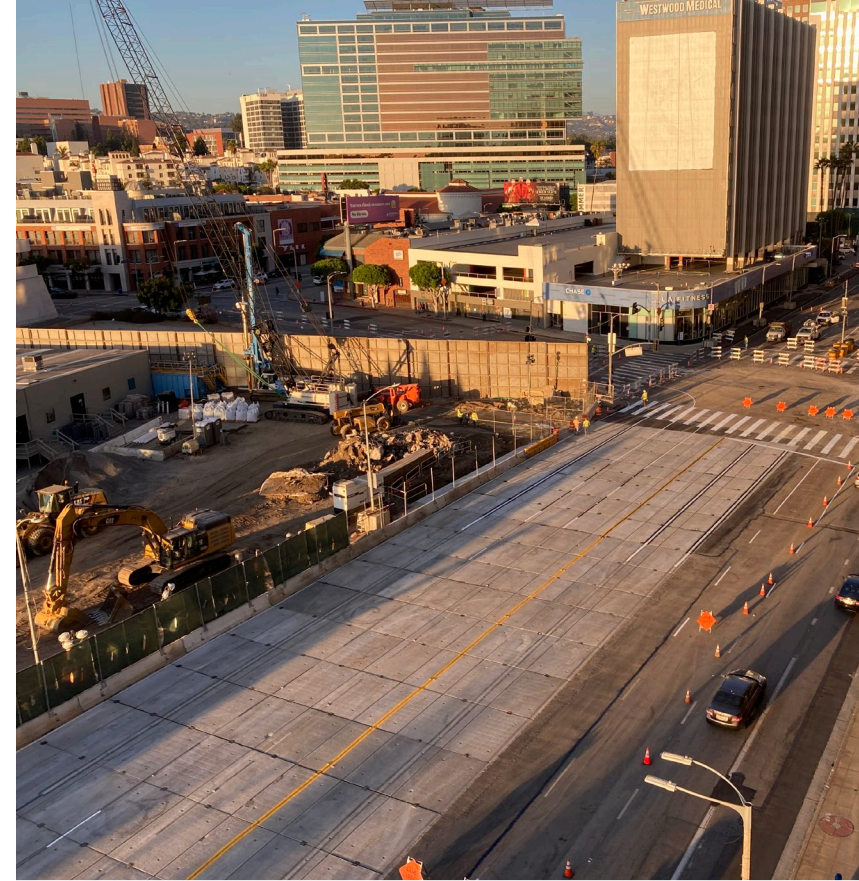

Decking on Wilshire Bl between Veteran Av and Westwood Bl.

Excavation for the Westwood/UCLA Station

Work includes mass excavation, hauling, bracing installation, lagging, and station ventilation installation.

The work will happen primarily underground.

Hauling of materials will also occur throughout the day by using the driveways on Veteran Av and Wilshire Bl.

Where: UCLA Lot 36

When: November 2022 through November 2023

Work Hours: Day and Night Shifts

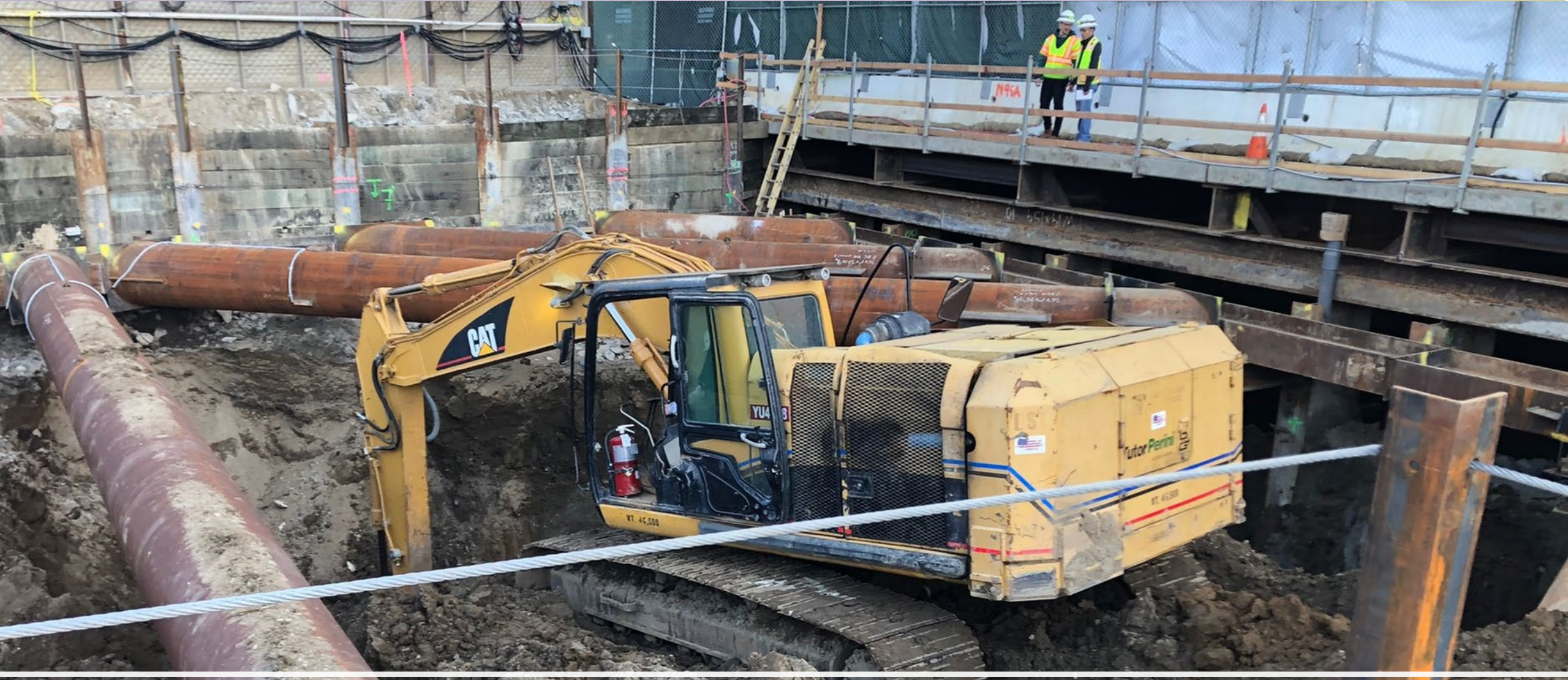

Westwood/UCLA Station Excavation

Installation of Storm Drain

Storm drain installation for the future Westwood/UCLA Station.

The work will require eastbound lane reductions on Wilshire Bl between Veteran Av and Westwood Bl.

There will be no impact to utilities.

Where: Wilshire Bl intersections of Westwood Bl and Gayley Av.

When: October 2022 to February 2023

Work Hours: 9pm to 6am, Monday to Friday, and continuous weekends, 10 pm Friday through 6am Monday

Temporary Power Support

Preparation of temporary power for excavation of the future Westwood/UCLA Station.

Work will occur on Wilshire Bl and Gayley Av/ Midvale Av for approximately three months.

Eastbound Wilshire Bl lanes will be reduced between Veteran Av and Westwood Bl.

No through traffic at the intersection of Wilshire Bl and Gayley Av/Midvale Av.

The south leg crosswalk will be closed.

Where: Gayley Av/Midvale Av and Wilshire Bl.

When: January 2023 to March 2023

Work Hours: 9pm to 6am

Westwood/VA Hospital Station Rendering



Westwood/VA Hospital Station Rendering (Bonsall Av)



Westwood/VA Hospital Station Box

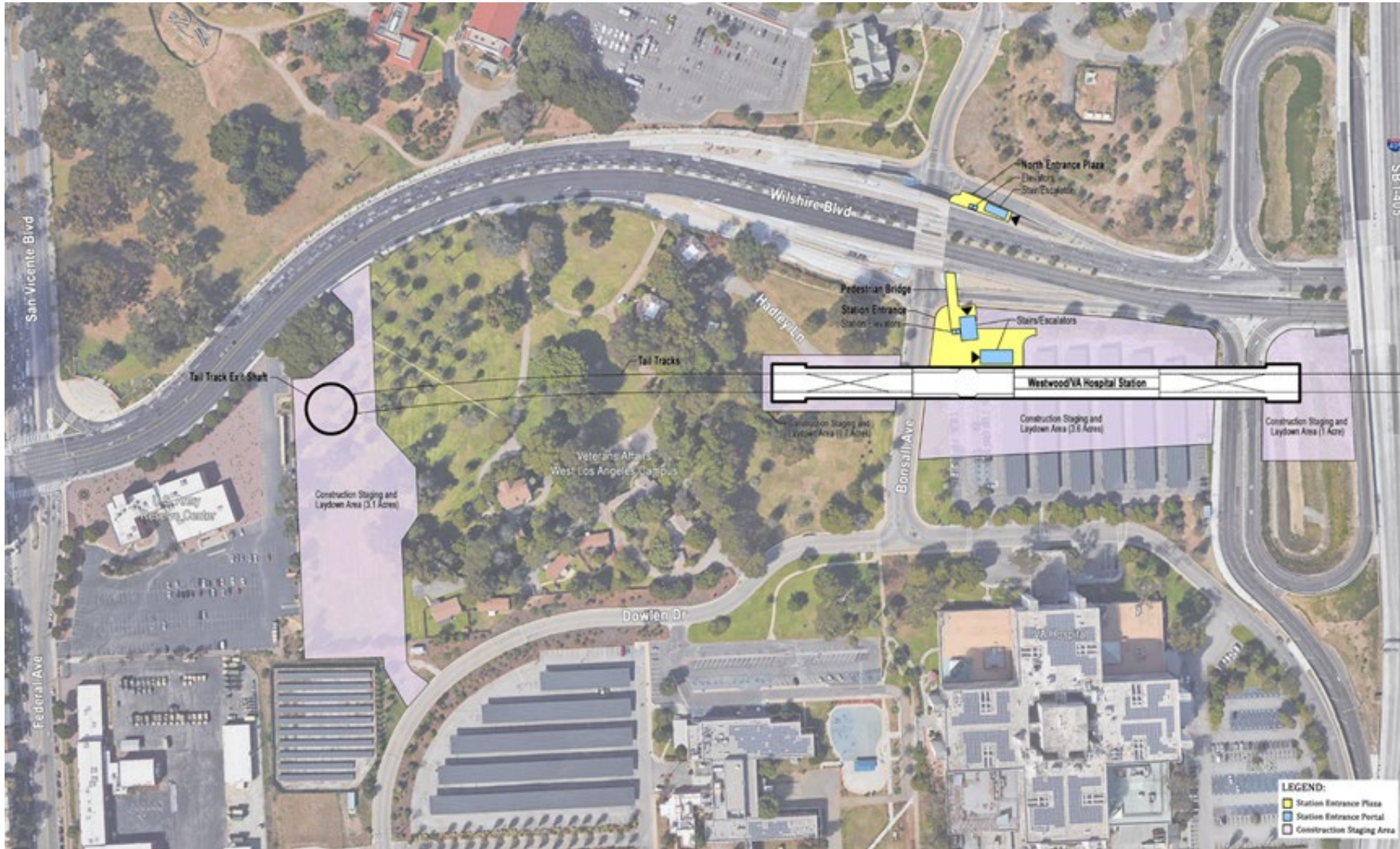

Rendering shows length of the underground station box on Wilshire Bl and Bonsall Av

Excavation for the Westwood/VA Hospital Station

Work includes mass excavation, hauling, bracing installation, lagging, and station ventilation installation.

Where: VA Lot 42 and the West of Bonsall Av staging yard

When: October 2022 through October 2023

Work Hours:

Excavation and related activities: 5pm to 6am and 6am to 5pm

Hauling: 9am to 3pm

Metro's Station Naming Policy

Metro will begin the Station Naming surveys for Section 3 in Spring 2025.

Station Names will reflect the following principles

- **Transit system content:** Names will reflect the property's location, relative to the entire transit system, and not duplicate elsewhere.
- **Property area:** provide specific information about the property's location relative to the surrounding area.
- **Neighborhood identity:** Acknowledge the communities and neighborhoods services by the station and stops.
- **Simplicity:** Names will be short, easily recognizable and fit for signage and mapping.

Metro's Station Naming Policy

- Initial station names were identified during the project planning process, primarily based on geographic location.
- Metro staff will solicit input from cities, communities, and other stakeholders on preferred station names based on the Board-adopted naming criteria.
- The resulting station names will be reviewed by a focus group comprised of both transit system users and non-users for general public recognizability.
- Metro staff will return to the Metro Board Construction Committee and then to the full Metro Board for adoption of the final set of official station names.

EAT SHOP PLAY



Eat Shop Play has highlighted local businesses along the Purple Line Extension project in Koreatown, Miracle Mile, Beverly Hills, Century City, and Westwood, especially eateries and specialty businesses operating pick-up and delivery during the past months.

The Eat Shop Play program continues supporting local businesses as construction progresses by promoting them through regular social media posts and newsletters.



EAT SHOP PLAY

KOREATOWN

RVM Salons

5356 Wilshire Bl

Rashard uses hair as his canvas, bringing a distinctive aesthetic and fresh approach to draw out each client's unique beauty.

Business hours:

Sun – Mon: Call for Availability

Tues – Sat: 8pm – 11pm

Rvmsalons.com

323.746.5406



EAT SHOP PLAY

MIRACLE MILE

I Love LuLu Hair Cafe

733 S La Brea Av

They are a best-in-class and unique hair salon providing services and products to help you grow and maintain healthy hair, naturally.

Business hours

By booking

iloveluluhairspa.com

(323)934.5727



EAT SHOP PLAY

BEVERLY HILLS

Bombay Palace

8690 Wilshire Bl

Bombay Palace takes an approach to multi-ethnic cooking that celebrates the very best of Indian foods.

Business hours

Mon - Thur: 11:30am - 3pm, 5:30-10:30pm

Fri : 11:30am - 3pm, 5:30-11:0pm

Sat: 12-3PM – 5:30-11:30pm

Sat - Sun: 12-3PM – 5:30-10:30pm

www.bombaypalace.com

310 659-9944



EAT SHOP PLAY

CENTURY CITY

Mrs. Winston's
1999 Ave of the Stars

Voted L.A.'s Best Salad Bar, they offer locally sourced organic products, always focusing on the healthiest and freshest ingredients. Each menu item is made in-house daily with love by their dedicated team.

Business hours
Tue – Fri 11:30am -1:30pm, 5-9:30pm
Saturday: 5-9:30pm

mrswinstons.com
310.553.4100



EAT SHOP PLAY WESTWOOD

Egg Tuck

1049 Gayley Av

"PINNACLE OF EXTRAORDINARY EGG SANDWICH EXPERIENCE." Their sandwiches are all made from scratch with cage-free eggs on a house-made premium brioche bun.

Business hours

Open Daily 7:30am-4pm

Eggtuck.com

310.824.8188



EAT SHOP PLAY WESTWOOD

Flax Pen

1078 Gayley Av

In addition to a curated selection of fine Stationery and pens, they offer services and host events.

Business hours

Tues-Fri: 11am – 6:30pm

Sat: 11am – 5:30pm

www.flaxpentopaper.com

310.208.3529



EAT SHOP PLAY



Contact Us

- > For more information on Eat Shop Play visit metro.net/eatshopplay
- > Send an email to eatshopplay@metro.net

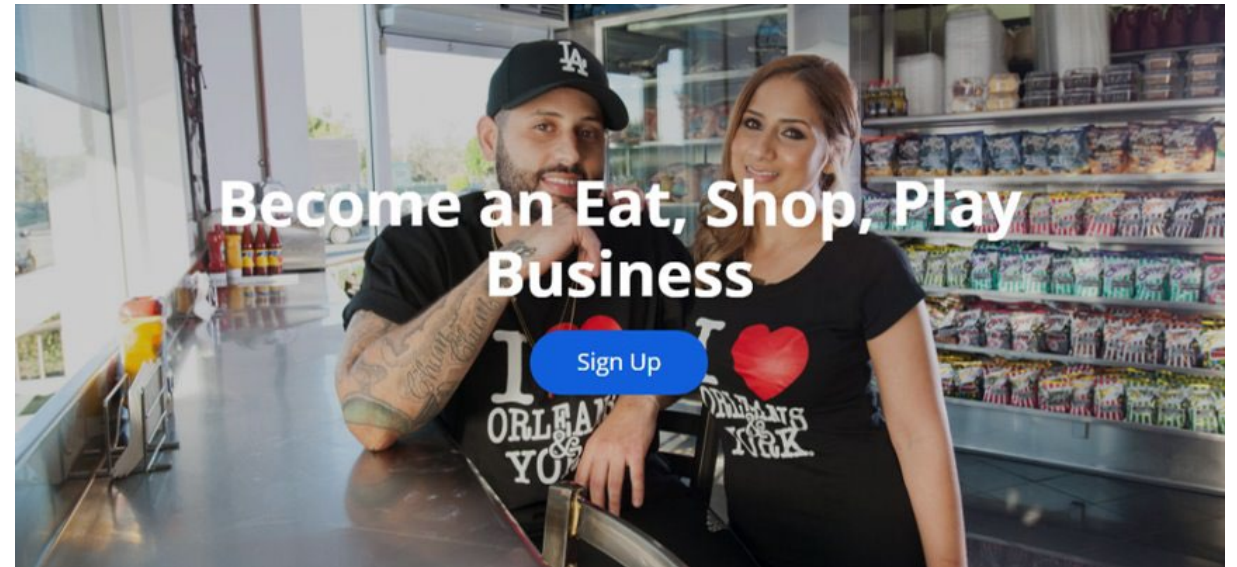

Business Interruption Fund (BIF)



Metro's Business Interruption Fund

BIF Information and Eligibility

- Financial assistance to small “mom & pop” businesses with 25 or fewer full-time employees directly impacted by Metro Rail construction along three project areas:
 - Crenshaw/LAX Transit Project
 - Purple Line Extension, Sections 1, 2 & 3
 - Regional Connector Project, Little Tokyo area & 2nd/Broadway Segment*
- Businesses must be located immediately adjacent to the rail corridor and meet other eligibility requirements
- Grant amounts are determined by business revenue loss directly related to period of Metro construction disruption
- Businesses may receive up to \$50,000 per impact year

*Segment eligibility based on full street closure with duration greater than six continuous months. Eligibility ended 6/30/17.

Metro's Business Interruption Fund

Metro's Business Interruption Fund (BIF) is **accepting applications** for transit rail **construction impact** along the Crenshaw/LAX Transit Project, the Little Tokyo area of the Regional Connector and Sections 1, 2 and 3 of the Purple Line Extension **sustained from March 20, 2020 going forward** (during the COVID-19 pandemic).

- **Small “mom and pop” businesses** that experienced transit rail construction impact during the COVID-19 pandemic **may be eligible**.
- Potentially eligible small business owners may *contact BIF Fund Administrator Pacific Coast Regional at 213.739.2999 x223 or Metro at bif@metro.net*.

Metro does not cover revenue loss nor fixed operating expenses related to COVID-19 impacts.

Metro's Business Interruption Fund

Value of BIF Grants Awarded:
\$36,268,644

(*as of 1/27/23)

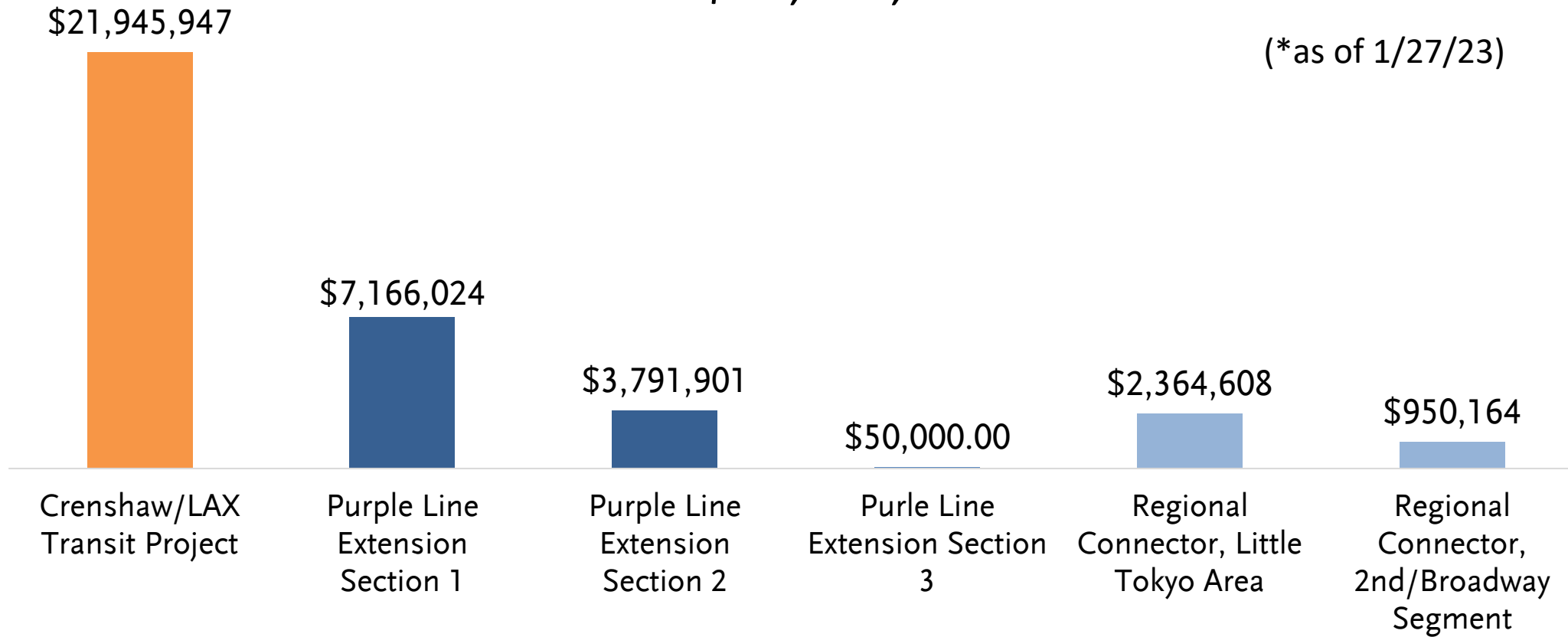

***BIF Grants do not cover COVID-19 related impacts.**

Stay in Touch

Upcoming Meetings

Purple (D Line) Extension Transportation
Project Sections 1 and 2
March 1, at 6PM, In-Person

Beverly Hills City Hall
Held in the Municipal Gallery at
455 N Rexford Dr, Beverly Hills, CA 90210



213.922.6934



purplelineext@metro.net



metro.net/purple



@purplelineext



facebook.com/purplelineext