



1st/Central Station Improvement Project

Open House

October 27, 2016

METRO

Los Angeles County Metropolitan Transportation Authority



**HUNT
DESIGN**



LHBE
LANDSCAPE ARCHITECTS



LIGHTING DESIGN ALLIANCE

AECOM



1st Street:

- General support for concepts
- Maintain as pedestrian friendly
- Maintain street parking
- Do not support cycle track between San Pedro and Alameda (there is no cycle track in this section)
- Want/need change on 1st Street but not sure what that change is

1st Street:

- No consensus on 1st Street improvements
- Remove all street parking to accommodate bike lane
- Don't want cut-through traffic
- Make pedestrian promenade (prohibit cars on 1st Street)
- Widen sidewalks
- Traffic calming to accommodate bike lane

1st Street:

- Need loading zone
- Bike lane will increase traffic
- Relocate bike lanes in tunnel under street
- Prefer sharrows
- Placing trees on north side of street will decrease sidewalk space
- Pleased that street parking will remain
- Prefers street parking over traffic calming

Bike Improvements:

- Supports bike lanes on Los Angeles Street (but not directly in front of hotel – tour bus loading)
- Not having a bike lane will be unsafe
- Are bike plans part of the 2010 Master Plan?
- Safety concerns about parking and bike lanes on Santa Fe
- Bike improvements will cause increased traffic
- Would like the bike lane extended to 7th Street

Landscaping:

- Who is responsible for maintenance of trees and bioswales
- No large trees
- No dirty trees
- The TIGER Grant nor ATP elements accurately represent what Little Tokyo wants or needs for landscaping

Landscaping:

- Remove all ficus trees
- Use ginkgo and other trees that have a “Japanese” style
- Would like input on tree selection
- Would like to work with Metro on long term tree and bioswale maintenance

Lighting:

- Would like to see more lighting in the Arts District
- Would like to see 1st and 2nd Streets as priorities for lighting

Signage:

- Consider new name for 2nd/Traction – “Gateway – People Street”
- Would like more connections between Little Tokyo and the Arts District

Traffic and access (not bike related):

- Locate bus layover zone in center of Los Angeles Street
- Relocate taxi zone (don't block hotel entrance)
- Reverse traffic flow during peak hours on Los Angeles Street
- Access concerns on Rose Street for businesses

Sidewalk/Lighting/Signage/Landscape General:

- Need for wider sidewalks
- People Street improvements
- Ensure Little Tokyo has a “physical welcoming presence” for visitors
- Would like to see more resources support the area south of 1st Street in the Arts District

Sidewalk/Lighting/Signage/Landscape General:

- Would like to see improvements extend the full block on Traction Avenue
- Would like to see improvements on Azusa and Onizuka Streets
- Would like specific designs for Arts District crosswalk improvements







- Bicycle Access, Traffic and Parking
 - Increased traffic from bike lane - want to see traffic analysis
 - Bike lane on 1st Street would be safer for bicyclists
 - Wider sidewalks
 - Scramble crosswalks
 - Improvements on Asuza Street
 - Street parking
 - Sharrows – support and oppose (both opinions)
 - Access to 1st Street businesses and parking garage at Central Avenue

- Landscape and Street Furniture
 - Don't include trees that block signage and buildings
 - Who provides maintenance
 - BID wants more say in landscape plan if BID will be responsible
 - More trash cans
 - NO PLASTIC BOLLARDS
 - Make landscape and street furniture improvements with the Art Walkway in mind
 - Include Azusa Street

- Signage
 - Include walking times on destination maps, signs and brochures
 - Place maps at *Koban*
 - Show connectivity between Little Tokyo and the Arts District on signs
 - Create a mobile sign app that provides more community background, history, destination, transit information, parking, etc.
 - Include Azusa Street

- Lighting
 - Why are lights only on certain streets
 - Need pedestrian lighting:
 - Alameda Street north of Temple Street
 - San Pedro Street near 3rd Street
 - Central Avenue near 3rd Street
 - Include Azusa Street

Community Outreach – Letter for LTCC Board



Little Tokyo Community Council
369 East First Street, Los Angeles, California 90012
213.293.5822
Email: info@littletokyola.org <http://littletokyola.org>

September 29, 2016

Ms. Dolores Roybal Saltarelli
Project Manager
Metro
One Gateway Plaza
Los Angeles, CA 90012-2952

Ms. Roybal Saltarelli:

On behalf of the Board of the Directors of the Little Tokyo Community Council (LTCC), I wanted to communicate our concerns about the proposed changes to First Street in the heart of Little Tokyo.

Several of the LTCC Board members have been following the progress of the proposed improvements when they were first introduced under the Linkages program. LTCC agreed to support Metro's application for the Tiger IV Discretionary Grant for both Little Tokyo and the Arts District. Throughout this process, LTCC and its representatives had been assured that we would be allowed input before major plans were finalized.

After the September 22, 2016 Community Meeting at the Japanese American Cultural and Community Center, it was apparent to members of the LTCC Board that certain decisions had been made concerning the proposed improvements. Specifically, the proposal for altering First Street from San Pedro to Alameda contained the reduction of traffic lanes and the introduction of cycle tracks. Both are major decisions and both are not currently supported by the local businesses on First Street.

At the Little Tokyo Community Council Board meeting on Tuesday, September 27, 2016, a motion was introduced to oppose these changes to First Street. The motion was passed unanimously. LTCC feels that Metro has jumped a step with its planning for the Tiger Grant proposals. LTCC insists on further discussions for the major changes to First Street and will not accept them as proposed.

Also, given LTCC support of Metro's grant application and given there are funds available for discretionary application, LTCC wants to be included on the decision-making process for the use of those funds. We want to make sure the process is fair and that the local stakeholders are included

If you have any further questions, please contact me.

Sincerely,

CHRIS KOMAI
Board Chair

The Little Tokyo Community Council is a nonprofit 501(c)(3) which has 90+ member organizations whose mission is to ensure that Little Tokyo would be a viable center for the Japanese American community and the Los Angeles Downtown community. The Council shall work to create a vision of what Little Tokyo should be in the future and serve as an advocate on behalf of the Little Tokyo community.

Segment 1 – 1st Street

(Los Angeles St. to Mission Rd.)

Segment 2 – Alameda Esplanade

(Commercial St. to 1st St.)

Segment 3 – Los Angeles Street

(Arcadia St. to 2nd St.)

Segment 4 – 2nd/Traction Gateway

(Intersection at 2nd/Alameda and ½ block of Traction)

Segment 5 – Central Avenue

(1st St. to 3rd St.)

Segment 6 – Judge John Aiso / San Pedro Street

(Temple St. to 3rd St.)

Segment 7 – Santa Fe Spine

(Vignes St. to 4th St.)

Segment 8 – Fundamental Pedestrian Improvements

Scramble Crosswalk – Hollywood Blvd / Highland Ave

Decorative Crosswalk Example – 2nd St / Azusa St

Bike Lane – Los Angeles Street

Cycle Track – Los Angeles Street

People Street – NoHo Plaza

People Street – Leimert Park Village

1st Street – Current Condition

1st Street – Proposed Condition (By Regional Connector)

Existing Condition – Segment 1 - 1st Street



Existing Condition – Segment 1 - 1st Street















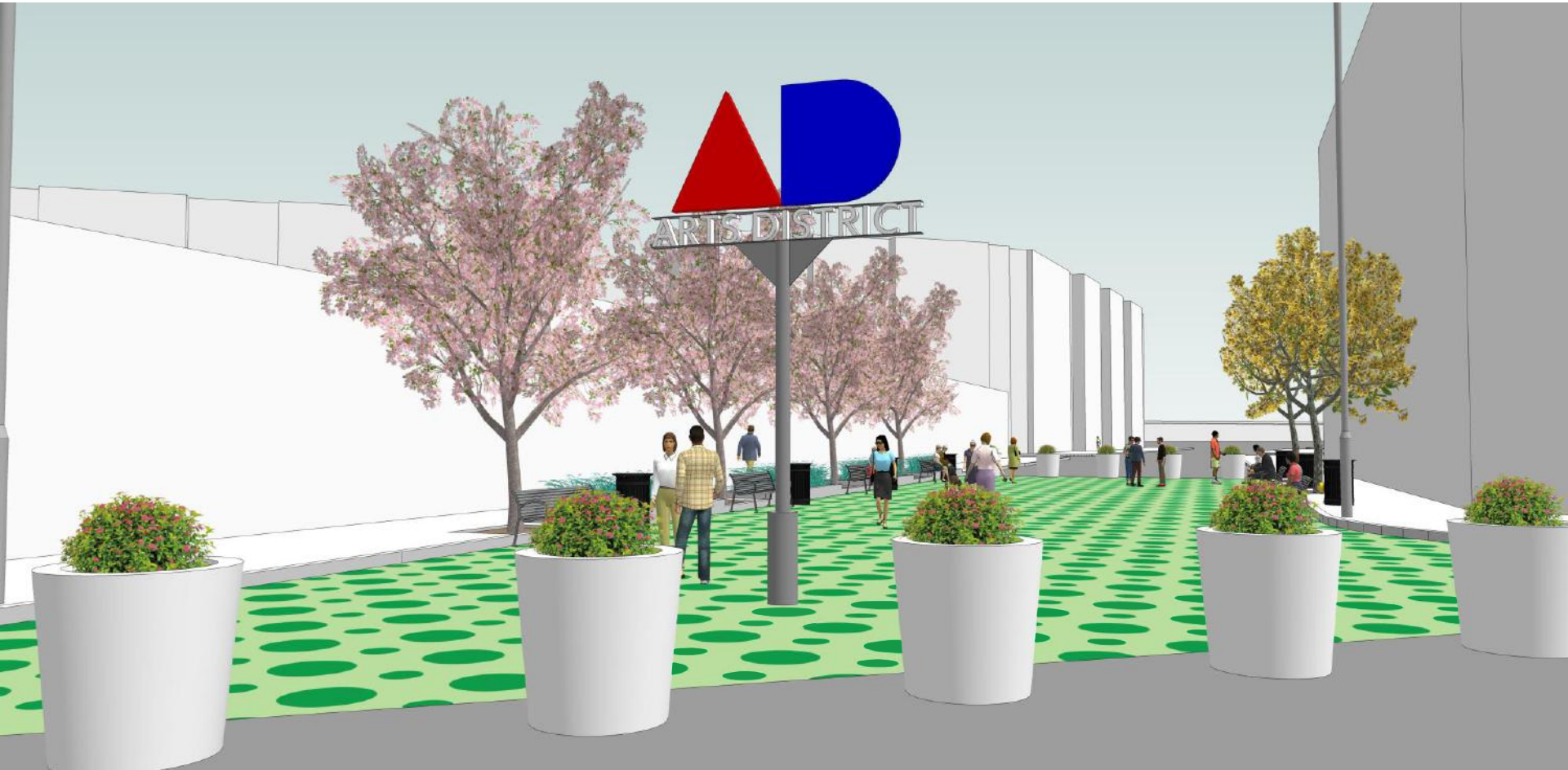

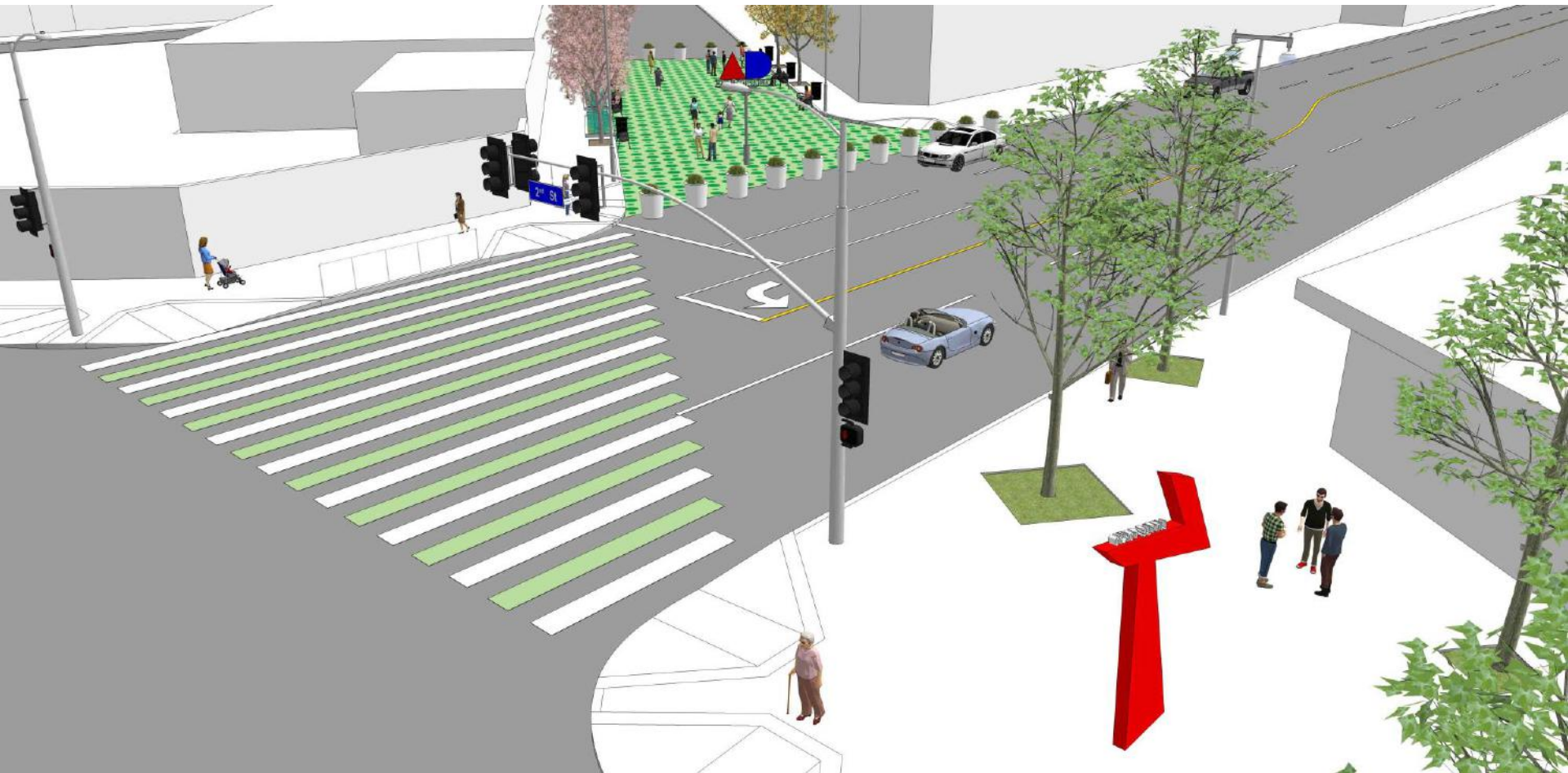







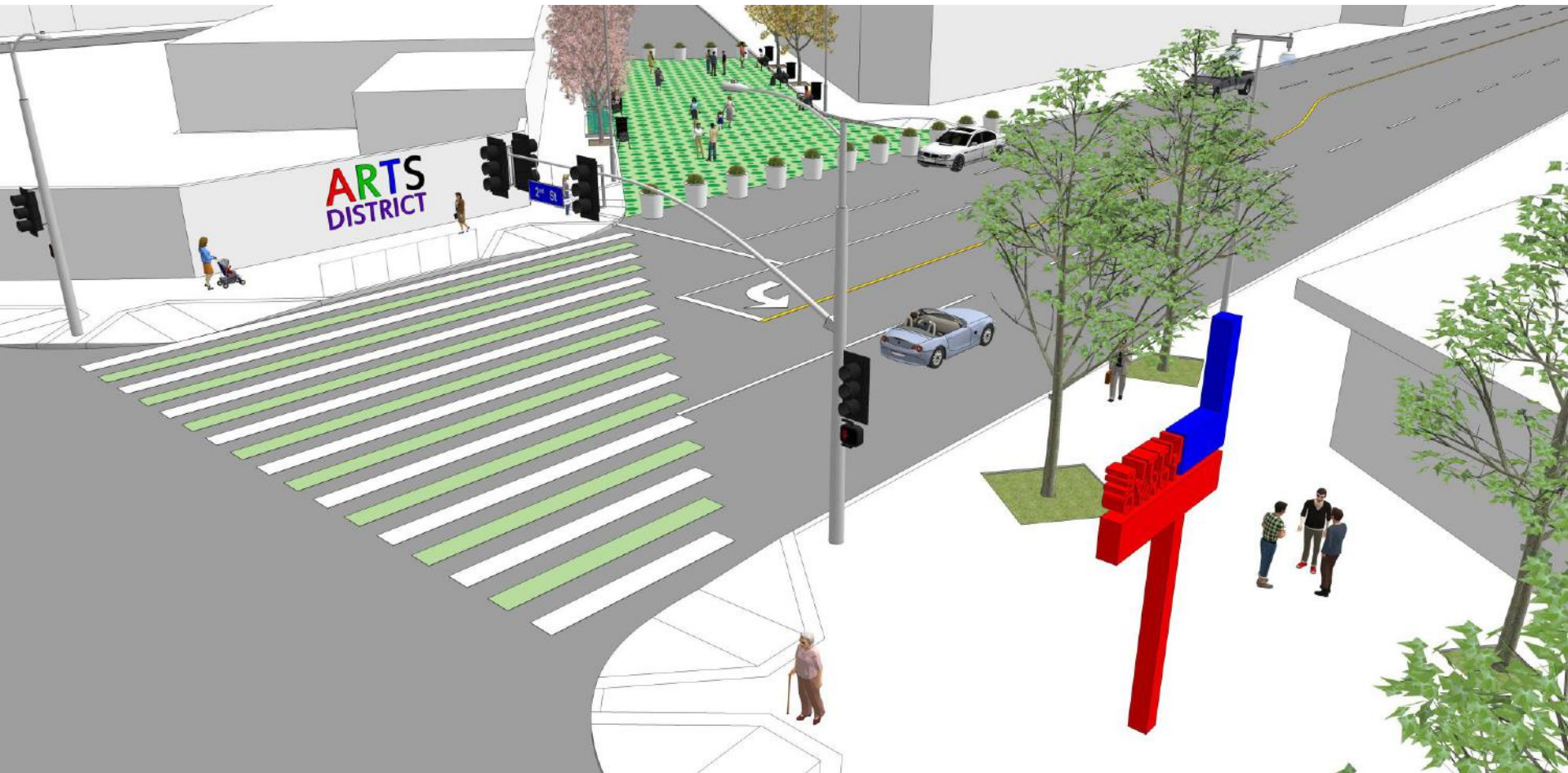

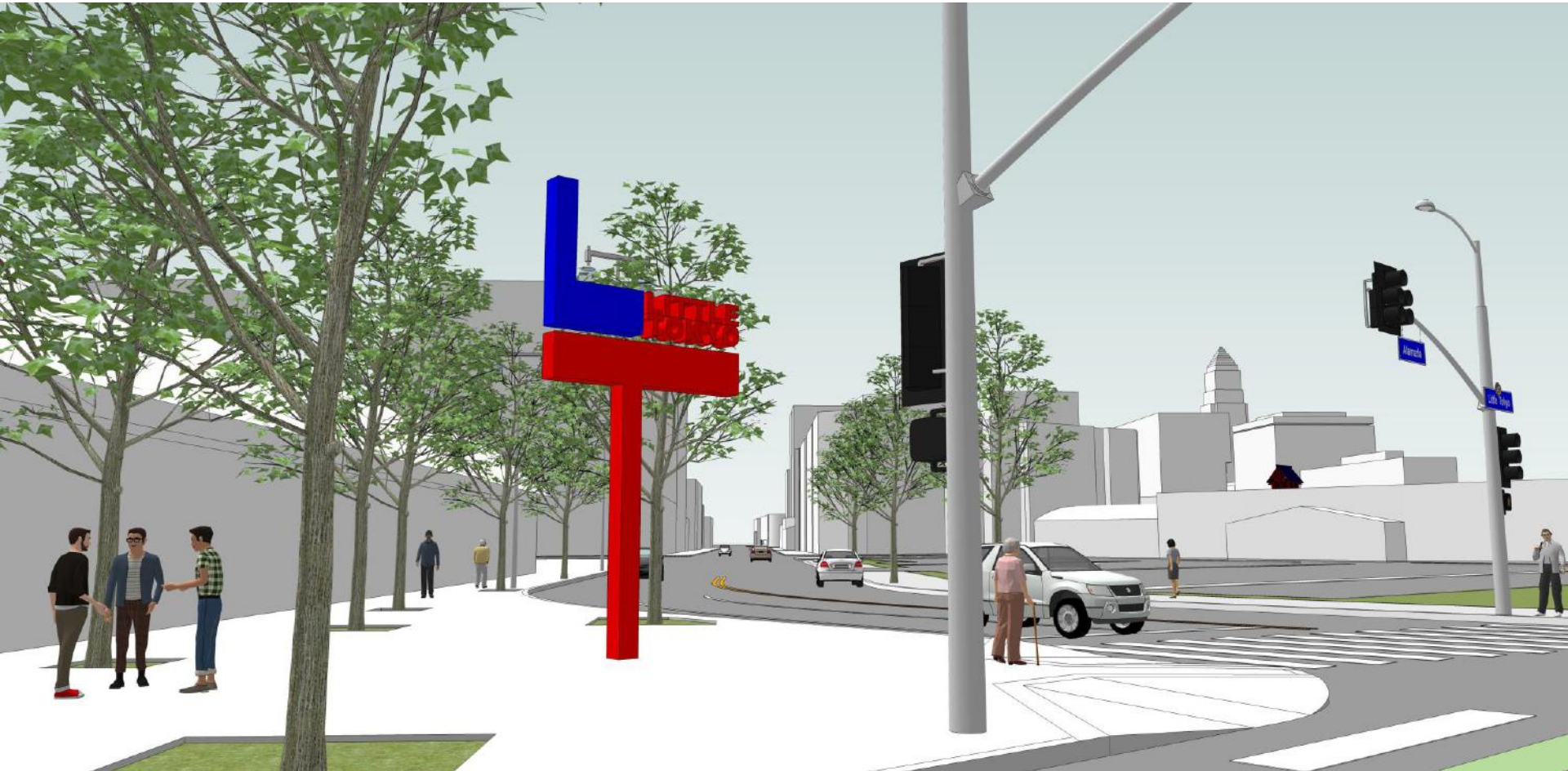



Landscape - Site Boundaries

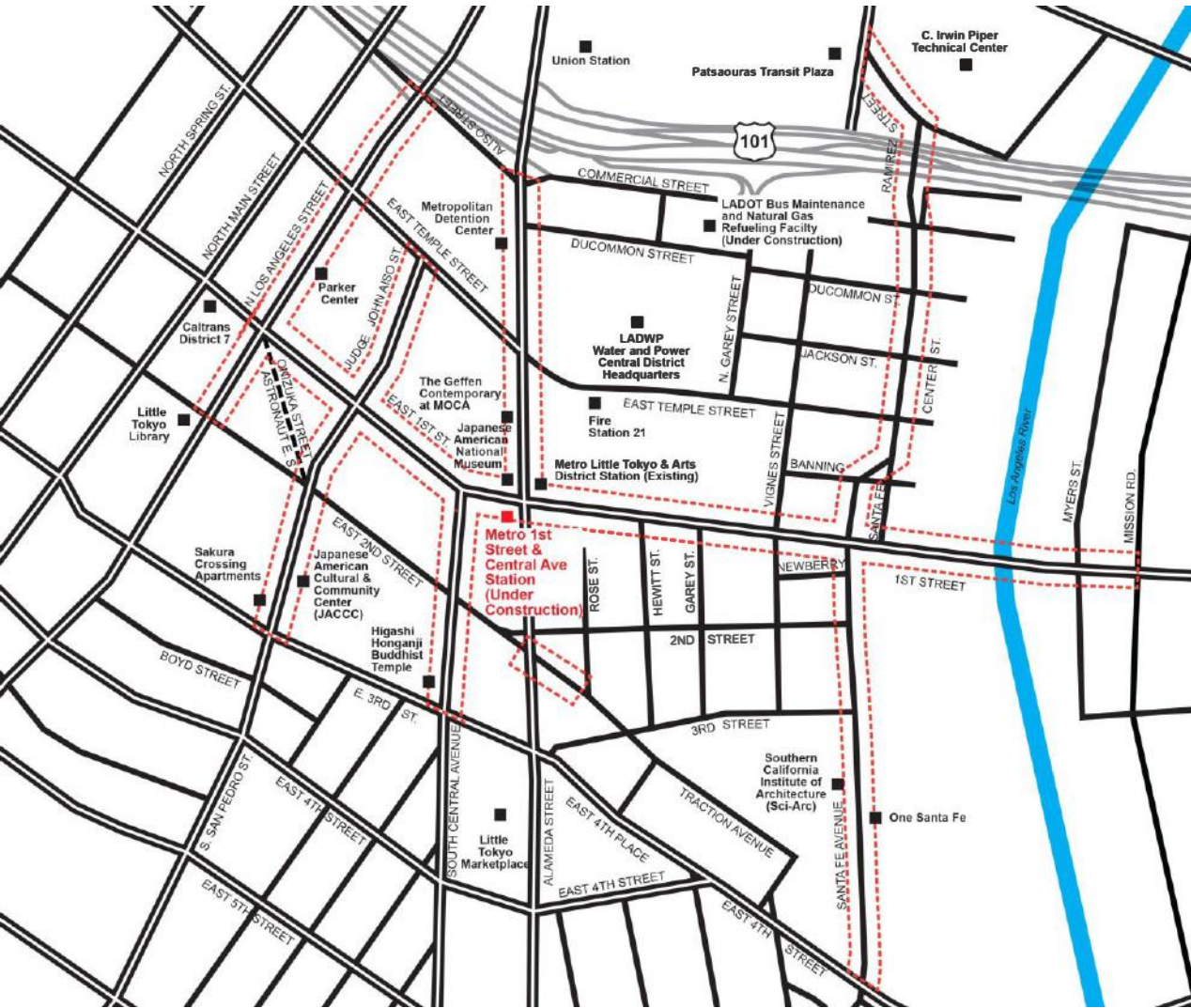

--- LIMIT OF WORK LINE NOT TO SCALE

Existing Conditions – 1st Street – Segment 1



- Some street trees in sidewalks





- Some girdled Ficus tree trunks

Existing Conditions – 1st Street – Segment 1



- Some shade street trees in tree wells

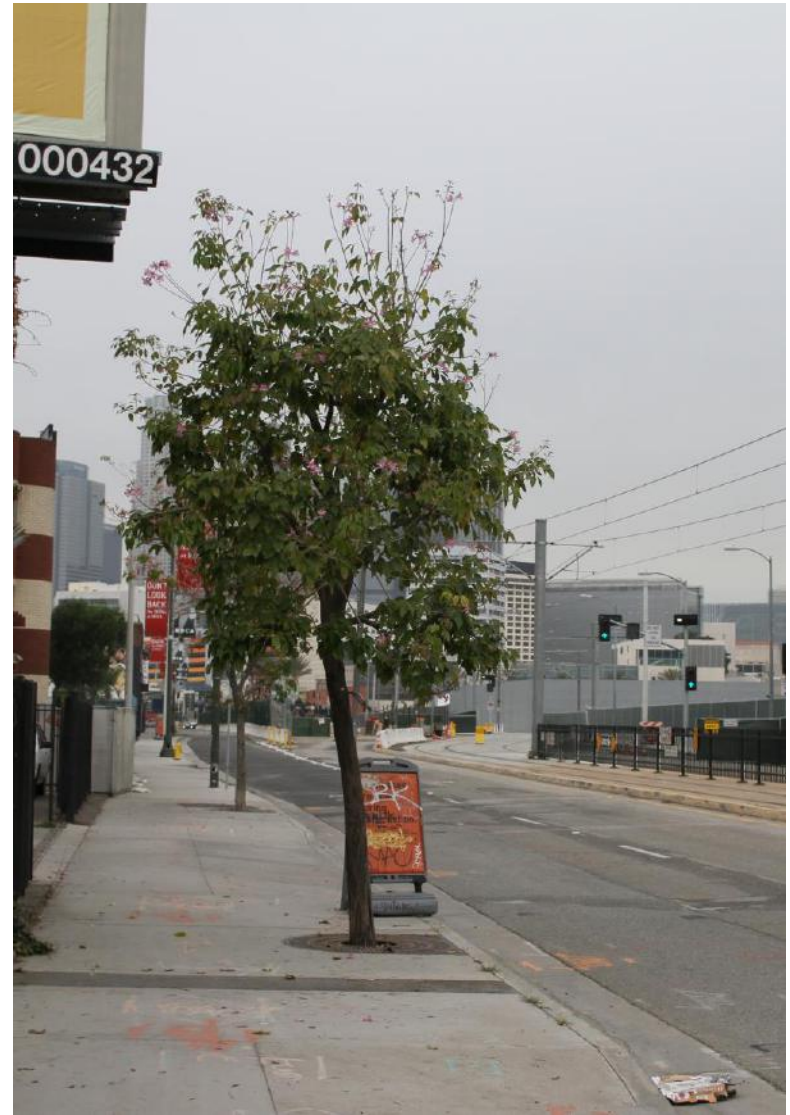



- Struggling or missing street trees in small tree wells



- No shade street trees between Temple and 1st Streets



- Some shade street trees in tree wells





- Some very large trees in center roadway median

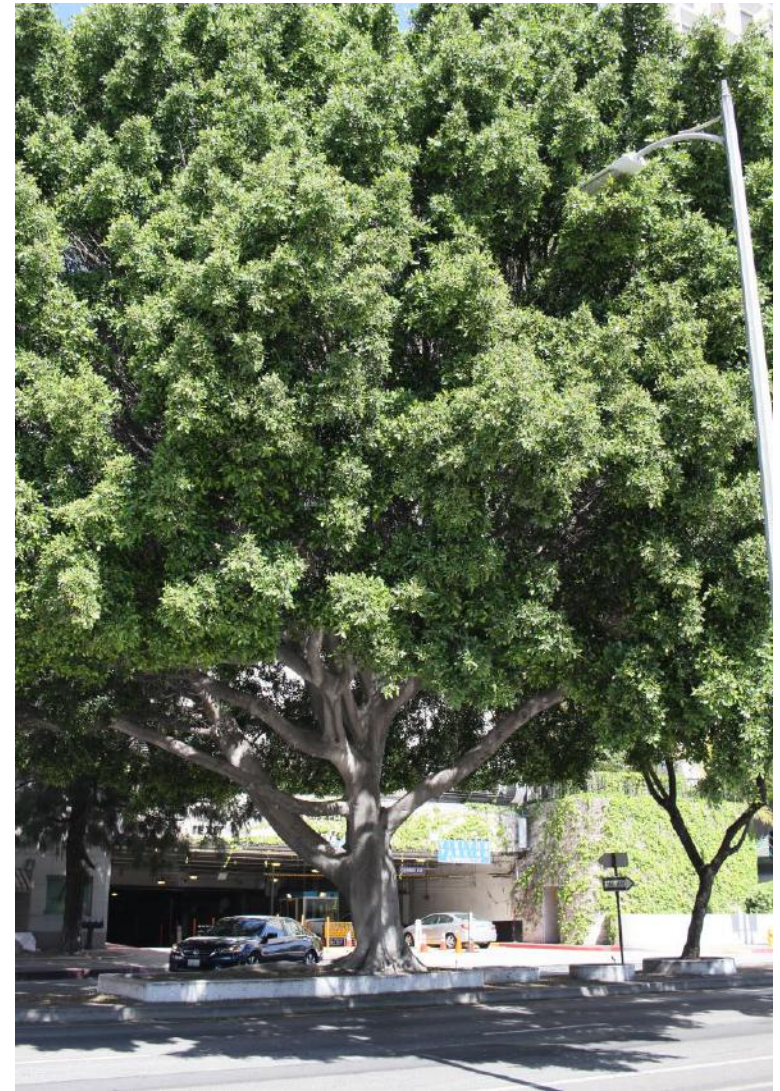

Existing Conditions – Traction & Alameda - Segment 4



- Missing or young shade street trees



- Some medium shade street trees



- Empty tree wells



- Some mature Ficus trees



- Medium sized Ginkgo trees

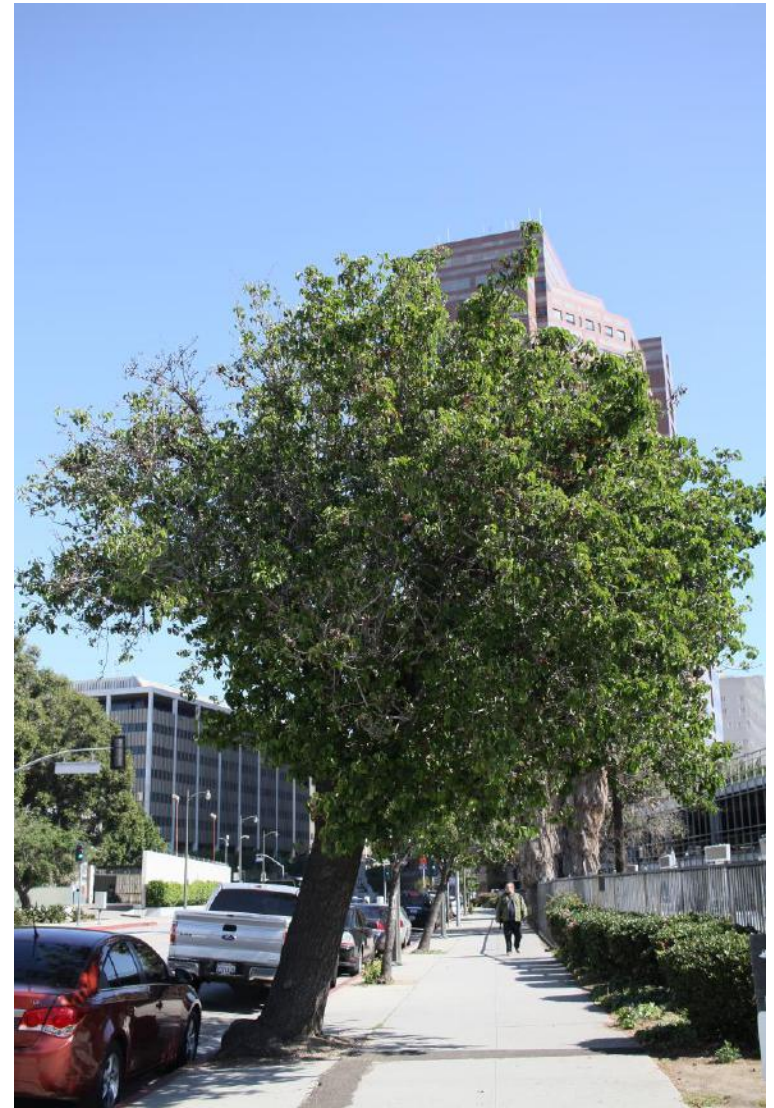

- Leaning and distressed pear trees



- Some mature street trees



- No street trees



- Some medium street trees



- Lack of street trees in middle of segment



- Some medium street trees



- Many medium street trees on both sides of Santa Fe



- Medium street trees along Santa Fe

GOALS OF LANDSCAPE DESIGN:

- 1. Enhance and encourage pedestrian access and comfort to, from, and between Union Station, the Arts District, and Little Tokyo neighborhoods.**
- 2. Provide environmentally responsible streetscape elements.**

LANDSCAPE ITEMS IDENTIFIED IN TIGER GRANT:

- Street trees**
- Site furniture**
- People Street**
- In/filtration planters**

HOW TO IMPLEMENT THESE GOALS:

- 1. Provide continuous rows of drought tolerant shade street trees.**
- 2. Provide infiltration and filtration planters where feasible on Los Angeles St., Alameda St., Traction Ave, and Santa Fe Ave.**
- 3. Design a welcoming and safe People Street at Alameda and Traction.**

Tree Disposition Plan

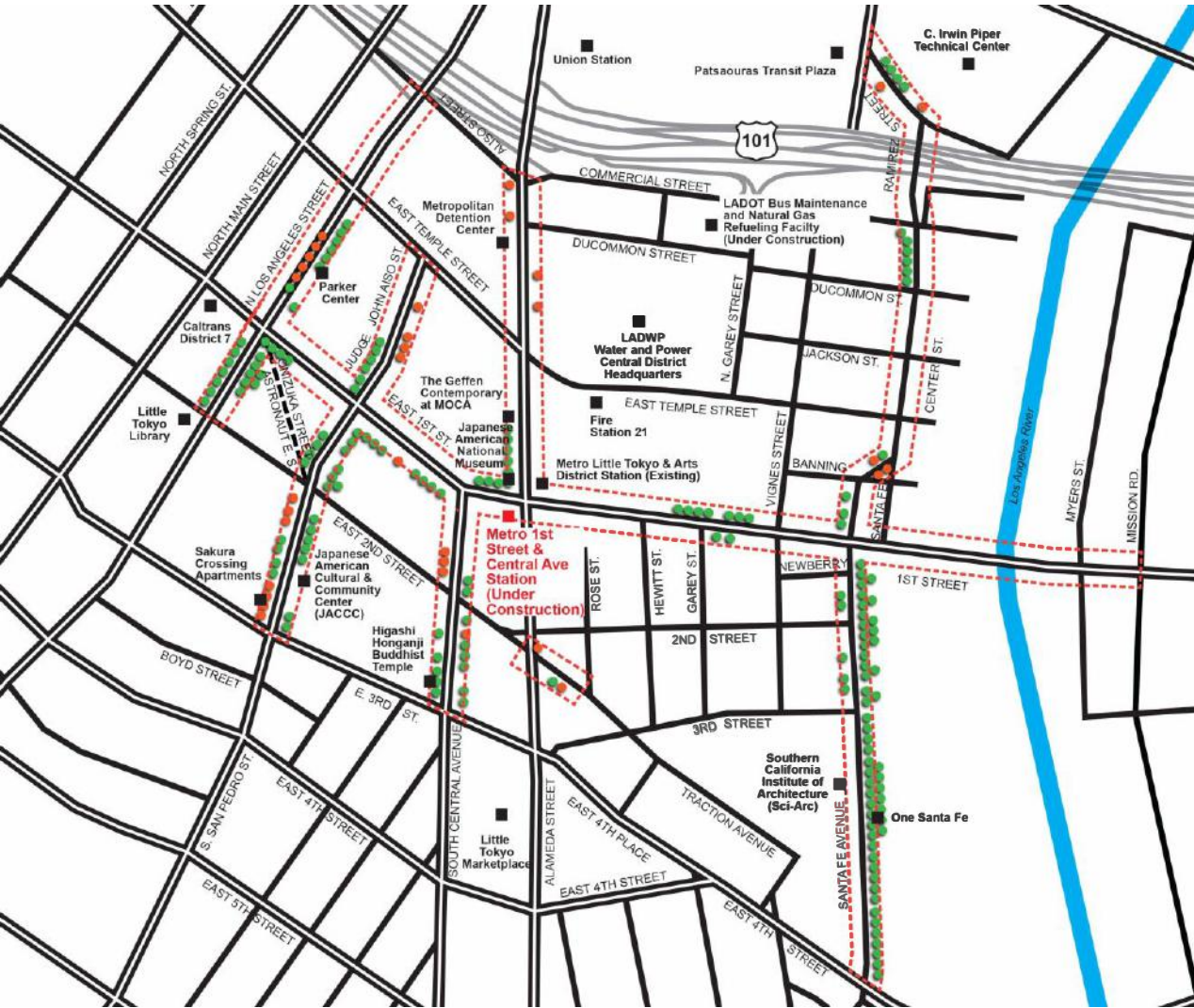

Street Tree Quantity Summary

	Existing Trees to Remain (Protect in Place)	Existing Trees to be Demolished	Existing Trees to be Replaced	Proposed New Trees	Proposed Infiltration Planter (Length in Feet)	Proposed Infiltration Planter (Length in Miles)
Segment 1	23	0	1	21	0	0.00
Segment 2	6	4	0	50	1400	0.27
Segment 3	22	5	0	48	900	0.17
Segment 4	1	1	1	0	80	0.02
Segment 5	13	0	11	6	0	0.00
Segment 6	28	0	5	5	0	0.00
Segment 7	72	3	2	66	360	0.07
TOTALS	165	13	20	196	2740	0.52

New Replacement Trees and Proposed New Trees: **216**
 Trees Purchased by TIGER Grant: **325**

--- LIMIT OF WORK LINE NOT TO SCALE



Proposed Street Tree Plan

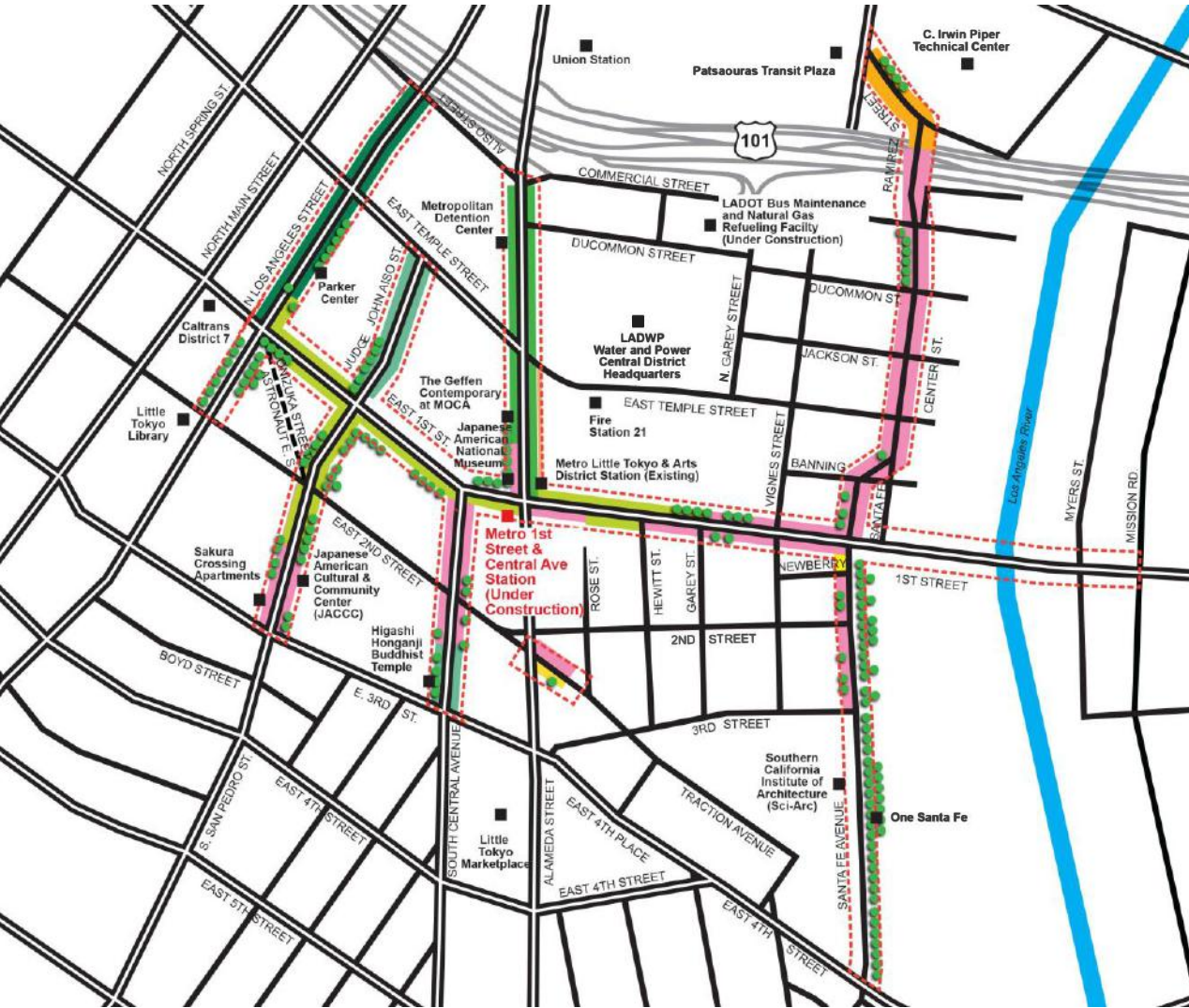

	Existing Trees to Remain (Protect in Place)	Cassia leptophylla / Gold Medalion Tree	Ginkgo biloba / Ginkgo	Liriodendron Tulipifera / Tulip Tree	Magnolia Grandiflora 'Montland' / Timeless Beauty Magnolia	Platanus acerifolia / London Plane Tree	Podocarpus gracilior / Fern Podocarpus	Tabebuia chrysoficha / Golden Trumpet Tree	Tabebuia impetiginosa / Pink Trumpet Tree	Tipuana tipu / Tipu Tree	TOTALS
Segment 1	23	0	12	0	0	0	0	0	10	0	45
Segment 2	6	0	0	17	0	0	30	0	3	0	56
Segment 3	22	0	2	0	46	0	0	0	0	0	70
Segment 4	1	1	0	0	0	0	0	0	0	0	2
Segment 5	13	0	0	0	0	0	0	0	17	0	30
Segment 6	28	0	5	0	0	5	0	0	0	0	38
Segment 7	72	0	0	0	0	0	4	54	10	0	140
TOTALS	165	1	19	17	46	5	28	4	84	10	351

--- LIMIT OF WORK LINE NOT TO SCALE



GINKGO BILOBA
“GINKGO” (MALE)

1st St., Los Angeles St., and San Pedro St.
(Segments 1, 3, 6)

- Slow growth habit, deciduous tree
- 35’ tall and 15’ wide
- Slightly pyramidal tree canopy
- Mid spring flowers are inconspicuous.
- Attractive seasonal gold colored foliage appears in late October.



MAGNOLIA GRANDIFLORA 'MONLAND'
TIMELESS BEAUTY® MAGNOLIA

Los Angeles St. (Segment 3)

- Moderate growth habit, evergreen tree
- 20' tall and 15 - 20' wide
- Slightly pyramidal tree canopy
- Attractive, large fragrant spring flowers



PLATANUS X ACERIFOLIA 'COLUMBIA'
"COLUMBIA LONDON PLANE TREE"

Central Ave., San Pedro St./Judge John Aiso St.
(Segments 5, 6)

- Moderate growth habit, deciduous tree
- Approximately 35' tall and 15' wide in urban environments
- Oval tree canopy
- Improved tree health over other *Platanus* cultivars
- Mid spring flowers are inconspicuous. Tan colored fruit appears in summer and disintegrates in the wind.
- Highly attractive mottled white bark visible from a distance.



PODOCARPUS GRACILIOR
“FERN PODOCARPUS”

Alameda St. (Segment 2)

- Slow growth habit, evergreen tree
- 40’ tall and 20’ wide. Takes hard pruning exceptionally well.
- Slightly pyramidal tree canopy
- Flowers are inconspicuous
- Highly resistant to pests and diseases



TABEBUIA CHRYSOTRICHA (HANDROANTHUS CHRYSOTRICHUS) “GOLDEN TRUMPET TREE”

Santa Fe Ave (Segment 7)

- Moderate growth habit, semi-evergreen tree
- Approximately 30’ tall and 15’ wide
- Oval tree canopy
- Late winter 2 inch long, trumpet shaped yellow flowers are very showy.
- Attractive profuse flowering habit with leaves and long brown seed pods that immediately follow.



TABEBUIA IMPETIGINOSA (HANDROANTHUS IMPETIGINOSUS, TABEBUIA AVELLANEDAE)
“PINK TRUMPET TREE”

1st St., Los Angeles St., Central Ave., Santa Fe Ave.
(Segments 1, 2, 5, 7)

- Moderate growth habit, semi-evergreen tree
- Approximately 25’ tall and 20’ wide
- Umbrella tree canopy
- Late winter 2 inch long, trumpet shaped pink flowers are very showy and highly attractive to hummingbirds.
- Attractive profuse flowering habit with leaves and long brown seed pods that immediately follow.



TIPUANA TIPU
“TIPU TREE” or “ROSEWOOD”

Santa Fe Ave (Segment 7)

- Rapid growth habit, semi-evergreen tree
- Approximately 20’ tall and 30-40’ wide
- Umbrella tree canopy
- Late spring clusters of yellow-orange pea-like flowers. Single-winged samara seed pods follow.

Proposed Site Furnishings and Stormwater Planters

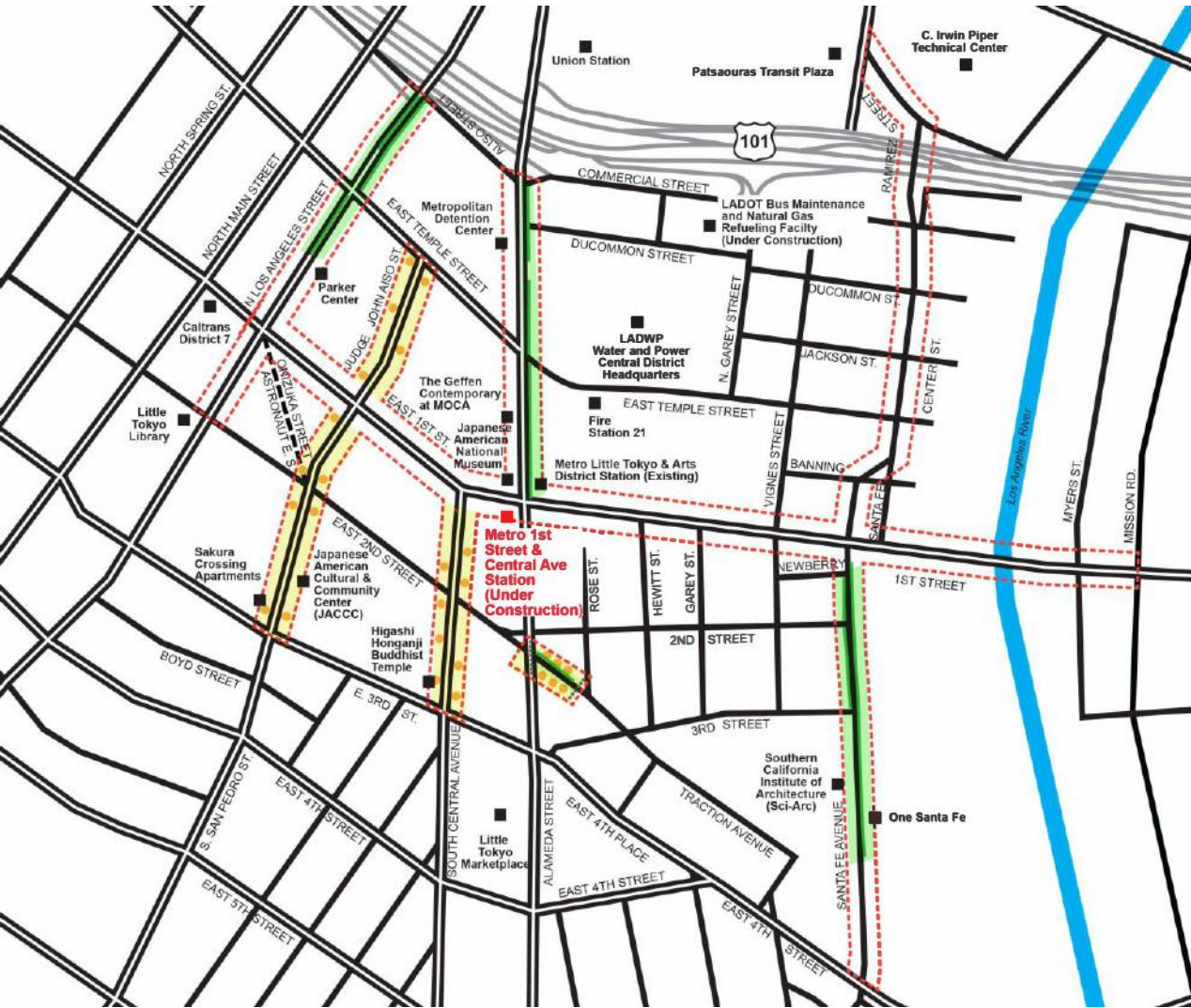

	New Bench and Trash Receptacle	Planter Bollards	Proposed Infiltration Planter (Length in Feet)	Proposed Infiltration Planter (Length in Miles)
Segment 1	0	0	0	0.00
Segment 2	0	0	1400	0.27
Segment 3	0	0	900	0.17
Segment 4	6	23	80	0.02
Segment 5	8	0	0	0.00
Segment 6	12	0	0	0.00
Segment 7	0	0	360	0.07
TOTALS	26	23	2740	0.52

--- LIMIT OF WORK LINE NOT TO SCALE



Proposed Concepts – Stormwater Planters

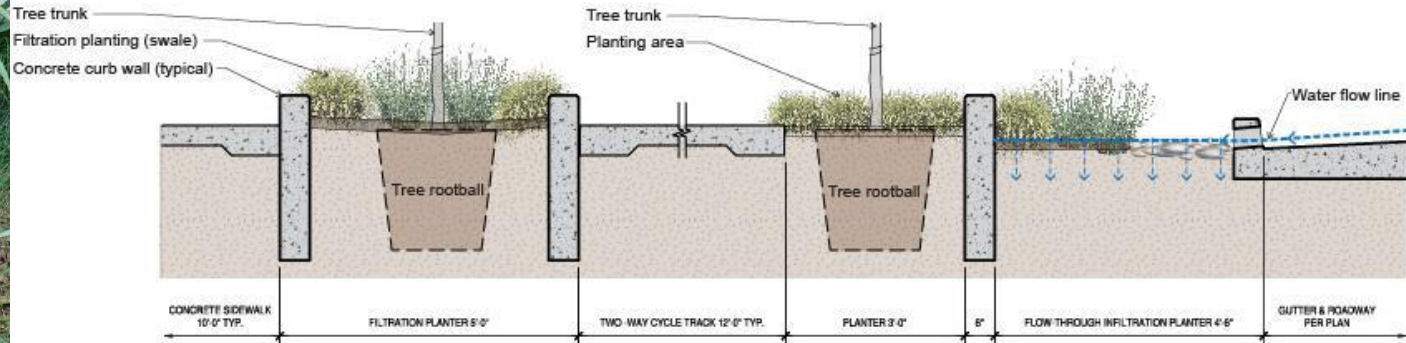
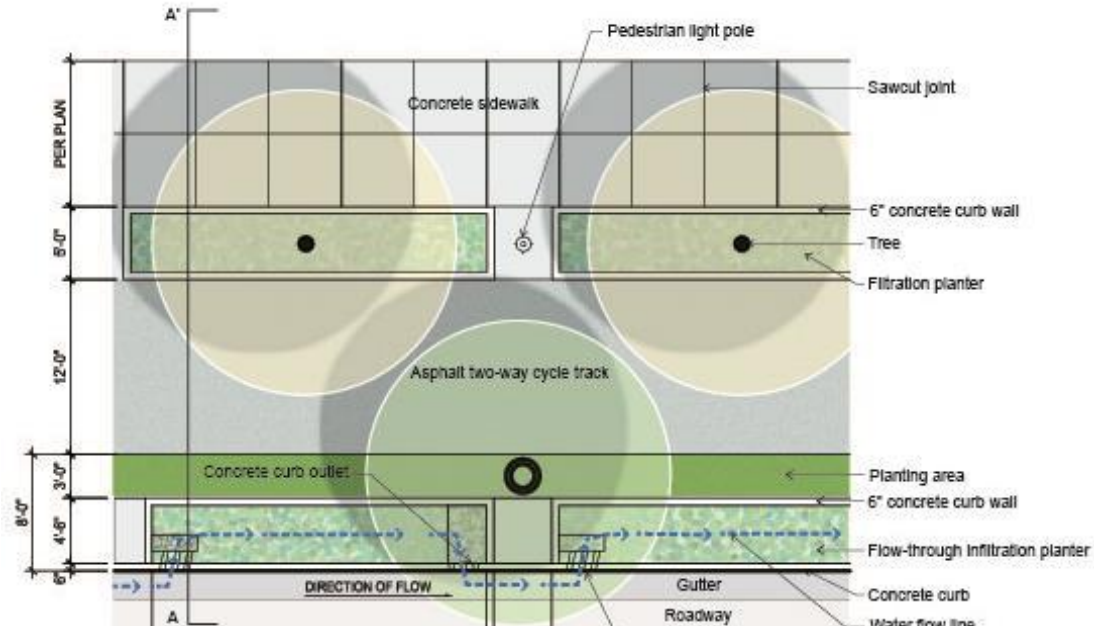

Proposed planter locations: Alameda, Los Angeles, Santa Fe & People Street

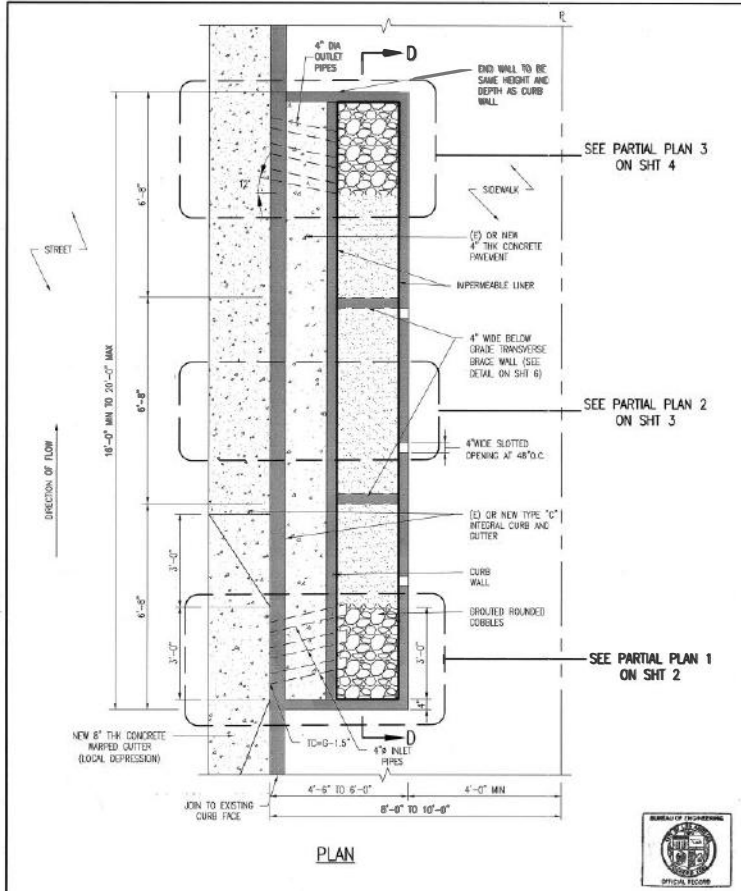

BUREAU OF ENGINEERING		DEPARTMENT OF PUBLIC WORKS		CITY OF LOS ANGELES	
PARKWAY SWALE IN LOCAL/COLLECTOR STREETS				STANDARD PLAN S-482-0	
PREPARED ALICE GONG, CE48187 BUREAU OF SANITATION ENGINEER OF SANITATION	SUBMITTED GARY LEE MOORE, P.E. ENGINEER OF DESIGN BUREAU OF ENGINEERS	APPROVED GARY LEE MOORE, P.E. CITY ENGINEER	SUPERSEDES S-410 S-480 S-484	REFERENCES	
CHECKED PATRICK LEE, CE42448 BUREAU OF ENGINEERING	REVISIONS DATE	DATE	VAULT INDEX NUMBER: 464		
			SHEET 1 OF 8 SHEETS		

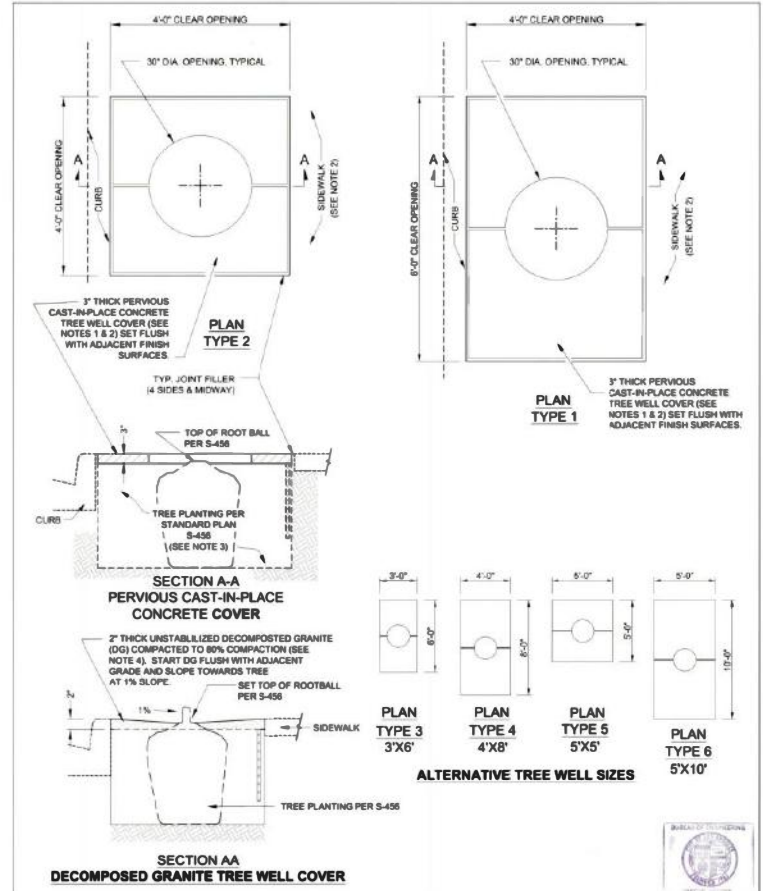

BUREAU OF ENGINEERING		DEPARTMENT OF PUBLIC WORKS		CITY OF LOS ANGELES	
TREE WELL COVER DETAILS				STANDARD PLAN S-450-3	
PREPARED NORMA BARRON BUREAU OF STREET SERVICES MANAGING SANCTION DIRECTOR	SUBMITTED SAMARA ALAMRAB, P.E. ENGINEER OF DESIGN	APPROVED GARY LEE MOORE, P.E. CITY ENGINEER	SUPERSEDES S-450-2 S-4036	REFERENCES S-456	
CHECKED MPT A. BARBARO, P.E. BUREAU OF ENGINEERING	DATE	DATE	VAULT INDEX NUMBER: 474		
			SHEET 1 OF 2 SHEETS		

Alameda Street Esplanade - Proposed

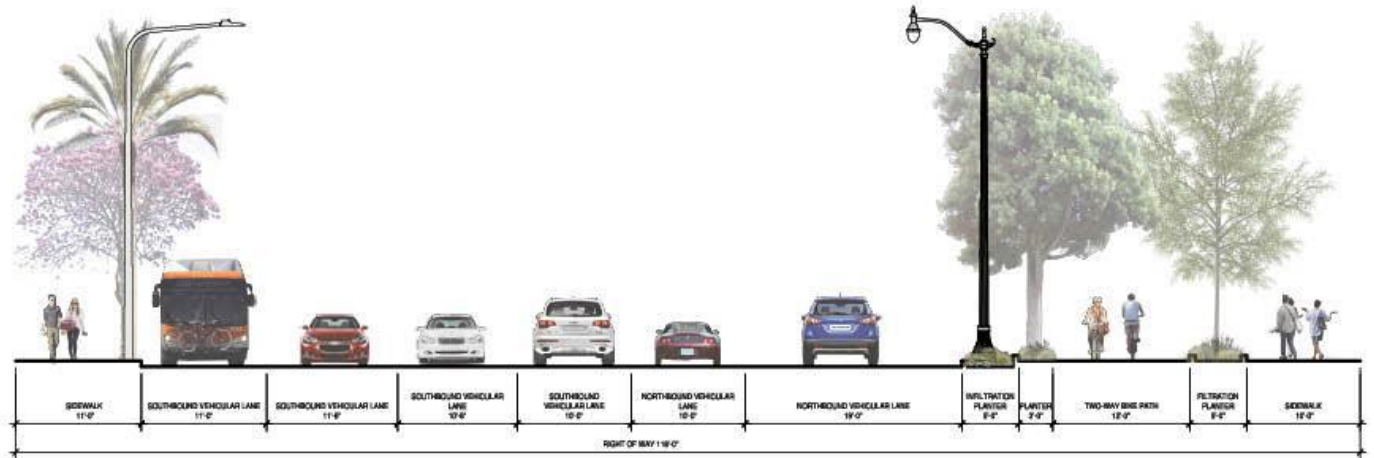

Proposed Section

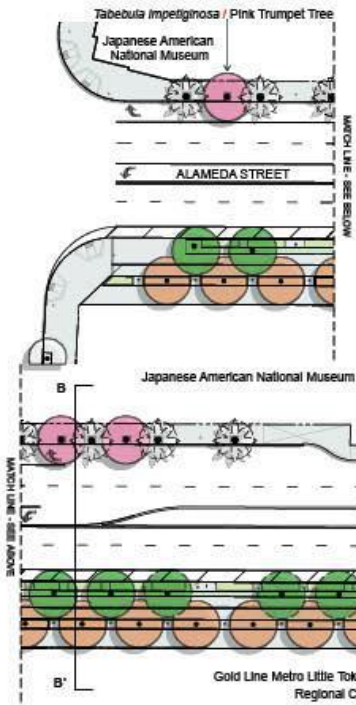

Plan View

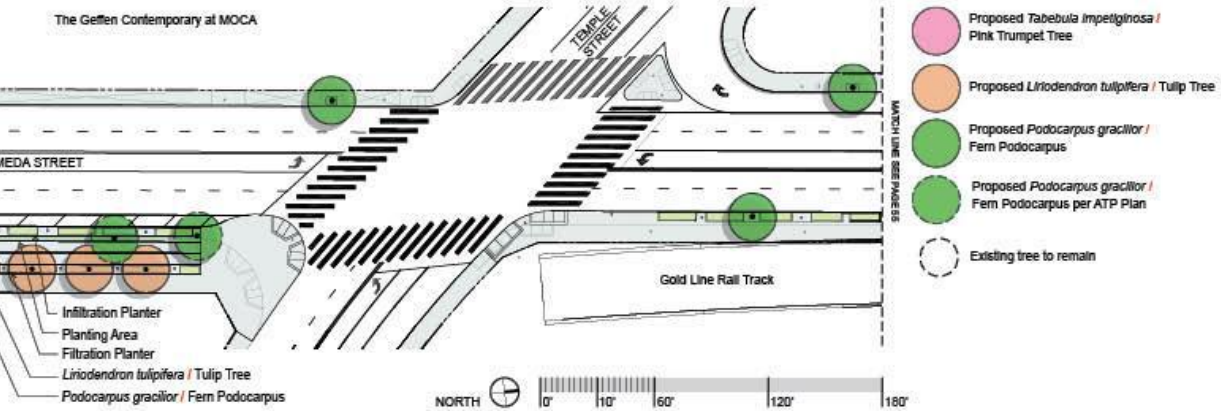

Alameda Street Esplanade - Proposed



Proposed Esplanade

Traction Avenue People Street – Existing / Proposed

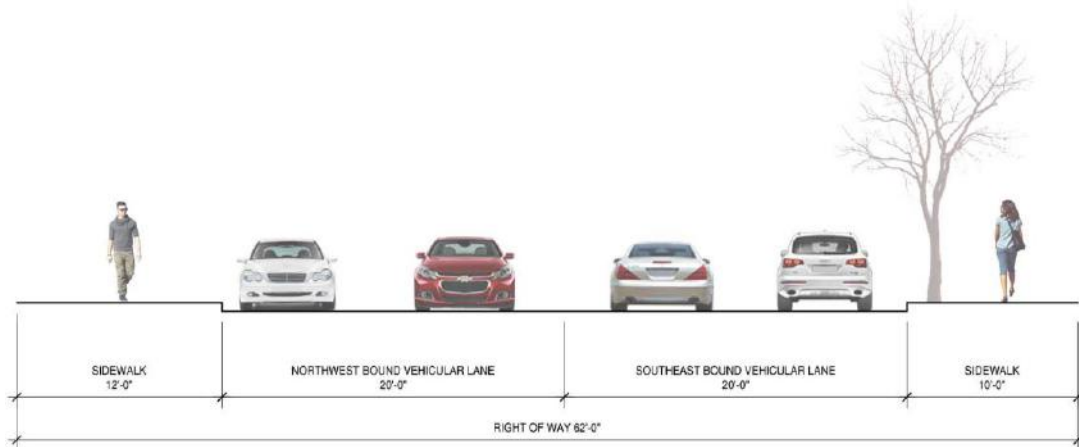

Existing Section

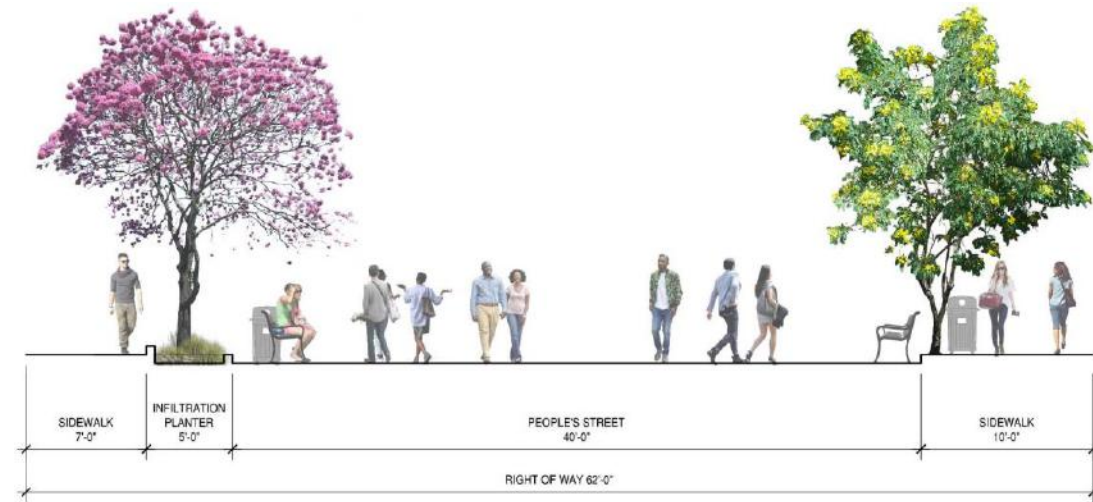

Proposed Section

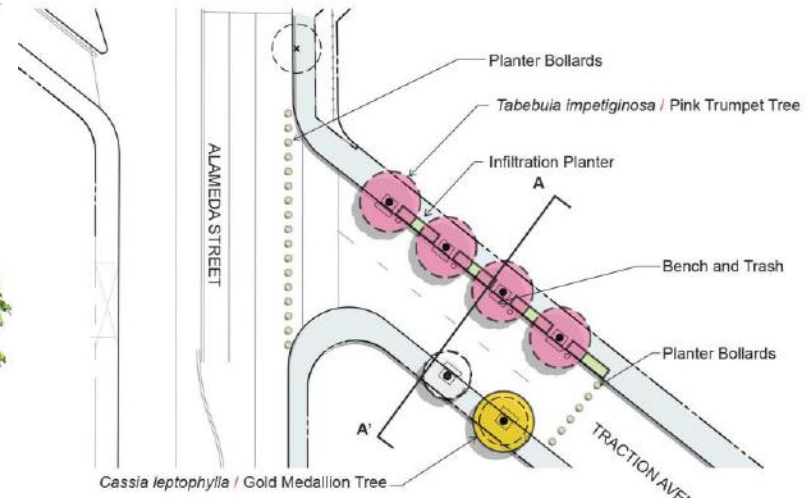

Plan View

Los Angeles Street – Existing / Proposed

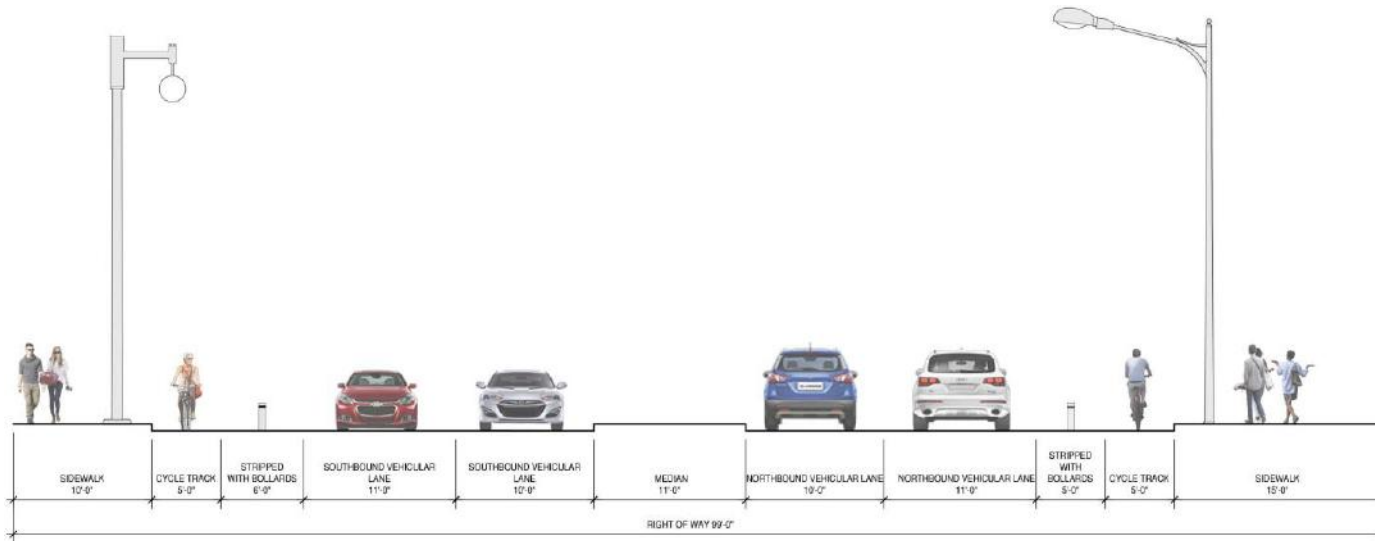

Existing Section

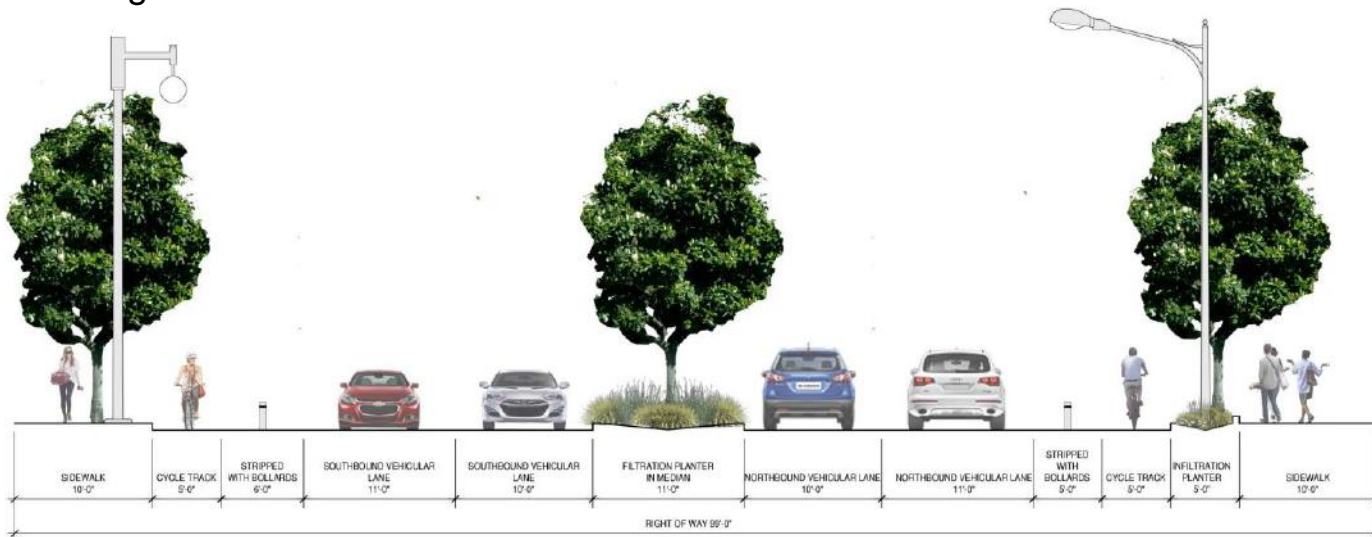

Proposed Section

Los Angeles Street - Proposed

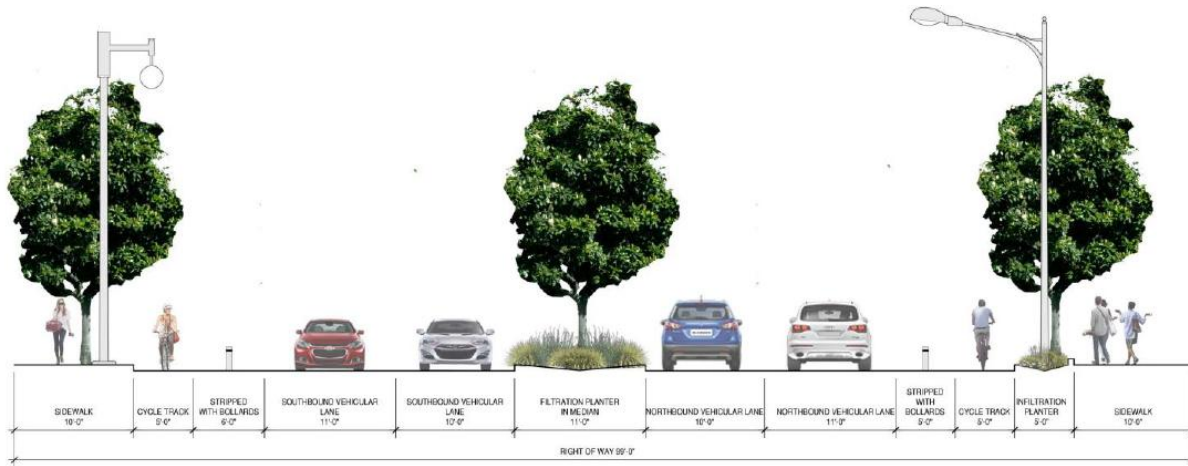

Proposed Section

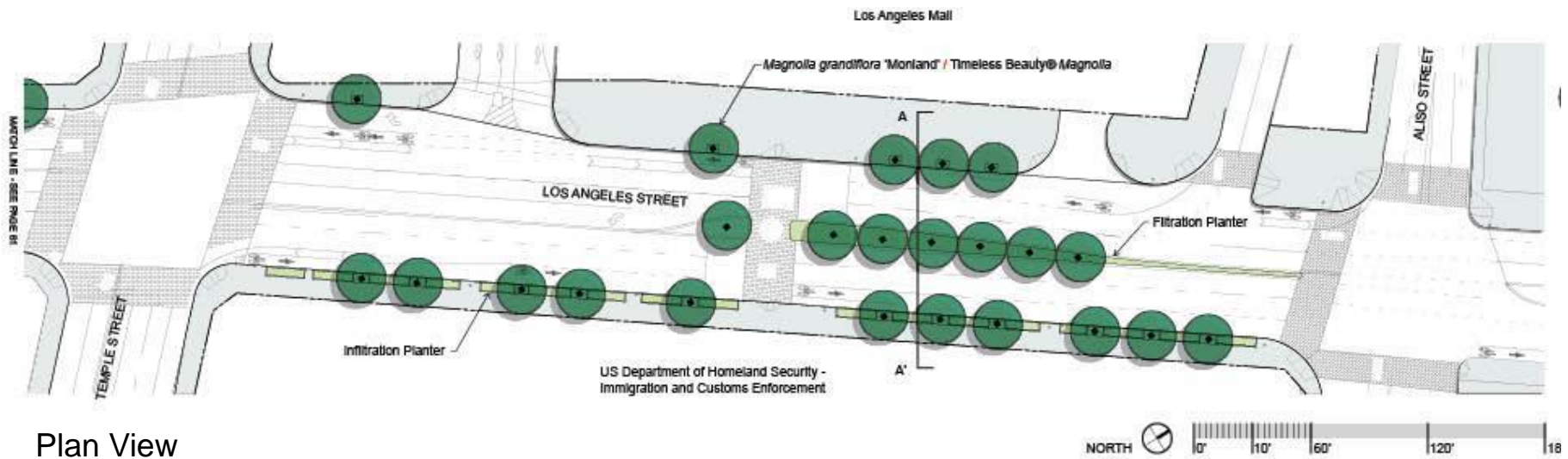

Plan View

Santa Fe Avenue – Existing / Proposed

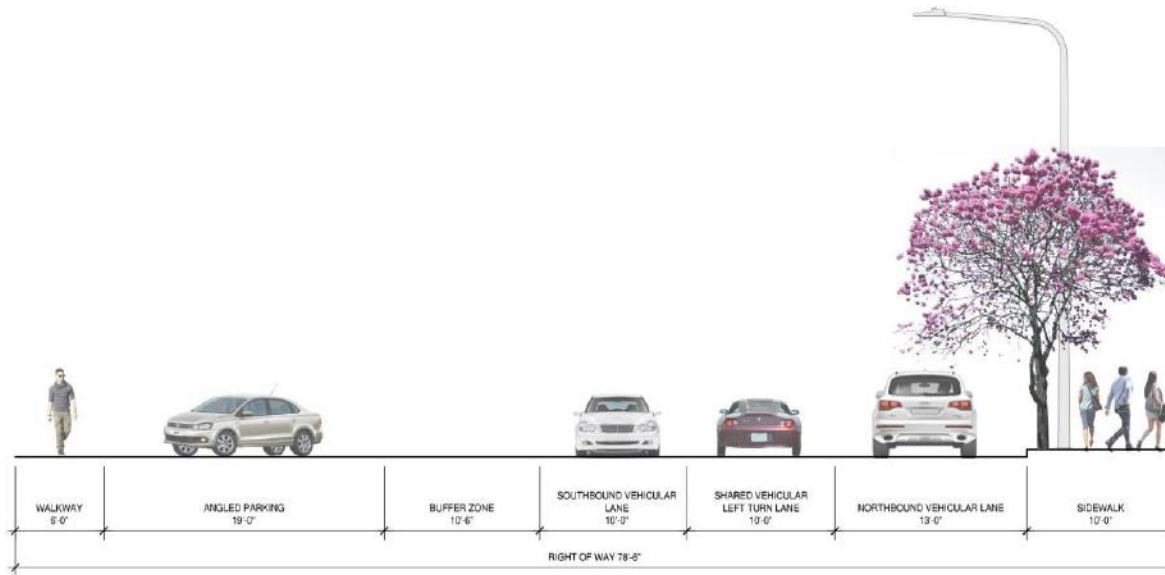

Existing Section

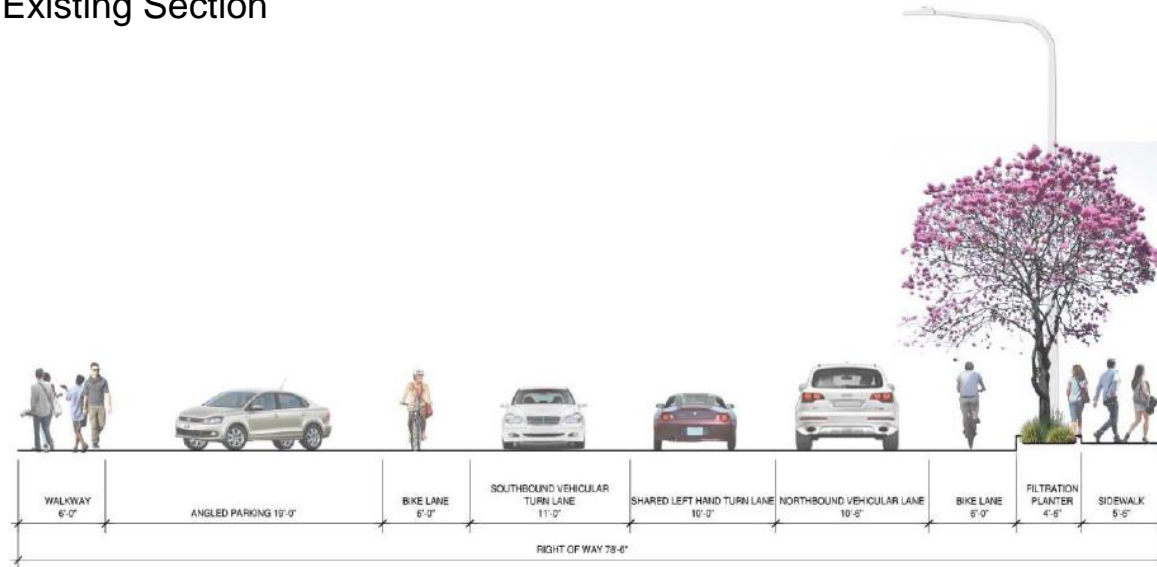

Proposed Section

Santa Fe Avenue - Proposed

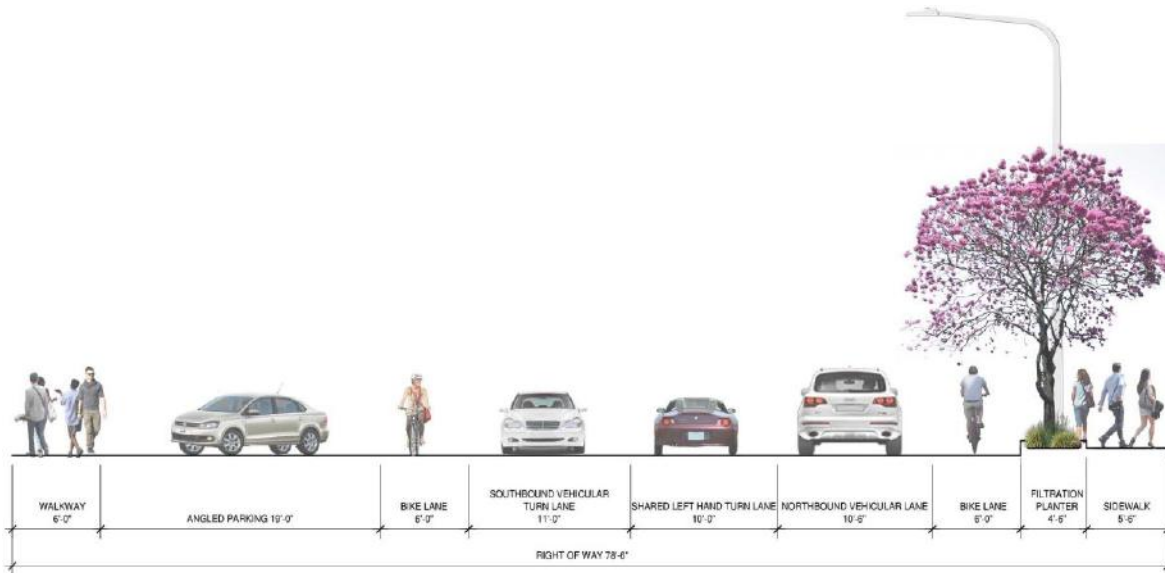

Proposed Section

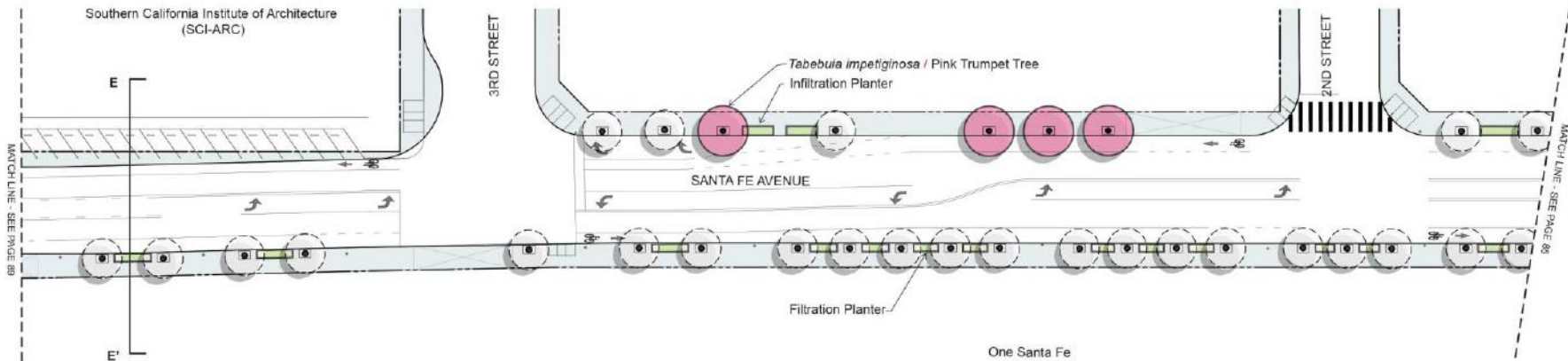

Plan View



AHBE

1st/Central Station Improvement Project – Open House
October 27, 2016

- Photo Comparison

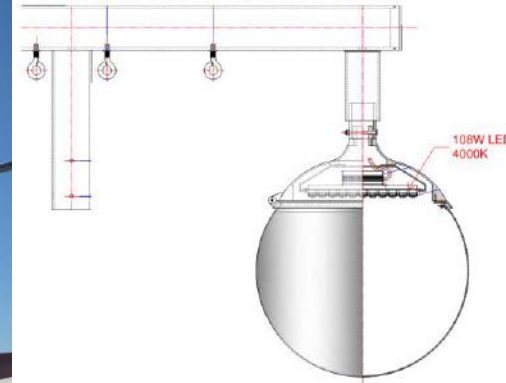

ANP Little Tokyo
Crossarm Assembly

- **MAINTENANCE:** LED has long life, less relamping is needed
- **EFFICIENCY:** LED is more efficient with high lumen/watt, much lower wattage consumption
- **DARK SKY:** LED has better and more precise light distribution to control light spill up to the sky and minimize light trespassing.
- **GLARE:** LED provides better glare control with the use of frosted globe shades and still maintain high performance and lumen output
- **COLOR:** with LED's consistent color temperature and CRI through out long period of life time, poles will remain consistent light quality

LED Retrofit Lighting Plan

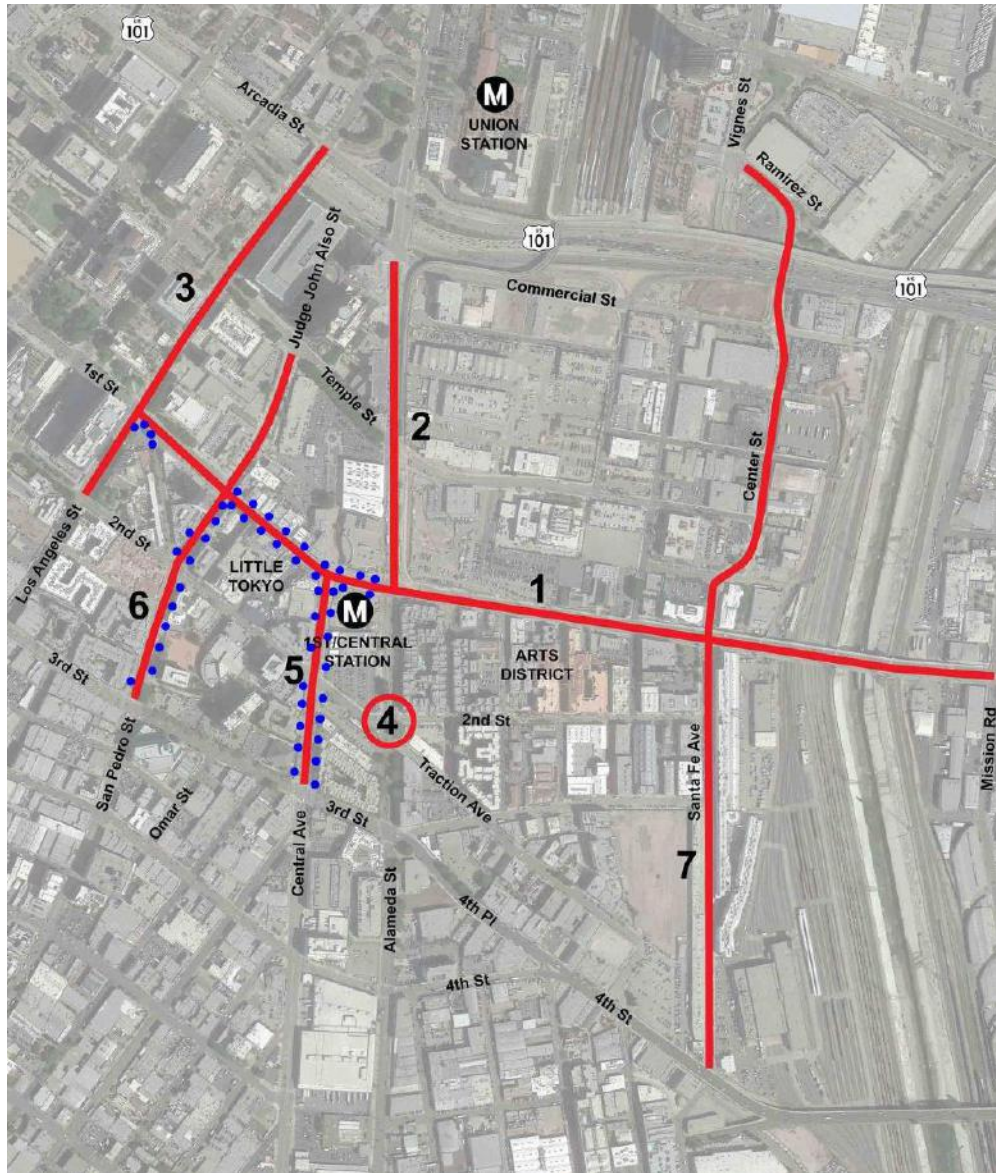

Segment	Street	Quantity
1	1 st St.	38
5	Central Ave.	32
6	San Pedro St.	30 (as many as possible)



Alameda Street Lighting Plan

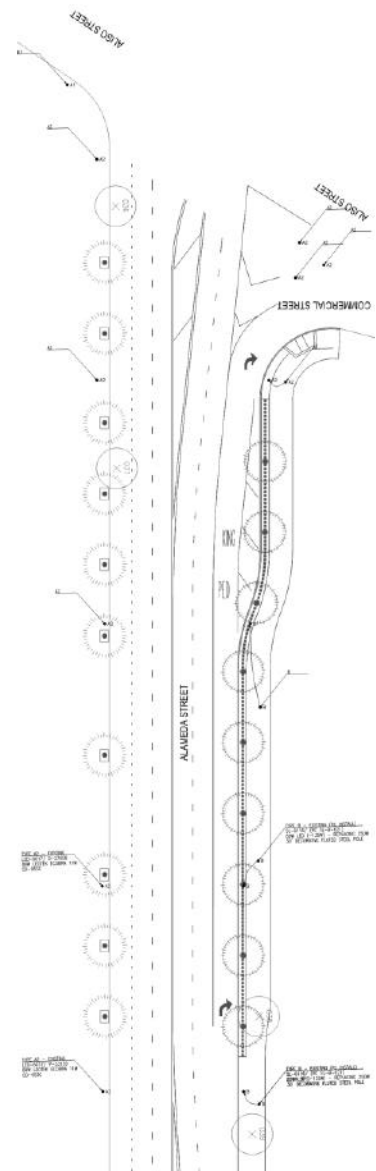
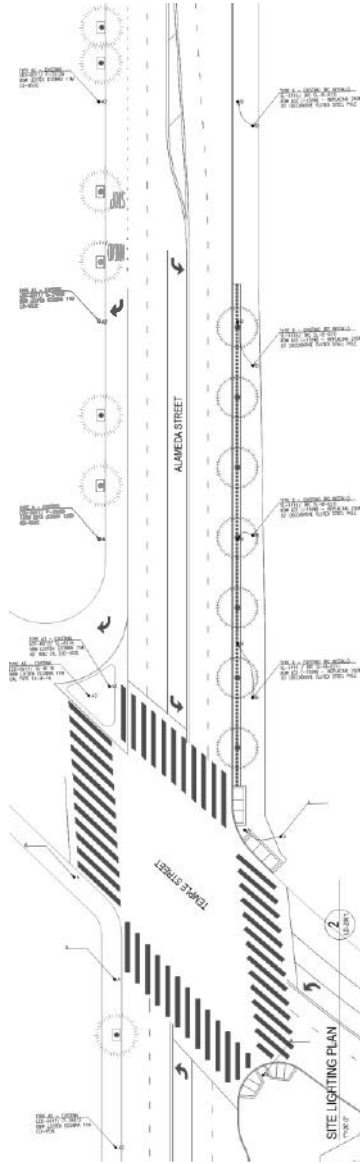
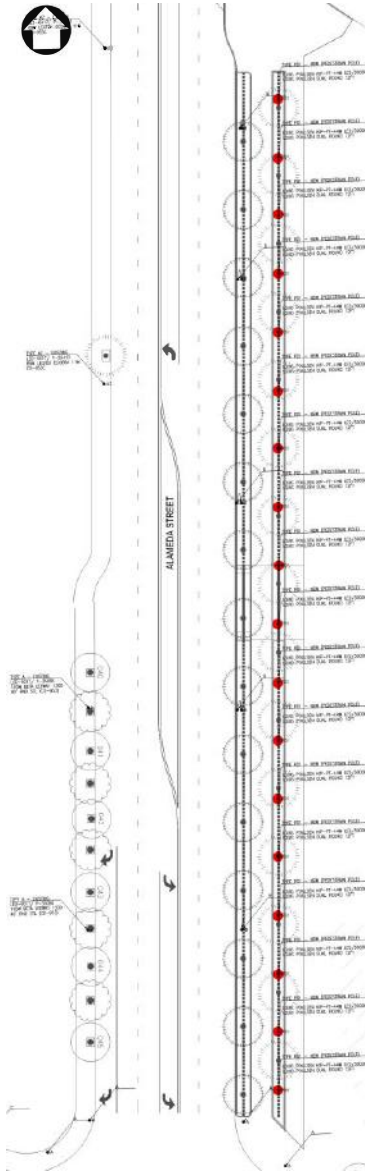

Alameda Esplanade Night Time Rendering



- Compliment new urban design improvements with appropriate signage and graphics.
- Facilitate pedestrian and bicycle circulation throughout project area.
- Celebrate the 1st/Central station as a center point of the area.
- Consider three opportunities for signage:
 - Wayfinding
 - Identity creation
 - Interpretation

Existing Graphic Elements



Vehicular signs from 13-district LA Walks sign program (2005)



Pedestrian directional signs and maps from LA Walks program



Angels Walk interpretive kiosk (2001)



Little Tokyo Crosswalk graphics



Interpretive elements in Little Tokyo



Identity 'icons' in Little Tokyo and Arts District

Existing Pedestrian Directional Signs



Sign Locations—Existing Pedestrian Directional Signs

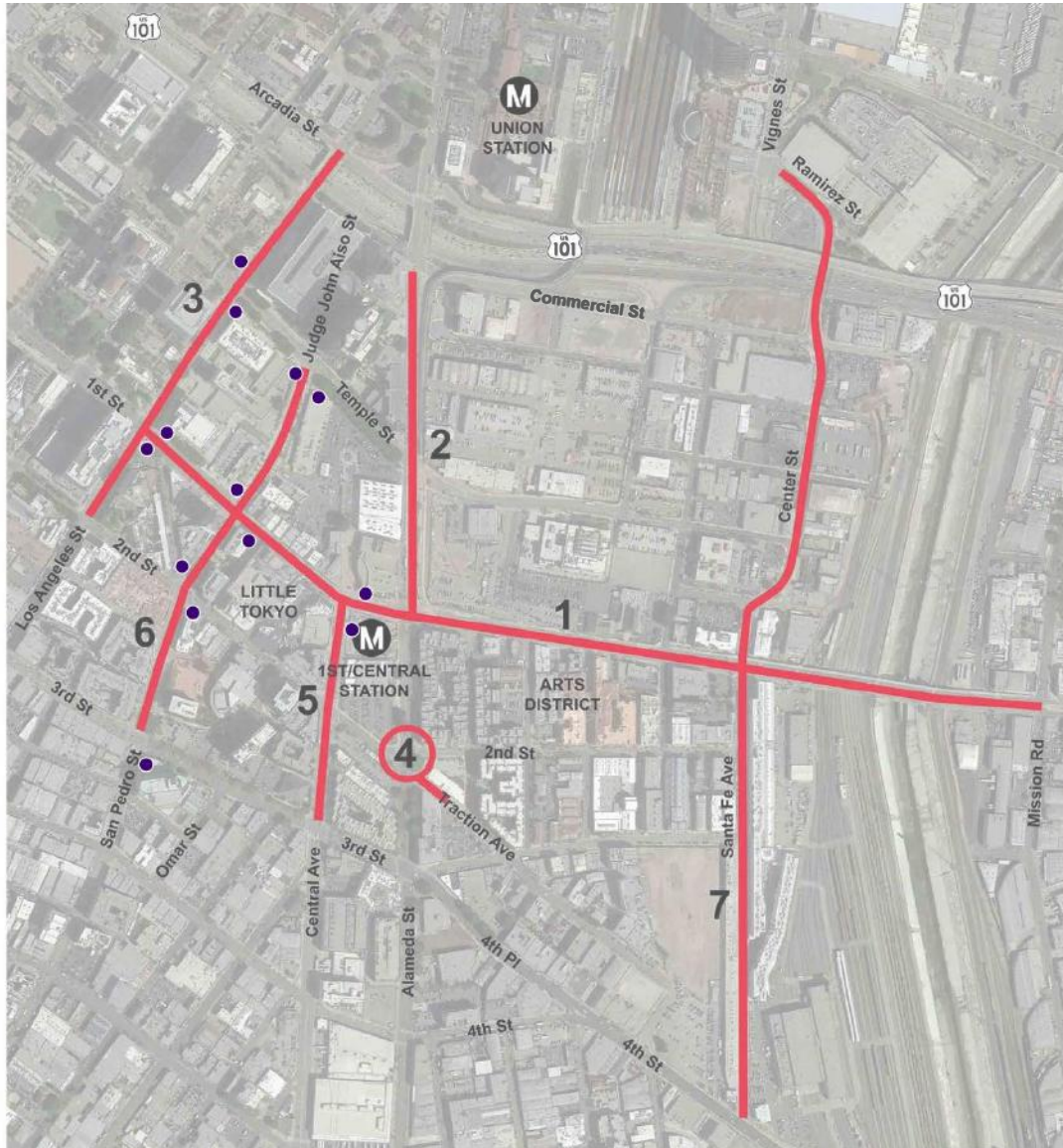

● Pedestrian Directional (EXISTING)



HUNTDESIGN

Sign Locations—Areas of Opportunity for Pedestrian Directional Signs



A Looking East



B Looking West



C Looking West

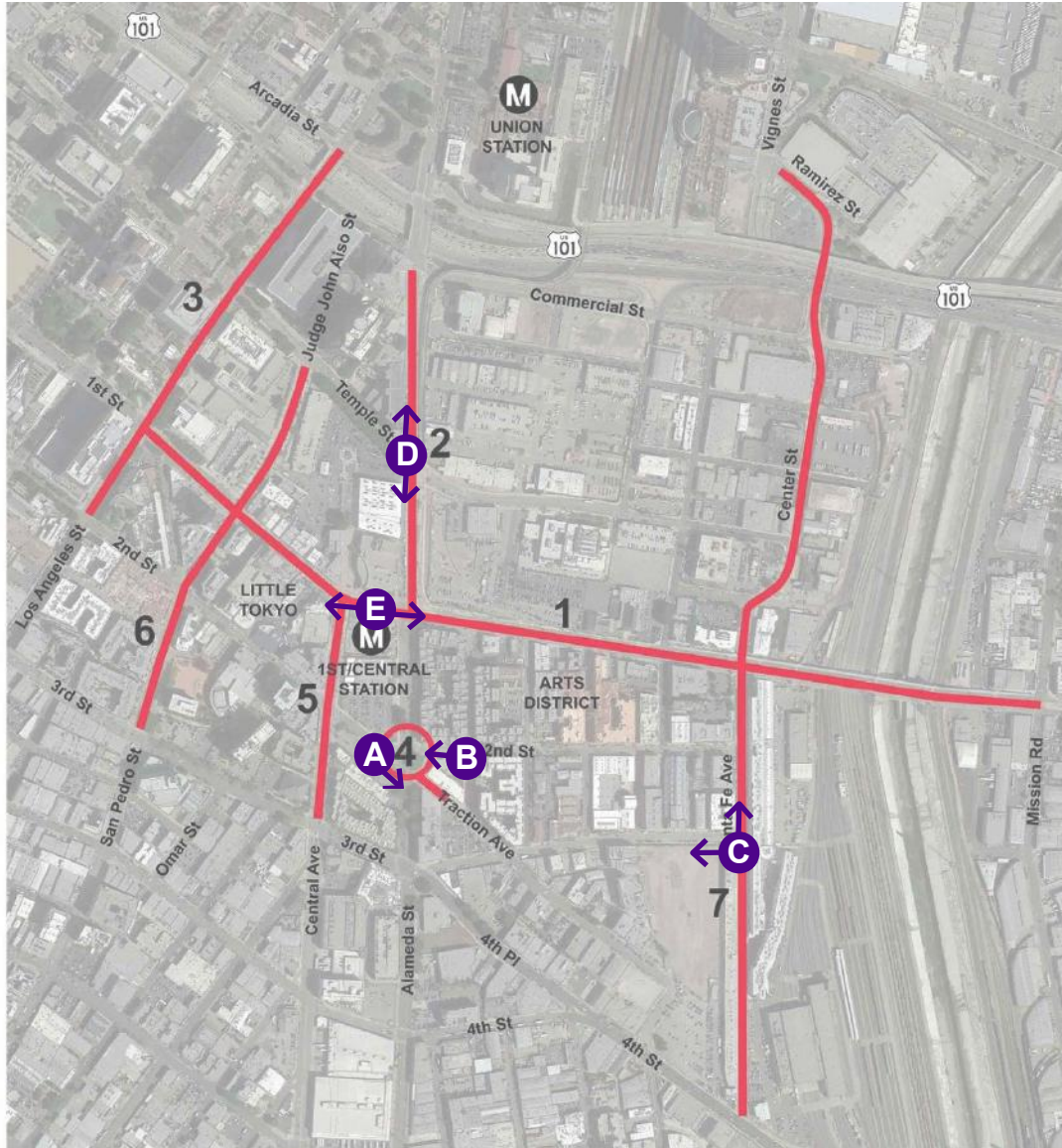

D Looking North (future esplanade)



E Looking West from the corner of 1st St/Central Ave



E Looking West from the corner of 1st St/Alameda St

- Establish an ‘overlay’ graphics visual language to work in both Little Tokyo and Arts District.
- Create a simple set of unified signage types:
 - Directional signs for pedestrians and cyclists
 - Interpretive elements to share local history and stories
- Design to coexist with existing Little Tokyo streetscape ‘brand’ elements.

Existing Sign Types to Remain

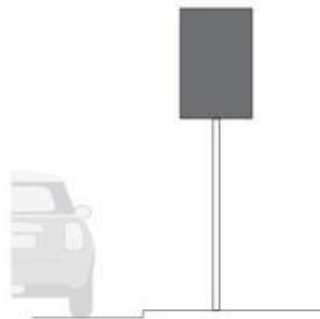

Vehicular Directional Sign
Signs directing drivers to destinations citywide.

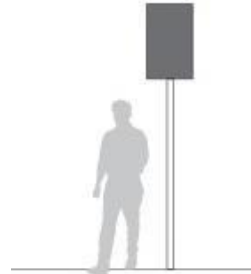

Pedestrian Directional Sign
Signs directing walkers to destinations.



Interpretive Kiosk
Angels Walk
interpretive kiosk



Interpretive Elements
Identity 'icons'

Recommendations—Sign Locations

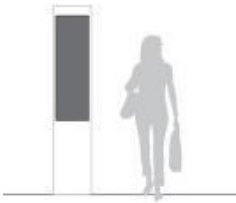

Interpretive Map Kiosk

Purpose

Orient pedestrians to surrounding areas and districts. Provide historical and personal stories of the area.

Potential Destinations

Map will include existing pedestrian map destinations.

Quantity

6

● Interpretive Map Kiosk

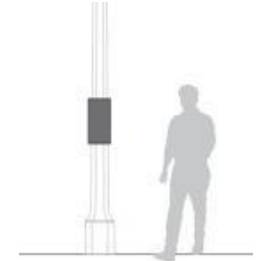
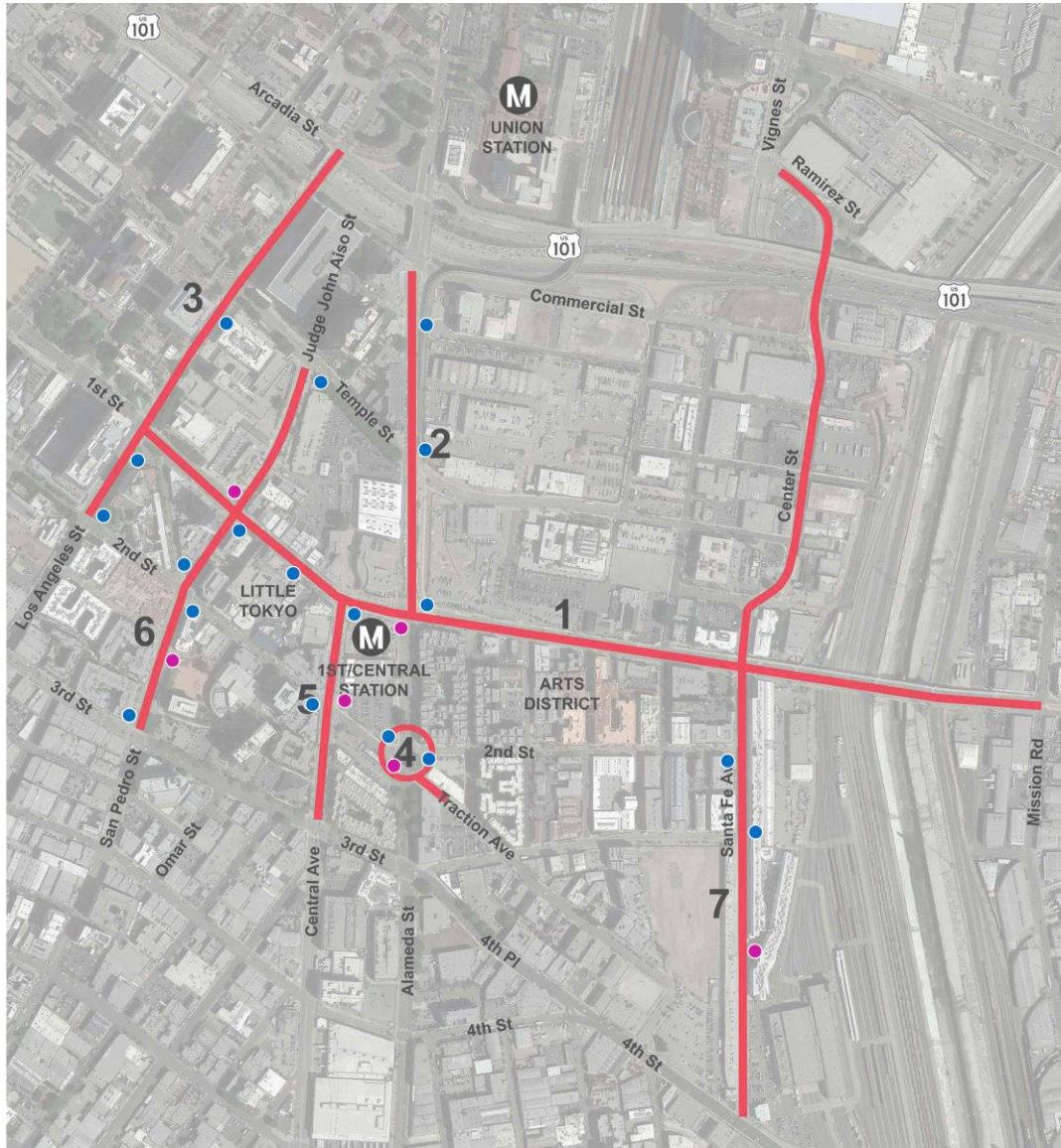

Secondary Map

Purpose

Orient pedestrians to immediate area.

Potential Destinations

1st/Central Station

Map will include existing pedestrian map destinations.

Quantity

18

● Secondary Map Sign

Design Concept—OPTION A

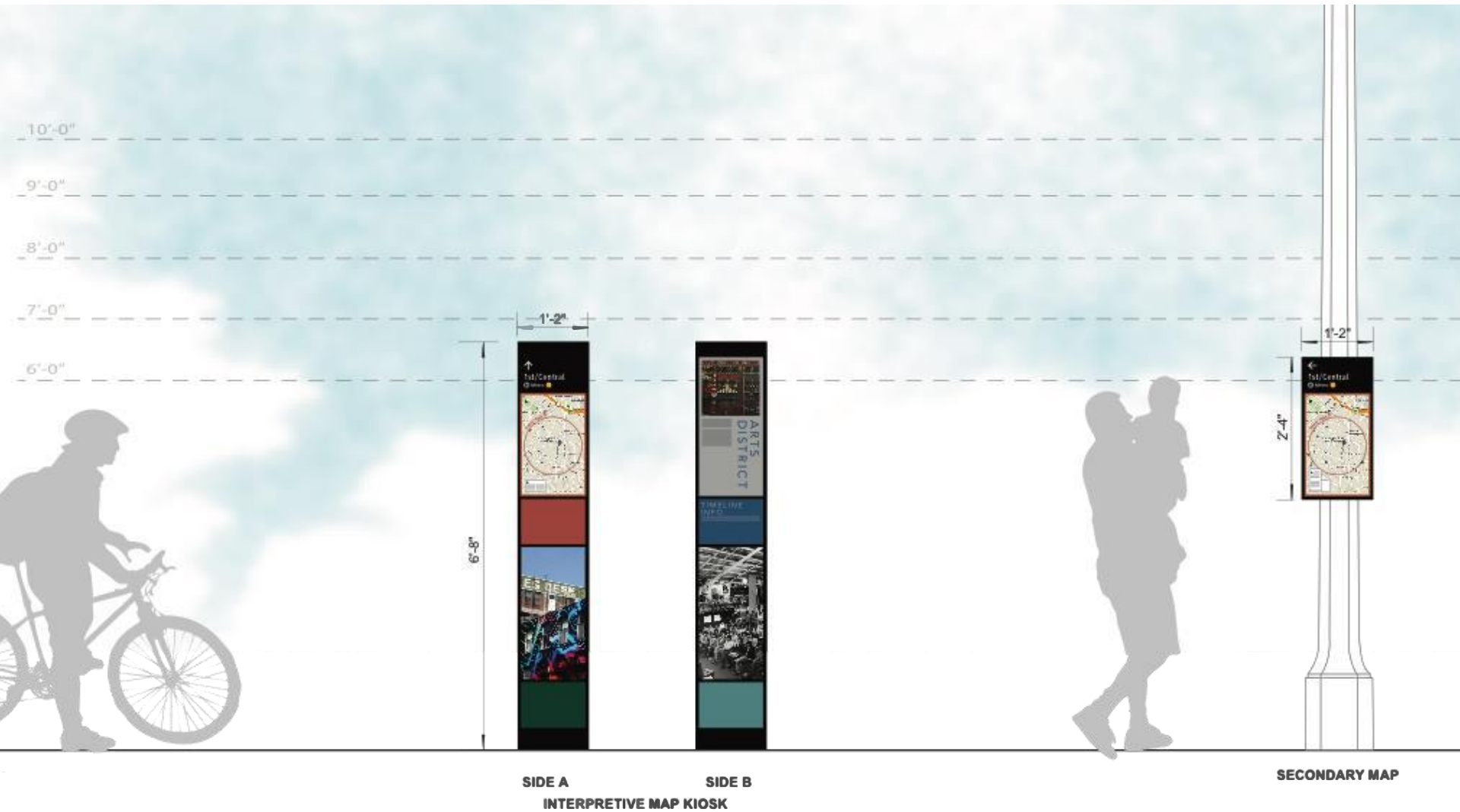

Design Concept—OPTION A

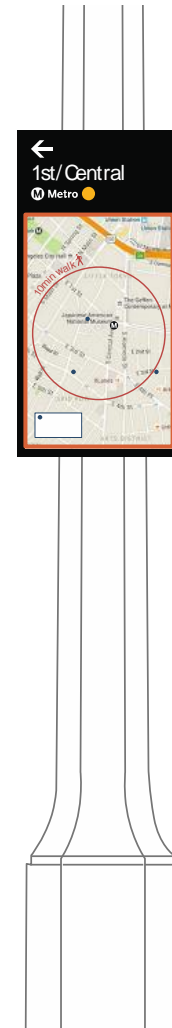
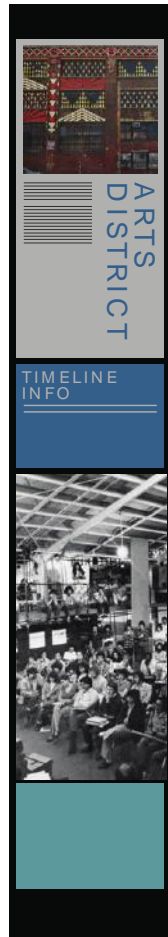
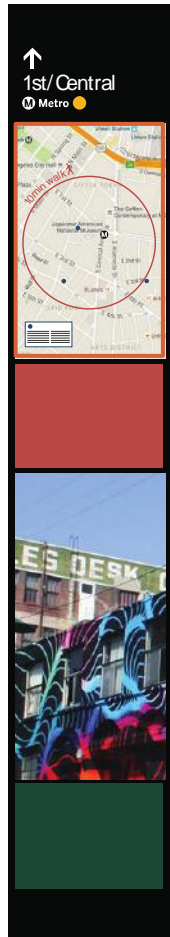

Design Concept—OPTION B

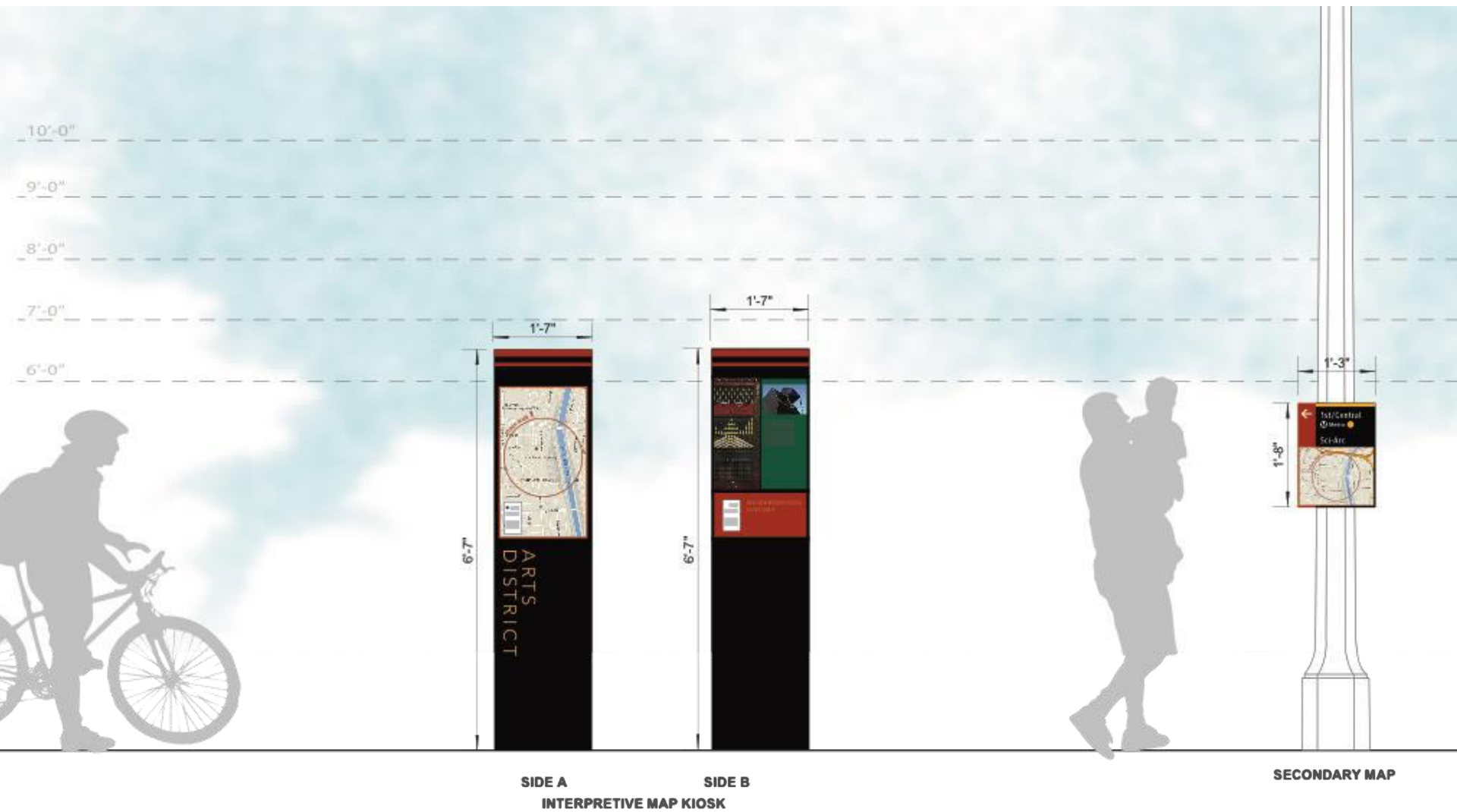

Design Concept—OPTION B



ARTS
DISTRICT

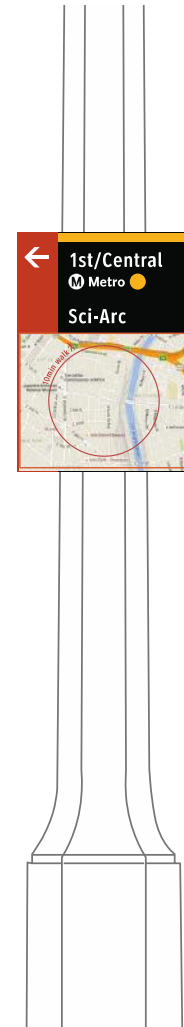
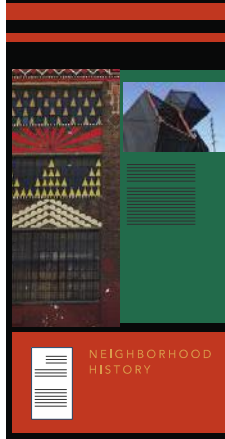

Design Concept Sign Locations





Secondary Map



Map Kiosk



Secondary Map



Map Kiosk

Proposed Bicyclist Directional Sign Type



Bicyclist Directional Sign
Signs directing bicyclists to destinations as per LADOT Bicycle Wayfinding Standards



Q & A