



We're building a safer drive on the 91.

EASTBOUND SR-91 ATLANTIC AV TO CHERRY AV AUXILIARY

LANE IMPROVEMENTS PROJECT

Community Meeting

July 22, 2024



Thank you for joining us today!

We understand that safety is a top priority for our community.

**Metro's plan will enhance safety on the Eastbound SR-91
between Atlantic Av to Cherry Av.**

**Tonight's meeting is designed to provide updates on the project and respond to
questions and concerns.**



Meeting Format

Metro is committed to listening with empathy and hearing your comments. We are here to provide you information on the environmental process, our approach to construction and answer your questions. To ensure the best possible outcome this evening, we ask everyone present to:

- Respect the format of the meeting and allow everyone an opportunity to submit questions
- Turn off cell phones and background noise
- Treat fellow community members and agency representatives with respect
- Address all questions and comments to Metro staff and consultants
- Maintain a conversational tone



Today's Agenda

Agenda

- > Welcome
- > Remarks by Councilmember Dr. Joni Ricks-Oddie
- > Project Limits/Details, Overview and Benefits
- > Metro's Approach to Planning and Environmental Review
- > EB SR-91 Environmental Review Process
- > Metro's Approach to Construction
- > Questions & Answers



Metro Representatives

- > Tim Lindholm, Chief Program Management Officer (Interim)
- > Paul Sullivan, Deputy Executive Officer
- > Ray Sosa, Chief Planning Officer
- > Carlos Montez, Deputy Executive Officer, Metro Countywide Planning and Development
- > Lucy Delgadillo, Sr. Director, Metro Countywide Planning and Development
- > Yvette ZR Rapose, Deputy Chief Customer Experience Officer
- > Anthony Crump, Executive Officer, Community and Construction Relations
- > Olga Arroyo, Director, Metro Construction Relations and Mitigation Programs



Caltrans Representatives

- > Thoa Le, Senior Environmental Scientist
- > Dawn Kukla Montano, Oversight Environmental Office Chief
- > Douglas Asher, Maintenance Manager II
- > Gerardo Parga, Maintenance Area Superintendent
- > George Saker, Office Chief
- > Issam Abumuhor, Principal
- > Thang Ton, Oversight Resident Engineer
- > Shane Weaver, Governmental Affairs Liaison
- > Peter Jones, Public Information Officer
- > Joseph E. Reynoza, Sr. Transportation Engineer



City of Long Beach Representatives

City of Long Beach

- > Grace Yoon, Deputy City Manager
- > Sarah Patterson, Manager of Strategic Partnerships & Gov. Affairs
- > Nancy Villasenor, Public Works
- > Jason Gallup, Sustainability
- > Laath Martin, Public Health

Project Limits/Details

- > From I-710 to EB SR-91 between Atlantic Av and Cherry Av
- > 1.4-mile project limits (restriping) includes a 0.86-mile auxiliary lane between Atlantic Av and Cherry Av
- > Total Life-of-Project Budget: \$174.2 Million
- > Funded by local Measure R and M, Trade Corridor Enhancement Program state funding and federal funding



Auxiliary Lane Cross Section

- > The project adds a 0.86-mile auxiliary lane between Atlantic Av and Cherry Av.
- > There will not be any additional thru lanes.
- > The shoulder will be standardized.

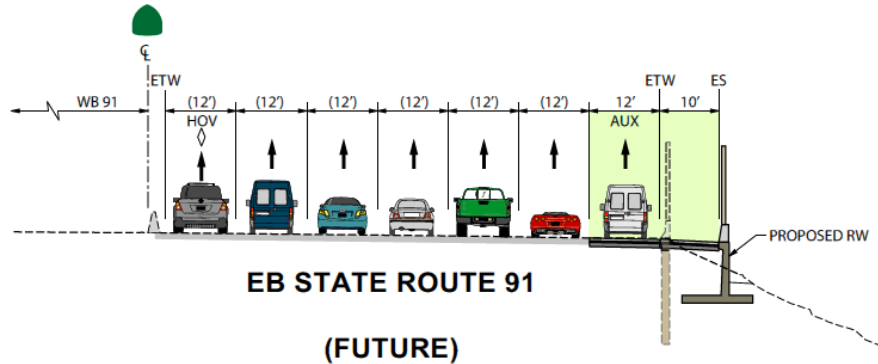
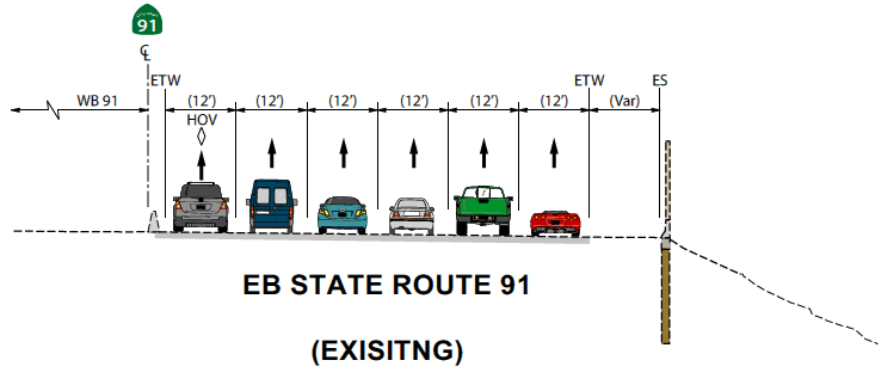

Section east of Myrtle before the Cherry Off ramp



EB SR-91 Project Benefits

- > The Project will add one eastbound auxiliary lane between (0.86-mile) the I-710 freeway interchange/Atlantic Av and the Cherry Av off-ramp to enhance the safety and operation of the freeway.
- > Safety and Congestion Benefits:
 - The auxiliary lane will reduce vehicle queues and enhance safety.
- > On-ramp Extension:
 - The Atlantic Av On-Ramp will be lengthened by 500 feet, increasing the ramp meter limit line.
 - By providing adequate storage space, the risk of vehicle spillover onto local streets will be minimized.
 - This will expand vehicle storage from 280 feet to 780 feet per lane, accommodating future traffic volumes through 2045.
- > Traffic Operations:
 - The addition of an auxiliary lane will improve traffic conditions by lengthening the lane to allow for easier, less congestive maneuvering between lanes.
 - This project will reduce congestion-related accidents, enhance PM peak hour HOV lane operations, and improve overall mobility in the area.
- > Extending the HOV lane entry/exit points to the west and east will provide earlier access, allowing HOV vehicles more time to merge smoothly.



Project Benefits Cont'd

- > **Per the Benefit Cost Analysis (BCA) the construction of the Project alone will create 2,431 direct and indirect jobs that will last the duration of construction.**
- > The Project Labor Agreement (PLA) requires 40% participation of construction workers residing in economically disadvantaged communities

Metro's Approach to Planning & Environmental Review

Planning & Environmental Review Approach

- > Evaluate purpose and need
 - Safety
 - Addressing high collisions rates in this segment
- > Compliance
 - Caltrans Highway Design Manual
 - Caltrans Standard Environmental Reference
- > Oversight
 - Metro is the Project Sponsor and Implementing Agency
 - Caltrans is the owner and operator of the freeway and CEQA/NEPA lead

EB SR-91 Environmental Review Process

Environmental Process Guidelines

- > Prepared the environmental document under CEQA/NEPA Guidelines
 - Determined purpose and need
 - Evaluated alternatives
 - Conducted technical studies
 - Evaluated impacts
 - Prepared the environmental document
 - Conducted a public circulation & comment period of the draft environmental document
 - Responded to comments
 - Finalized the environmental document

Metro and City Coordination

- > Metro met consistently with the City of Long Beach staff and the Council Office through the planning phase.
- > Review of each of the phases of the project design took place.
- > Metro will continue its coordination with the City and the Council Office through the next phase of the project.



Documents Prepared for the SR-91 Project

- > For SR-91/Cherry, an Initial Study (IS)/Mitigated Negative Declaration (MND) (CEQA)/ Environmental Assessment (EA)/Finding of No Significant Impact (FONSI) (NEPA) was based on the level of impact. Based on the analysis, it was determined that significant impacts would not occur. Mitigation measure were included to minimize impact by limiting the magnitude such as reconstruction of noise barriers (MM-NOI-1) or discovery of Paleontological resources (MM-PALEO-1 through MM-PALEO-7)

Noise Evaluation

Noise Study Report (NSR)

- > Completed in Sept 2020 which was conducted in support of the environmental document.
- > NSR identifies traffic noise impacts and evaluates noise abatement for acoustical feasibility.
- > Existing noise studies were conducted and evaluated with and without the Project.
- > Noise Readings were conducted in August 2019
 - Existing noise levels range between 56 dB to 65 dB
 - With No Build noise levels will range between 64 dB to 72 dB
 - With Project noise levels will range between 58 dB to 68 dB

Noise Abatement Decision Report (NADR)

- > Completed in October 2020, in support of the environmental document.
- > The NADR reports on the feasibility and reasonableness of noise abatement.



Noise Evaluation (Cont'd.)

- > The Existing 12 ft Sound Wall on the Atlantic Av Bridge will be replaced in kind.
- > Proposed Barrier Heights Ranging from 8 to 16ft were Evaluated, 14ft was found to be the most feasible and reasonable based on Cost and Safety considerations
- > Length of the Proposed Wall, 4,864 ft, is similar in Length to the Existing Wall.
- > The Proposed 14ft Noise Barrier is Estimated up to 9 dB Noise Reduction.
- > The Proposed 14ft Noise Barrier that is being built adjacent to the residents on 67th Street is Projected to Reduce Noise Levels from Existing Levels
- > Without the Project and construction of the 14ft Noise Barrier the noise will worsen up to 9 dB

Metro's Approach to Construction

Metro's Approach to Construction

- > Safety is our #1 Priority
- > Compliance with Environmental Document
- > Contract Enforcement
- > Continued Coordination with City of Long Beach
- > Mitigations
- > Construction Notification



Project Activities

> Project work activities include:

- Construction of a 0.86-mile freeway auxiliary lane
- Sound wall and retaining wall construction
- Widen 4 bridges
- Retrofit the Atlantic Ave Bridge columns
- Landscaping

> The Project will be constructed in 5 Stages

Five Construction Stages to Build SR-91 Improvements



Stage 1 Construction Elements: Atlantic Av

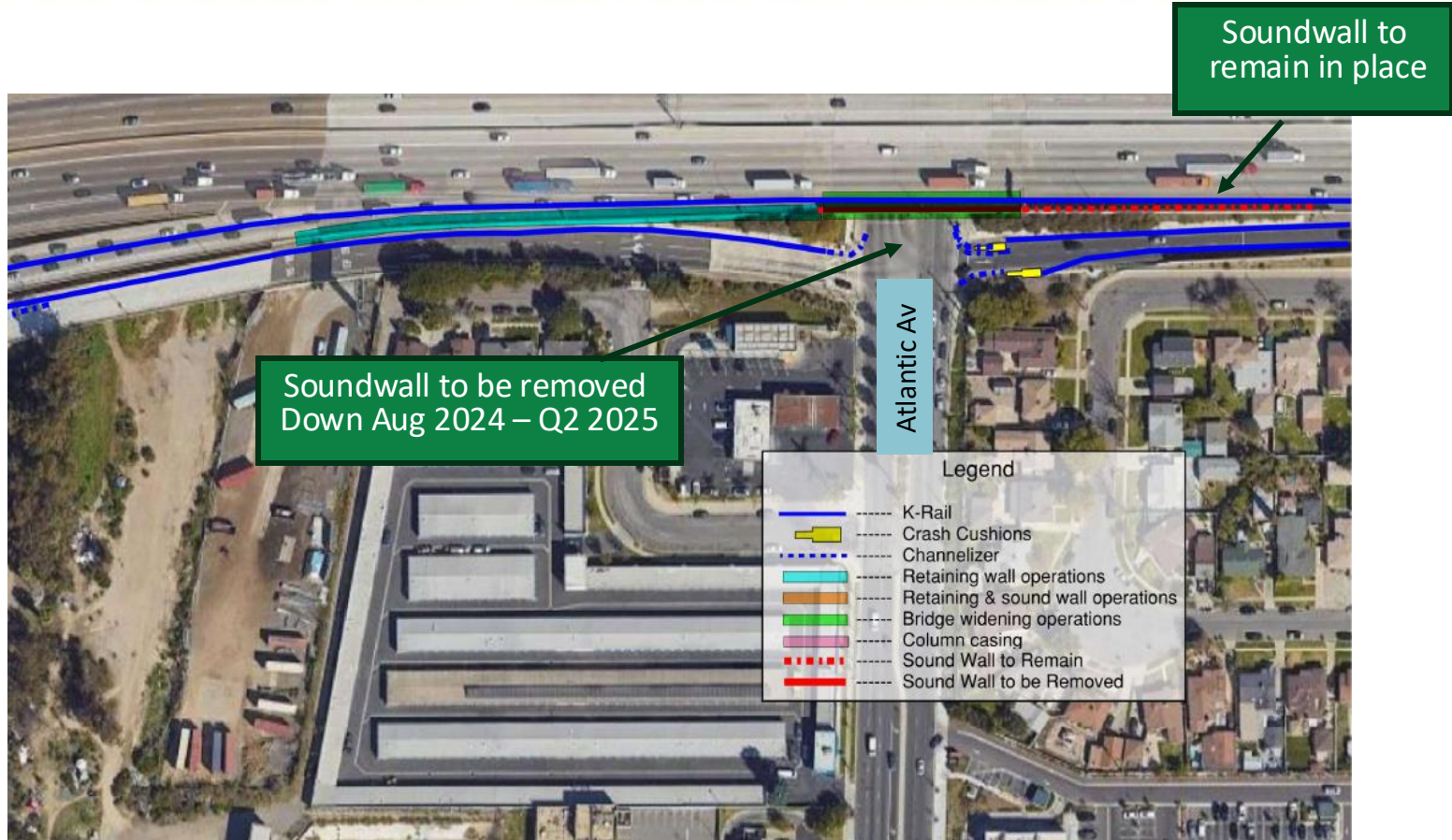

Stage 1 Construction Elements: Atlantic Av to Myrtle Av

Legend

- K-Rail
- Crash Cushions
- Channelizer
- Retaining wall operations
- Retaining & sound wall operations
- Bridge widening operations
- Column casing
- Sound Wall to Remain
- Sound Wall to be Removed



Stage 1 Construction Elements: Myrtle Av

Legend

- K-Rail
- Crash Cushions
- Channelizer
- Retaining wall operations
- Retaining & sound wall operations
- Bridge widening operations
- Column casing
- Sound Wall to Remain
- Sound Wall to be Removed

Soundwall & retaining wall to be removed
Down from Aug 2024 – Q2 2025



Construction Impact Mitigations

- > Industry standard measures will be used to mitigate construction impacts:
 - Noise (noise reducing equipment, keep soundwall up for as long as possible)
 - Vibration (regular monitoring)
 - Dust and tire track-out
 - Construction work zone access and haul routes
 - Maintain local streets access (vehicular & pedestrian)
 - 67th St parking and Contractor parking (west of Atlantic)
 - Nighttime light pollution (keep soundwall up for as long as possible)

Community Benefits

- > The EB SR-91 invested \$3.1 million in design adjustments to allow for more flat area to accommodate the City's Beach Hamilton Loop Project.
- > This is being achieved by lowering the retaining wall footings, reducing the slope.
- > To yield the best design possible, adjustments of the design were done in partnership with the City of Long Beach throughout the planning phase.

Community Benefits

> In January 2022, the Metro Board directed staff to include select accommodations for air filtration and a 2:1 tree replacement ratio:

- Landscaping

- The project will plant trees at 2:1 ratio for trees removed due to construction
- Approximately 174 trees and other vegetation will be planted on the state right-of-way
- New irrigation system will be installed
- 174 additional trees will be distributed by the City of Long Beach
- For more info contact: The Office of Climate Action and Sustainability, 562-570-7483/
TreeRequest@longbeach.gov

- Air filtration

- Devices for businesses and residences located within 750 feet of the project will be made available by the City of Long Beach
- For more info contact: Department of Health and Human Services, Tel.: 562-570-7907/
PublicHealthInfo@longbeach.gov



Landscaping: Restored at the Completion of the Project



Prostrate Acacia/
Acacia Redolens
'Low Boy'



Boston Ivy/
Parthenocissus
Tricuspidata



Red Trumpet Vine/
Distictis Buccinatoria



Fern-Leaved
Catalina Ironwood/
Lyonothamnus
Floribundus
Asplenifolius



Sugar Bush/
Rhus Ovata



Davis Gold Toyon/
Heteromeles Arbutifolia



Eastern Redbud/
Cercis Canadensis



Mexican Sycamore/
Platanus Mexicana



Imperial Blue Plumbago/
Plumbago Auriculata

Plant Legend

PLANT GROUP (SIZE)	PLANT No.	SYMBOL	BOTANICAL NAME	COMMON NAME
A (No. 1)	1		<i>ACACIA REDOLENS</i> 'LOW BOY'	PROSTRATE ACACIA
	2		<i>DISTICTIS BUCCINATORIA</i>	RED TRUMPET VINE
	3		<i>PARTHENOCISSUS TRICUSPIDATA</i>	BOSTON IVY
B (No. 5)	4		<i>PLUMBAGO AURICULATA</i>	IMPERIAL BLUE PLUMBAGO
	5		<i>RHUS OVATA</i>	SUGAR BUSH
U (No. 15)	6		<i>CERCIS CANADENSIS</i>	EASTERN REDBUD
	7		<i>HETEROMELES ARBUTIFOLIA</i>	DAVIS GOLD TOYON
	8		<i>LYONOTHAMNUS FLORIBUNDUS</i> <i>ASPENIFOLIUS</i>	FERN-LEAVED CATALINA IRONWOOD
	9		<i>PLATANUS MEXICANA</i>	MEXICAN SYCAMORE

Plant Quantities

BOTANICAL NAME	COMMON NAME	PLANT GROUP		
		A	B	U
<i>ACACIA REDOLENS</i>	PROSTRATE ACACIA	1,004		
<i>DISTICTIS BUCCINATORIA</i>	RED TRUMPET VINE	23		
<i>PARTHENOCISSUS TRICUSPIDATA</i>	BOSTON IVY	214		
<i>PLUMBAGO AURICULATA</i>	IMPERIAL BLUE PLUMBAGO		32	
<i>RHUS OVATA</i>	SUGAR BUSH		43	
<i>CERCIS CANADENSIS</i>	EASTERN REDBUD			50
<i>HETEROMELES ARBUTIFOLIA</i>	DAVIS GOLD TOYON			89
<i>LYONOTHAMNUS FLORIBUNDUS</i> <i>ASPENIFOLIUS</i>	FERN-LEAVED CATALINA IRONWOOD			35
<i>PLATANUS MEXICANA</i>	MEXICAN SYCAMORE			26
TOTAL		1,241	75	200

June 25 Community Meeting Questions

- > Since the June 25 community meeting, Metro received 43 questions
- > All 43 questions have been answered in a Frequently Asked Questions (FAQs) document
- > The FAQ was published and distributed on July 11
 - E-mail distribution
 - Metro website
 - Social Media
 - NextDoor
- > What we heard generally were questions about maintenance/landscaping , project elements, community outreach, environmental process & concerns and construction impact mitigation



EB SR-91 Atlantic Av to Cherry Av Auxiliary Lane Improvements Project

Frequently Asked Questions

In response to questions received by Metro during the June 25, 2024, project update community meeting, the following FAQ was developed to address community questions.

1. **What are Metro and Caltrans commitments, post-project, for maintenance, upkeep, and homeless under the freeway? Please provide regular updates to Gateway Cities Service Council. Continue to keep the community engaged. How can residents report problems and/or violations by staff?**

Metro recognizes that the crises of homelessness, drug addiction, and untreated mental illness have impacted local communities, particularly where unhoused individuals are sheltering near freeways. Caltrans is responsible for assisting individuals experiencing homelessness after completing the EB SR-91 Project and within their right-of-way. Otherwise, homeless outreach under the freeway is the responsibility of the local jurisdiction. Residents can contact Caltrans at the following link <https://csr.dot.ca.gov/> to report maintenance concerns or call Caltrans District 7 Maintenance Support phone number at 213-897-4426.

The project will provide regular construction updates on the EB SR-91 Project to the Gateway Cities Service Council and the community.

During construction, the contractor is responsible for the maintenance and upkeep within the project boundaries. Community residents can contact the project for any inquiries or to report any project-related issues at 213.922.4091 or communityrelations@metro.net.

June 25 Community Meeting Questions (Contd.)

- > Public comments included general categories
 - Maintenance / Landscaping
 - Project Elements
 - Community Outreach
 - Environmental Process & Environmental Concerns
 - Construction Impact Mitigation

Questions & Answers



Stay connected to this project.



213.922.4091



communityrelations@metro.net



Metro.net/atlantic-cherry



@metrolosangeles



losangelesmetro