

# I-405 Sepulveda Pass Widening Project

November 19, 2009



# Project Overview

- 10 Mile Northbound HOV Lane
- Southbound Lane Standardization
- 20 Ramp Improvements
- 8 New Ramp Structures
- Widening of 12 Bridge Structures
- 3 New Bridge Structures
- 18 Miles of Retaining Wall and Sound Wall
- \$1.034 Billion
- Project Completion 2013
- Metro Board of Directors awarded project to Kiewit Pacific Company on April 24, 2009
- Issued Notice to Proceed June 2, 2009
- Project Commencement August 31, 2009



# Project Boundaries

## Southern Boundary

National Blvd., South of the Santa Monica-Rosa Parks Freeway (I-10)

## Northern Boundary

Greenleaf St. – South of the Ventura Freeway (U.S. 101)

I-405 Sepulveda Pass Widening Project Map

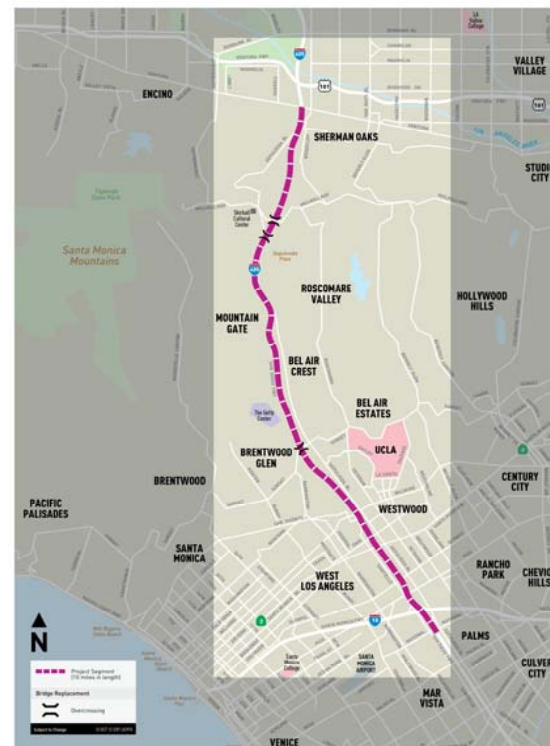

# Project Approach

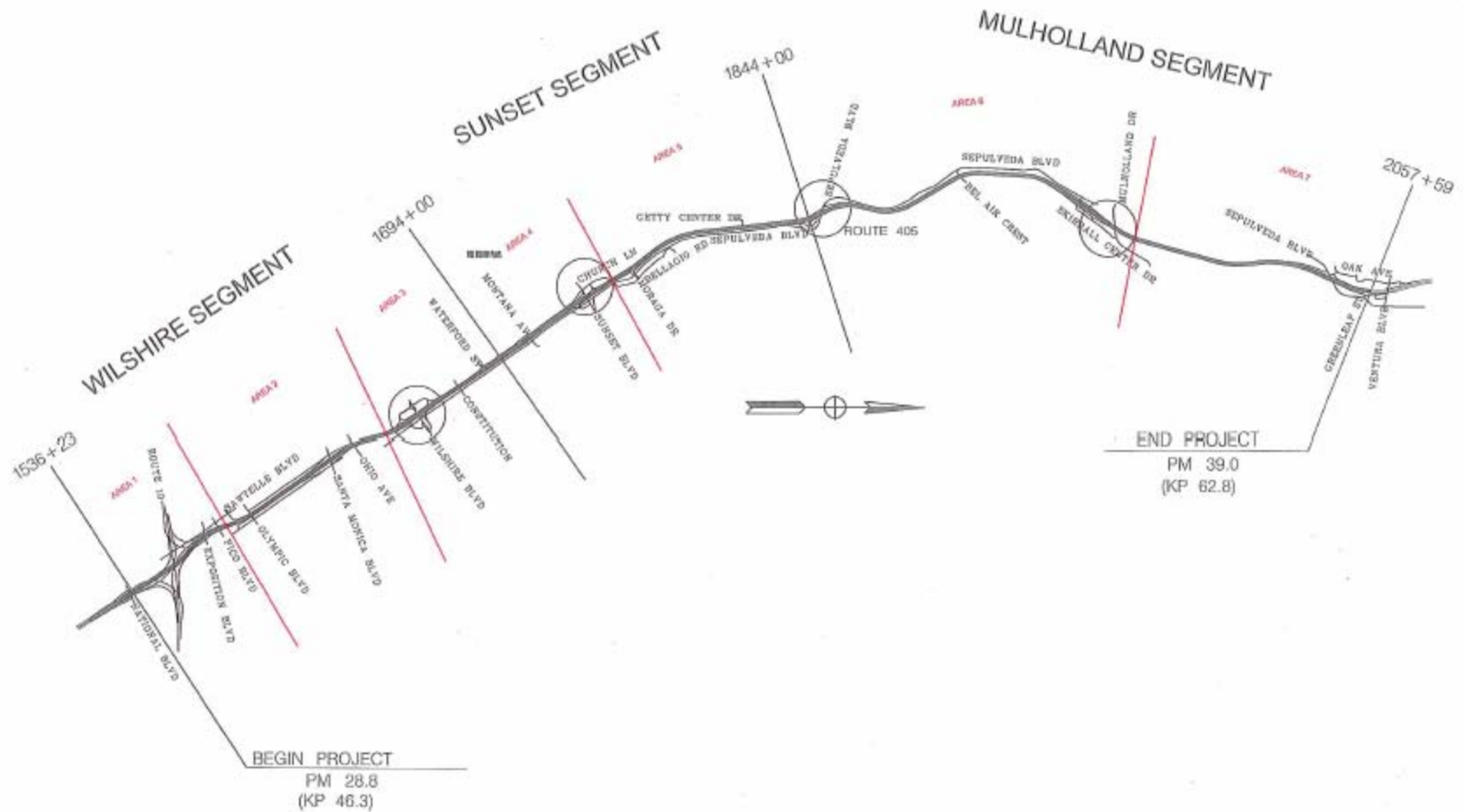



# Project Milestones

- Bridge Replacement Mulholland
- Shifting of Sepulveda
- Ramp Improvements at Wilshire, Sunset and Skirball
- Construct Retaining Walls
- MWD 96" water line realignment



# Pre-Construction Activities

- Geotechnical Investigation
- Inspection and cleaning of storm drains and sewers
- Survey Work
- Mobilization
- Construction Yard and Trailer set up
- Conceptual Design
- Pre-Construction Surveys



# Construction Schedule

## Early Work (Start mid-late December 2009)

- Construction Area Signs
  - Start December 2009
- Profile Grinding
  - Start 1st week of January 2010
- Lane Modifications/Re-striping
  - Start 3<sup>rd</sup> week of December 2009
- Barrier Rail Installation
  - Start 2<sup>nd</sup> week in January 2010
- Utility Relocations
  - Start January 2010



# Construction Schedule Continued

## Main Line Work (February/March 2010)

- 17 Retaining Walls along Sepulveda Blvd.
  - March 2010 to July 2012
- Box Culvert Protection/Relocation
  - TBD
- Wilshire Blvd. Interchange
  - March 2010 to October 2012



# Construction Schedule Continued

## Main Work (February/March 2010 Continued)

- Sunset Overcrossing Replacement
  - March 2010 to June 2011
- Soil Nail Walls/Excavation along Sepulveda Pass
  - March 2010 to February 2011



# Upcoming Activities

- Skirball Overcrossing Replacement
  - June 2010 to August 2011
- Mulholland Overcrossing Replacement
  - September 2010 to May 2012
- Getty Bridge Widening
  - March 2011 to September 2011
- Bel Air Crest Bridge Widening
  - June 2011 to November 2011



# Construction Mitigation

- Construction Noise
  - Monitoring noise levels during construction
  - Source reduction
  - Reduction at recipient
  - Limiting night work
  - Complaint process

# Construction Mitigation Continued

- Traffic Impacts
  - Outreach with CAC
  - Coordination with City and Caltrans
  - Avoid residential neighborhoods
  - Minimize Construction Vehicle Impacts
- Lighting
  - Avoid Residents
  - Limit night work



# Projects Coordination

## Projects in the Corridor

- Sepulveda Reversible and Bike Lane Project (LADOT)
- Skirball Widening (LADOT)
- DWP Sunset/Church Lane Sewer Project



# First Responders Coordination

## Main Line (Freeway) and Local Streets

- Increase Freeway Service Patrol
- CHP on site as required
- Closure submitted to LAPD weekly
- Close coordination of construction activities with LAPD, LASD, LAFD and CHP
- Emergency vehicles will have access to construction zone throughout the 10 miles



# Community Relations

## Construction Impact Mitigation Program

- Public Outreach
- Stakeholder Communication
- Construction Impact Mitigation
- On-going Coordination with Caltrans on commuter notifications



# Community Relations Continued

## Resolving Issues

- Regular hours work with Management team to address concerns
- After hours work with field staff to address concerns
- On call 24/7 for emergencies



# The End

Metro Community Relations

Project Hotline: (213) 922-3665

[I405@metro.net](mailto:I405@metro.net)

[www.metro.net/I-405](http://www.metro.net/I-405)

