

**STAGE CONSTRUCTION and TRAFFIC HANDLING PLAN:
Over Sepulveda Boulevard**

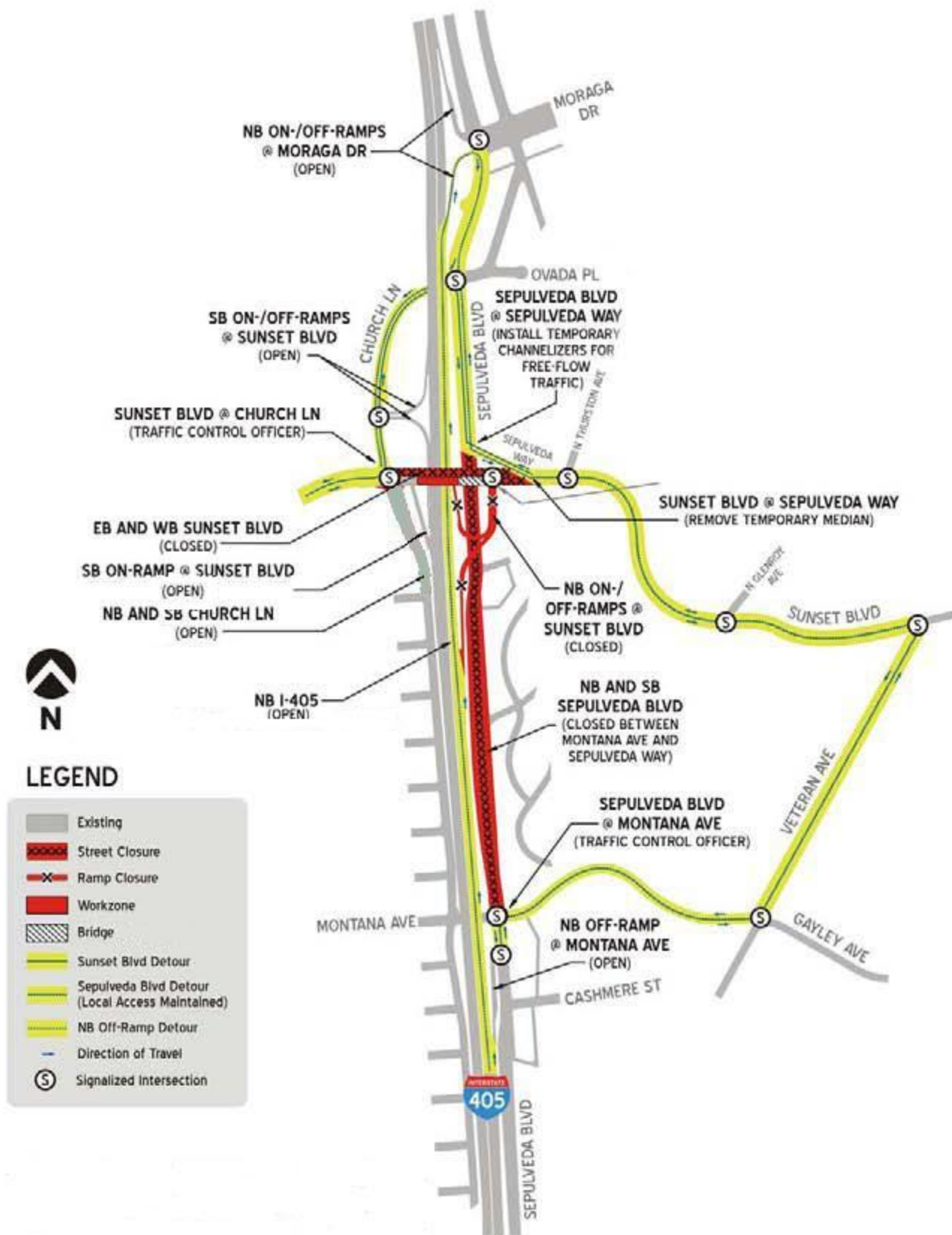

LEGEND

- Existing
- Street Closure
- Ramp Closure
- Workzone
- Bridge
- Sunset Blvd Detour
- Sepulveda Blvd Detour (Local Access Maintained)
- NB Off-Ramp Detour
- Direction of Travel
- Signalized Intersection